



Dexter Building Design Ltd
Unit 5
Victoria Grove
Bristol, BS3 4AN
Tel:
E: Enquiries@dexterdesigns.co.uk
www.Dexterdesigns.co.uk

**Proposed replacement
of roof**
Ladies and Gentlemans Public Conveniences,
Gulford Place, Camden, London, WC1

PRELIMINARY
NOT FOR
CONSTRUCTION

1 Beam layout

Scale: 1:25

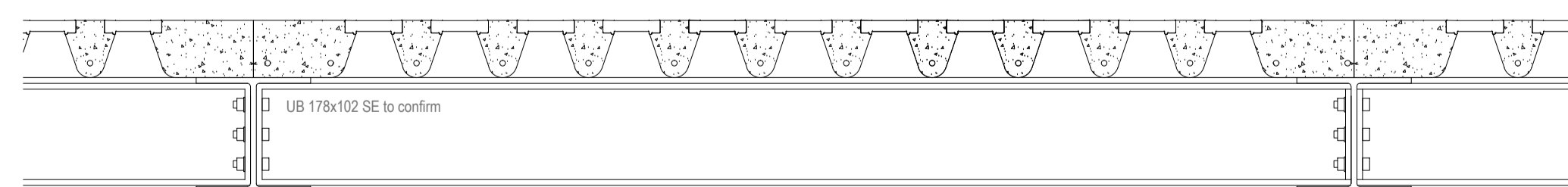
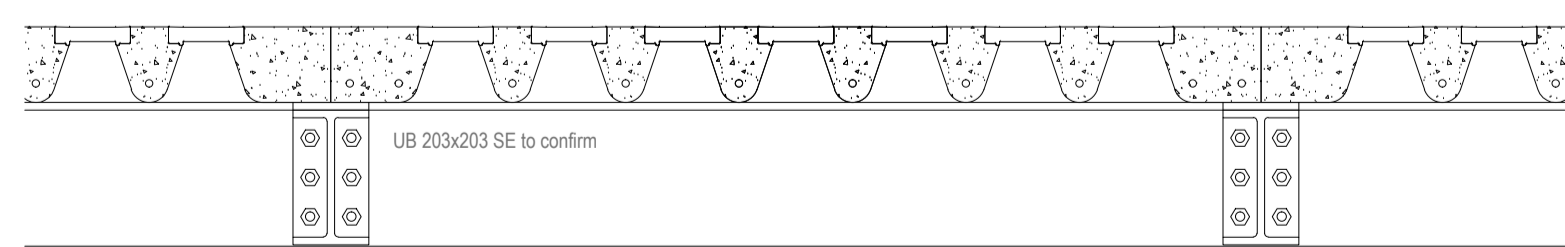

2 Typical proposed connection detail

Scale: 1:10

3 Typical proposed connection detail

Scale: 1:10

Revision no.	

Project No. 737

763_V02.03.dwg is kept roof only.dwg

Drawn

Checked JD

Date 08/04/2016

Scale As shown

Title No.

Beam layout and
Typical connection
detail

A108