

01: Existing Gallery Layout: Sir Joseph Hotung Gallery (Room 33): South Asia and Southeast Asia and Asahi Shinbun Gallery (Room 33a) Amaravati - Level 3

<table><tr><th>Rev.</th><th>Date</th><th>Description</th></tr><tr><td>-</td><td>29.07.16</td><td>Submitted for Listed Building Approval.</td></tr></table>			Rev.	Date	Description	-	29.07.16	Submitted for Listed Building Approval.	<p>Notes:</p> <ol style="list-style-type: none">1. All dimensions in mm.2. This drawing to be read in conjunction with all relevant contract documents.3. This drawing to be read in conjunction with all Engineer's and Main contractor/ Sub-Contractor drawings and documentation.4. Do not scale from this drawing.5. Report any errors, contradictions, and omissions to the architect as soon as possible.	<p>Key:</p>	<div><div><div><h1>Nissen Richards</h1><div><div>Unit 5-6 Waterhouse 8 Orsman Road London N1 5QJ</div><div>T 020 7870 8899 info@nissenrichardsstudio.com www.nissenrichardsstudio.com</div></div></div></div><div><div><div>Project:</div><div>Client:</div><div>Title:</div><div>Scale:</div><div>Drawing no:</div></div><div><div>Sir Joseph Hotung Gallery and Selwyn and Ellie Alleyne Gallery Refurbishment</div><div>The British Museum</div><div>Existing Sir Joseph Hotung Gallery Plan : South/ Southeast Asia Gallery Room 33 (Level 3)</div><div>1:100 at A1 1:200 at A3</div><div>A1628-PL-120/-</div></div></div></div>
Rev.	Date	Description									
-	29.07.16	Submitted for Listed Building Approval.									

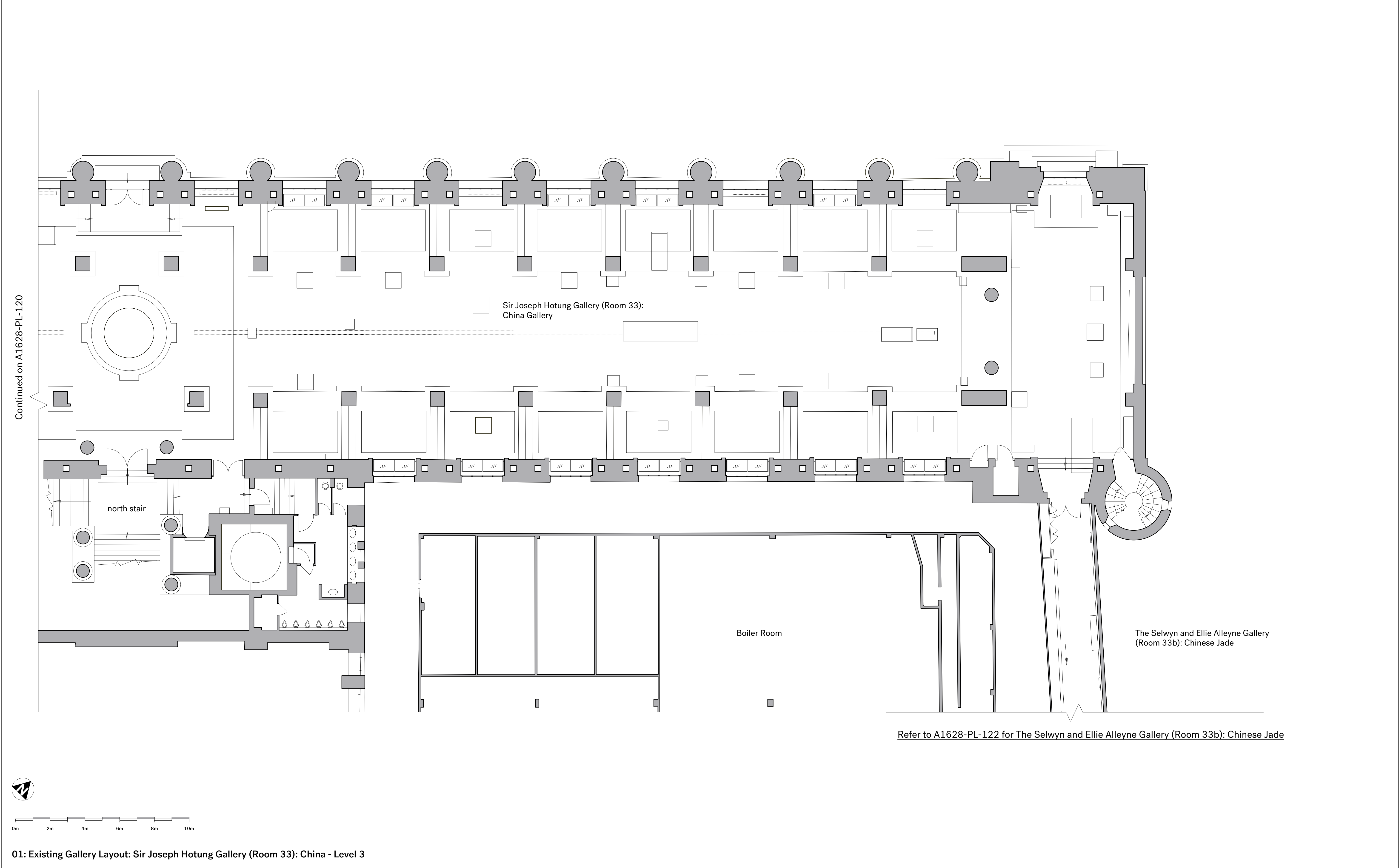

01: Existing Gallery Layout: Sir Joseph Hotung Gallery (Room 33): China - Level 3

<table><tr><th>Rev.</th><th>Date</th><th>Description</th></tr><tr><td>-</td><td>29.07.16</td><td>Submitted for Listed Building Approval.</td></tr></table>			Rev.	Date	Description	-	29.07.16	Submitted for Listed Building Approval.	<p>Notes:</p> <ol style="list-style-type: none">1. All dimensions in mm.2. This drawing to be read in conjunction with all relevant contract documents.3. This drawing to be read in conjunction with all Engineer's and Main contractor/ Sub-Contractor drawings and documentation.4. Do not scale from this drawing.5. Report any errors, contradictions, and omissions to the architect as soon as possible.	<p>Key:</p>	<div><div><h1>Nissen Richards</h1><p>Unit 5-6 Waterhouse 8 Orsman Road London N1 5QJ</p><p>T 020 7870 8899 info@nissenrichardsstudio.com www.nissenrichardsstudio.com</p></div><div><table><tr><td>Project:</td><td>Sir Joseph Hotung Gallery and Selwyn and Ellie Alleyne Gallery Refurbishment</td></tr><tr><td>Client:</td><td>The British Museum</td></tr><tr><td>Title:</td><td>Existing Sir Joseph Hotung Gallery Plan: China Gallery, Room 33 (Level 3)</td></tr><tr><td>Scale:</td><td>1:100 at A1 1:200 at A3</td></tr><tr><td>Drawing no:</td><td>A1628-PL-121/-</td></tr></table></div></div>	Project:	Sir Joseph Hotung Gallery and Selwyn and Ellie Alleyne Gallery Refurbishment	Client:	The British Museum	Title:	Existing Sir Joseph Hotung Gallery Plan: China Gallery, Room 33 (Level 3)	Scale:	1:100 at A1 1:200 at A3	Drawing no:	A1628-PL-121/-
Rev.	Date	Description																			
-	29.07.16	Submitted for Listed Building Approval.																			
Project:	Sir Joseph Hotung Gallery and Selwyn and Ellie Alleyne Gallery Refurbishment																				
Client:	The British Museum																				
Title:	Existing Sir Joseph Hotung Gallery Plan: China Gallery, Room 33 (Level 3)																				
Scale:	1:100 at A1 1:200 at A3																				
Drawing no:	A1628-PL-121/-																				

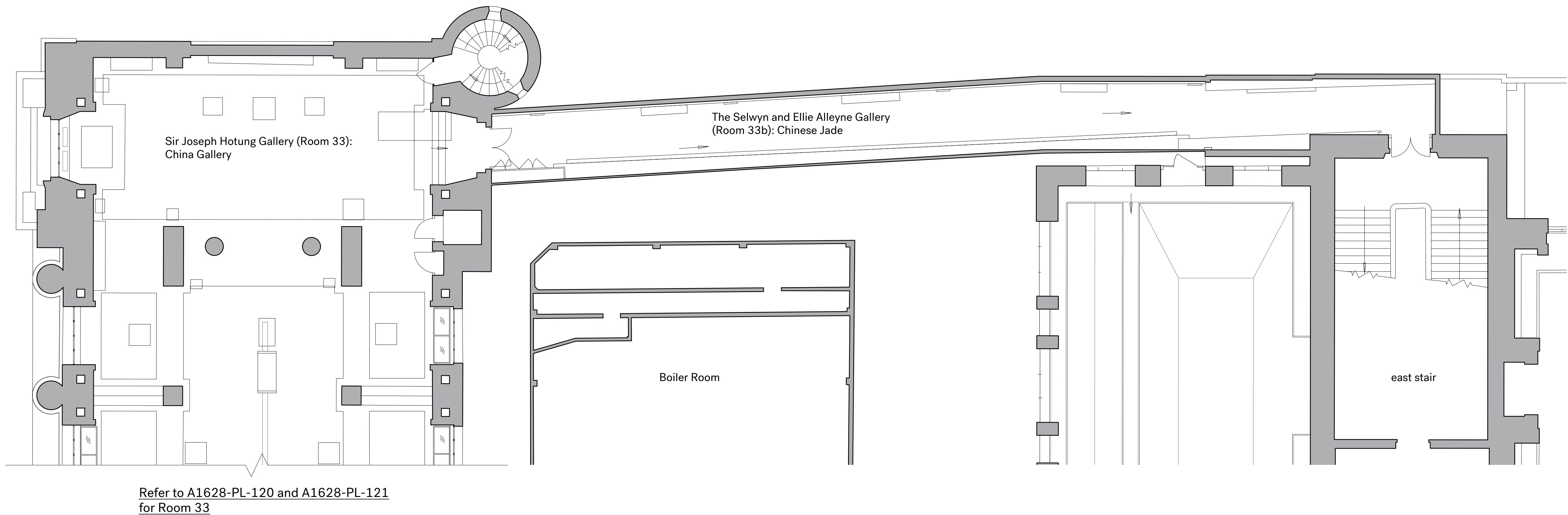

0m 2m 4m 6m 8m 10m

01: Existing Gallery Layout: The Selwyn and Ellie Alleyne Gallery (Room 33b) Chinese Jade - Level 3

Rev.	Date	Description
-	29.07.16	Submitted for Listed Building Approval.

Notes:
1. All dimensions in mm.
2. This drawing to be read in conjunction with all relevant contract documents.
3. This drawing to be read in conjunction with all Engineer's and Main contractor/
Sub-Contractor drawings and documentation.
4. Do not scale from this drawing.
5. Report any errors, contradictions, and omissions to the architect as soon as possible.

Key:

Nissen Richards

Unit 5-6 Waterhouse
8 Orsman Road
London N1 5QJ

T 020 7870 8899
info@nissenrichardsstudio.com
www.nissenrichardsstudio.com

Project:	Sir Joseph Hotung Gallery and Selwyn and Ellie Alleyne Gallery Refurbishment
Client:	The British Museum
Title:	Existing Selwyn and Ellie Alleyne Gallery Plan Chinese Jade, Room 33b (Level 3)
Scale:	1:100 at A1 1:200 at A3
Drawing no:	A1628-PL-122/-

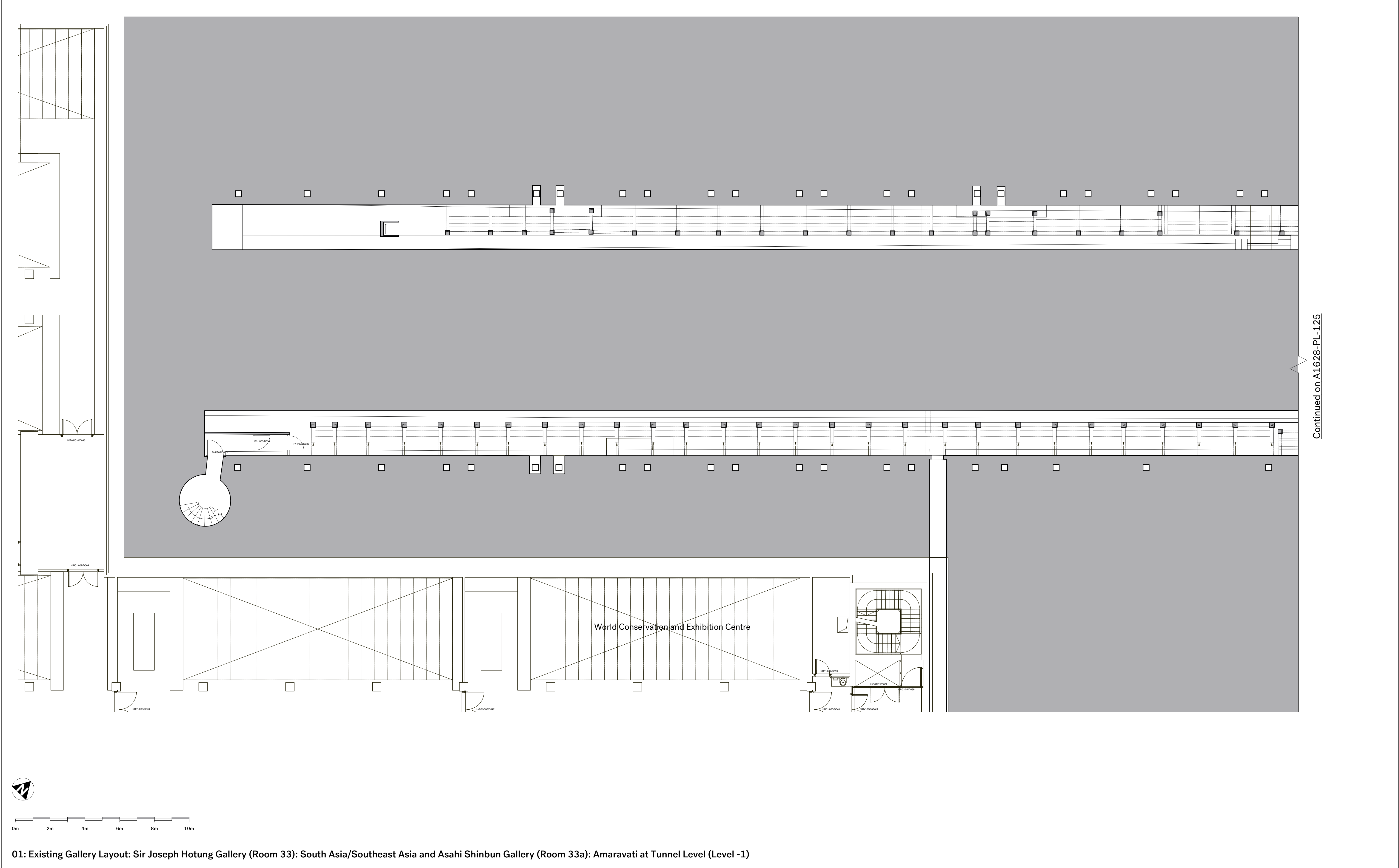

01: Existing Gallery Layout: Sir Joseph Hotung Gallery (Room 33): South Asia/Southeast Asia and Asahi Shinbun Gallery (Room 33a): Amaravati at Tunnel Level (Level -1)

<table><tr><th>Rev.</th><th>Date</th><th>Description</th></tr><tr><td>-</td><td>29.07.16</td><td>Submitted for Listed Building Approval.</td></tr></table>			Rev.	Date	Description	-	29.07.16	Submitted for Listed Building Approval.	<p>Notes:</p> <ol style="list-style-type: none">1. All dimensions in mm.2. This drawing to be read in conjunction with all relevant contract documents.3. This drawing to be read in conjunction with all Engineer's and Main contractor/ Sub-Contractor drawings and documentation.4. Do not scale from this drawing.5. Report any errors, contradictions, and omissions to the architect as soon as possible.	<p>Key:</p>	<div><div><h1>Nissen Richards</h1><div><div>Unit 5-6 Waterhouse 8 Orsman Road London N1 5QJ</div><div>T 020 7870 8899 info@nissenrichardsstudio.com www.nissenrichardsstudio.com</div></div></div><div><table><tr><td>Project:</td><td>Sir Joseph Hotung Gallery and Selwyn and Ellie Alleyne Gallery Refurbishment</td></tr><tr><td>Client:</td><td>The British Museum</td></tr><tr><td>Title:</td><td>Existing Sir Joseph Hotung Gallery Plan : Tunnels under South/Southeast Asia Gallery Room 33 (Level -1)</td></tr><tr><td>Scale:</td><td>1:100 at A1 1:200 at A3</td></tr><tr><td>Drawing no:</td><td>A1628-PL-124/-</td></tr></table></div></div>	Project:	Sir Joseph Hotung Gallery and Selwyn and Ellie Alleyne Gallery Refurbishment	Client:	The British Museum	Title:	Existing Sir Joseph Hotung Gallery Plan : Tunnels under South/Southeast Asia Gallery Room 33 (Level -1)	Scale:	1:100 at A1 1:200 at A3	Drawing no:	A1628-PL-124/-
Rev.	Date	Description																			
-	29.07.16	Submitted for Listed Building Approval.																			
Project:	Sir Joseph Hotung Gallery and Selwyn and Ellie Alleyne Gallery Refurbishment																				
Client:	The British Museum																				
Title:	Existing Sir Joseph Hotung Gallery Plan : Tunnels under South/Southeast Asia Gallery Room 33 (Level -1)																				
Scale:	1:100 at A1 1:200 at A3																				
Drawing no:	A1628-PL-124/-																				

Continued on A1628-PL-124

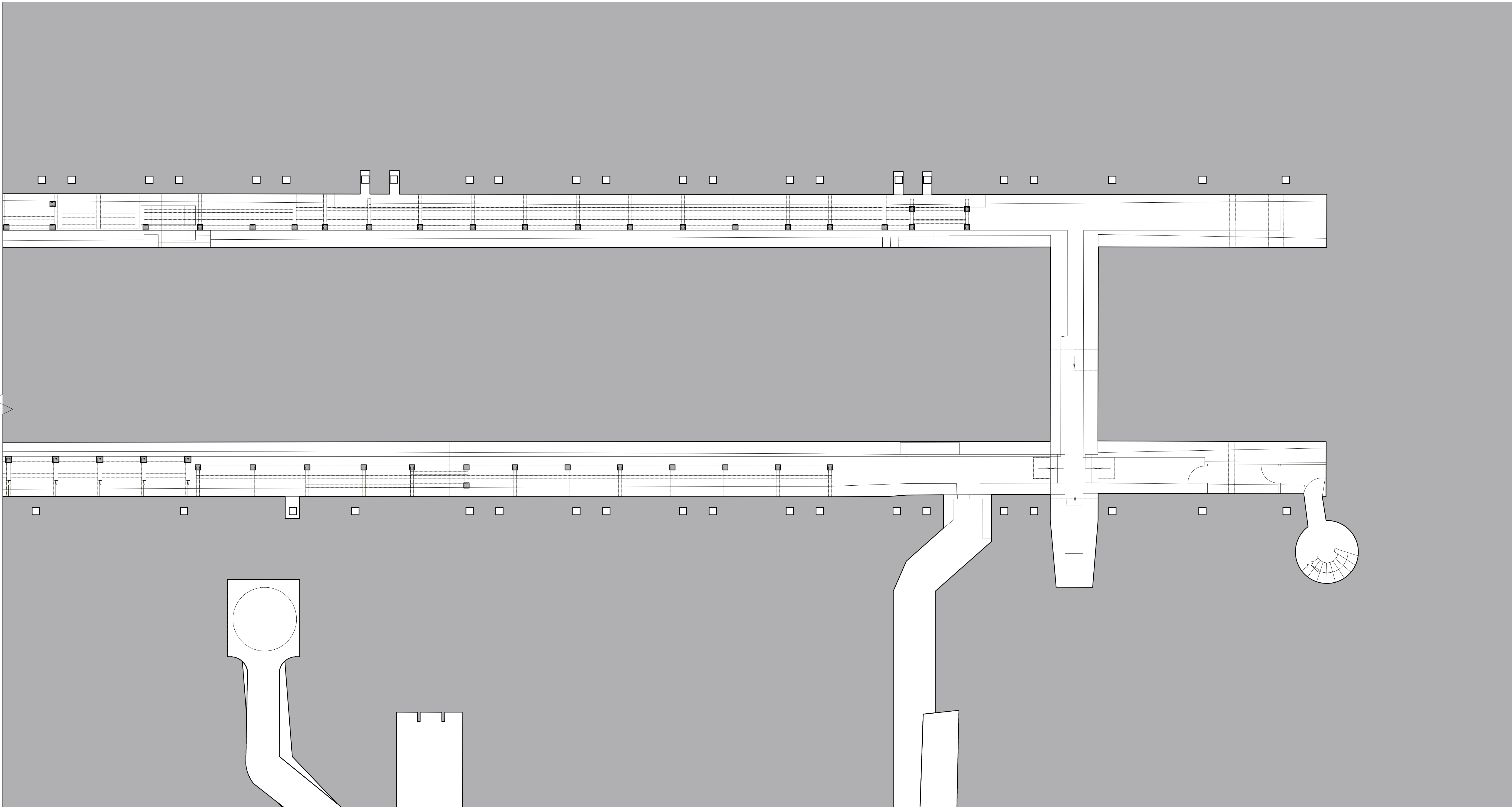

0m 2m 4m 6m 8m 10m

01: Existing Gallery Layout: Sir Joseph Hotung Gallery (Room 33): China at Tunnel Level (Level -1)

Rev.	Date	Description
-	29.07.16	Submitted for Listed Building Approval.

Notes:
1. All dimensions in mm.
2. This drawing to be read in conjunction with all relevant contract documents.
3. This drawing to be read in conjunction with all Engineer's and Main contractor/
Sub-Contractor drawings and documentation.
4. Do not scale from this drawing.
5. Report any errors, contradictions, and omissions to the architect as soon as possible.

Key:

Nissen Richards

Unit 5-6 Waterhouse
8 Orsman Road
London N1 5QJ

T 020 7870 8899
info@nissenrichardsstudio.com
www.nissenrichardsstudio.com

Project: Sir Joseph Hotung Gallery and Selwyn and Ellie Alleyne Gallery Refurbishment
Client: The British Museum
Title: Existing Sir Joseph Hotung Gallery Plan : Tunnels under China Gallery Room 33 (Level -1)
Scale: 1:100 at A1 1:200 at A3
Drawing no: A1628-PL-125/-

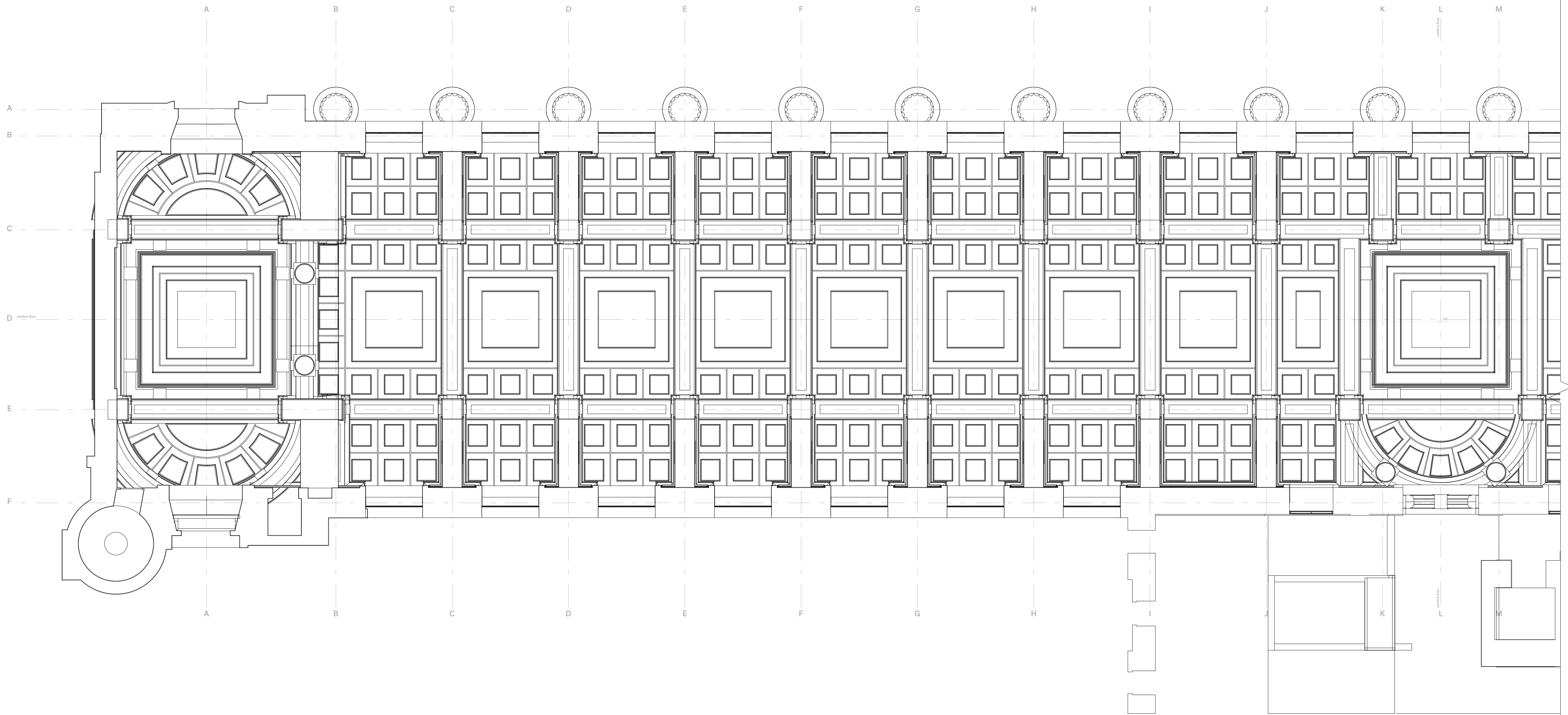

Continued on A1628-PL-210



0m 2m 4m 6m 8m 10m

01: Existing Reflected Ceiling Plan : South Asia Gallery (Level 3)

Rev.	Date	Description
-	29.07.16	Submitted for Listed Building Approval.

Rev.	Date	Description
------	------	-------------

Notes:
1. All dimensions in mm.
2. This drawing to be read in conjunction with all relevant contract documents.
3. This drawing to be read in conjunction with all Engineer's and Main contractor/
Sub-Contractor drawings and documentation.
4. Do not scale from this drawing.
5. Report any errors, contradictions, and omissions to the architect as soon as possible.

Key:

Nissen Richards
Unit 5-6 Waterhouse T 020 7870 8899
8 Orsman Road info@nissenrichardsstudio.com
London N1 5QJ www.nissenrichardsstudio.com

Project:	Sir Joseph Hotung Gallery and Selwyn and Ellie Alleyne Gallery Refurbishment
Client:	The British Museum
Title:	Existing Reflected Ceiling Plan: South/ Southeast Asia Gallery Room 33 (Level 3)
Scale:	1:100 at A1 1:200 at A3
Drawing no:	A1628-PL-130/-

Continued on A1628-PL-210

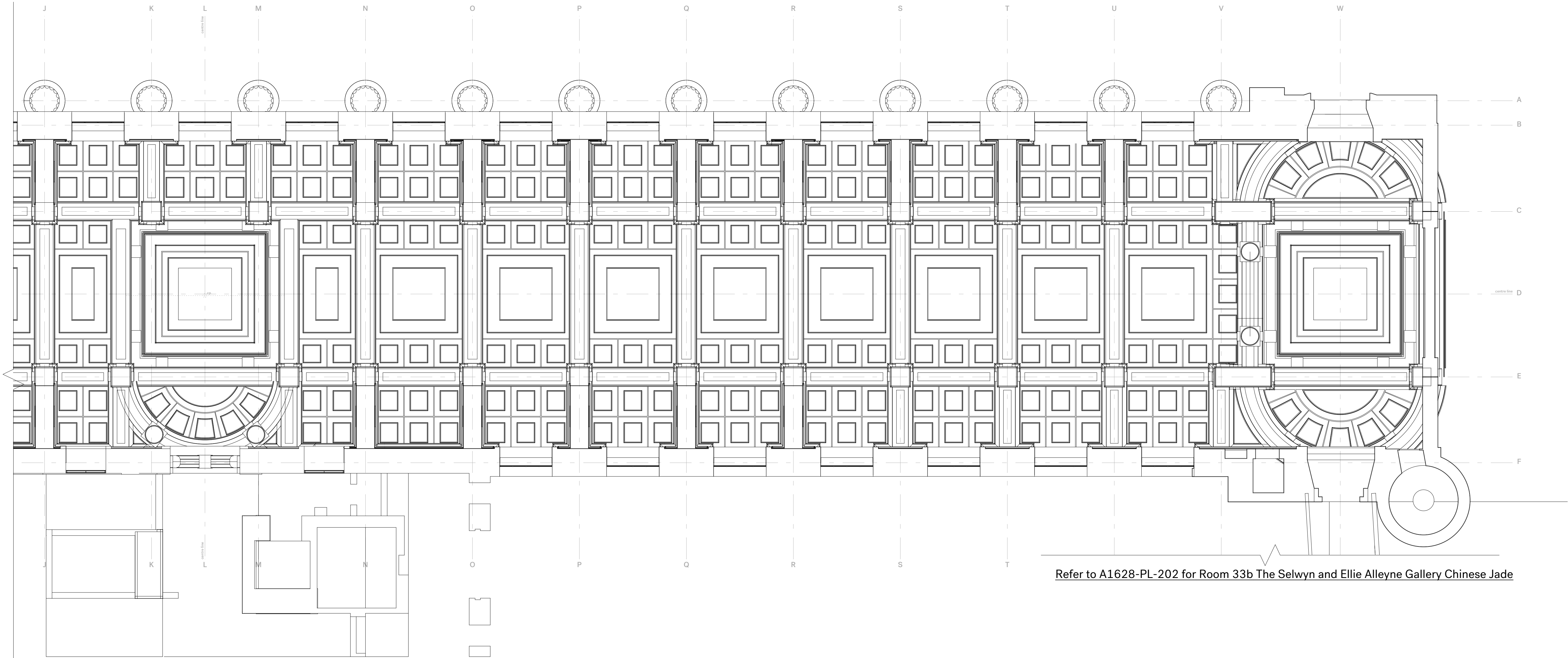

Refer to A1628-PL-202 for Room 33b The Selwyn and Ellie Alleyne Gallery Chinese Jade



0m 2m 4m 6m 8m 10m

01: Existing Reflected Ceiling Plan : China Gallery (Level 3)

Rev.	Date	Description	Rev.	Date	Description
-	29.07.16	Submitted for Listed Building Approval.			

Notes:
1. All dimensions in mm.
2. This drawing to be read in conjunction with all relevant contract documents.
3. This drawing to be read in conjunction with all Engineer's and Main contractor/
Sub-Contractor drawings and documentation.
4. Do not scale from this drawing.
5. Report any errors, contradictions, and omissions to the architect as soon as possible.

Key:

Nissen Richards

Unit 5-6 Waterhouse T 020 7870 8899
8 Orsman Road info@nissenrichardsstudio.com
London N1 5QJ www.nissenrichardsstudio.com

Project:	Sir Joseph Hotung Gallery and Selwyn and Ellie Alleyne Gallery Refurbishment
Client:	The British Museum
Title:	Existing Reflected Ceiling Plan: China Gallery, Room 33 (Level 3)
Scale:	1:100 at A1 1:200 at A3
Drawing no:	A1628-PL-131/-