

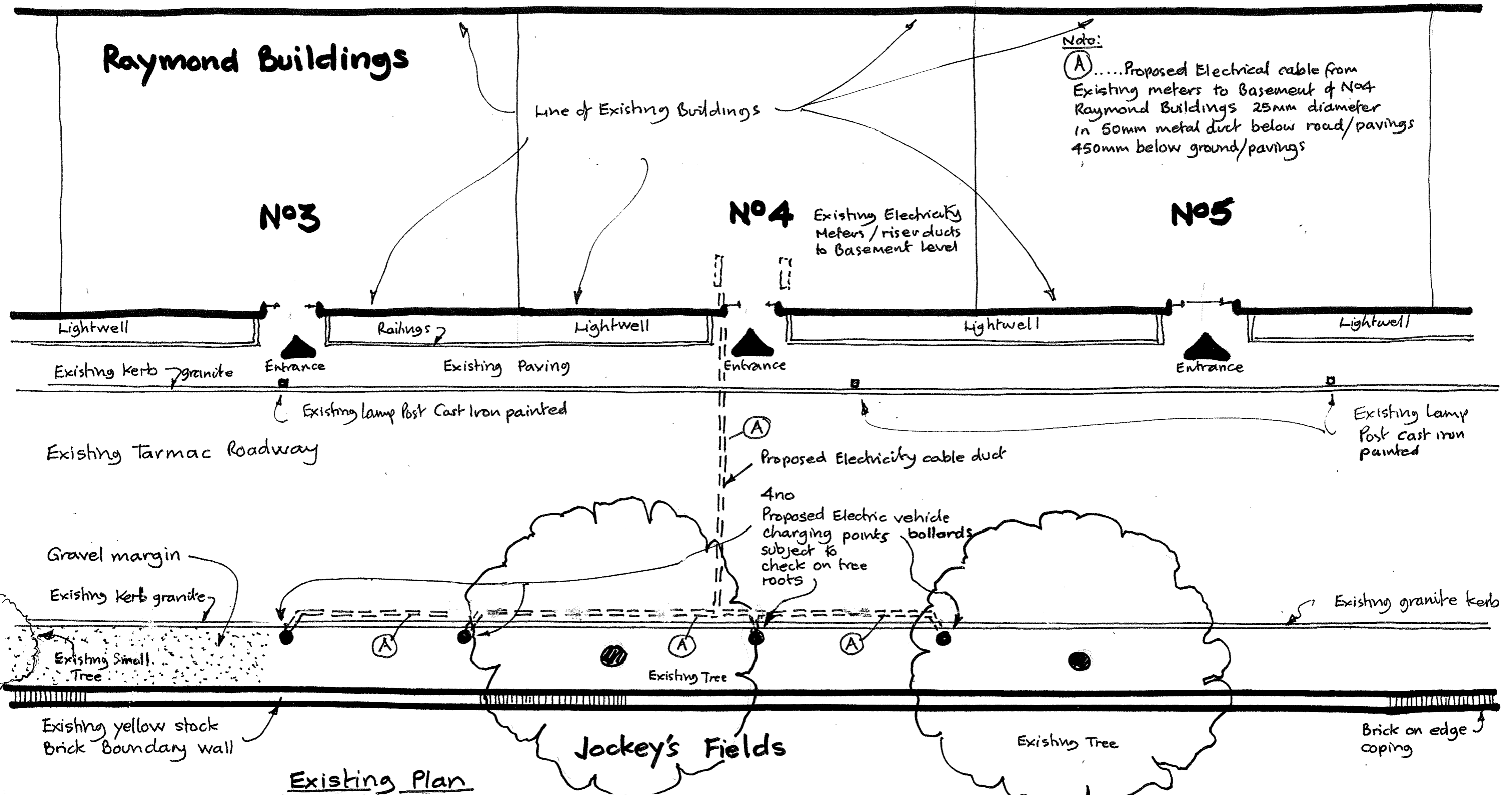

Grays Inn Gardens



Existing Plan
showing proposed Electric Vehicle charging points

Gray's Inn Estate - Proposed Electric Vehicle Charging Points
For The Honourable Society of Gray's Inn.
Proposed Installations opposite Raymond Buildings

GHK ARCHITECTS
Architects · Designers · Historic Building Specialists

530 Fulham Road, London SW6 5NR
Tel: +44 (0)20 7471 8000 mail@ghkarchitects.co.uk
www.ghkarchitects.co.uk

Rev A Plans updated 6 July 2016

Drawing No: HK2209/SK007 Revision A
Scale: 1:100 @ A3
Date: 3rd May 2016
Drawn: CM

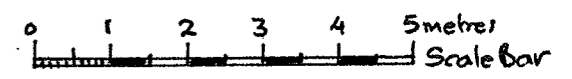

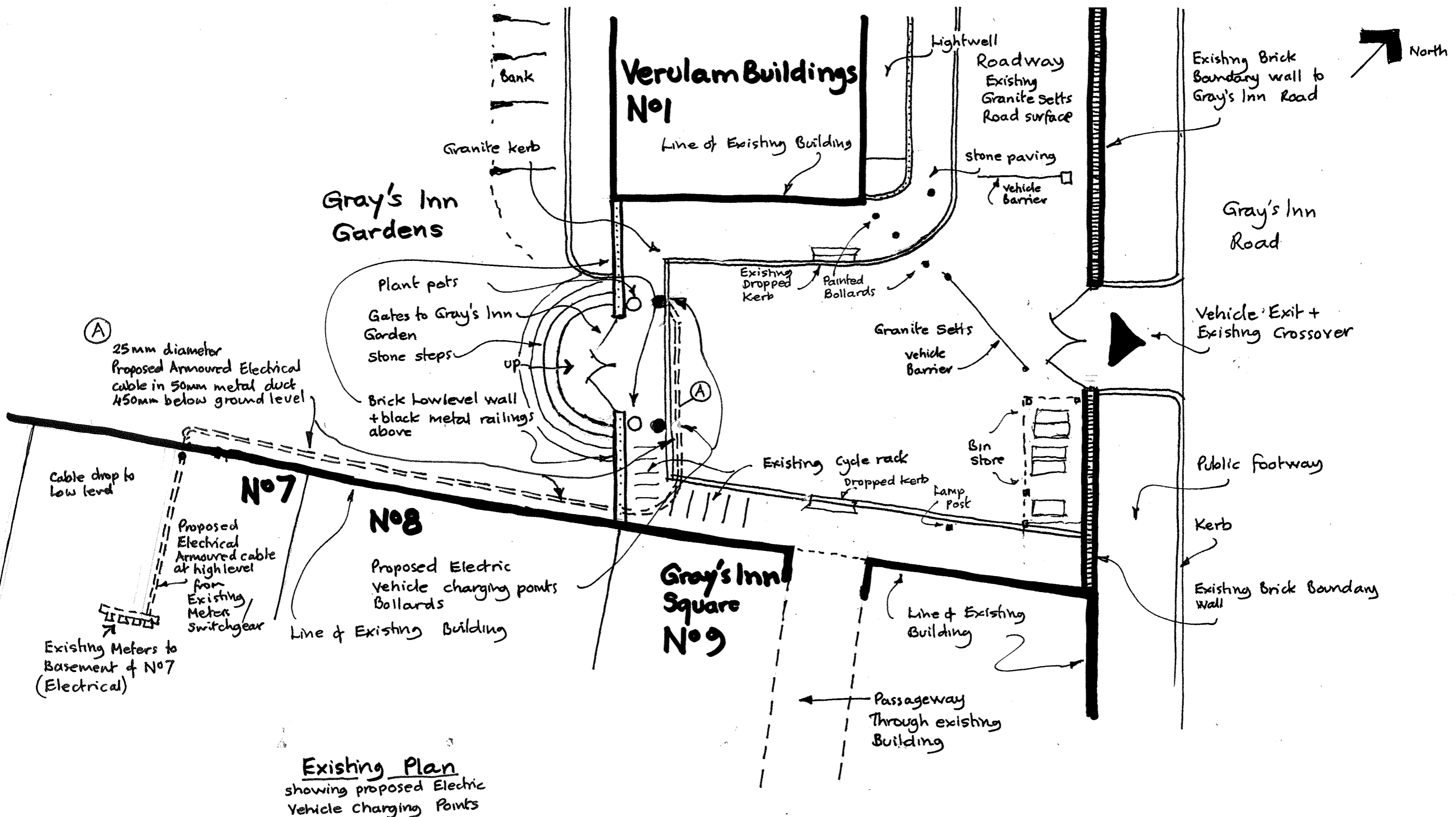

Gray's Inn Estate - Proposed Electric Vehicle Charging Points
 For The Honourable Society of Gray's Inn
 Proposed Installations adjacent to No 1 Verulam Buildings + Existing Plan

GHK ARCHITECTS
 Architects · Designers · Historic Building Specialists

530 Fulham Road, London SW6 5NR
 Tel: +44 (0)20 7471 8000 mail@ghkarchitects.co.uk
 www.ghkarchitects.co.uk

Rev A Plan updated 6th July 2016
 For Bollards

Drawing No **HK2209 / SK008** Revision A
 Scale: 1:100 @ A3
 Date: 3rd May 2016
 Drawn: LM

0 1 2 3 4 5 metres
 Scale Bar

Existing Plan
 showing proposed Electric
 Vehicle charging Points

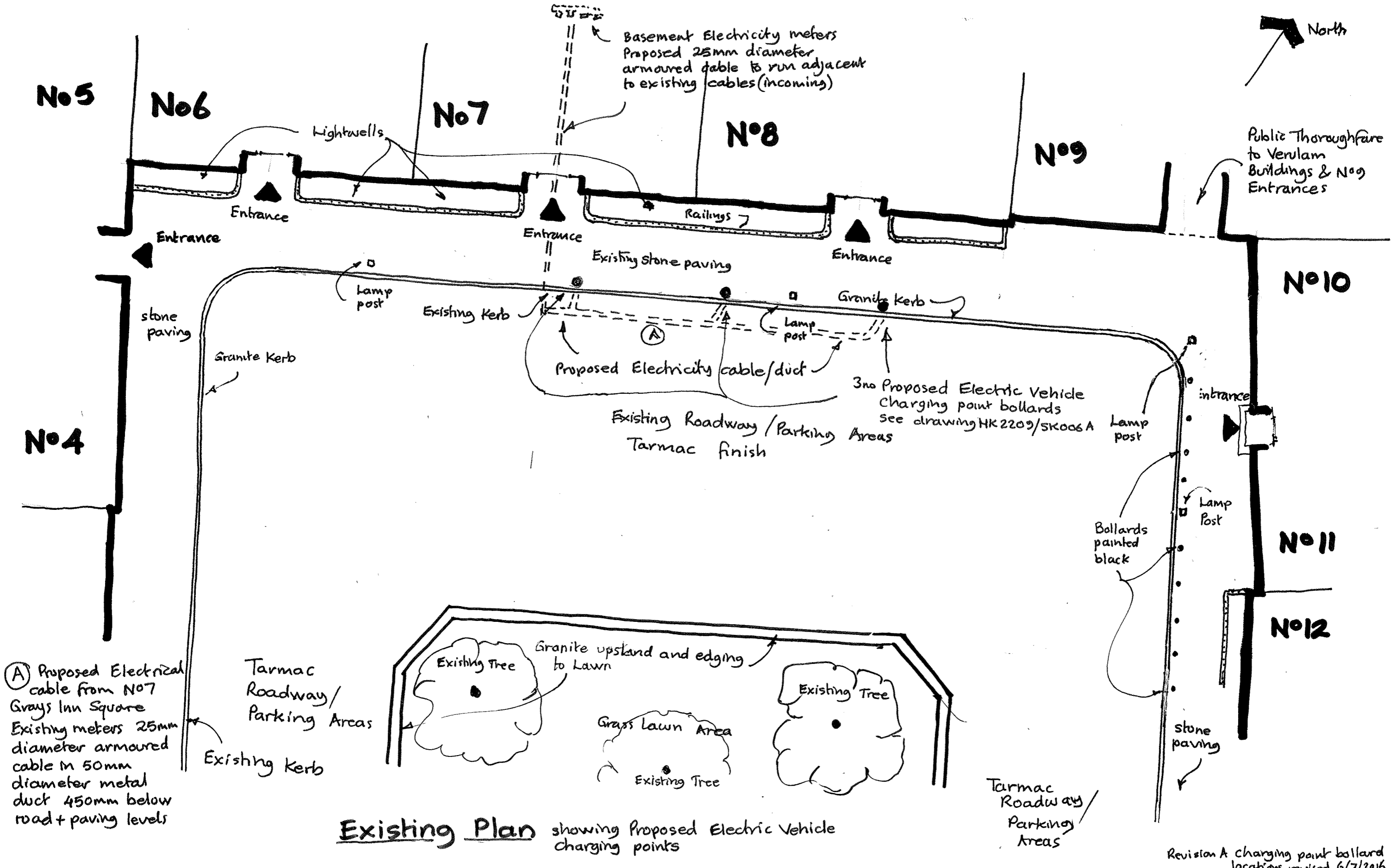

(A) Proposed Electrical cable from No 7 Grays Inn Square Existing meters 25mm diameter armoured cable in 50mm diameter metal duct 450mm below road + paving levels

Existing Plan showing Proposed Electric Vehicle charging points

Revision A charging point bollard locations revised 6/7/2016

Gray's Inn Estate - Proposed Electric Vehicle Charging Points For The Honourable Society of Gray's Inn Proposed Installations Northend Grays Inn Square

GHK ARCHITECTS
 Architects · Designers · Historic Building Specialists
 530 Fulham Road, London SW6 5NR
 Tel: +44 (0)20 7471 8000 mail@ghkarchitects.co.uk
 www.ghkarchitects.co.uk

Drawing No: HK2209/SK009 Revision A
 Scale: 1:100 @ A3
 Date: 3 May 2016
 Drawn LM

Scale Bar

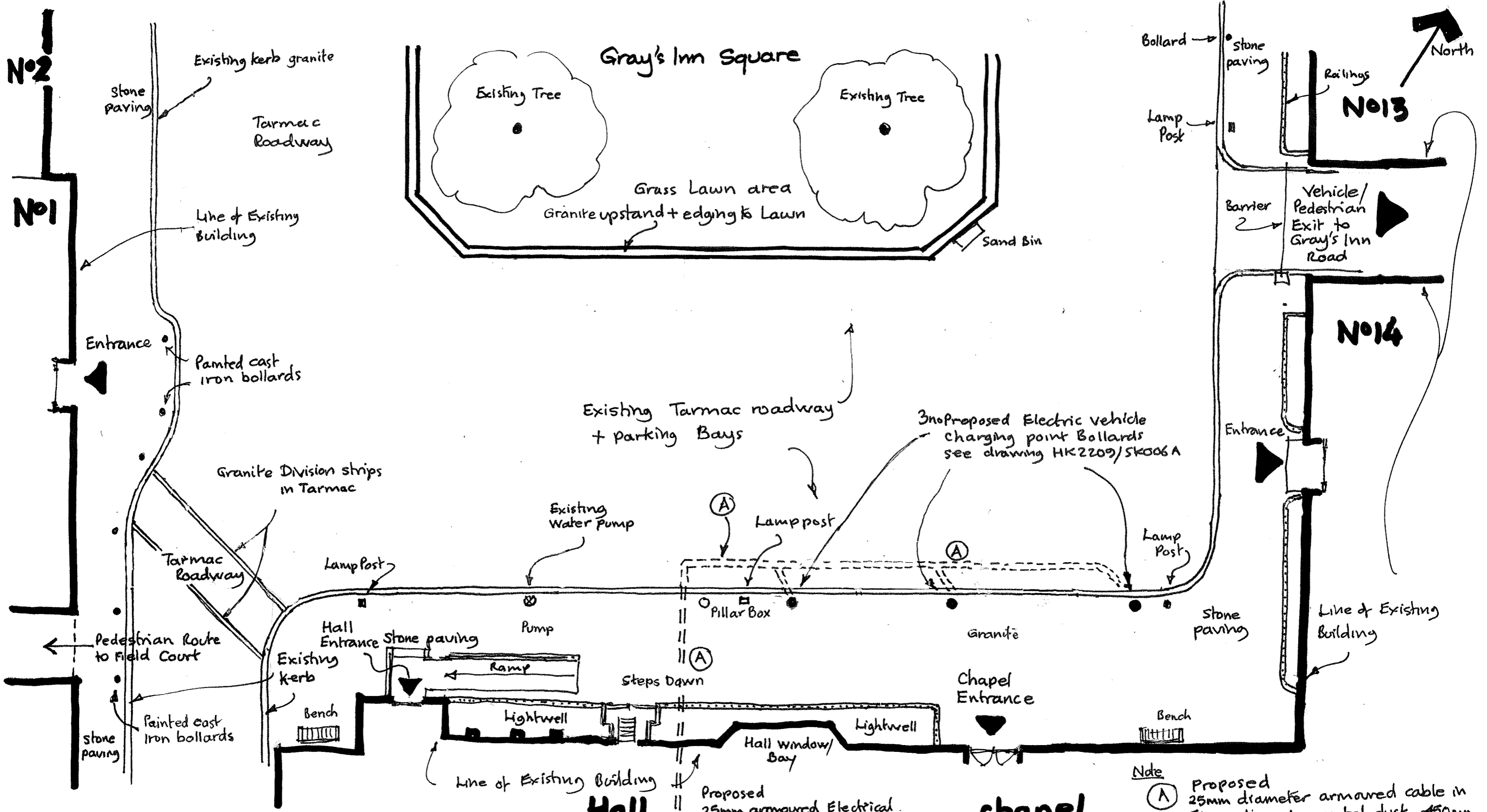

Existing Plan

showing proposed Electric Vehicle charging points

Grays Inn Estate - Proposed Electric Vehicle Charging Points
 For The Honourable Society of Gray's Inn
 Proposed Installations South End Gray's Inn Square + Existing Plan

GHK ARCHITECTS
 Architects · Designers · Historic Building Specialists

530 Fulham Road, London SW6 5NR
 Tel: +44 (0)20 7471 8000 mail@ghkarchitects.co.uk
 www.ghkarchitects.co.uk

chapel

Note
 (A) Proposed 25mm diameter armoured cable in 50mm diameter metal duct 150mm below paving road level to Electric Vehicle charging points

Rev A charging point bollard locations revised 6 July 2016

Drawing No: **HK 2209 / SK010** Revision A
 Scale: 1:100 @ A3
 Date: 3rd May 2016
 Drawn: LM

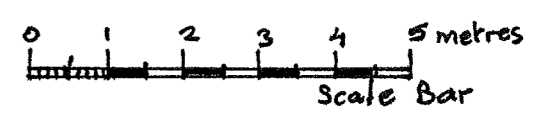

For Continuation see Drawing
HK2209/SK012



South Square

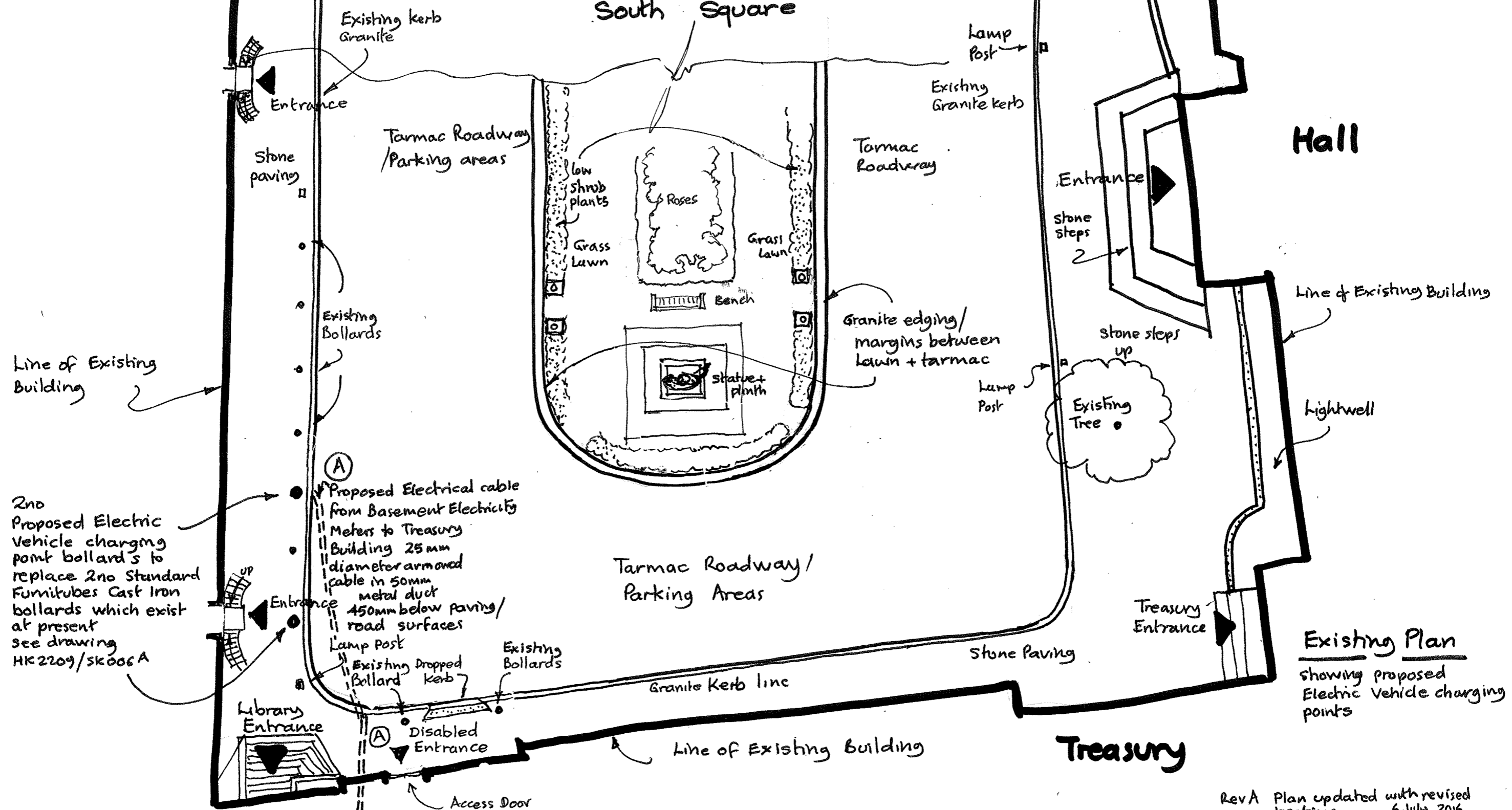

2no Proposed Electric Vehicle charging point bollards to replace 2no Standard Funitubes Cast Iron bollards which exist at present see drawing HK2209/SK006A

Proposed Electrical cable from Basement Electricity Meters to Treasury Building 25mm diameter armoured cable in 50mm metal duct 450mm below paving/road surfaces

Existing Plan showing proposed Electric Vehicle charging points

Gray's Inn Estate - Proposed Electric Vehicle charging Points For The Honourable Society of Gray's Inn Proposed Installations South Side of South Square + Existing Plan

GHK ARCHITECTS
Architects · Designers · Historic Building Specialists
530 Fulham Road, London SW6 5NR
Tel: +44 (0)20 7471 8000 mail@ghkarchitects.co.uk
www.ghkarchitects.co.uk

Treasury

Rev A Plan updated with revised locations 6 July 2016

Drawing No HK2209/SK011 Revision A
Scale: 1:100 @ A3
Date: 3rd May 2016
Drawn: CM





Hall

Line of Existing Wall

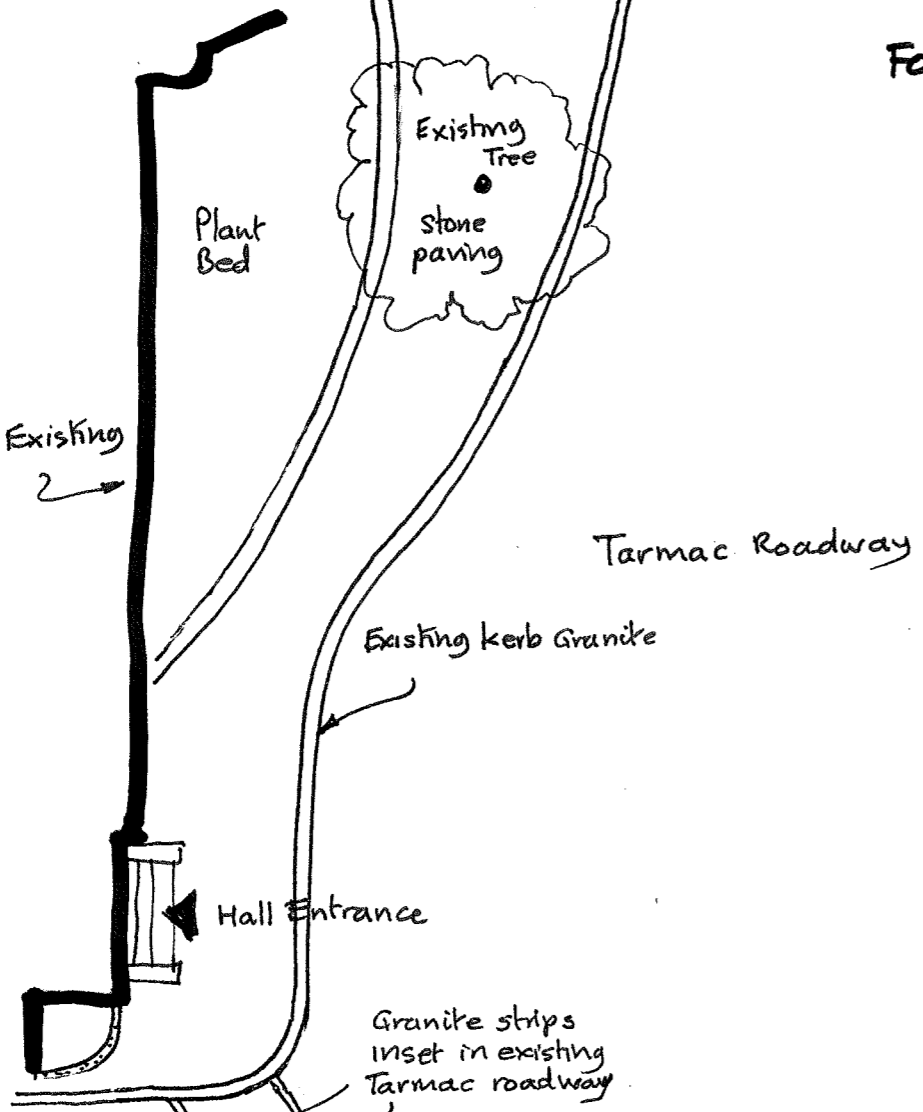

For Continuation see HK2209/SK011 Rev A

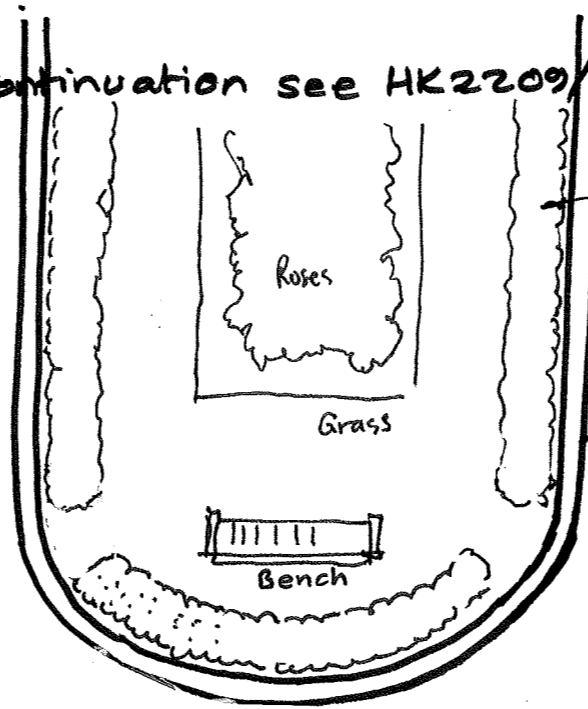

Low shrub planting
Existing Granite kerb
Granite margin between Roadway + planting

Nos 2-4

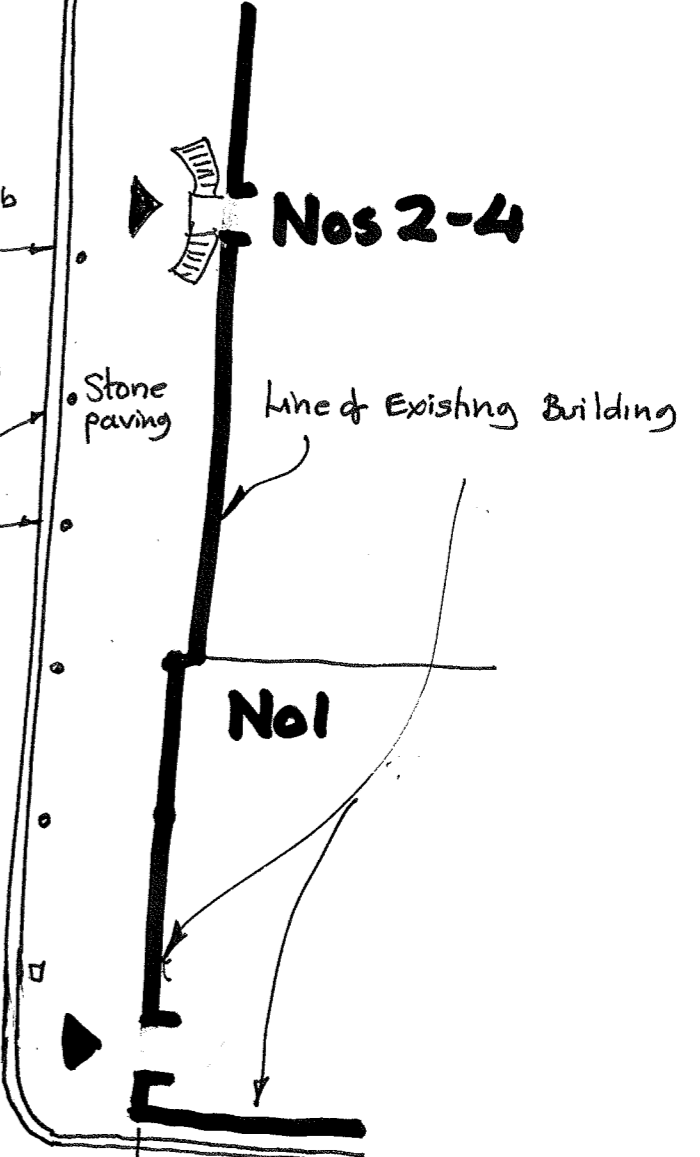

No 1

4 no Proposed Electric Vehicle Charging Point Bollards see drawings HK2209/SK006 A
A Proposed Electrical cable duct fed from Switch Room at Basement level 25mm diameter armoured cable in 50mm duct, 450mm below road/paving level

To Gray's Inn Square

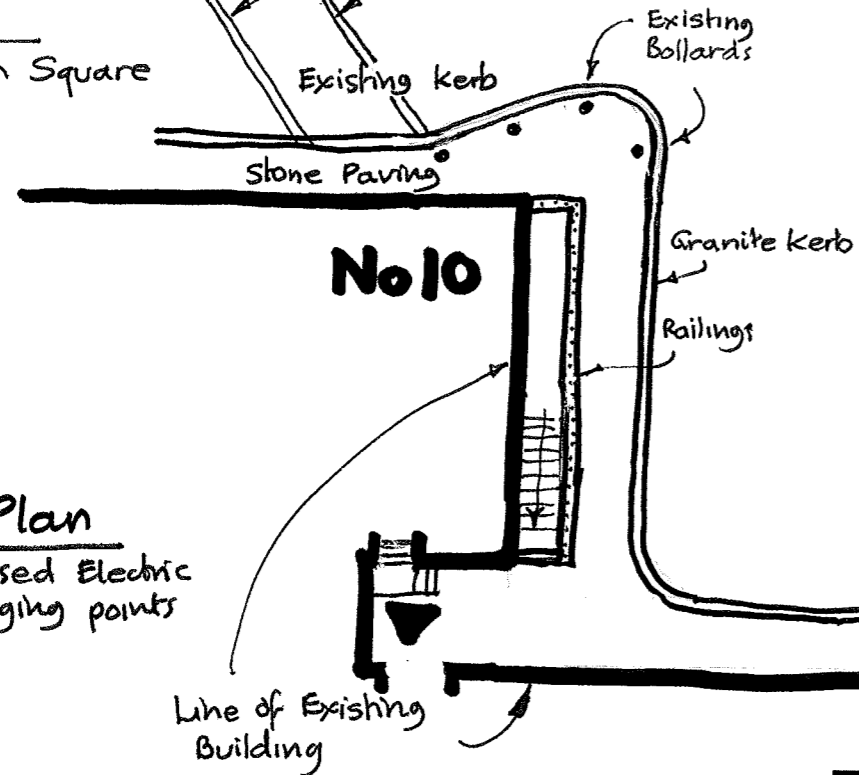

No 10

Tarmac Parking Area

Entrance

No 14

Archway above Road-tarmac

Existing Plan showing proposed Electric Vehicle charging points

Line of Existing Building

No 11 + 12

Proposed Bollard charging points revised 6 July 16
Rev A

Gray's Inn Estate - Proposed Electric Vehicle Charging Points
For The Honourable Society of Gray's Inn
Proposed Installations West End of South Square + Existing Plan

GHK ARCHITECTS
 Architects · Designers · Historic Building Specialists

530 Fulham Road, London SW6 5NR
 Tel: +44 (0)20 7471 8000 mail@ghkarchitects.co.uk
 www.ghkarchitects.co.uk

Drawing No HK 2209/SK012 Revision A
Scale: 1:100 @ A3
Date: 3rd May 2016
Drawn LM

