



# ARBORICULTURAL METHOD STATEMENT

---

Erection of new single-storey dwelling house with basement/s, on land to the rear garden of No. 81 Fitzjohn's Avenue, with access off Ellerdale Road (Class C3)

**Author:**  
**Robert C Yates**  
**July 2016**

Planning Ref. **2015/7036/P**

**This document is to be read in conjunction with the Construction Management Plan provided by Charles Edward Ltd (main contractor)**

## **SITE SPECIFIC ARBORICULTURAL METHOD STATEMENT**

This statement is made subject to the provisions of the Construction (Design and Management) Regulations 2015 (CDM 2015)

To be familiar to all site operatives and placed in a visible position for reference for the duration of the project

Any plans referred to in this statement shall be available to all site operatives – The Tree Protection Plan forms appendix 1 to is statement

**NO SIGNS, CABLES, FIXTURES OR FITTINGS OF ANY OTHER DESCRIPTION SHALL BE ATTACHED TO ANY PART OF A RETAINED TREE**

**IF IN DOUBT – ASK THE ARBORICULTURIST OR SITE MANAGER**

<b>Site address</b>	Land to the rear garden of No. 81 Fitzjohn's Avenue, with access off 1, Ellerdale Road
<b>Planning application No. Decision notice Ref.</b>	2015/7036/P
<b>Local Planning Authority (LPA)</b>	London Borough of Camden
<b>Main contractor: Name &amp; contact number</b>	Charles Edward Ltd 01622 712810
<b>LPA tree officer: Name &amp; contact number</b>	John Malet-Bates 02079745826
<b>LPA planning case officer: Name &amp; contact number</b>	Elaine Quigley 02079745826
<b>Planning Consultant: Name &amp; contact number</b>	Phillips Planning Services Ltd 01234 272829
<b>Project Arboriculturist</b>	Robert C Yates 01604 581044 or 07801 183677
<b>Site manager: Name &amp; contact number</b>	tbc
<b>Tree protection measures monitoring &amp; supervision</b>	<ol style="list-style-type: none"><li>1. The site manager to make a daily inspection of tree protective measures to ensure continuing compliance.</li><li>2. Work force to be monitored during works to ensure method statement is complied with.</li><li>3. Erection of temporary protective fencing to be checked for conformity by project arboriculturist prior to commencement, and at relevant stages during site works</li></ol>

<b>Pre-development tree surgery &amp; felling</b>	Not applicable
<b>Tree works during build</b>	This should not be necessary, but if so, must be in accordance with guidance/approval from the local planning authority and in consultation with the project arboriculturist.
<b>Site access</b>	Off highway (Ellerdale Road)
<b>Contractors' parking</b>	<b>For demolition phase :</b> n/a
	<b>For construction phase :</b> On highway
<b>Materials storage</b>	See Construction Management Plan
<b>Mortar mixing / washing</b>	Materials which may contaminate the soil, e.g. concrete mixings, diesel oil and vehicle washings, must not be discharged within 15 metres of ANY tree stem or water course
<b>Fires</b>	Not permitted
<b>Site huts / toilets</b>	See Construction Management Plan
<b>Demolition</b>	Sections of boundary party wall to 81 & 83 Fitzjohn's Avenue
<b>Ground Works within Root Protection Area (RPA) of retained trees</b> [see tree protection plan]	<ul style="list-style-type: none"> <li>• Excavation to approx. 1 metre below existing ground level</li> <li>• Piling operations</li> <li>• Timber retaining wall &amp; paving</li> </ul>
<b>Underground service runs, external lighting, surface water, foul drainage, gas &amp; electricity etc.</b>	In accordance with National Joint Utilities Group (NJUG) volume 4 issue 2 – A copy of this has been provided for use by site operatives and is to be clearly displayed in the site office
<b>Levels changes</b>	Excavation of ground up to approx. 1 metre depth / basement construction in excess of 7.5 metres
<b>Space for cranes</b>	Not available on site / possibly on highway



<b>Temporary Barriers/Fencing</b>	See attached specification P.6 for temporary protective fencing for trees
<b>WARNING! notices</b>	<ul style="list-style-type: none"> <li>• One weather proof sign of at least 600 x 600mm at site entrance, stating <b>“Tree Protection Measures in force on this work site – obtain further details from site manager on arrival”</b></li> <li>• Weather proof signs of at least 200 x 300mm fixed to tree protection fencing at 7m intervals, stating <b>“Tree Protection Area – No Admittance! “</b></li> </ul>
<b>Ground protection [temporary]</b>	Temporary tree protection fencing – See P.6 & Tree Protection Plan
<b>Ground Protection [permanent]</b>	Not applicable
<b>Additional precautions</b>	<ul style="list-style-type: none"> <li>• Root severance and remedial treatment, where required, is to be supervised by the appointed arboriculturist</li> <li>• The use of high lift mobile equipment e.g. cranes, will be undertaken with extreme care; operators of such equipment will be briefed by the site manager or arboriculturist, regarding the risk of damage to retained trees, and a banksman will be deployed to oversee the lifting/moving of large or particularly awkward loads</li> </ul>
<b>Hard surfaces</b>	No special requirements
<b>Soft surfaces &amp; landscaping</b>	Planting area to be protected by tree protection fencing until completion of all construction works
<b>Removal of protection</b>	Only at the stages specified in build sequence above.
<b>Aftercare</b>	<ul style="list-style-type: none"> <li>• Routine tree inspection and work recommended where necessary.</li> </ul>

## TEMPORARY TREE PROTECTION FENCING – SPECIFICATION

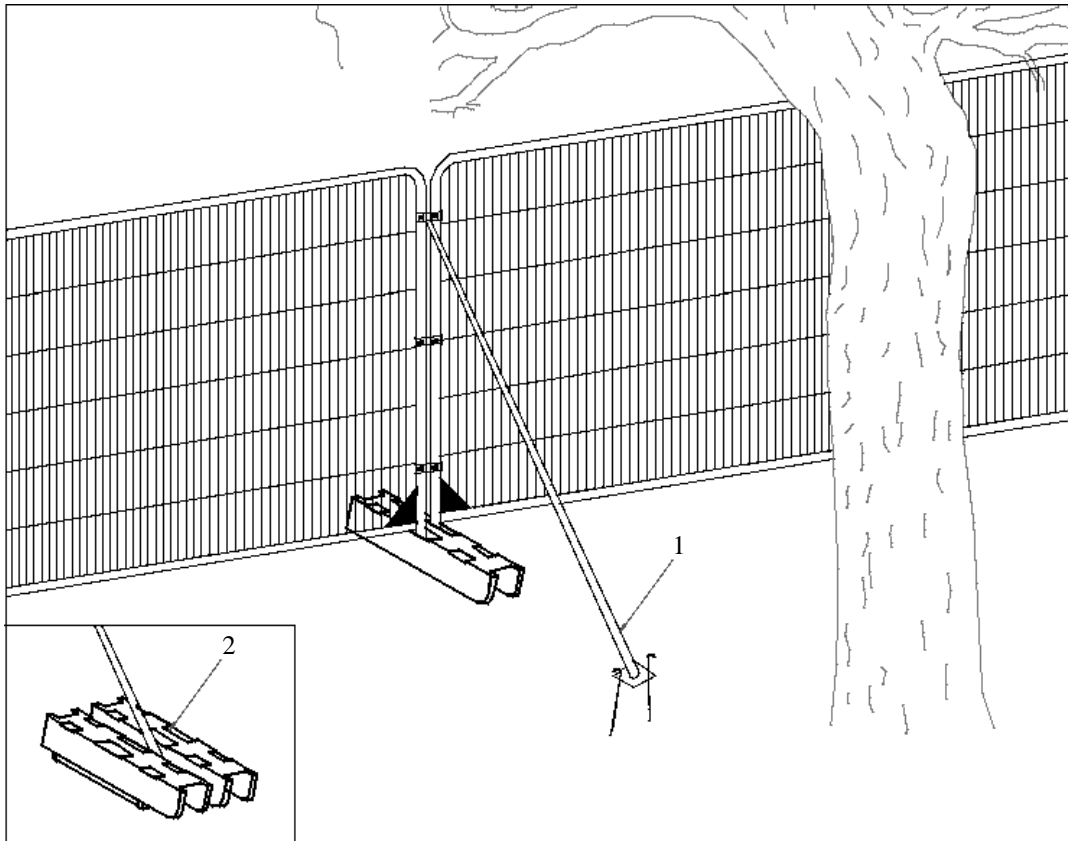

Alternative above ground stabilising systems for use with 2m high Heras™ type fence panels

1. Stabiliser strut with base plate secured with ground pins
2. Stabiliser strut mounted on block tray – only to be used where ground pins cannot be used e.g. on existing hard surfacing

**Page reserved for Site notes / Inspection schedule**

Purpose of visit	Comments	Date	Signed

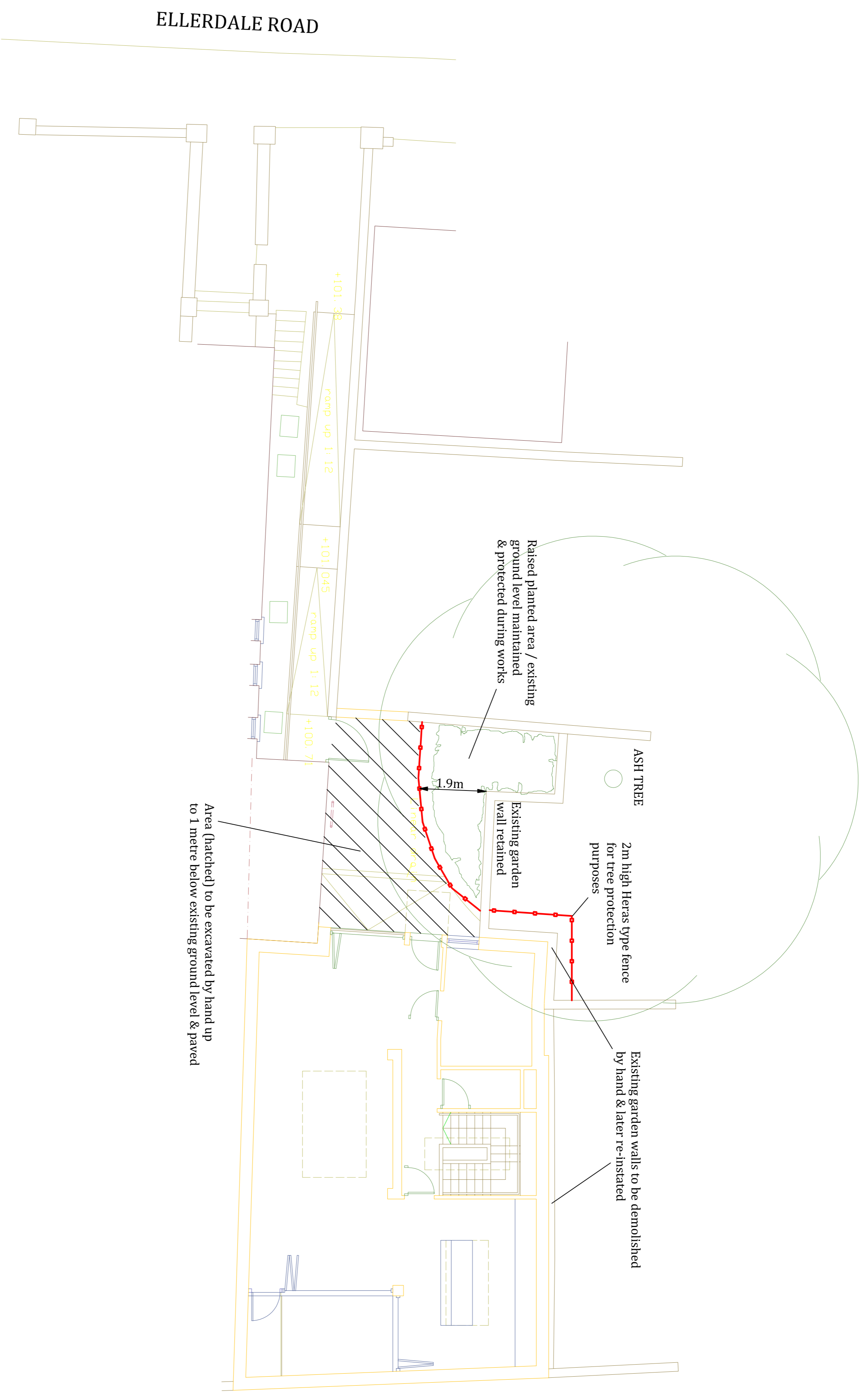

**TREE PROTECTION PLAN (Ground Floor Level)**

**Fig. 1. Specification for temporary tree protection fencing for retained trees**

Above ground stabilising systems for use with 2m high Heras® type fencing

1. Stabiliser strut with base plate secured with ground pins
2. Stabiliser strut mounted on block tray - for use only where ground pins cannot be used

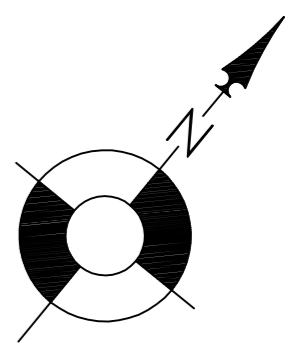
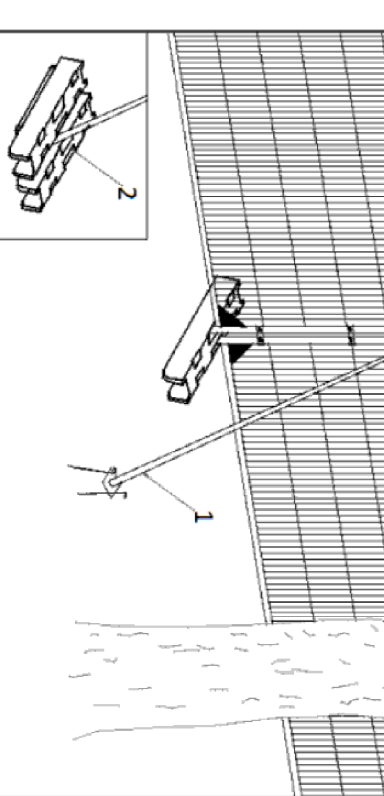

THIS TREE PROTECTION PLAN RELATES TO APPROVED PLANNING APPLICATION No.2015.6843.P GARDEN HOUSE TO REAR OF 1, ELLERDALE ROAD, LONDON

IT MUST BE READ IN CONJUNCTION WITH THE ARBORICULTURAL METHOD STATEMENT TO WHICH IT FORMS APPENDIX 1 AND THE CONSTRUCTION MANAGEMENT PLAN FROM CHARLES EDWARD LTD

Revisions:

**RG&S**  
**Arboricultural Consultants**  
 52 Milway, Northampton NN56ES  
 Tel: 01604 581044  
 Email: info@rgs-reeservices.co.uk

Site:	Land of: 1, Ellerdale Road / 81 & 83 Fitzjohn's Avenue		
Client:	Charles Edward Ltd		
Survey Description:	Tree Protection Plan		
Date:	July 2016	Scale:	1/100
Dwg. No:	Appendix 1	Surveyor:	RR
Sheet:	1 of 1	Checked:	



NJUG Guidelines for the Planning, Installation and Maintenance of Utility Apparatus in Proximity to Trees – Issue 2

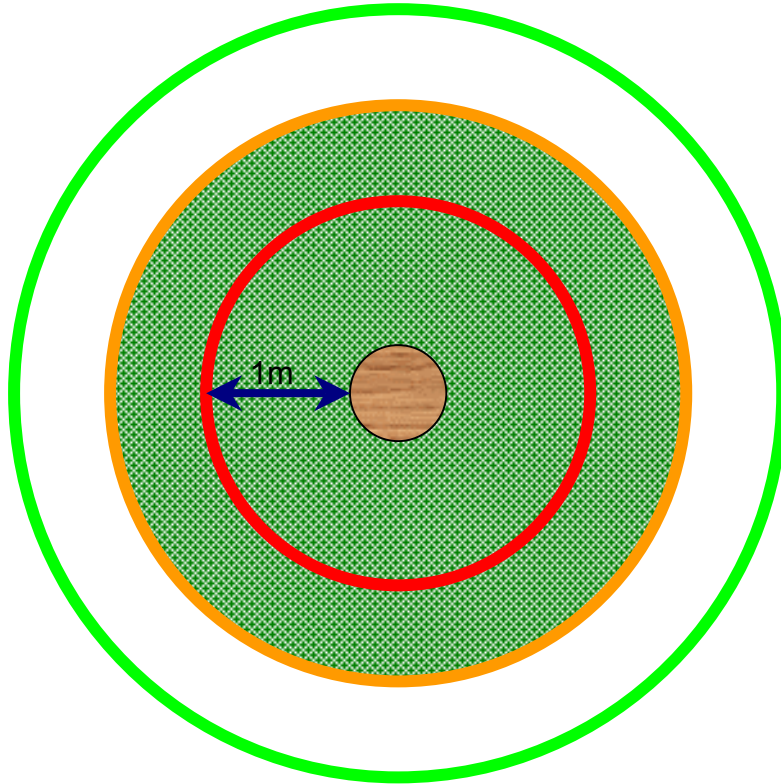

**TREE PROTECTION ZONE**

Key to Diagram



Trunk of Tree

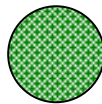

Spread of canopy or branches



**PROHIBITED ZONE – 1m from trunk.** Excavations of any kind must not be undertaken within this zone unless full consultation with Local Authority Tree Officer is undertaken. Materials, plant and spoil must not be stored within this zone.



**PRECAUTIONARY ZONE – 4 x tree circumference.** Where excavations must be undertaken within this zone the use of mechanical excavation plant should be prohibited. Precautions should be undertaken to protect any exposed roots. Materials, plant and spoil should not be stored within this zone. Consult with Local Authority Tree Officer if in any doubt.



**PERMITTED ZONE – outside of precautionary zone.** Excavation works may be undertaken within this zone however caution must be applied and the use of mechanical plant limited. Any exposed roots should be protected.

## DAMAGE TO TREES

Tree roots keep a tree healthy and upright. Most roots are found in the top 600mm of soil and often grow out further than the tree's height. The majority of these roots are very fine; even close to a tree few will be thicker than a pencil. Most street tree roots grow under the footway but may also extend under the carriageway. If roots are damaged the tree may suffer irreversible harm and eventually die.

## PROTECTING ROOTS - DO'S and DON'TS

There are three designated zones around a tree each of which has its own criteria for working practices.

### THE PROHIBITED ZONE

- Don't** excavate within this zone.
- Don't** use any form of mechanical plant within this zone
- Don't** store materials, plant or equipment within this zone.
- Don't** move plant or vehicles within this zone.
- Don't** lean materials against, or chain plant to, the trunk.
- Do** contact the local authority tree officer or owner of the tree if excavation within this zone is unavoidable.
- Do** protect any exposed roots uncovered within this zone with dry sacking.
- Do** backfill with a suitable inert granular and top soil material mix as soon as possible on completion of works.
- Do** notify the local authority tree officer or the tree's owner of any damage.

### THE PRECAUTIONARY ZONE

- Don't** excavate with machinery. Where excavation is unavoidable within this zone excavate only by hand or use trenchless techniques.
- Don't** cut roots over 25mm in diameter, unless advice has been sought from the local authority tree officer.
- Don't** repeatedly move / use heavy mechanical plant except on hard standing.
- Don't** store spoil or building material, including chemicals and fuels, within this zone.
- Do** prune roots which have to be removed using a sharp tool (e.g. secateurs or handsaw). Make a clean cut and leave as small a wound as possible.
- Do** backfill the trench with an inert granular material and top soil mix. Compact the backfill with care around the retained roots. On non highway sites backfill only with excavated soil.
- Do** protect any exposed roots with dry sacking ensuring this is removed before backfilling.
- Do** notify the local authority tree officer or the tree's owner of any damage.

### THE PERMITTED ZONE

- Don't** cut roots over 25mm in diameter, unless advice has been sought from the local authority tree officer.
- Do** use caution if it is absolutely necessary to operate mechanical plant within this zone.
- Do** prune roots which have to be removed using a sharp tool (e.g. secateurs or handsaw). Make a clean cut and leave as small a wound as possible.
- Do** protect any exposed roots with dry sacking ensuring this is removed before backfilling.
- Do** notify the local authority tree officer or the tree's owner of any damage.