

PLANNING ISSUE

Check all dimensions on site. Do not scale off drawings without prior consultation. Any discrepancies to be reported to architects before execution of relevant works. This drawing has been produced for the London Borough of Camden for the development of Netley Primary School, 74 Stanhope Street, NW1 and for that application alone and is not intended for use by any other person or for any other purpose. Drawings remain copyright of Hayhurst and Co. and may not be reproduced without written consent or licence.

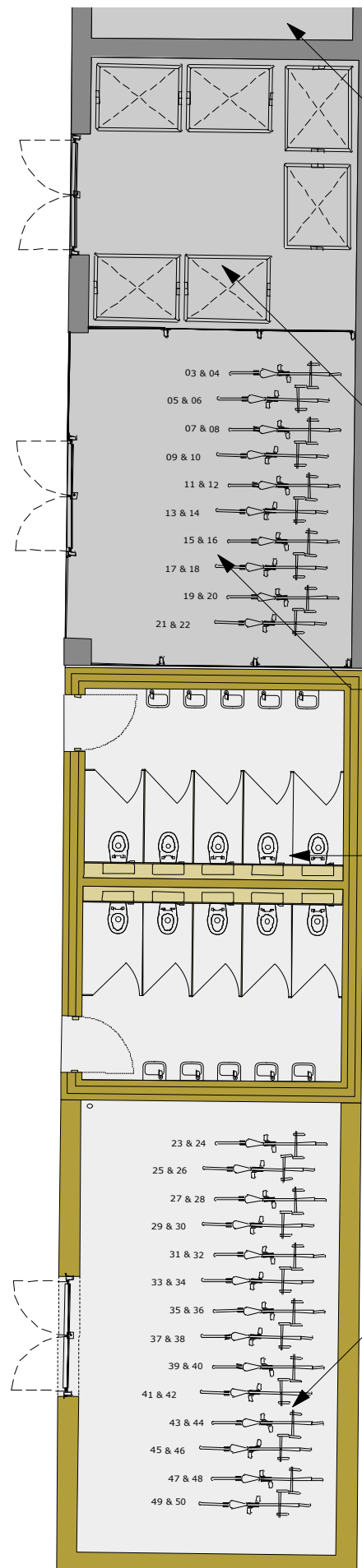
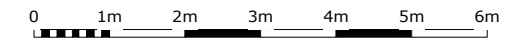

Existing caretakers office

Existing bin store

Existing Storage for 24 Bicycles

New W.C. Building

Future location for additional cycle storage (24 Bicycles) if required - to be determined under separate application to vary the conditions from the CIP project.

Proposed floor plan of new WCs and Cycle Store

Issue/Revision	Date	Rev
Project:		
STEM & 2 Year Old Provision Netley Primary School, 74 Stanhope Street, London, NW1 3EX		
Hayhurst and Co.		
26 Fournier Street, London, E1 6QE T: (020) 7247 7028 F: (020) 7247 7029 E. mail@hayhurstand.co.uk www.hayhurstand.co.uk		
Subject:	Proposed WC & Cycle Store	
Scale:	1:100	Date: 29.07.2016
Original Size:	A3	
Drawing No.:	184 2YO A500	