

PL 020.00 No. 59 St Giles High Street Proposed Basement plan 1:50

New high level kitchen extract transfer to adjacent plant block - location/route to be confirmed following opening up works

New trench below floor finish to accommodate UKPN cables. Floor finish to be reinstated as existing following installation

UKPN room in adjacent building

Shopfront carefully repaired and repainted, glazing replaced, cladding to stalliser and downlights removed

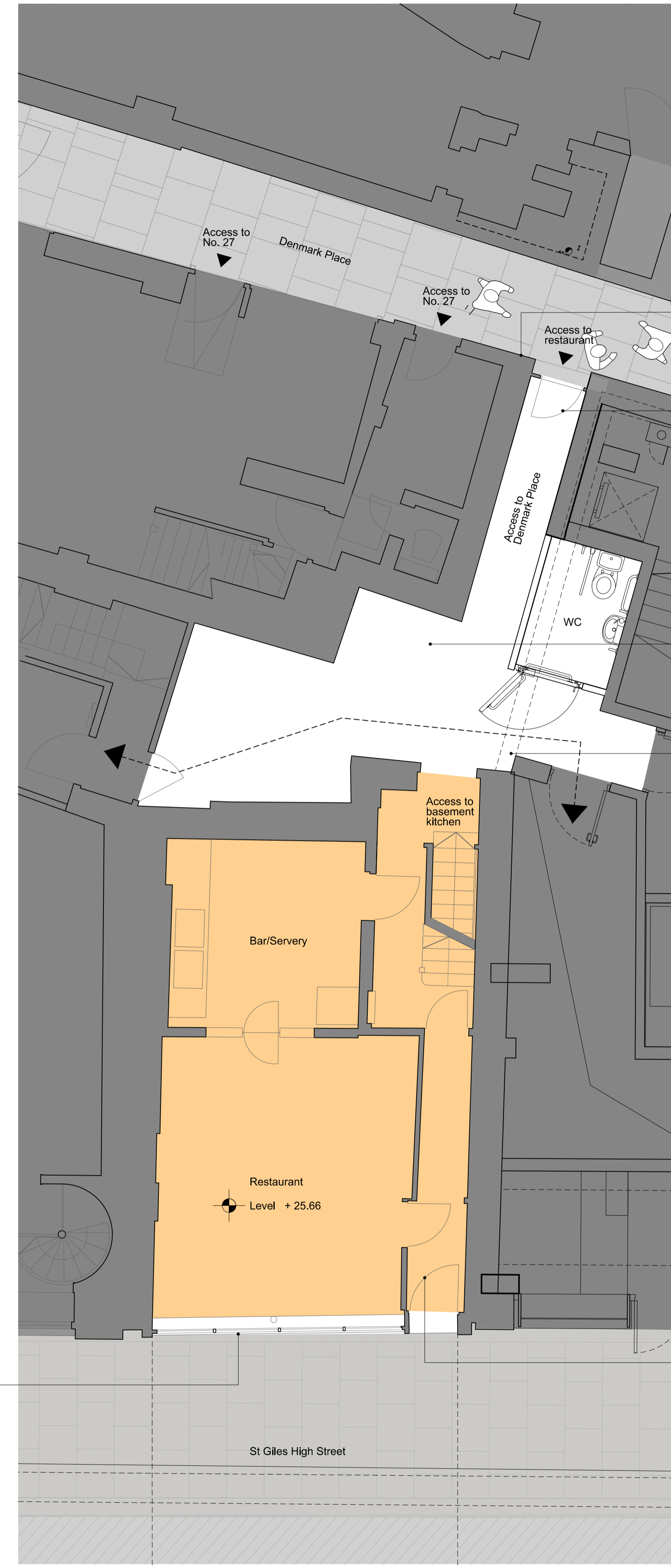

PL 020.00 No. 59 St Giles High Street Proposed Ground Floor plan 1:50

B10 Existing brickwork to be water washed by hand, pointing carefully raked out, masonry repaired where required with matching reclaimed bricks. Repointing in lime mortar with flush joints

D08 New tongue & groove timber door

New Part M compliant WC

New access formed to link plant areas

D02 New period door to match shop front with glazed fanlight

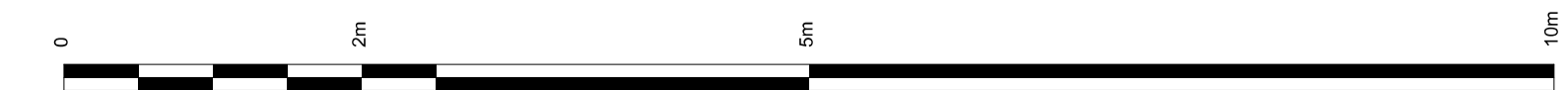

Notes: All internal furniture layouts are indicative only.

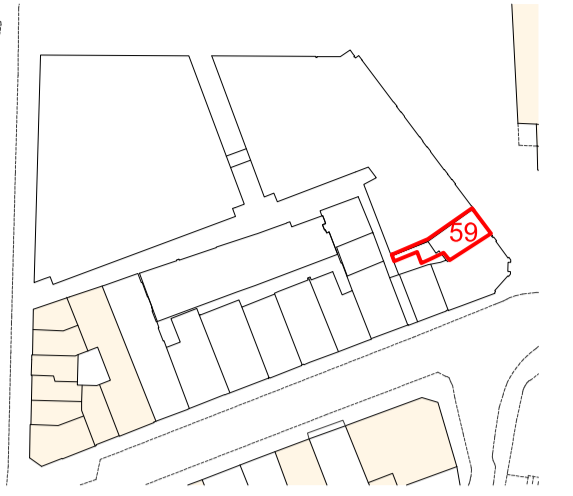

Layouts presented for reference only
No works proposed

- SVP
- Kitchen/Bathroom Extract
- RWP

P1 28.07.16 Issued for Planning
14.12.12 Issued for Planning

FOR PLANNING

Revision:

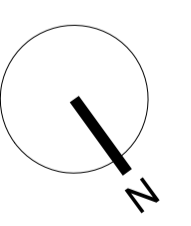

ORMS
Architecture Design

1 Pine Street London EC1R 0JH
T 0207 833 8533 F 0207 837 7575
E orms@orms.co.uk

Project ST GILES CIRCUS

Drawing title No. 59 St Giles High Street Proposed Basement & Ground Floor plans

Scale 1:50 @ A1 Drwg. No. 1793PL020-00

Date August '12 Rev. P1

Status For information For tender For construction

Do not scale. All dimensions to be confirmed on site. Information contained in this drawing is the sole copyright of ORMS Designers & Architects Ltd. and is not to be reproduced without permission.