

01 PROPOSED LONG SECTION DD

02 PROPOSED LONG SECTION EE

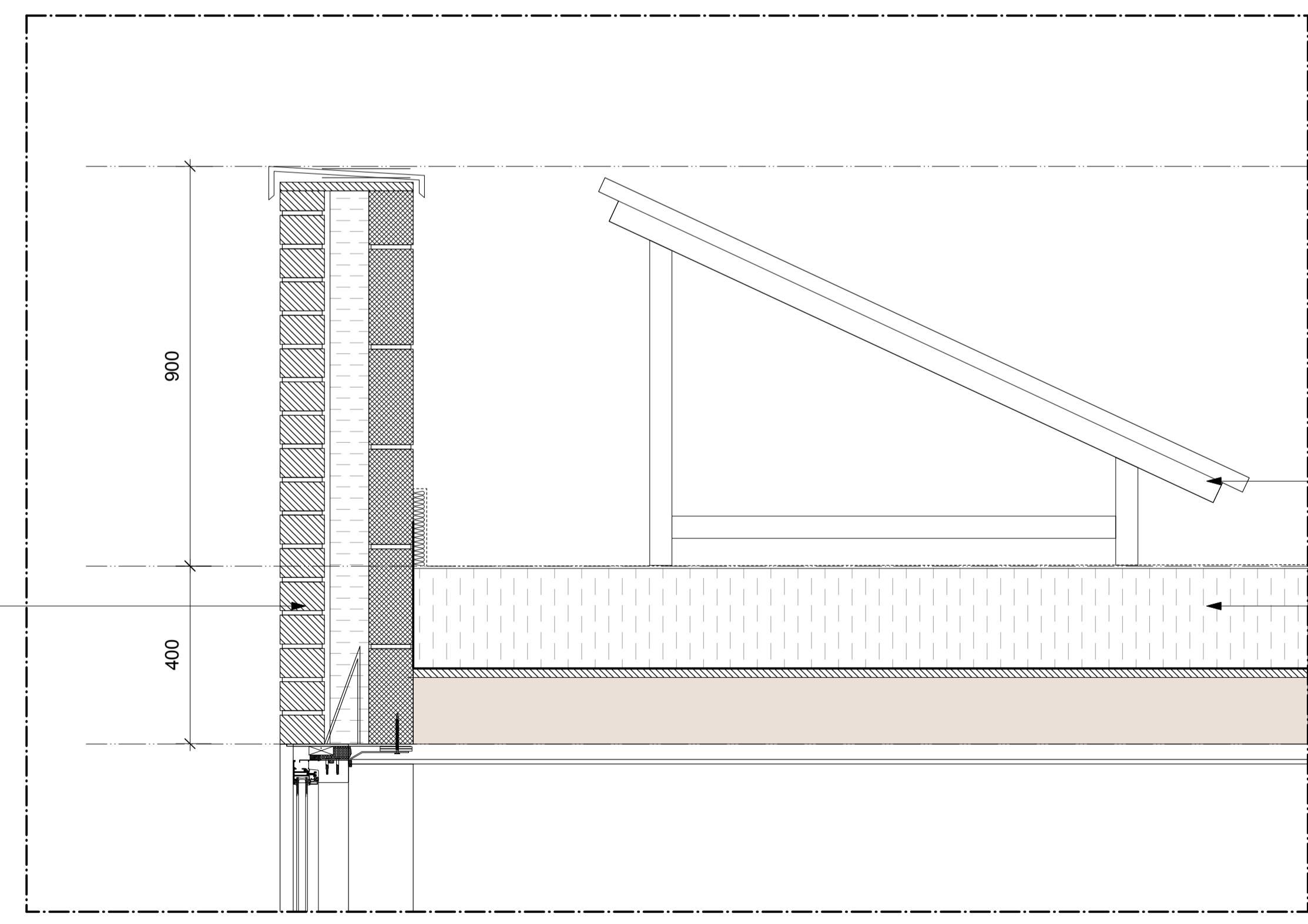

Parapet Wall
Alumasc Skyline Aluminium Profile Coping in Anthracite Grey RAL 7016
100mm London Stock Brick to match existing
100mm XtraTherm Full Fill Cavity Insulation
100mm lightweight block
Insulated Catnic lintel to window head
Dark grey aluminium faced slimline window
Velfac 200 or similar approved

Solar Hot Water
1 no 30 tube solar water heater
Kingspan Thermomax HP400
1930x2150mm installed to 45° pitched roof as shown
to provide 70% of annual hot water consumption

Solar Photovoltaic Panels
12 no 245W Panasonic HIT PV Panels
each panel is mounted at max 25° sloping mount
set below 900mm parapet wall
Panels are oriented 38° south south west
Each panel is 1600x850mm
Total installation output 3kW

Flat roof build up
Sarnafil single ply membrane
150-225mm Kingspan ThermaTaper TT46 LPC/FM
Dupont AVCL vapour control layer on
18mm marine plywood deck on
100x150mm C16 rafters [400mm centers max.]
35mm softwood batten
Ceiling 9.8m plasterboard and 3mm skim

03 PROPOSED SEDUM ROOF DETAIL
SCALE 1:10 @ A1

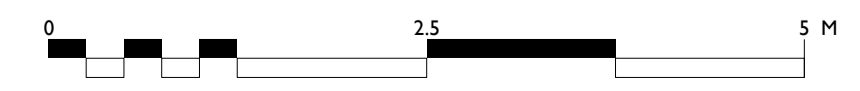

Mador & Partners Chartered Architects Ltd.

Studio 102
1 Thane Villas
London N7 7PH

telephone 0207 281 5550
fax 0207 272 3959

PLANNING

3 Whitcher Place		Project	
Proposed House Sections and roof detail		Drawing	
1:50 at A1	scale	July 2016	date
172	job P-06	no.	revision LK
			drawn