

The design to which this drawing relates is protected by Copyright. In addition, certain aspects of the design and certain parts thereof are protected by Design Right. Unlicensed copying of this drawing in any form is expressly forbidden. This drawing is provided on the basis that it may not be copied or reproduced in any form without the express permission or licence from the Copyright holder and/or the owner of the Design Right (if different).

Copyright and/or Design Right licences may be obtained upon application to: (Formpave Limited).

Formpave Limited are the proprietors of a number of British and foreign patents one or more of which may be incorporated in the design shown in this drawing.

 FORMPAVE RECTANGULAR AQUAFLOW BLOCKS IN PARKING AREA

 FORMPAVE RECTANGULAR AQUAFLOW BLOCKS WITH LEVEL SUB-FORMATION. (FOR FORMATION DETAILS REFER TO DRAWING FSC3649-D100)

 AREA OF CATCHMENT INCLUDED IN DESIGN

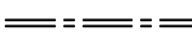
 FULL HEIGHT RESTRAINT

 FIN DRAIN WITH 110mm OUTLET PIPE

 AMENDED PROPOSED LEVELS
 PROPOSED INVERT LEVELS

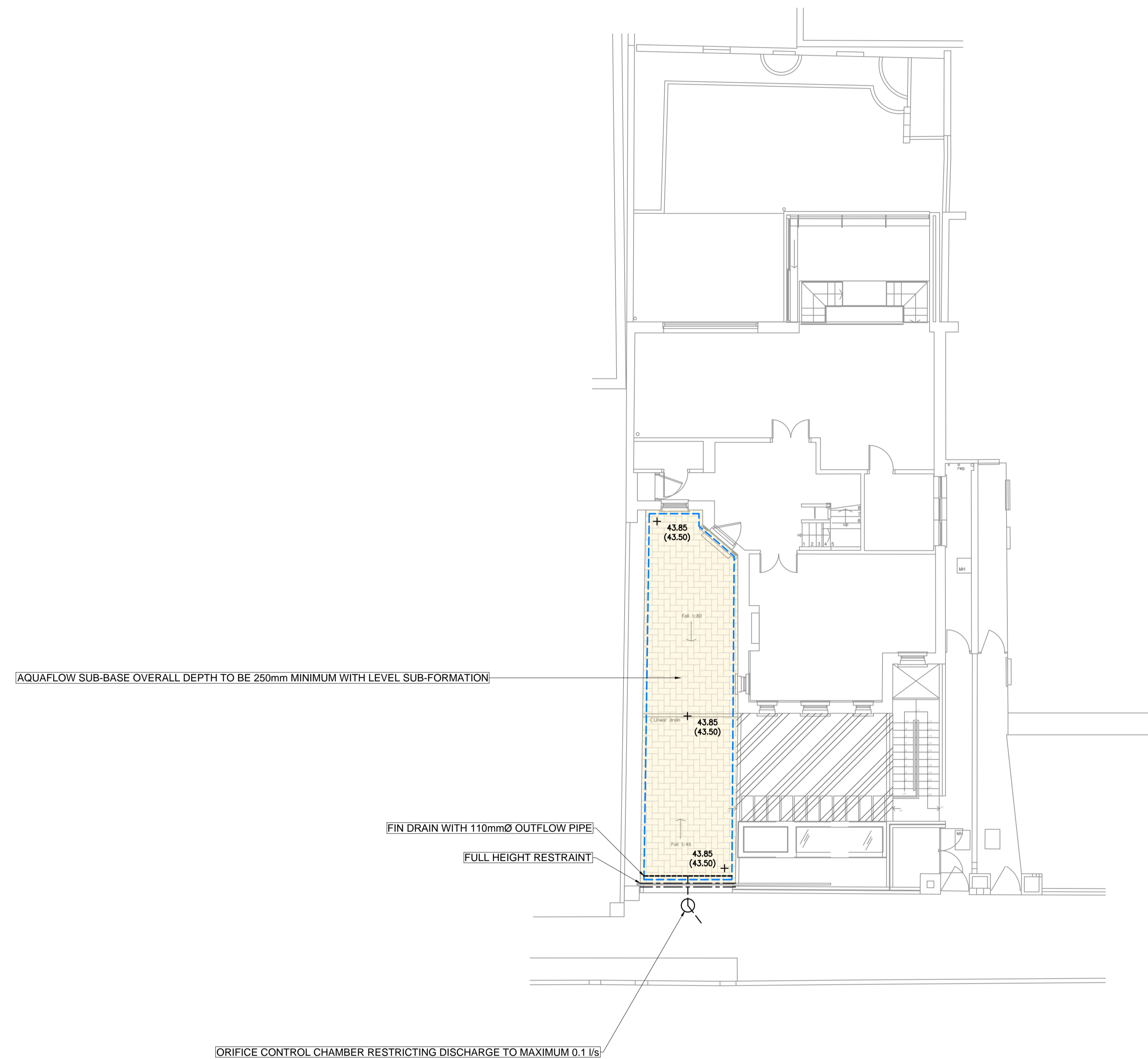

NOTES:

- FOR CONSTRUCTION AND FORMATION DETAILS REFER TO DRAWING FSC3649-D100
- DRAINAGE RUNS SHOWN FOR INDICATIVE PURPOSES ONLY - TO BE DESIGNED BY OTHERS.
- LOWER FORMATION LOCALLY WHERE REQUIRED TO SUIT INVERT OF DISTRIBUTION BOXES

-	First Issue	TU	18.07.2016
Rev. No.	Revision	Drawn By	Date

Formpave®
INNOVATORS IN PERMEABLE PAVING

Quality concrete paving products

Formpave
Tuffhorn Avenue, Coleford,
Gloucestershire, GL16 8PR
Tel: 01594 836999
Fax: 01594 810577
E-mail: design.services@formpave.co.uk
forterra.co.uk/formpave



Project
7 GREVILLE PLACE
KILBURN, LONDON. NW6 5JP

Title
AQUAFLOW PERMEABLE PAVING LAYOUT
FOR PARKING AREA

Scale	Date	Drawn	Checked	Approved
1:100	18.07.2016	TU	JL	JL

Project No.	Dr. No.	Revision
FSC3649	D1	-