

# Construction Phasing Sequence

Hampstead Manor – Kidderpore Avenue Development

Submitted to London Borough of Camden  
By Mount Anvil Ltd  
22<sup>nd</sup> April 2016



# KIDDERPORE AVENUE - CONTRACT HANDOVER PHASING PLAN

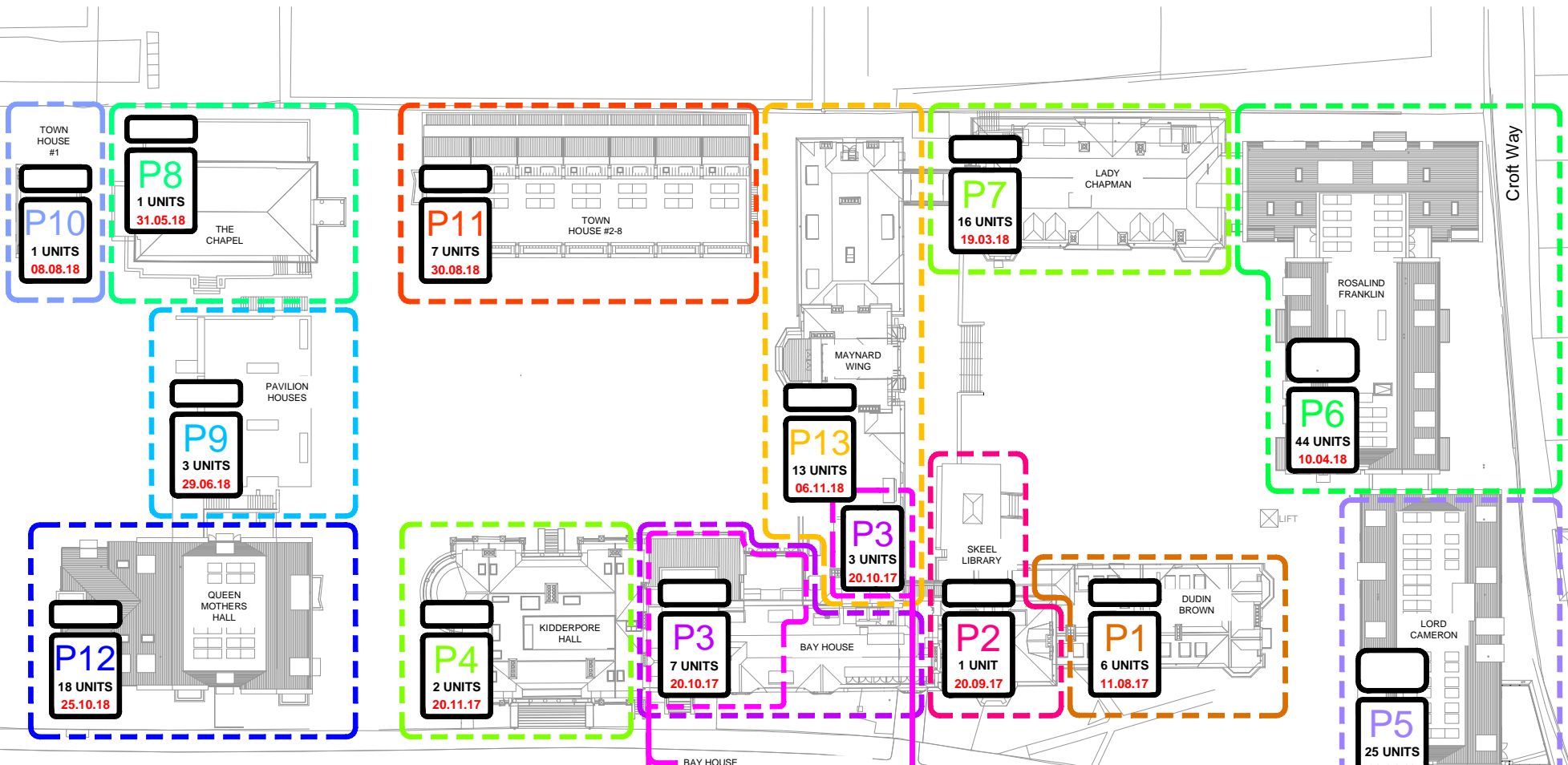

KIDDERPORE AVENUE

Croft Way

BAY HOUSE  
 MARKETING SUITE BUILD COMPLETE  
 28.11.16  
 SHOW FLAT BH-05 Build Complete  
 28.03.17  
 NINE APARTMENTS DELAYED BY SALES  
 WILL BE HANDED BACK - 02.04.18  
 HANDOVER OF UNITS - 06.11.18

MAYNARD WING  
 THREE UNITS DELAYED WHILST THE  
 MARKETING SUITE AND SHOW FLAT ARE  
 IN USE. RELEASED AT THE SAME TIME  
 AS BAY HOUSE

12.08.15 - Rev C - Completion date for SL P2 revised  
 28.08.15 - Rev D - Start date for BH corrected  
 16.10.15 - Rev E - Sales and Marketing key dates revised  
 23.11.15 - Rev F - Phases revised to reflect site offices  
 25.11.15 - Rev G - Phases revised. Start and HO dates confirmed  
 11.12.15 - Rev H - HO Phases revised P1 to P5  
 02.02.16 - Rev J - HO dates and phases revised  
 09.02.16 - Rev K - HO & marketing suite tenure dates revised  
 10.02.16 - Rev L - MS build completion note amended  
 29.03.16 - Rev M - Revised HO dates following planning permission

rev M  
 KA-MA-JETSK002  
 J.E.T.  
 N.T.S.  
 14.07.15

# Project Phasing & Handover Sequence July to September 2016

2016												2017												2018											
J	F	M	A	M	J	J	A	S	O	N	D	J	F	M	A	M	J	J	A	S	O	N	D	J	F	M	A	M	J	J	A	S	O	N	D

**July to September 2016:**

1. Removal off site of summerhouse for refurbishment and future re-install.
2. Demolish Queen Mother Hall, Lord Cameron, Rosalind Franklin and Lady Chapman
3. Structural alterations to listed and retained buildings

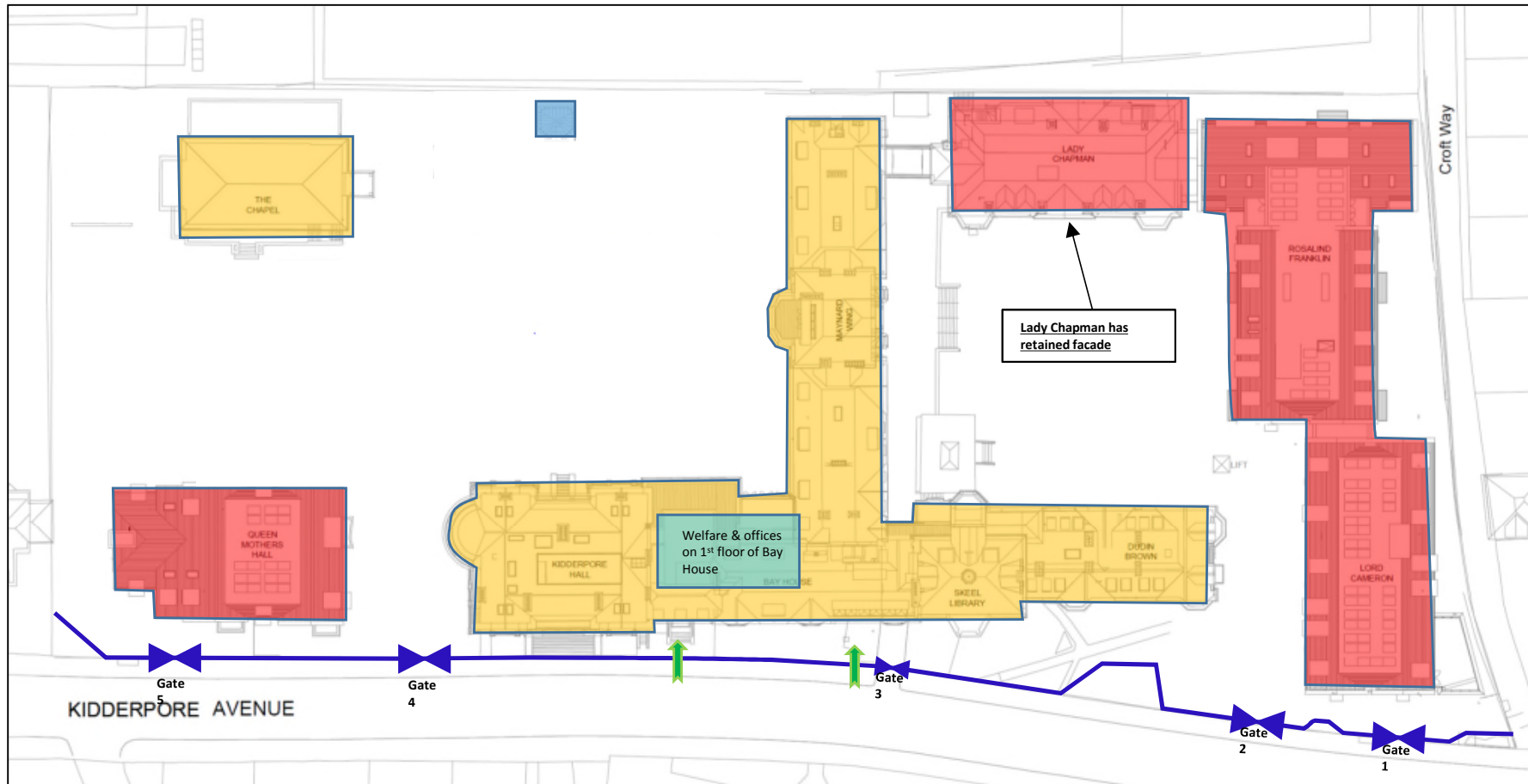

# Project Phasing & Handover Sequence September to December 2016

2016												2017												2018											
J	F	M	A	M	J	J	A	S	O	N	D	J	F	M	A	M	J	J	A	S	O	N	D	J	F	M	A	M	J	J	A	S	O	N	D

### September to December 2016:

1. Fit Out to Dudin Brown and Marketing Suite
2. Substructure & RC Works to Lord Cameron, Rosalind Franklin, Lady Chapman and new basement carpark.
3. RC Frame to Chapel extension
4. Structural alterations to the Chapel and Kidderpore Hall
5. Tower crane 1 installed November 2016
6. Marketing suite due to open December 2016

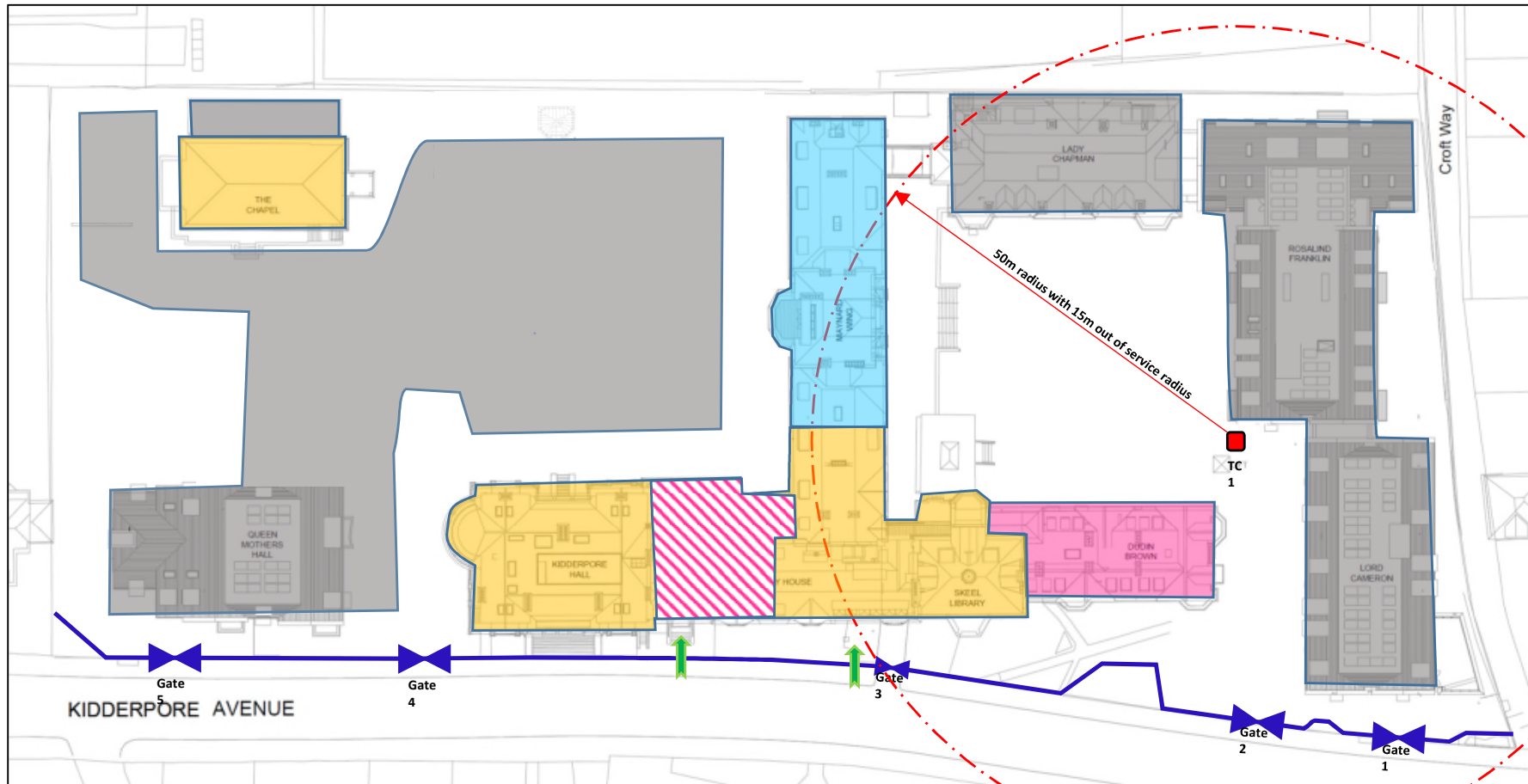

# Project Phasing & Handover Sequence January to April 2017

2016												2017												2018											
J	F	M	A	M	J	J	A	S	O	N	D	J	F	M	A	M	J	J	A	S	O	N	D	J	F	M	A	M	J	J	A	S	O	N	D

**January to April 2017:**

1. Continue fit Out to Dudin Brown
2. Start fit out to Skeel Library and Bay Hall P1 in January 2017
3. Start fit out to Lady Chapman in April 2017
4. RC Frame Works to Lord Cameron, Rosalind Franklin and new basement carpark.
5. Structural alterations to the Chapel and Kidderpore Hall
6. TC 2 installed March 2017
7. TC 3 installed April 2017

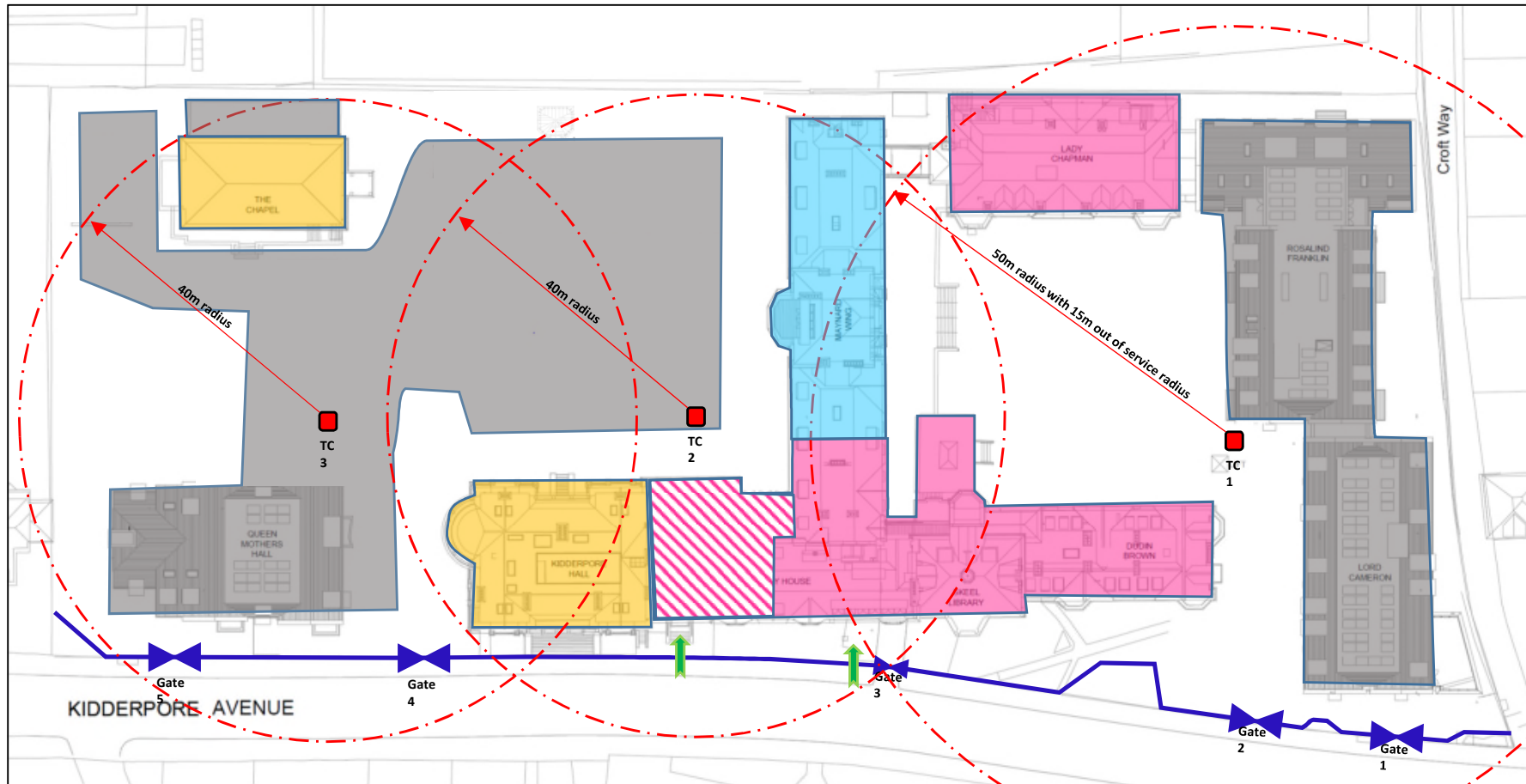

- = marketing suite demise
- = Tower Crane
- = Vehicular Access Gate
- = Pedestrian Access
- = Site offices & welfare facilities

# Project Phasing & Handover Sequence May to September 2017

2016												2017												2018											
J	F	M	A	M	J	J	A	S	O	N	D	J	F	M	A	M	J	J	A	S	O	N	D	J	F	M	A	M	J	J	A	S	O	N	D

### May to September 2017:

1. Fit Out to Lord Cameron, Rosalind Franklin and Lady Chapman, Kidderpore Hall and The Chapel
2. Substructure & RC Works to Lord Cameron, Rosalind Franklin, Lady Chapman and new basement carpark.
3. TC1 removed in August 2017
4. Dudin Brown, Skeel Library and Bay House P1 complete September 2017

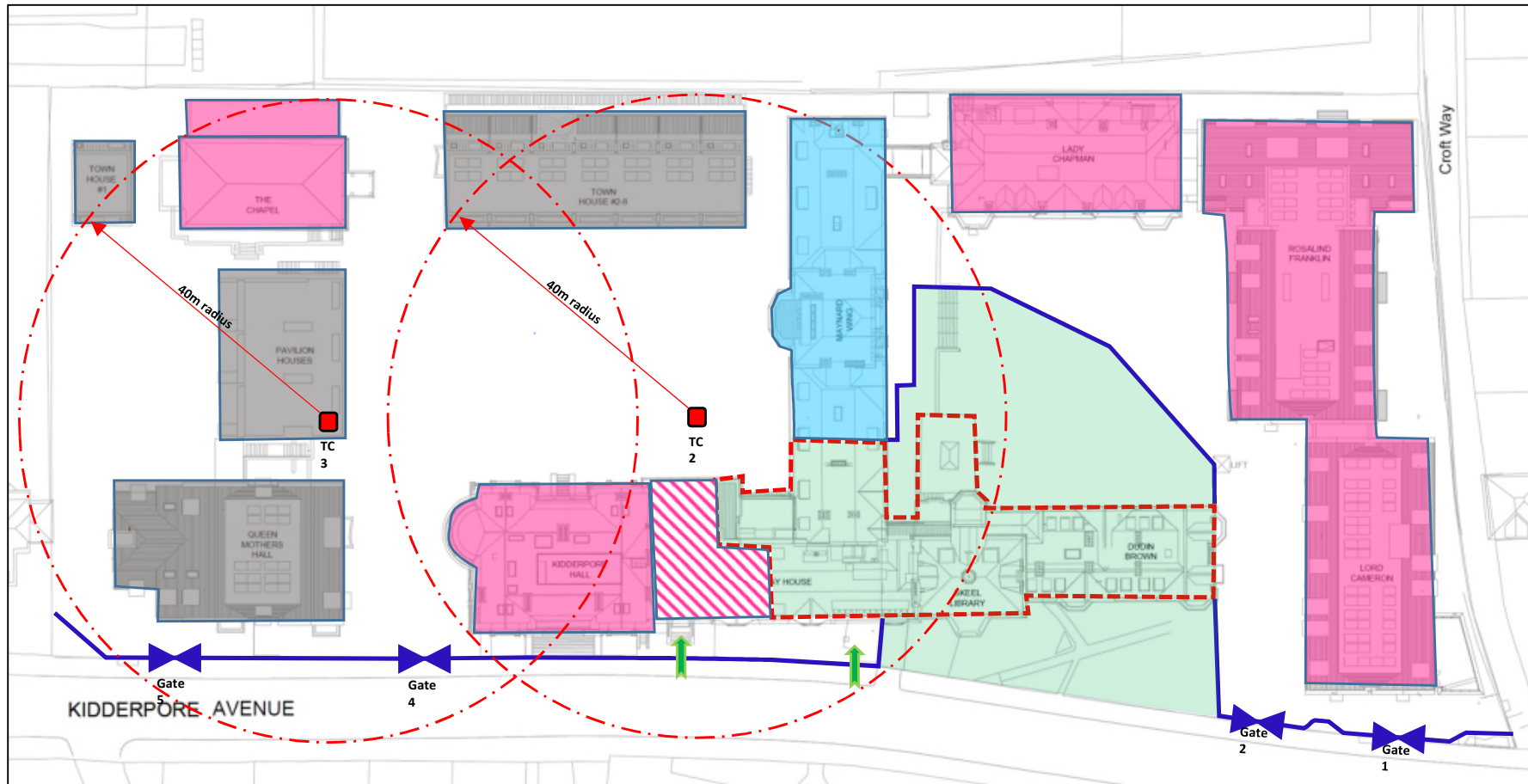

- = Completed & occupied dwellings.
- = marketing suite demise
- = Tower Crane
- = Vehicular Access Gate
- = Pedestrian Access
- = Site offices & welfare facilities

# Project Phasing & Handover Sequence October to December 2017

2016												2017												2018											
J	F	M	A	M	J	J	A	S	O	N	D	J	F	M	A	M	J	J	A	S	O	N	D	J	F	M	A	M	J	J	A	S	O	N	D

**October to December 2017:**

1. Fit Out to Lord Cameron, Rosalind Franklin, Lady Chapman, Kidderpore Hall and The Chapel
2. Substructure & RC Works to Lord Cameron, Rosalind Franklin, lady Chapman and new basement carpark.
3. Summerhouse re-opens to public in December 2017
4. TC2 removed October 2017
5. TC3 removed December 2017
6. Lady Chapman complete November 2017

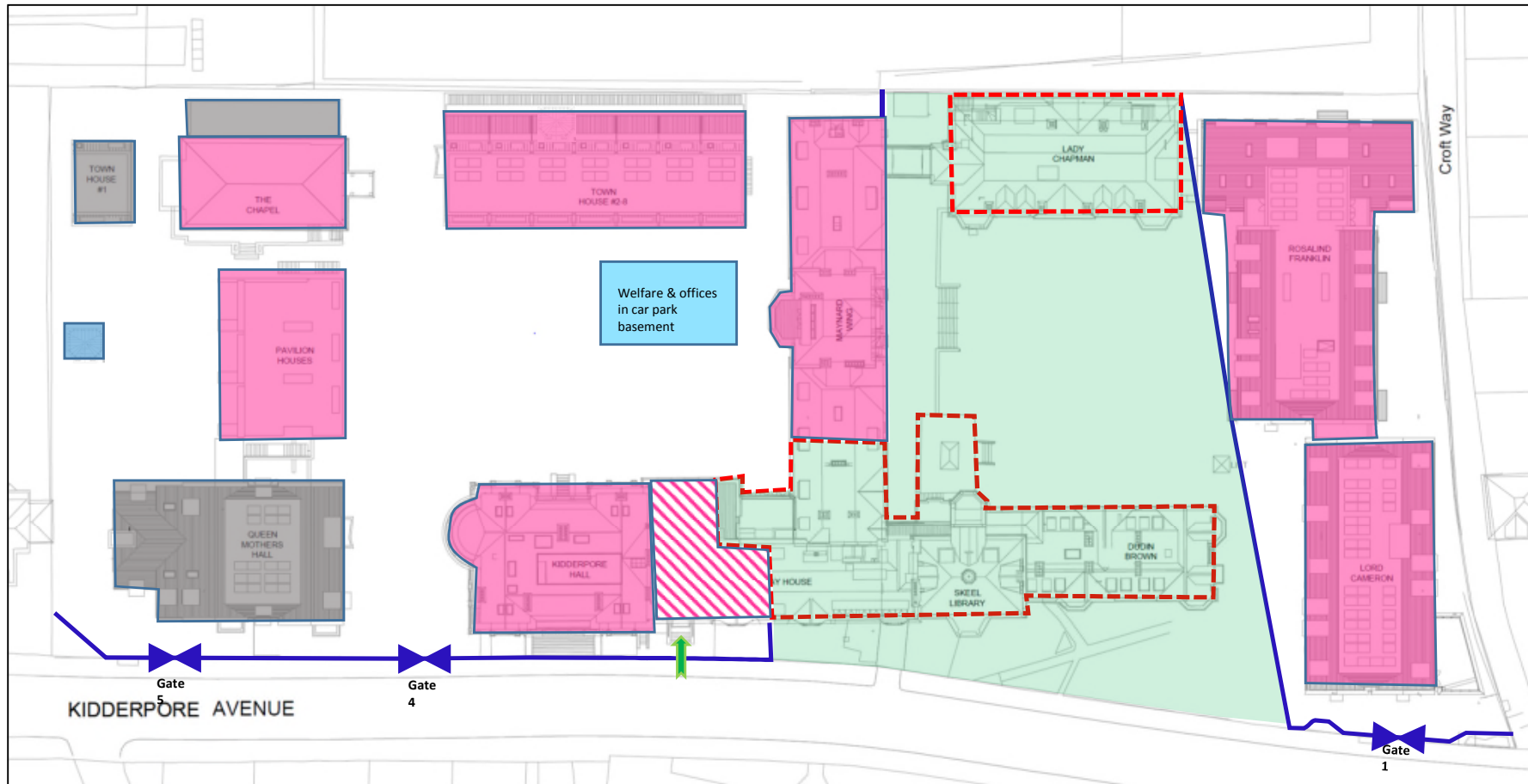

- = Completed & occupied dwellings.
- = marketing suite demise
- = Tower Crane
- = Vehicular Access Gate
- = Pedestrian Access
- = Site offices & welfare facilities





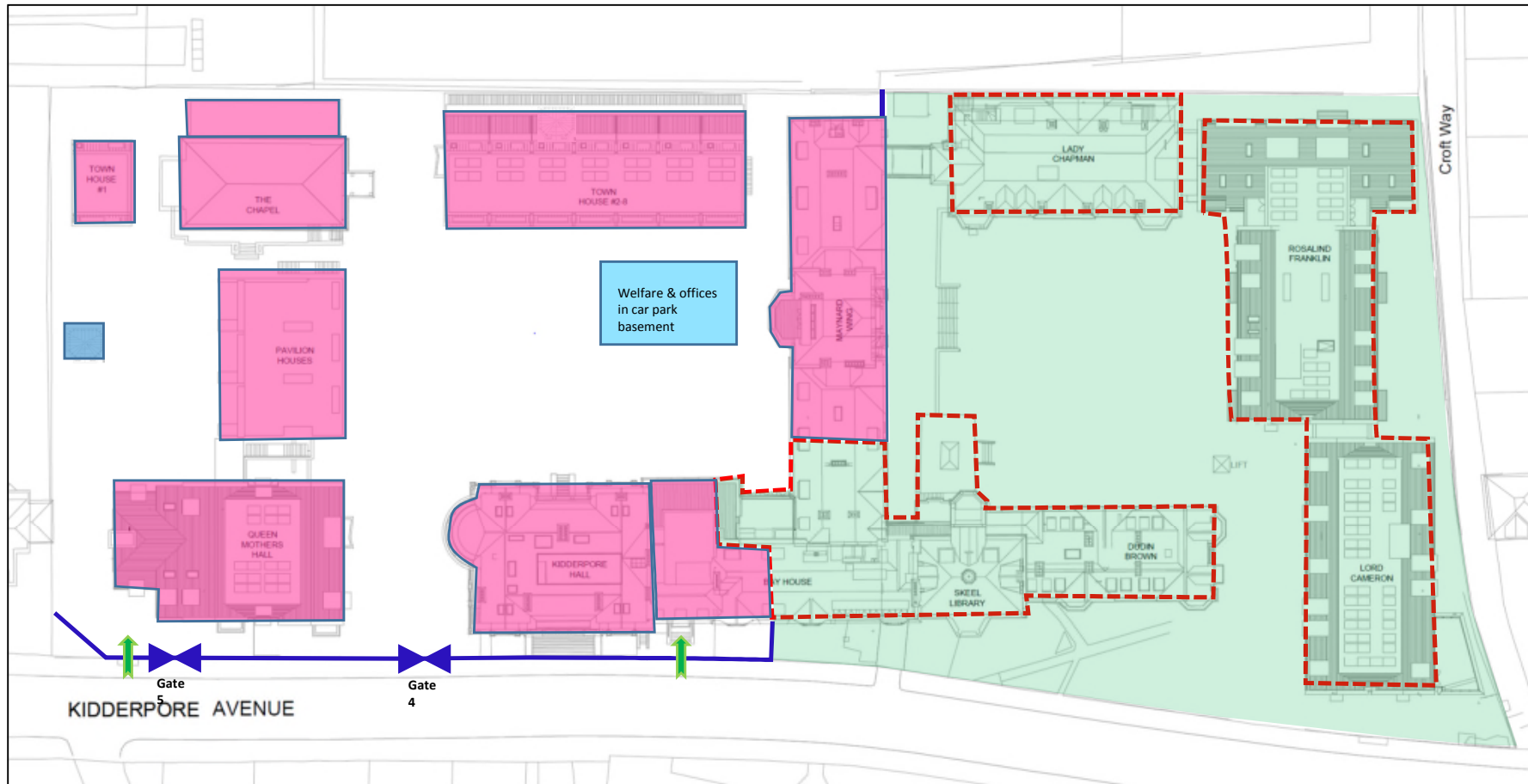

# Project Phasing & Handover Sequence January to February 2018

2016												2017												2018											
J	F	M	A	M	J	J	A	S	O	N	D	J	F	M	A	M	J	J	A	S	O	N	D	J	F	M	A	M	J	J	A	S	O	N	D

### January to February 2018:

1. Fit Out to Maynard, Town houses, Pavilions, The Chapel, Queen Mother Hall and Kidderpore Hall
2. Lord Cameron complete January 2018 – in accordance with clause 5.6.2 of the section 106 agreement. This will be completed prior to 25% of the private tenure dwellings are occupied.
3. Rosalind Franklin complete February 2018.
4. Decant from marketing suite



-  = Completed & occupied dwellings.
-  = marketing suite demise
-  = Tower Crane
-  = Vehicular Access Gate
-  = Pedestrian Access
-  = Site offices & welfare facilities









# Project Phasing & Handover Sequence March to May 2018

2016												2017												2018											
J	F	M	A	M	J	J	A	S	O	N	D	J	F	M	A	M	J	J	A	S	O	N	D	J	F	M	A	M	J	J	A	S	O	N	D

**March to May 2018:**

1. Fit Out to Maynard, Queen Mother Hall and Kidderpore Hall
2. The Chapel complete in March 2018
3. The Townhouses complete in March 2018
4. The pavilions complete in March 2018

-  = Completed & occupied dwellings.
-  = marketing suite demise
-  = Tower Crane
-  = Vehicular Access Gate
-  = Pedestrian Access
-  = Site offices & welfare facilities

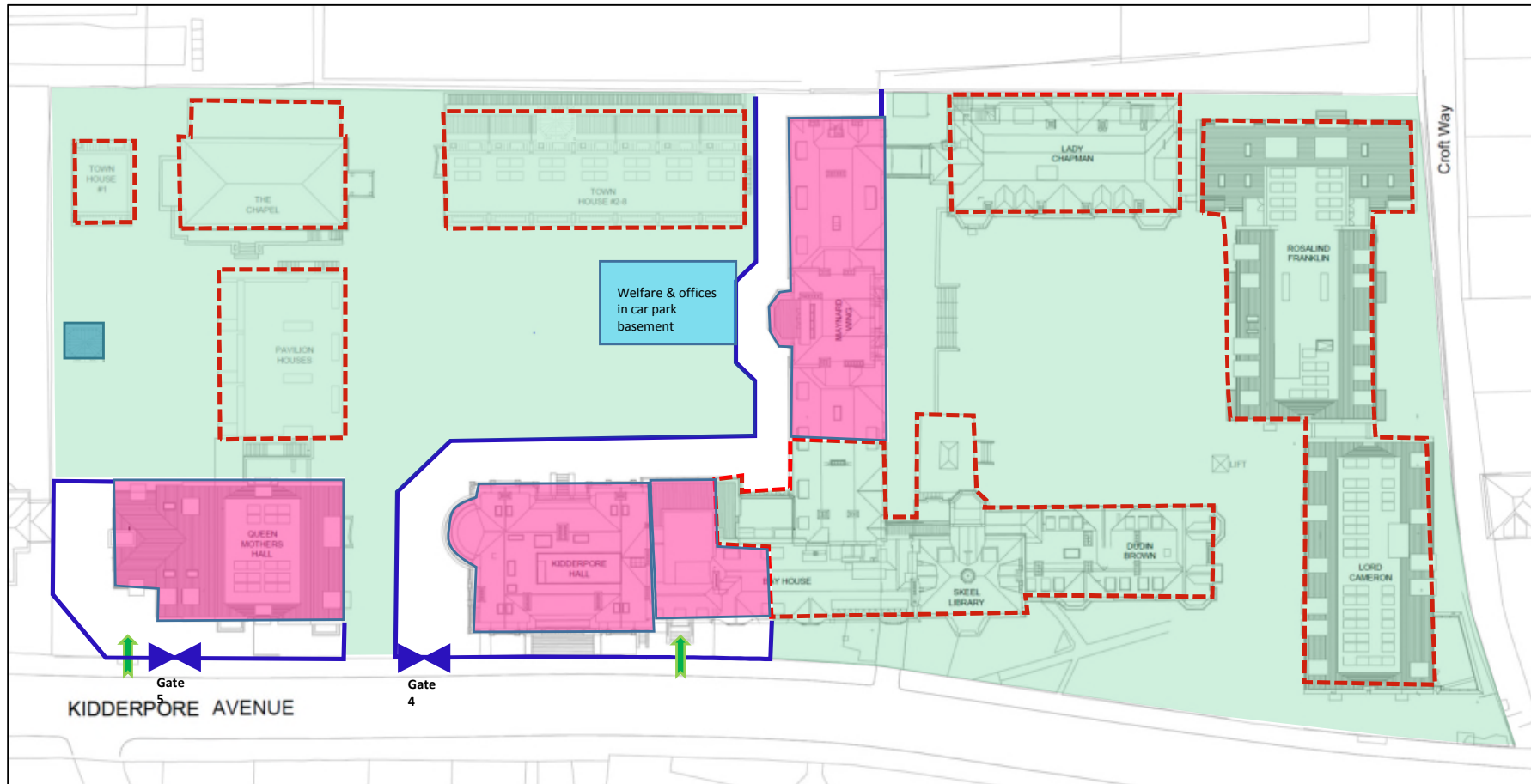

# Project Phasing & Handover Sequence

## June to October 2018

2016												2017												2018											
J	F	M	A	M	J	J	A	S	O	N	D	J	F	M	A	M	J	J	A	S	O	N	D	J	F	M	A	M	J	J	A	S	O	N	D

**June to October 2018:**

1. Queen Mother Hall complete in September 2018 – *In accordance with clause 5.6.3 of the section 106 agreement. Queen Mother Hall is complete after occupation of the intermediate housing units within Rosalind Franklin & Lord Cameron.*
2. Kidderpore Hall complete in October 2018
3. Maynard Wing complete in October 2018
4. Project Complete end October 2018

