

THIRD FLOOR PLAN

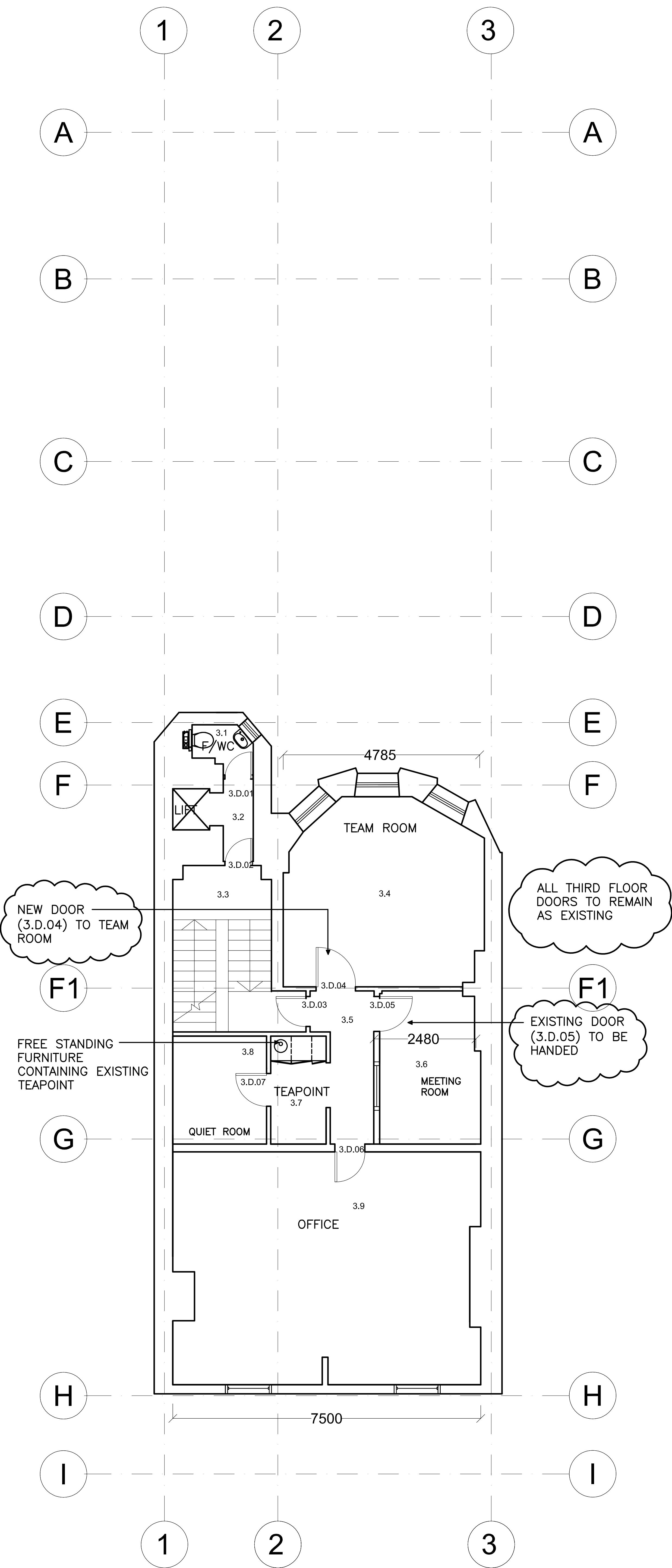

DOORS REMAINING AS EXISTING –  
3.D.01, 3.D.02, 3.D.03, 3.D.05 (EXISTING DOOR TO BE HANDED), 3.D.06, 3.D.07

NEW DOOR TO TEAM ROOM –  
3.D.04 (DOOR TO MATCH ADJACENT DOOR 3.D.05)

|   |          |  |     |
|---|----------|--|-----|
| C | 07.07.16 | Listed Building Consent Application - revised drawings | EJW |
| B | 20.05.16 | Listed Building Consent Application                    | EJW |
| A | 19.04.16 | Amendments to half landing wc                          | EJW |

|  |                   |               |        |      |
|--|-------------------|---------------|--------|------|
| Rev:   | Date:             | Details:      | By:    | Chk: |
| <b>EngineRoom</b>  |                   |               |        |      |
| EngineRoom<br>Unit E, Bristol Court<br>Martlesham Heath<br>Betts Avenue<br>Ipswich IP5 3RY   |                   |               |        |      |
| PLANNING   |                   |               |        |      |
| Client / Location:<br>SCHILLINGS INTERNATIONAL LLP<br>41 Bedford Square<br>London WC1B 3HX   |                   |               |        |      |
| Drawing:<br>Proposed Third Floor GA Plan   |                   |               |        |      |
| Scale:<br>1:50 @ A1  | Date:<br>04.04.16 | Drawn:<br>EJW | Check: |      |
| Job No:<br>1501007   | Dwg No:<br>304    | Rev:<br>C     |        |      |
| © EngineRoom Ltd. This title block is 100mm wide at full scale.<br>Do not scale. Work to figured dimensions only which should be verified on site. |                   |               |        |      |