

FIRST FLOOR PLAN

DOORS REMAINING AS EXISTING –
 1.D.01, 1.D.02, 1.D.03, 1.D.04, 1.D.05,
 1.D.06 (WITH NEW PARLIAMENT HINGES
 TO INCREASE DOOR SWING), 1.D.07

DOOR TO REMAIN CLOSED –
 1.D.05

DOORS REMOVED –
 1.D.09 (AS SHOWN ON THE EXISTING AND STRIP
 OUT, REMOVAL AND DISMANTLING FIRST
 FLOOR PLAN)

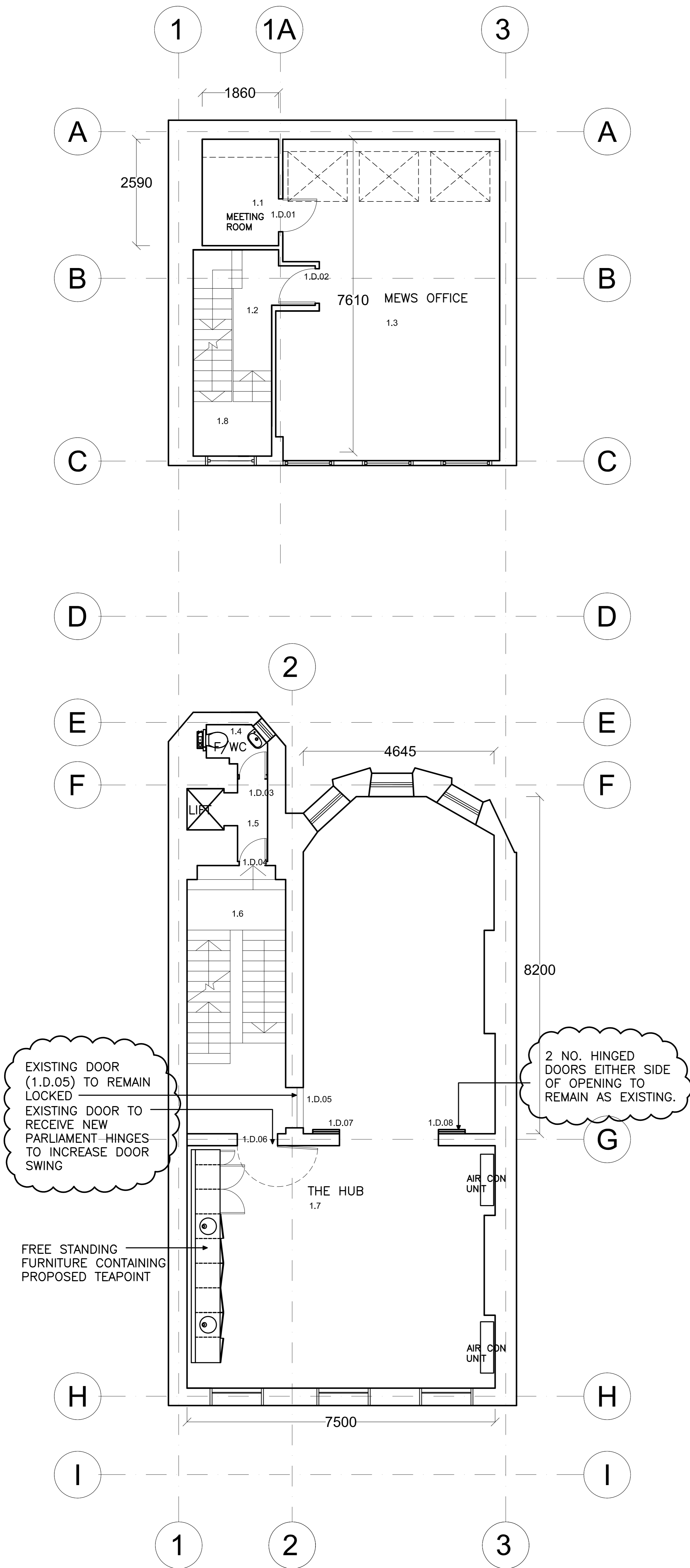

Rev:	Date:	Details:	By:	Chk:
C	07.07.16	Listed Building Consent Application - revised drawings	EJW	
B	20.05.16	Listed Building Consent Application	EJW	
A	19.04.16	Amendments to Office Teapoint	EJW	

Rev: Date: Details: By: Chk:

EngineRoom

EngineRoom
 Unit E, Bristol Court
 Martlesham Heath
 Betts Avenue
 Ipswich IP5 3RY

PLANNING

Client / Location:
 SCHILLINGS INTERNATIONAL LLP
 41 Bedford Square
 London WC1B 3HX

Drawing:
Proposed First Floor GA Plan

Scale:	Date:	Drawn:	Check:
1:50 @ A1	04.04.16	EJW	
Job No:	Dwg No:	Rev:	
1501007	302	C	