

TECHNICAL DATA SHEET**Bauder Xero Flor XF301 Sedum Blanket****DESCRIPTION**

The Bauder Xero Flor XF301 vegetation blanket is a unique sedum mat product developed for use directly over the waterproofing system without the need for a secondary substrate growing medium, making XF301 the lightest self-contained sedum blanket system available.

It incorporates a polypropylene mesh bonded to a vapour permeable base carrier sheet. This ensures that the blanket substrate is contained, doesn't compact and helps to maintain the vegetation in optimum condition.



The product also has an integral moisture retention fleece that can absorb and retain up to 5 L/m² of water. The vegetation within this product is a mix of hardy sedum species with some grasses and moss also present.

TECHNICAL DATA:**Composition**

Mineral component selected porous aggregate
Organic component composted green waste

Technical Performance

pH value 6.5 – 7
Vegetation support layer geo-textile carrier filter layer with bonded UV resistant nylon loops
Moisture retention fleece recycled fibres (80%man-made, 20% organic)

Weights and sizes

Standard roll width 1 m
Standard roll length 2 m
Non-standard lengths up to 10m (cut only in increments of 1m) installed with a crane attachment that is available from Bauder Ltd.
Thickness: ca. 28mm (excluding vegetation)
Saturated weight: 44Kg/m²

Fire Rating

BS 476 Part 3:2004 Ext. F. AA Ext. S. AA

Supply Form

Rolls of blanket to specified lengths (as above)

UNITED KINGDOM**Bauder Ltd**

70 Landseer Road
Ipswich Suffolk England IP3 0DH
T: +44 (0)1473 257671 **E:** info@bauder.co.uk
bauder.co.uk

IRELAND**Bauder Ltd**

O'Duffy Centre Cross Lane Carrickmacross
Co. Monaghan Ireland
T: +353 (0)42 9692 333 **E:** info@bauder.ie
bauder.ie



DELIVERY INFORMATION

- Deliveries of the Bauder XF301 Sedum Blanket are made from Tuesday to Friday.
- In exceptional weather we are unable to harvest the product for delivery until conditions improve. We are only able to advise the day before delivery if such a problem occurs.
- Order no more blanket to be delivered to site than can be installed within 24 hours of delivery.
- Should the blanket be considered faulty it is imperative that the Bauder sales office is informed on the day of delivery.
- If, for any reason, it is not possible to install the blanket on the day of delivery, the product should be rolled out on a flat, level surface, lightly watered and left out overnight before re-rolling for use early the following morning.

INSTALLATION INSTRUCTIONS – 2 X 1M ROLLS

- Ensure that the waterproofing has first been given and passed Final inspection by the Bauder Site Technician and that all waterproofing attached accessory items such as edge trims or retention stripes are installed.
- If large areas are to be installed then watering and installation should be done in sections of as much area as can be completed within four hours.
- It is important to ensure that width rolls are used at all roof perimeters i.e. no thin strips or small pieces that would otherwise present a wind uplift risk. Any 'cutting in' of thinner strips must be made in the field area, with the cut being made opposite to the selvedge to maintain continuity during installation.
- Working from the bottom left hand corner of the roof and taking care not to stand on the vegetated surface, unroll the blanket apply firmly onto the waterproofing, ensuring that the selvedge is unfolded and cleaned to remove any over-growing vegetation. This is important to ensure that the blankets are installed tightly butted together with no gaps.
- The blanket is fully inserted in to SS40 edge retention trim where this is installed.
- Continue on up the slope with the next roll, taking care to ensure that the junction between the two rolls is tightly butted. Fill any gaps with the extra substrate provided.
- When the first row of blankets are installed and the selvages unfolded, the contractor is to use a short piece of 50 x 50mm or similar softwood timber to run up and down the selvedge, lightly pressing up against the substrate and vegetation adjacent to remove all surplus material and leave a clean edge to butt the next blanket up to. The surplus substrate and vegetation is to be collected and set aside for future use.

UNITED KINGDOM

Bauder Ltd

70 Landseer Road

Ipswich Suffolk England IP3 0DH

T: +44 (0)1473 257671 **E:** info@bauder.co.uk

bauder.co.uk

IRELAND

Bauder Ltd

O'Duffy Centre Cross Lane Carrickmacross

Co. Monaghan Ireland

T: +353 (0)42 9692 333 **E:** info@bauder.ie

bauder.ie

- Upon completion of the area, the previously collected surplus substrate is to be used to dress into and make good any joints where the blanket edges are not tightly butted. Excess vegetation spouts removed from cleaning the selvedge can be applied to filled gaps/joints or any bare areas and these will usually root and establish within a couple of weeks.
- In order to keep all joints correctly spaced and well-made it is recommended that no more than three rolls should be installed before adjacent rolls are added to the installation.
- Commence the next row of blankets with a ½ roll, to create a staggered brick-bond laying pattern with the row previously installed.
- At abutments and penetrations the blanket may be cut using a sharp knife and straight edge. It is generally easier to cut up through the carrier on the underside of the blanket than to cut through the vegetation. Alternatively, a disc cutter can be used (using the appropriate safety equipment i.e. gloves and eye protection). Before cutting using this method, ensure that protection is applied to the waterproofing beneath using a timber plank or plywood sheet.
- In situations where the vegetation barrier secures the blanket edges against wind uplift, the 20/40 mm pebble loading must extend onto the leading edge of the blanket by a minimum of 100mm.
- Upon the completion of an area installed over a maximum 4 hour period the installation is to be heavily watered to ensure that the blanket and substrate are saturated before moving on to the next area.
- Upon completion of the installation apply Bauder organic slow release fertilizer at a rate of 80g/m² using the approved applicator trolley and thoroughly watered in.
- Care is to be taken to avoid the blanket being walked or stood upon unnecessarily or trafficked by other trades during and after the installation, as this will have an adverse effect on the vegetation.

INSTALLATION OF LONG ROLLS

- The Bauder XF301 blanket can be supplied in long rolls in 1m increments from 3m to 10m.
- It is the contractor's responsibility to ensure that adequate unloading facilities and storage space on site will be available before the product is ordered.
- It is the contractor's responsibility to ensure that the appropriate crane with sufficient reach, load capacity and the Bauder crane attachment are present on site at the time of delivery.

UNITED KINGDOM

Bauder Ltd

70 Landseer Road

Ipswich Suffolk England IP3 0DH

T: +44 (0)1473 257671 E: info@bauder.co.uk

bauder.co.uk

IRELAND

Bauder Ltd

O'Duffy Centre Cross Lane Carrickmacross

Co. Monaghan Ireland

T: +353 (0)42 9692 333 E: info@bauder.ie

bauder.ie

- In addition to the crane driver, a workforce of 3 or 4 is required to carry out the installation efficiently. One of the operatives on the roof will need to give directions to the crane driver.
- If you have not previously carried out a Bauder long roll installation, please ensure that the Bauder Site Technician responsible for the project is informed at least 2 weeks before installation is due to commence, to ensure that the correct level of site support is provided.
- The general principals of installation for long rolls are the same as for 2 x1m rolls, with the exception that the roll ends must be staggered a minimum 1m in length instead of ½ roll, to ensure staggered joints.

ESTABLISHMENT MAINTENANCE

- After completion of the installation it will be necessary to keep the substrate and blanket damp for a period of at least 4 weeks immediately afterwards, and it may be necessary to irrigate for longer than this if installation is followed by a warm, dry spell of weather.
- Please do not over-water! It is equally important to ensure that the green roof substrate does not become totally saturated by either excessive watering through periods of cool, wet weather. Further information on watering requirements for this product is available to view or download from the Bauder web site www.bauder.co.uk. Log in and visit our Technical Centre and review the document **“Watering Requirement Guidelines for Extensive and Bio-diverse Green Roof installations”**
- To encourage the plants to survive without too much irrigation and to harden them off in readiness to survive winter, it is important to start cutting back on watering from early September.
- The maintenance requirement in the following years will depend upon the weather experienced through the winter and early spring of each year and should follow our standard biodiversity green roof maintenance guidelines.

SUPPORT

- Modern extensive and bio-diverse green roof installations will normally require only minimal maintenance. Bauder is happy to offer advice on any issues concerning your green roof and enquiries should be forwarded to our Green Roof Technical Department at the address below.
- We believe our products and systems are of the highest standard and are always prepared to discuss any queries or concerns that may arise. Providing photographs or drawings to accompany your queries will help speed our response.

Please note: In the event of any query arising which it is thought may affect the condition of the system, then Bauder Ltd should be contacted at the address below. We cannot accept responsibility for any problem or failure due to use outside those parameters for which the system was designed or 'acts of god' beyond our control e.g. extreme weather conditions or damage through pests.

UNITED KINGDOM

Bauder Ltd

70 Landseer Road

Ipswich Suffolk England IP3 0DH

T: +44 (0)1473 257671 **E:** info@bauder.co.uk

bauder.co.uk

IRELAND

Bauder Ltd

O'Duffy Centre Cross Lane Carrickmacross

Co. Monaghan Ireland

T: +353 (0)42 9692 333 **E:** info@bauder.ie

bauder.ie

TECHNICAL DATA SHEET**Bauder SDF Mat****DESCRIPTION**

Separation layer and slip layer used on roofs of 1 -2°.

TECHNICAL DATA:**Composition**

Material geo-textile facings with thermally bonded UV resistant woven nylon loops between

Weights and sizes

Standard roll width	1 metre
Standard roll length	20 or 50 metres
Thickness:	20mm
Weight:	ca. 0.6Kg/m ²
Pressure resistance	ca. 20kN/m ²

Supply Form

rolls

**UNITED KINGDOM****Bauder Ltd**

70 Landseer Road
Ipswich Suffolk England IP3 0DH
T: +44 (0)1473 257671 E: info@bauder.co.uk
bauder.co.uk

IRELAND**Bauder Ltd**

O'Duffy Centre Cross Lane Carrickmacross
Co. Monaghan Ireland
T: +353 (0)42 9692 333 E: info@bauder.ie
bauder.ie

Bauder Bituminous Membrane Green Roof System - Standard Detail

Extensive substrate based green roof system - Bauder XF300 Sedum vegetation blanket

XF300 / ET - 4A

Issue	Date	Checked
1	MARCH 2013	

NOT TO SCALE

Notes:

- This detail is of a conceptual nature and should only be used as such and not included as part of a specification document. Please contact our Technical Department to ensure the details you require are appropriate and accurate.

BIODIVERSITY LANDSCAPING ELEMENTS BY OTHERS

DESIGN CONSIDERATIONS

- Any additional biodiversity landscaping is normally constructed in accordance with an ecologists report and recommendations. Bauder does not take any responsibility for the design, performance or maintenance of any planting schemes.
- Weight loading for any surface landscaping items, such as rocks, logs, undulating areas of growing medium and fully established planting /vegetation, making up the Biodiverse landscaping, must be provided directly from the supplier or landscape designer and should be the subject to a structural engineer's approval.

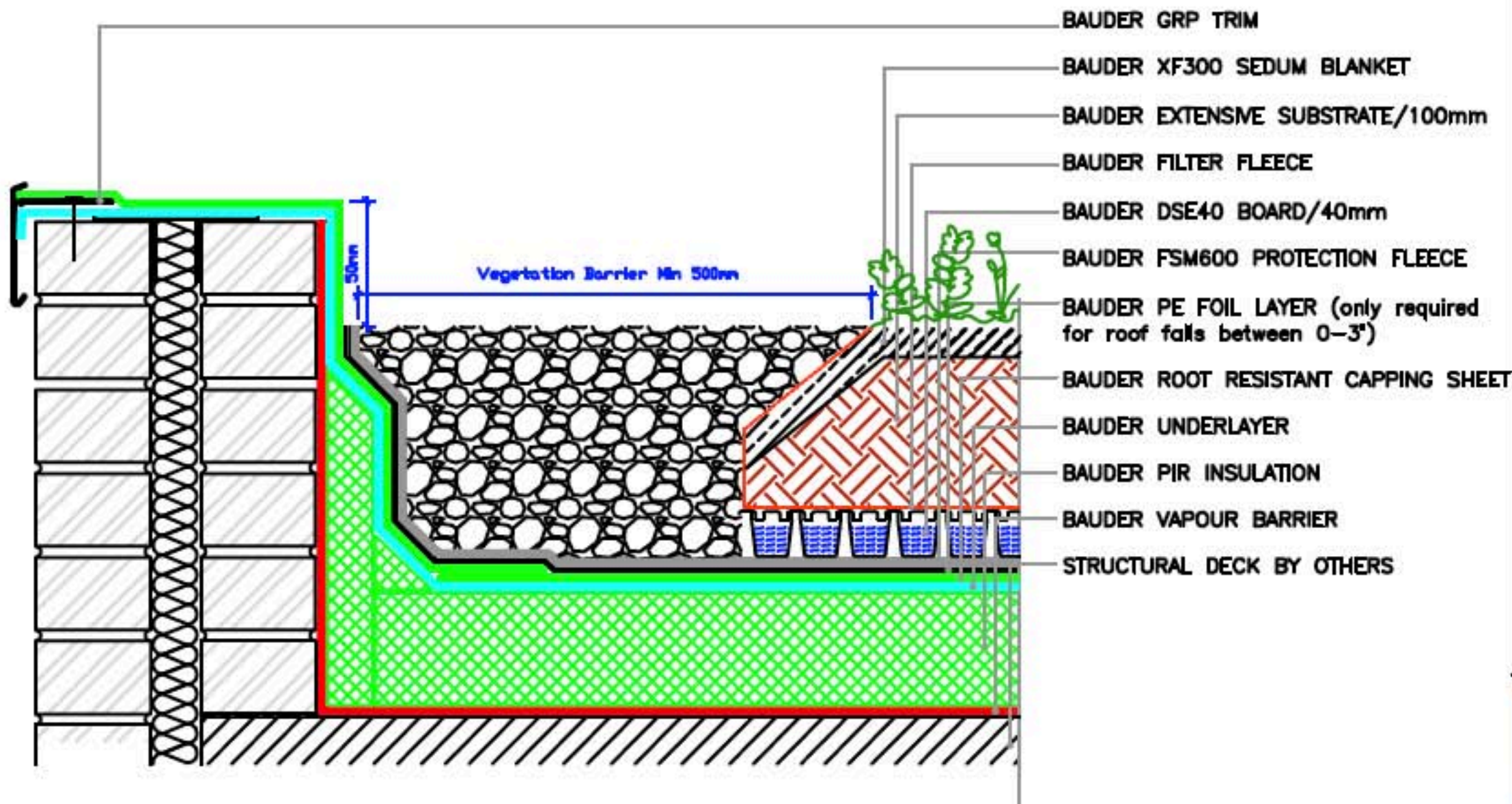

TYPICAL SECTION DETAIL / CHECK KERB UPSTAND / DSE40 BOARD 0 - 5° SLOPE

BAUDER

UK OFFICE

Bauder Limited
70 Landseer Road,
Ipswich,
Suffolk IP3 0DH,
England,

T: +44 (0)1473 257671

F: +44 (0)1473 230761

E: technical@bauder.co.uk

bauder.co.uk

IRELAND OFFICE

Bauder Limited
O'Duffy Centre,
Cross Lane,
Carrickmacross,
Co. Monaghan,
Ireland,

T: +353 (0)42 9692 333

F: +353 (0)42 9692 839

E: technical@bauder.ie

bauder.ie

Bauder Bituminous Membrane Green Roof System - Standard Detail

Extensive substrate based green roof system - Bauder XF300 Sedum vegetation blanket

XF300 / ET - 1A

Issue	Date	Checked
1	MARCH 2013	

NOT TO SCALE

Notes:

- This detail is of a conceptual nature and should only be used as such and not included as part of a specification document. Please contact our Technical Department to ensure the details you require are appropriate and accurate.

BIODIVERSITY LANDSCAPING ELEMENTS BY OTHERS

DESIGN CONSIDERATIONS

- Any additional biodiversity landscaping is normally constructed in accordance with an ecologists report and recommendations. Bauder does not take any responsibility for the design, performance or maintenance of any planting schemes.
- Weight loading for any surface landscaping items, such as rocks, logs, undulating areas of growing medium and fully established planting /vegetation, making up the Biodiverse landscaping, must be provided directly from the supplier or landscape designer and should be the subject to a structural engineer's approval.

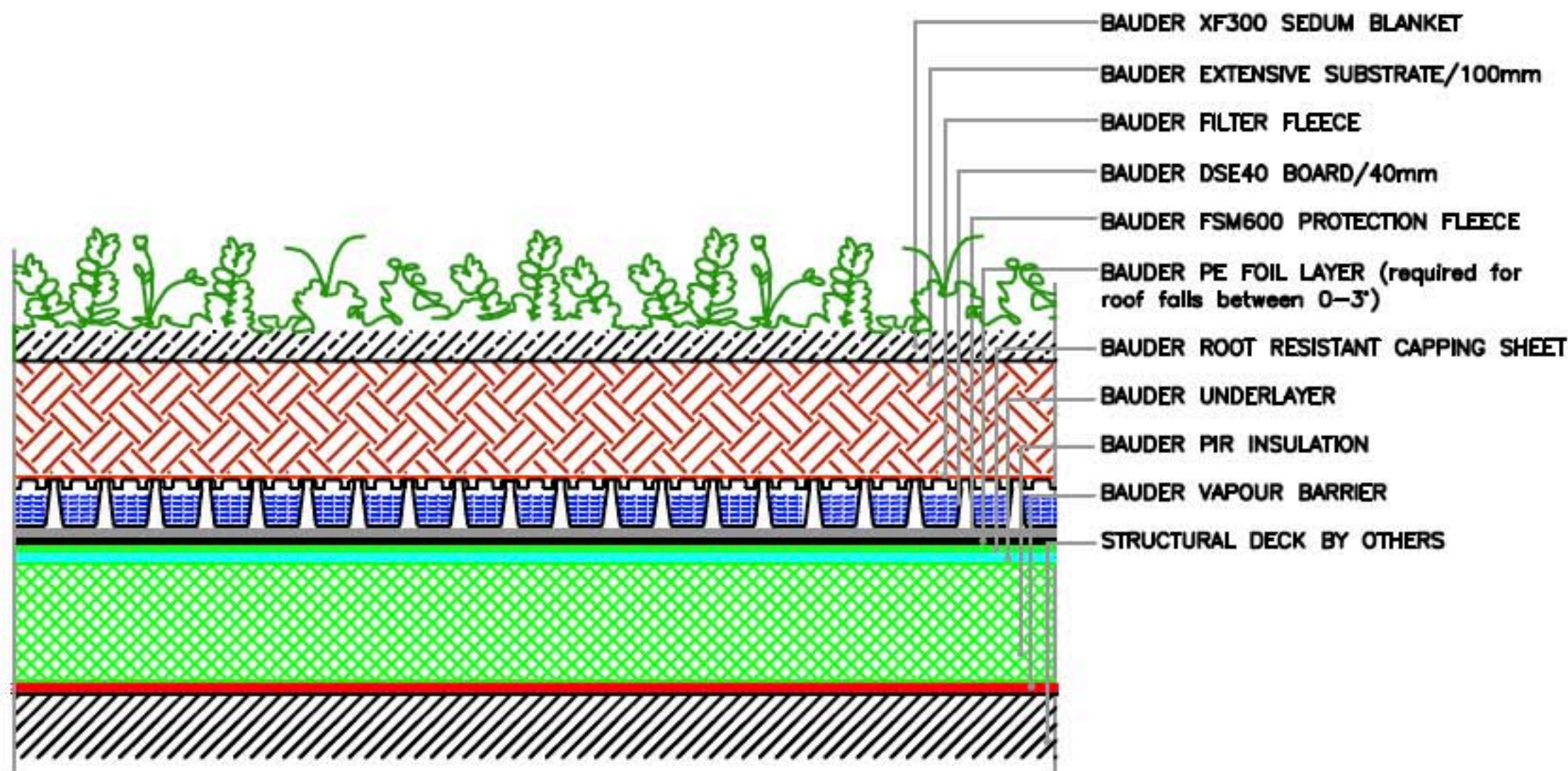

TYPICAL SECTION DETAIL / BUILD-UP / DSE40 BOARD 0 - 5° SLOPE



UK OFFICE
Bauder Limited
 70 Landseer Road,
 Ipswich,
 Suffolk IP3 0DH,
 England.
 Tl +44 (0)1473 257671
 Fl +44 (0)1473 230761
 E: technical@bauder.co.Ku?
bauder.co.Ku

IRELAND OFFICE
Bauder Limited
 O'Duffy Centre,
 Cross Lane,
 Carrickmacross,
 Co. Monaghan,
 Ireland.
 Tl +353 (0)42 9692 333
 Fl +353 (0)42 9692 839
 E: technical@bauder.ie
bauder.ie

Bauder Bituminous Membrane Green Roof System - Standard Detail
Extensive Sedum blanket system /
Bauder Xero Flor XF301 combination Sedum blanket

XFC1-1/3/7/10

Issue	Date	Checked
01	MARCH 2013	BAUDER LTD

NOT TO SCALE

Notes:

This detail is of a conceptual nature and should only be used as such and not included as part of a specification document. Please contact our Technical Department to ensure the details you require are appropriate and accurate.

TECHNICAL NOTES

- Uprand details (minimum height): 150 mm. This must be taken from the surface of the finished landscaping. Special attention should be paid to all structures, such as rooflights, counter-flashings, window and door cills, pipes etc... Bauder cannot take responsibility for water ingress over waterproofing details constructed below the recommended minimum height.
- Uprand details to a timber check kerb (minimum height): 50 mm. This must be taken from the surface of the finished landscaping.
- Flashings: Separate flashings must always be formed. Capping sheet taken up the upstand in one piece will not be permitted.

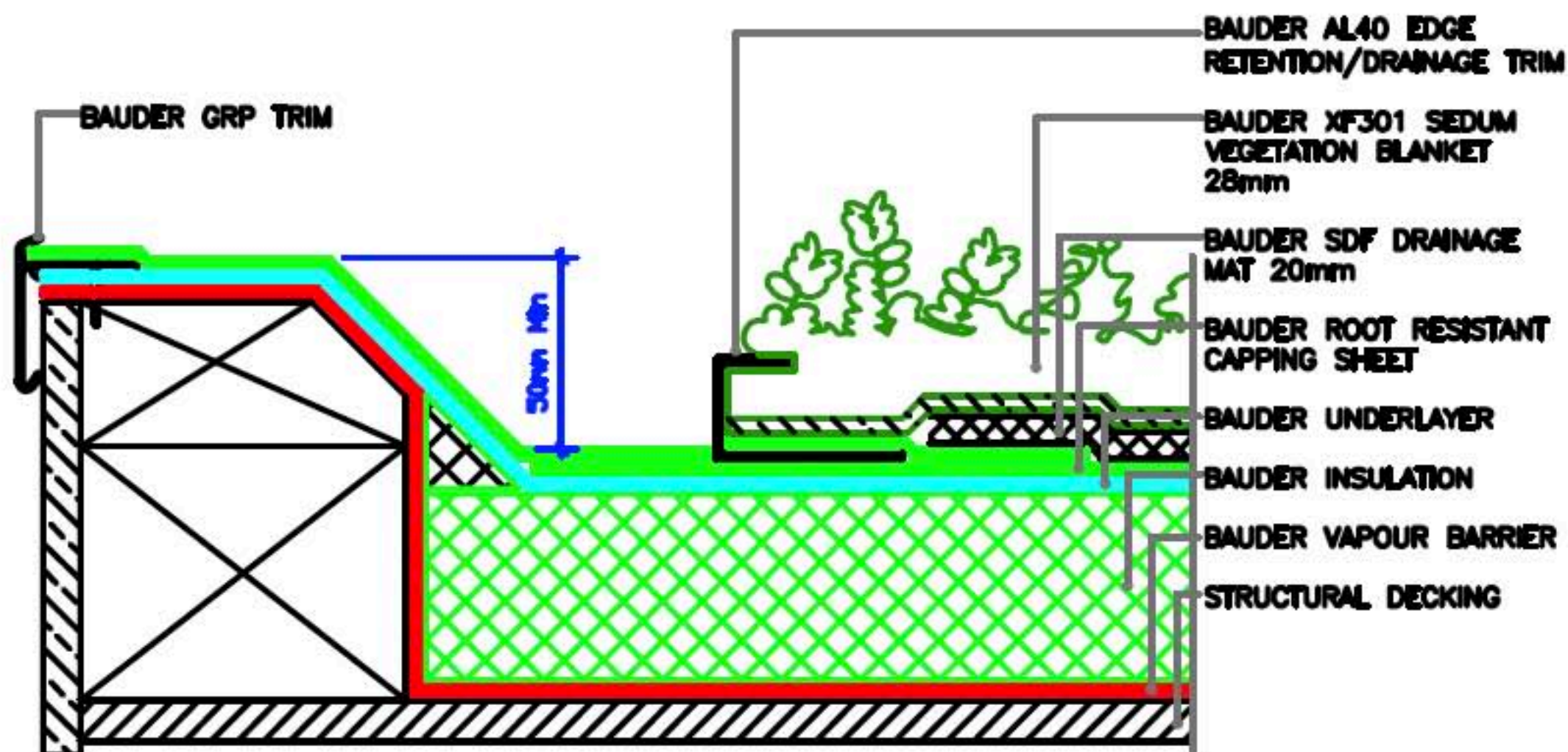

EAVES DETAIL TO TIMBER KERB WITH NEW GRP TRIM / VEGETATION BARRIER OPTION / AL40 EDGE RETENTION/DRAINAGE TRIM OPTION

BAUDER

UK OFFICE

Bauder Limited
 70 Landseer Road, Ipswich,
 Suffolk IP3 0DH,
 England,
 T: +44 (0)1473 257671
 F: +44 (0)1473 230761
 E: technical@bauder.co.uk
bauder.co.uk

IRELAND OFFICE

Bauder Limited
 O'Duffy Centre, Cross Lane,
 Carrickmacross, Co. Monaghan,
 Ireland.
 T: +353 (0)42 9692 333
 F: +353 (0)42 9692 839
 E: technical@bauder.ie
bauder.ie

Bauder Bituminous Membrane Green Roof System - Standard Detail

Extensive Sedum blanket system /

Bauder Xero Flor XF301 combination Sedum blanket

XFG4-1/3/6

Issue	Date	Checked
01	MARCH 2013	BAUDER LTD

NOT TO SCALE

Notes:

This detail is of a conceptual nature and should only be used as such and not included as part of a specification document. Please contact our Technical Department to ensure the details you require are appropriate and accurate.

TECHNICAL NOTES

- Uprand details (minimum height): 150 mm. This must be taken from the surface of the finished landscaping. Special attention should be paid to all structures, such as rooflights, counterflashings, window and door cills, pipes etc... Bauder cannot take responsibility for water ingress over waterproofing details constructed below the recommended minimum height.
- Uprand details to a timber check kerb (minimum height): 50 mm. This must be taken from the surface of the finished landscaping.
- Flashings: Separate flashings must always be formed. Capping sheet taken up the upstand in one piece will not be permitted.

BAUDER

UK OFFICE

Bauder Limited
70 Landseer Road, Ipswich,
Suffolk IP3 0DH,
England.
T: +44 (0)1473 257671
F: +44 (0)1473 230761
E: technical@bauder.co.uk
bauder.co.uk

IRELAND OFFICE

Bauder Limited
O'Duffy Centre, Cross Lane,
Carrickmacross, Co. Monaghan,
Ireland.
T: +353 (0)42 9692 333
F: +353 (0)42 9692 839
E: technical@bauder.ie
bauder.ie

BAUDER XF301 SEDUM
VEGETATION BLANKET
28mm

BAUDER SDF DRAINAGE
MAT 20mm

BAUDER ROOT RESISTANT
CAPPING SHEET

BAUDER UNDERLAYER

BAUDER INSULATION

BAUDER VAPOUR BARRIER

STRUCTURAL DECKING

VEGETATION BARRIER 500mm

100mm

SECTION THROUGH INTERNAL RAINWATER OUTLET / VEGETATION BARRIER OPTION