

Level 3 Proposed General Arrangement Plan

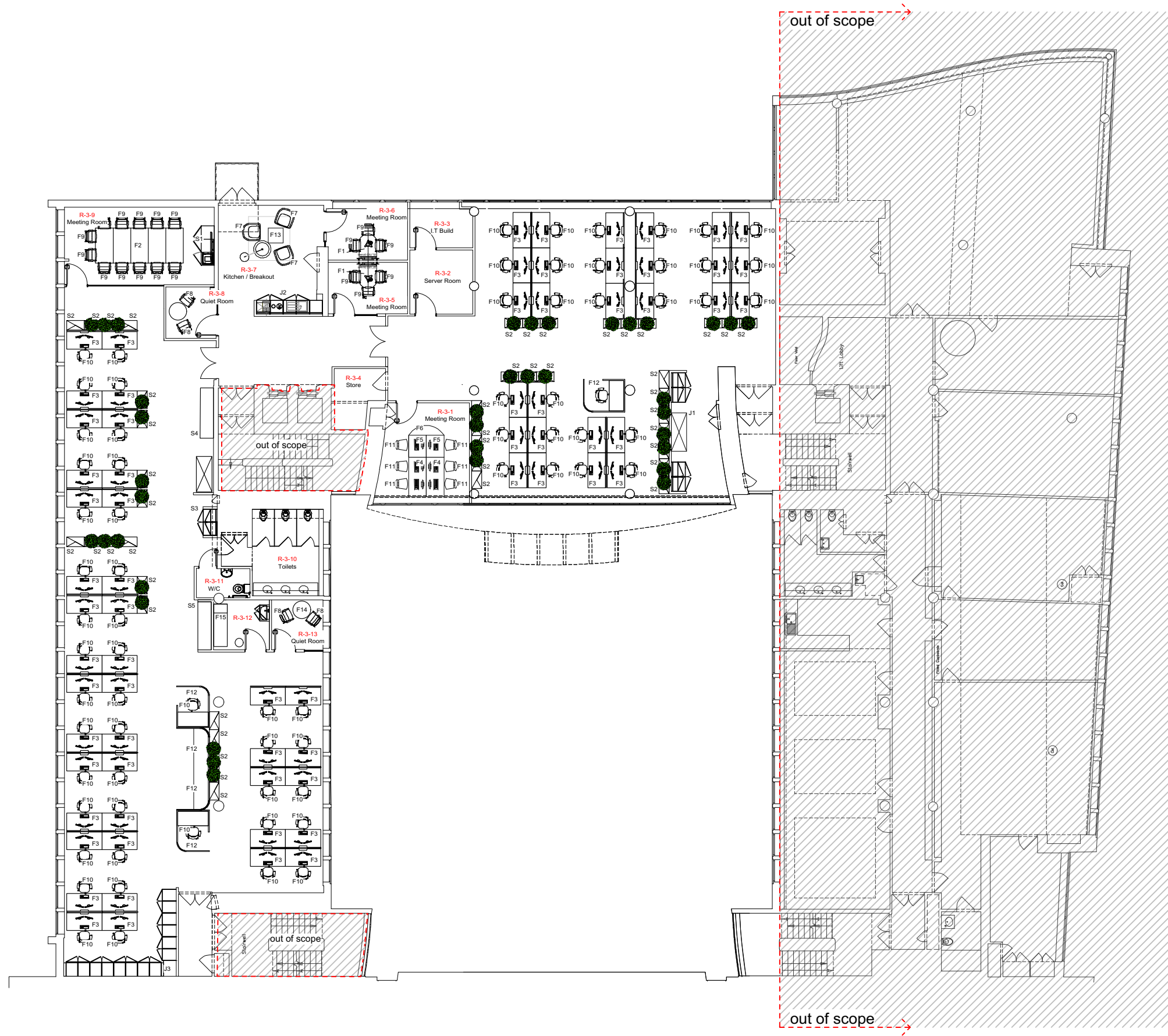

Item	Quantity
F1 - Meeting Table 1 Spec: TBC	2
F2 - Meeting Table 2 Spec: TBC	1
F3 - Desk 1 Spec: TBC	58
F4 - Desk 2 Spec: TBC	2
F5 - Desk 3 Spec: TBC	2
F6 - Desk edge Spec: TBC	1
F7 - Lounge Chair Spec: TBC	3
F8 - Quiet Room Chair Spec: TBC	4
F9 - Meeting Room Chair Spec: TBC	11
F10 - Task Chair 1 Spec: TBC	66
F11 - Task Chair 2 Spec: TBC	6
F12 - Pod Spec: TBC	5
F13 - Coffee table 1 Spec: TBC	1
F14 - Coffee table 2 Spec: TBC	1
F15 - Bed Spec: TBC	1
S1 - Credenza Spec: TBC	1
S2 - Storage unit with planter Spec: TBC	43
S3 - Individual storage unit 1 Spec: TBC	1
S4 - Individual storage unit 2 Spec: TBC	1
S5 - Individual storage unit 3 Spec: TBC	1
J1 - New resource point See drawing no:	1
J2 - New kitchen point See drawing no:	1
J3 - New storewall See drawing no:	1

Do not scale from this drawing, use only written dimensions. Critical dimensions are identified thus with the 'a' prefix. Contractor to check ALL measurements on site prior to the commencement of the work and notify HTS of any discrepancies. All setting out to be approved by HTS PRIOR to fabrication.
© The Harmsen Group/Harmsen Tilney Shane retain the copyright and ownership of the drawing which must not be copied without written consent.

Revisions.
Rev.: By: Date:



Client
TUC

Project
Congress House

Drawing Title
Level 3
Proposed General Arrangement Plan

Scale	Drawn	Date
1:200 (A3)	DH	04.07.16

Bristol | Farleigh Court | Flax Bourton | BS48 1UR
T 01275 465 200

London | The Printworks | Dunstable Road | TW9 1RR
T 020 8439 2970

www.harmsentilneyshane.com

Project no.	Drawing no.	Revision
689	103	0

Purpose of Issue
Tender