

Second floor plan - Proposed

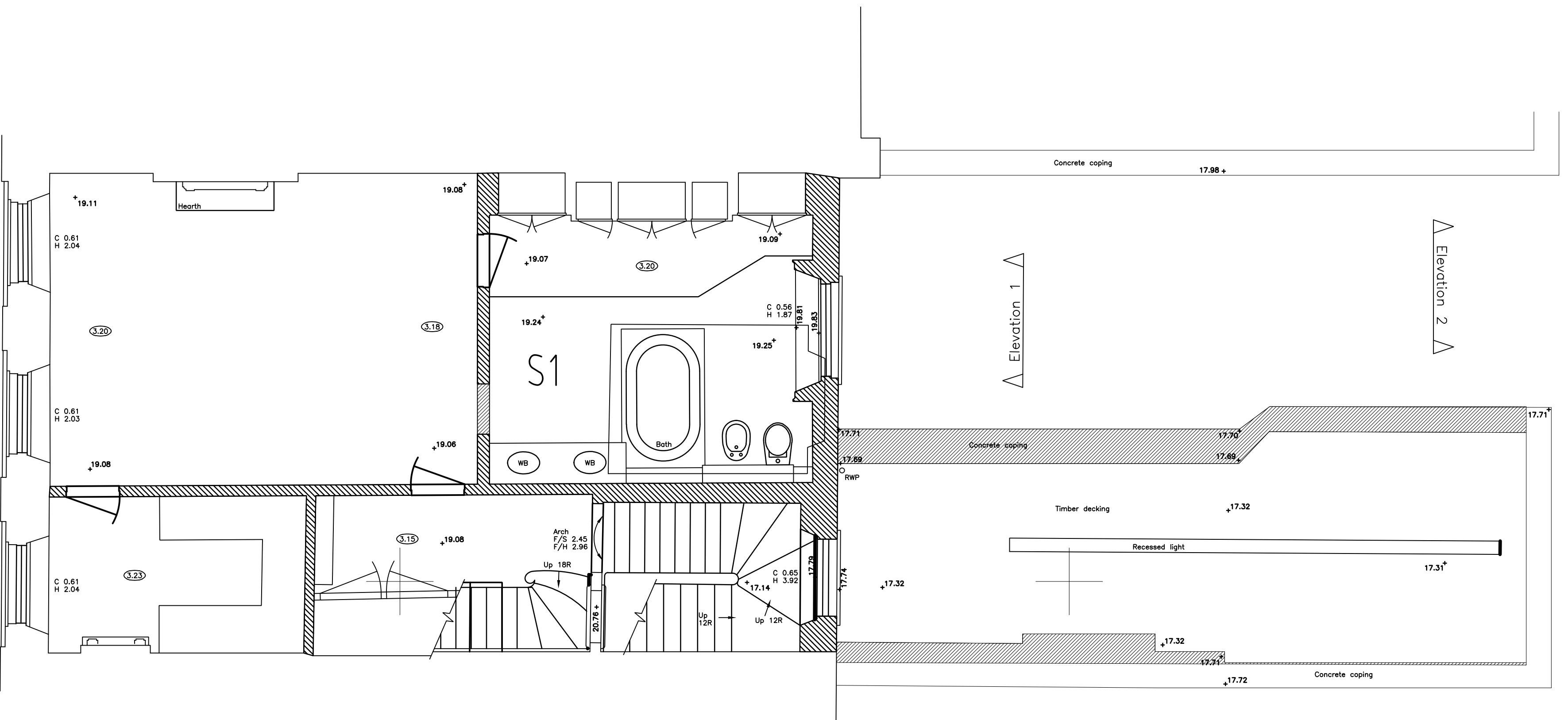

Second floor plan - Existing

- Existing walls to be retained
- Existing walls to be removed

A		Steelwork to link and mews added	18.05.16	BSI	-
Rev.	Revision Description.		Date	Initial	DRA
DRA - Denotes whether revision(s) affect the Designers Risk Assessment. "Yes" in this column will be accompanied by a note added to the drawing describing the new or increased/decreased risk. "No" in this column denotes no change to the DRA.					
<div><div></div><div><p>Baxter Glaysher Consulting Civil and Structural Engineers 33-35 Bell Street Reigate Surrey RH2 7AW Tel.: 01737 240241 Fax: 01737 240341 Email: <a href="mailto:cadoffice@bg-consulting.co.uk">cadoffice@bg-consulting.co.uk</a></p></div></div>					
Client					
Project 10 Gloucester Gate London					
Drawing Title Second Floor Plan					
Drawn BSI	Checked	Approved	Contract / Drawing No. 216057 D04		Rev. A
Date May 2016	Scale @ A1 1:50				
Baxter Glaysher Consulting Ltd					
© Copyright; This drawing is the property of Baxter Glaysher Consulting Ltd. Copyright is reserved by them and the drawing is issued on the condition that it is not copied either wholly, or in part, without the consent in writing of Baxter Glaysher Consulting Ltd.					