

- No. Material Name**
- 1 Structural glass balustrade by HandrailDesign or similar. Top rail colour - black.
 - 2 Metal railing finished in black gloss paint.
 - 3 All existing tiles are to be carefully lifted and relaid.
Existing battens and sarking felt to be removed.
Sarking boards are to be inspected and fixed where necessary.
New felt to be installed along with new pre treated counterbattens and battens fixed with galvanised steel nails (as existing)
Tiles to be fixed with aluminium nails. Relaid and replacement (to match existing)
Tiles should be grouped within separate pitches to avoid patchwork aesthetic.
Replacement Tile to be Dreadnought – Machine made clay tile – Brown Antique - smoothface
Matching colour "GlideVale" vent tiles to be installed over the SVP vents and kitchen extract.
9x6" black painted cast iron vent
 - 4 Heritage range cast aluminium RWP finished in gloss black paint
 - 5 Structural glazing
 - 6 New timber window by Mummford and Wood or similar, colour to match existing
 - 7 New timber door by Mummford and Wood or similar, colour to match existing
 - 8 Metal fascia to new balcony colour white
 - 9 New stone coping to match existing
 - 10 Metal fascia to new terrace colour white
 - 11 Existing brick
 - 12 New Lead covered canopy to match existing
 - 13 New Brick to match existing

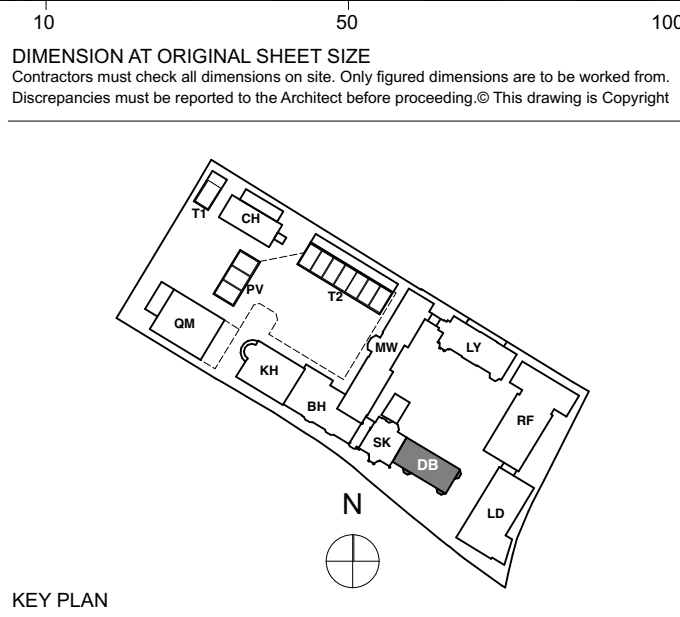

KEY PLAN

PLANNING

REVISION	DRN	CHKD	DATE
- First Issue	K/C	KC	11/07/2016

A&Q

PARTNERSHIP

CLIENT
MOUNT ANVIL LTD



PROJECT
KIDDERPORE AVENUE

DRAWING
Dudin Brown
East Elevation As Proposed

SCALE 1:50 @ A1 DATE July 2016

DRAWING No. 15 230
9000-DRG-02DB-EL902

DRAWN BY K/C
REV

A & Q PARTNERSHIP (LONDON) LTD
THE LUX BUILDING, 2-4 HOXTON SQUARE, LONDON N1 6 NU
Tel: 020 7613 2244 Fax: 020 7613 2642 Email: london@aqp.co.uk
ARCHITECTURE DESIGN MASTERPLANNING INTERIORS