

**GENERAL NOTES.**  
 The Contractor to advise on all details and ensure stability and strength of construction. The contractor to provide setting out and rod drawings for approval prior to construction.  
 The contractor to check all dimensions on site and relate to these drawings. The contractor to report any discrepancies to designers prior to construction. All services to local authorities, BCO & Environmental Health requirements and to Service Engineers.  
 All structure to Structural Engineer's details and local authority and BCO requirements. All construction and materials to comply with the current Building and Fire Regulations.

REVISION	Rev No.	Date	Description
A	April '16	Revised following LPA's pre-application input	
B	June '16	Revised following tree survey.	
C	June '16	Root protection areas indicated.	

previous studio footprint  
 1. Smaller footprint April 2016: revised following LPA pre-application feedback. Cross refer to tree & structural reports for approach to foundations.

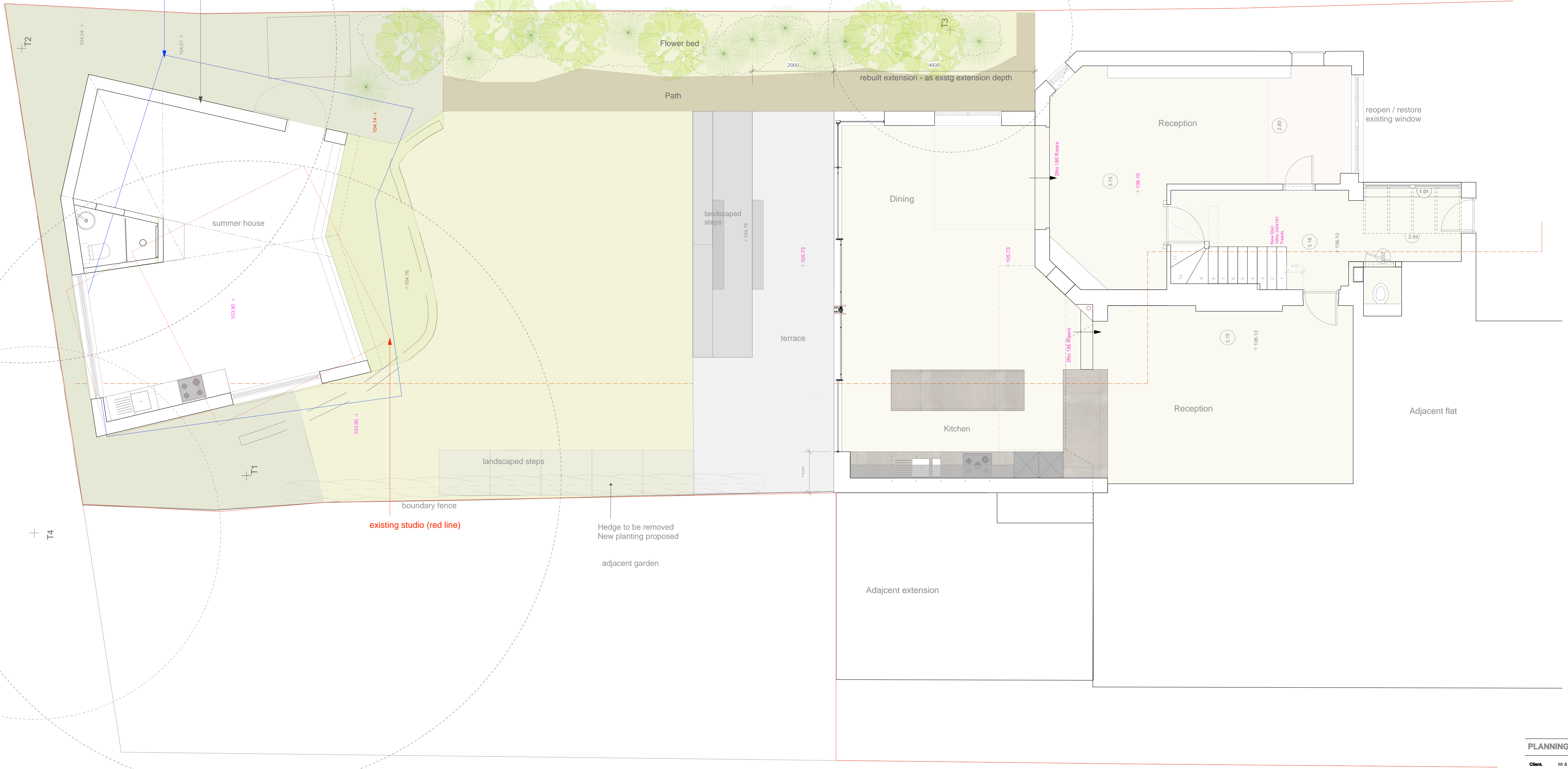

Proposed Ground Floor Plan 1:50

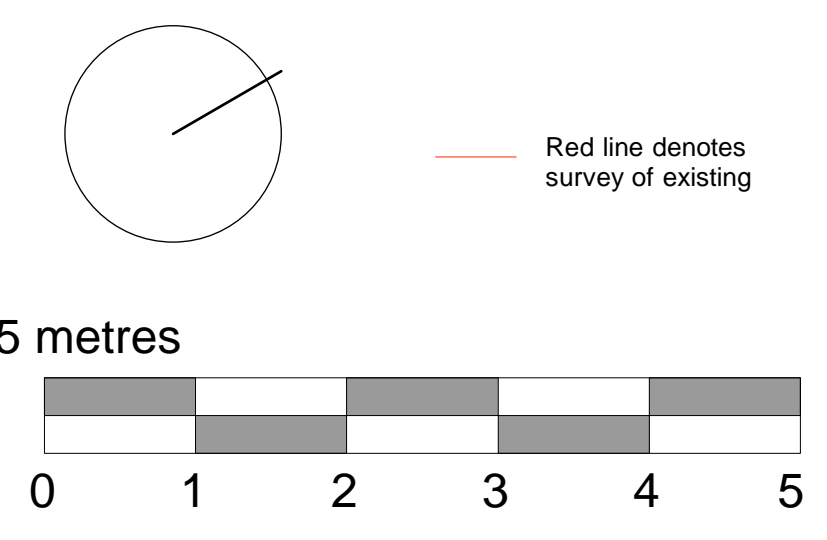

PLANNING	
Client:	Mr & Mrs Bartlett
Job:	40 B Hollycroft Avenue London NW3 7QN
Title:	Proposed Ground Floor Plan
Date:	Feb 2016
Drawn by:	WI
Checked By:	AN
Scale:	1:50 @ A1
Drawing No.:	1512-100
Revision:	C

**fabric space**  
 Studio 2.01, Canterbury Court  
 1-3 Brixton Road, London SW9 6DE  
 t: +44 20 7793 2888  
 e: info@fabric-space.com  
 www.fabric-space.com