

notes
 1. THIS DRAWING IS TO BE READ IN CONJUNCTION WITH ALL RELEVANT ARCHITECT'S AND ENGINEER'S DRAWINGS AND THE SPECIFICATIONS.

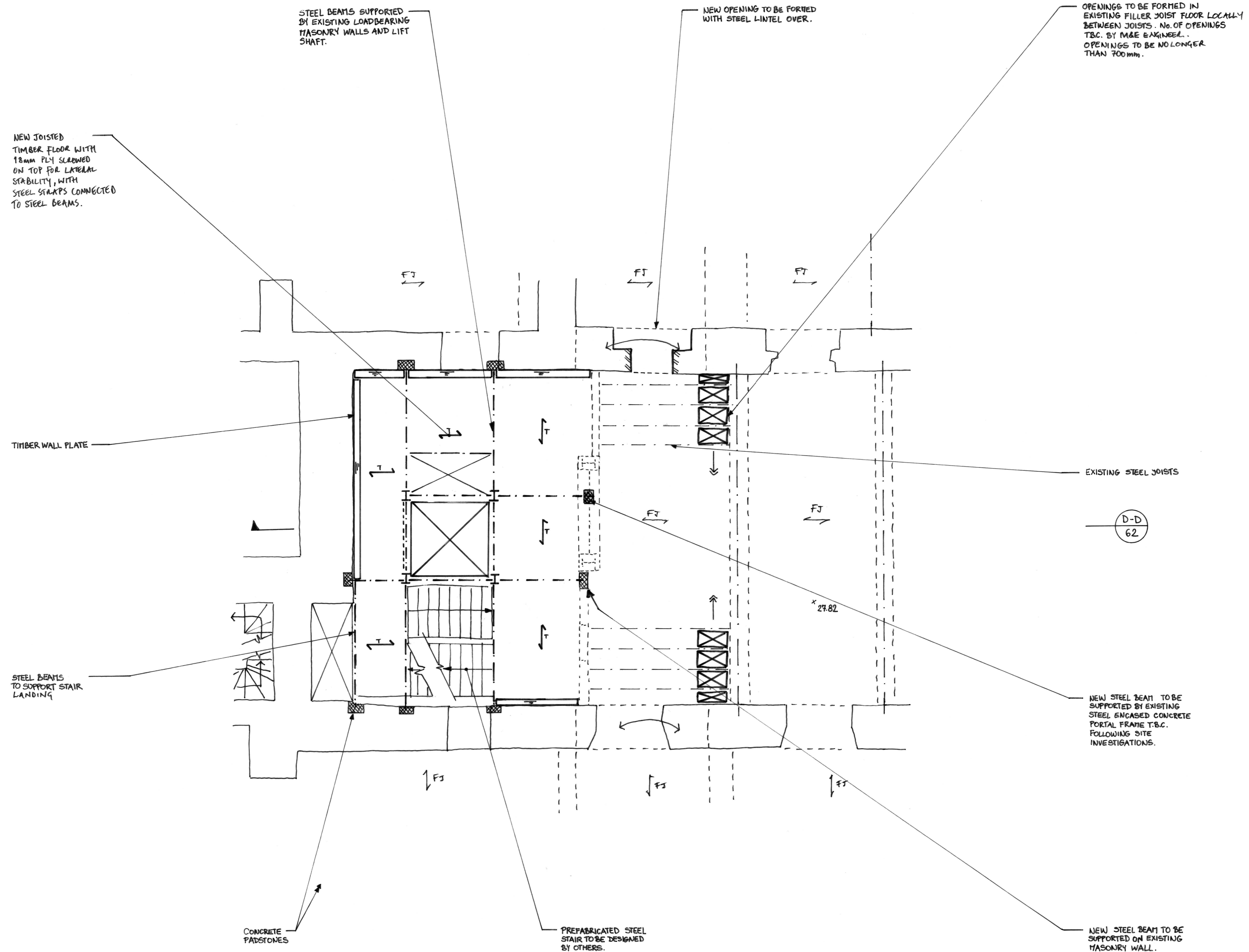

1.6.16 ISSUED FOR PLANNING LK

job
**BRITISH MUSEUM
 WHITE WING -
 CRAWFORD STAIR**

title
**PROPOSED STRUCTURE
 LEVEL 2 PLAN**

drawn
 LK
 date
 MAY '16

checked
 fw
 scale (original - A1)
 1:50

Alan Baxter

75 Cowcross Street London EC1M 6EL
 tel 020 7250 1555
 email aba@alanbaxter.co.uk
 www.alanbaxter.co.uk

drg. no.
0699/454/65

rev.
 -