

STEEL BEAMS  
 200mm DP X 100mm WD  
 SPANNING BETWEEN  
 MASONRY WALLS.  
 BEAMS ARE  
 SUPPORTING WATER  
 TANK.  
 BEAMS ARE APPROX.  
 215mm ABOVE  
 FLOOR LEVEL.

ASSUMED  
 MASONRY WALL  
 FORMING ENCLOSURE  
 TO PLANT AREA,  
 SUPPORTED  
 BY R.C. FLOOR  
 SLABS.

WATER TANK  
 3030mm LONG  
 X 1500mm WIDE  
 X 750mm HIGH.

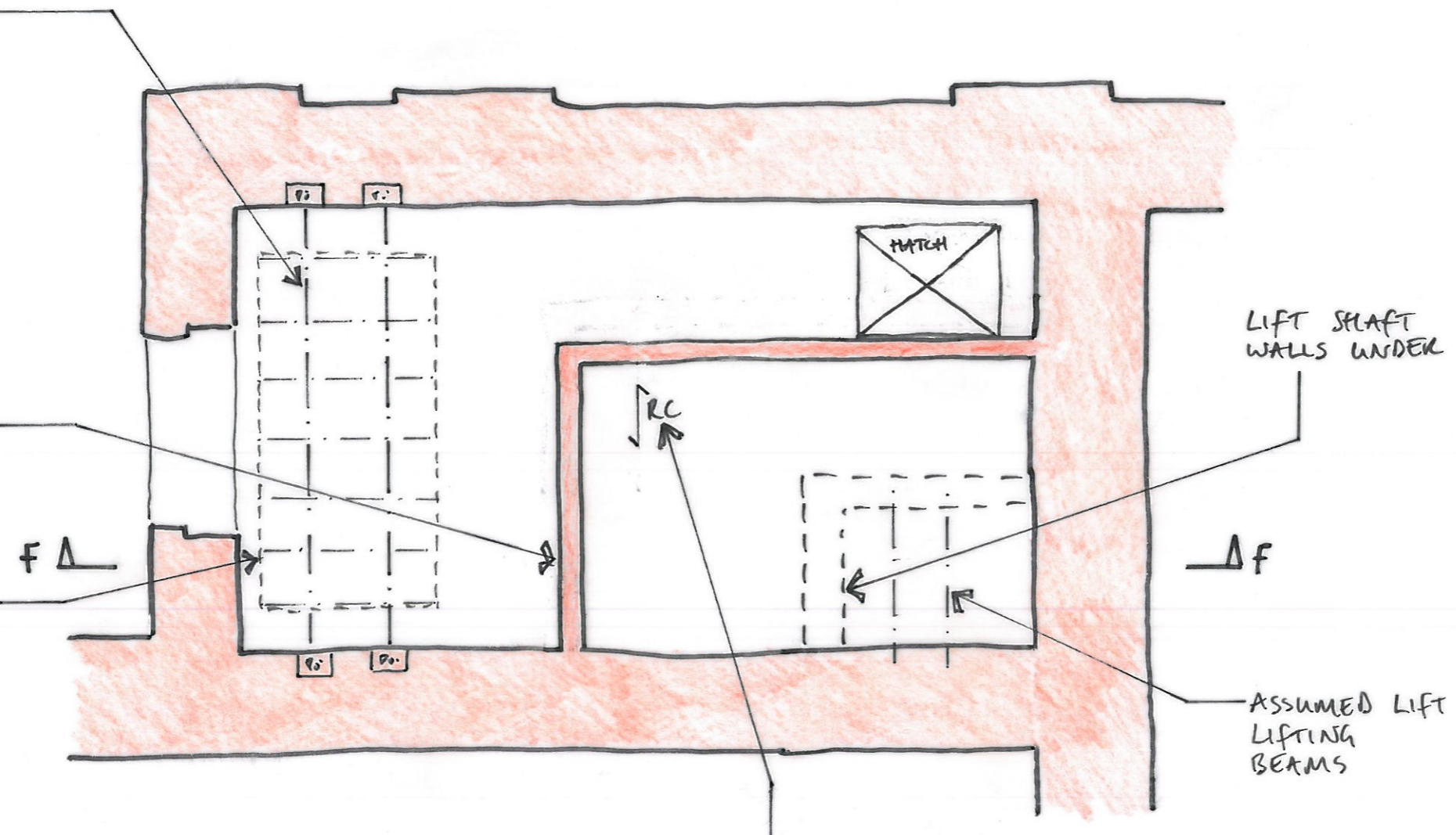

LIFT SHAFT  
 WALLS UNDER

ASSUMED LIFT  
 LIFTING  
 BEAMS

ASSUMED R.C. FLOOR  
 SLAB SPANNING  
 BETWEEN LOAD BEARING  
 MASONRY WALLS.  
 SLAB DEPTH APPROX.  
 260mm.

-	1.6.76	ISSUED FOR PLANNING	
job	BRITISH MUSEUM WHITE WING		
title	EXISTING STRUCTURE PLANT ROOM ABOVE LEVEL 6 AT ROOMS 42 & 43.		
drawn	LK	checked	[Signature]
date	MAY '16	scale (original - A3)	1:50

# Alan Baxter

75 Cowcross Street London EC1M 6EL  
 tel 020 7250 1555  
 email aba@alanbaxter.co.uk  
 www.alanbaxter.co.uk

drg. no.	0699/454/20	rev.	-
----------	-------------	------	---