

SUB-CONTRACTOR OVERLAYS:

ROLTON M&E: --- --- ---  
(drawings '12-0083 M 515', '12-0083 M 547')

HARMONY TIMBER: --- --- ---  
(drawings 'f01047 ## Wall Layout' series)

job BACTON LOW RISE CAMDEN	drawn: 1:50 @A1 1:100 @A3	date: 06.16
drawing GENERAL ARRANGEMENT PLAN SECOND FLOOR BLOCK B2 EXTERNAL WALL LAYOUT	scale: 1:50 @A1 1:100 @A3	job no: 1952
note: all dimensions to be checked on site at commencement of the work. If this drawing exceeds the quantities in the bill of materials, the client shall be informed before the work is commenced. For all quantities in the bill of materials for planning application purposes do not scale, use dimensions, this drawing is for information only.	drawing no. GA-P-B2- L02	rev. as below

rev.	date	description	issued by	checked by
C1	03.06.16	first construction issue	RR	JD

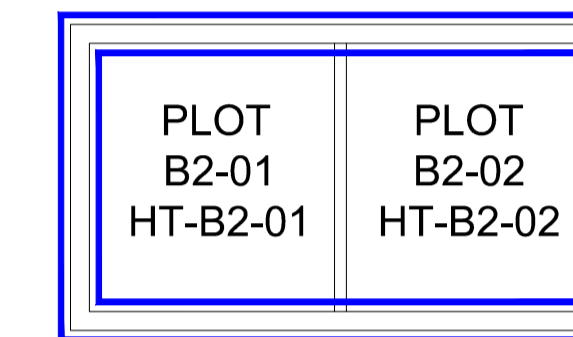
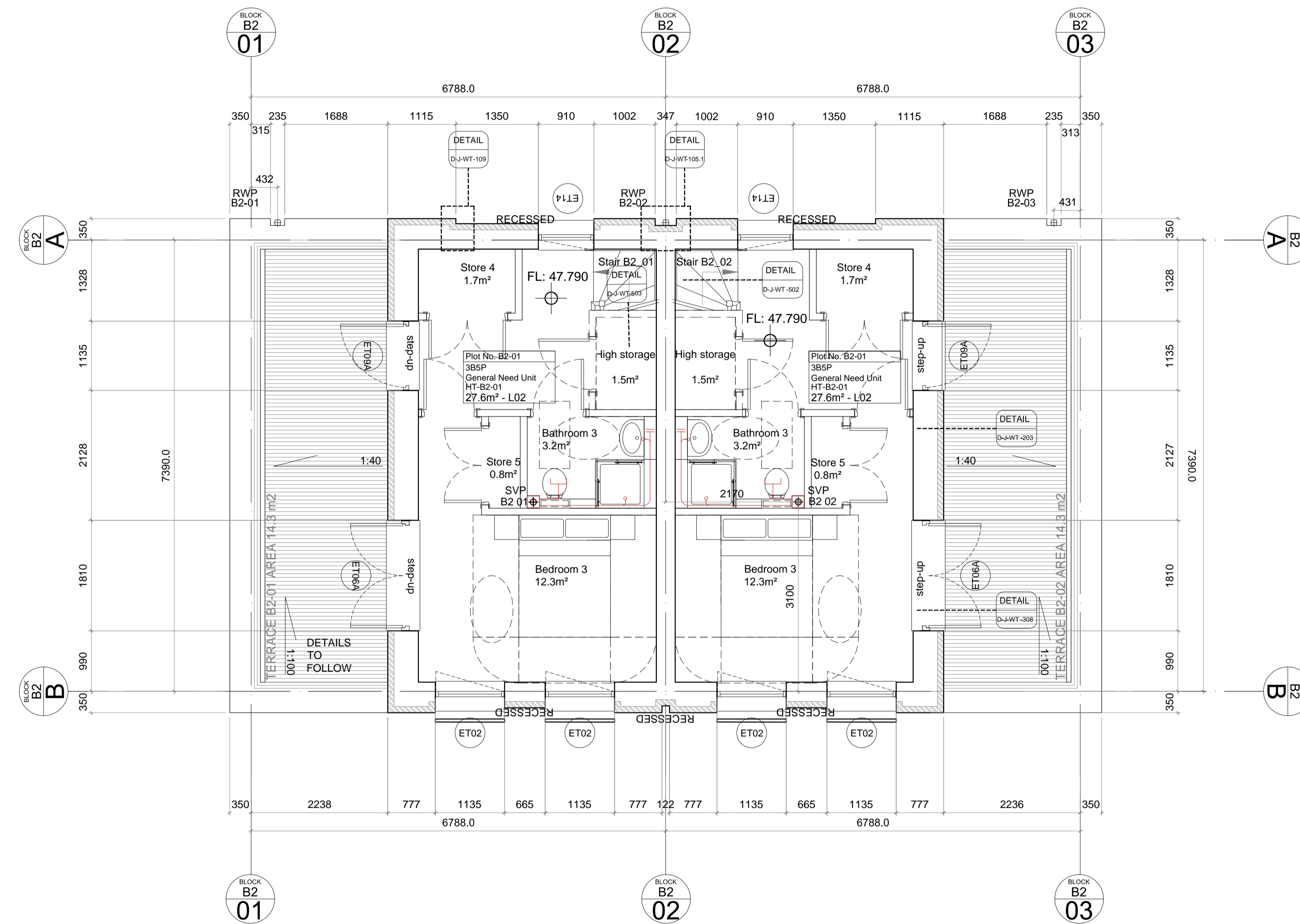

BLOCK B2 - ACOUSTIC KEY PLAN (NTS)

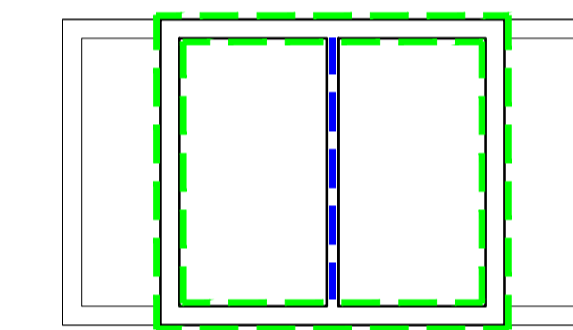

- KEY:
- REFER TO ACA D-TY SERIES
  - REFER TO GA-P FOR RECESS PANEL LOCATIONS, AS PER D-TY-WT-WT2
  - FOR ALL INTERNAL PARTITION WALLS NOT INDICATED IN KEY PLAN, REFER TO D-TY-WT-PT2
  - WT1 (WT2 WHERE RECESS PANEL)
  - PW1
  - PT1

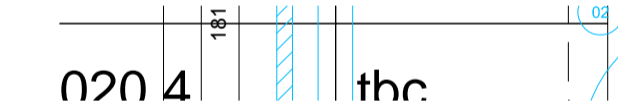

BLOCK B2 - WALL TYPE KEY PLAN NTS

LOCATION PLAN 1:1000

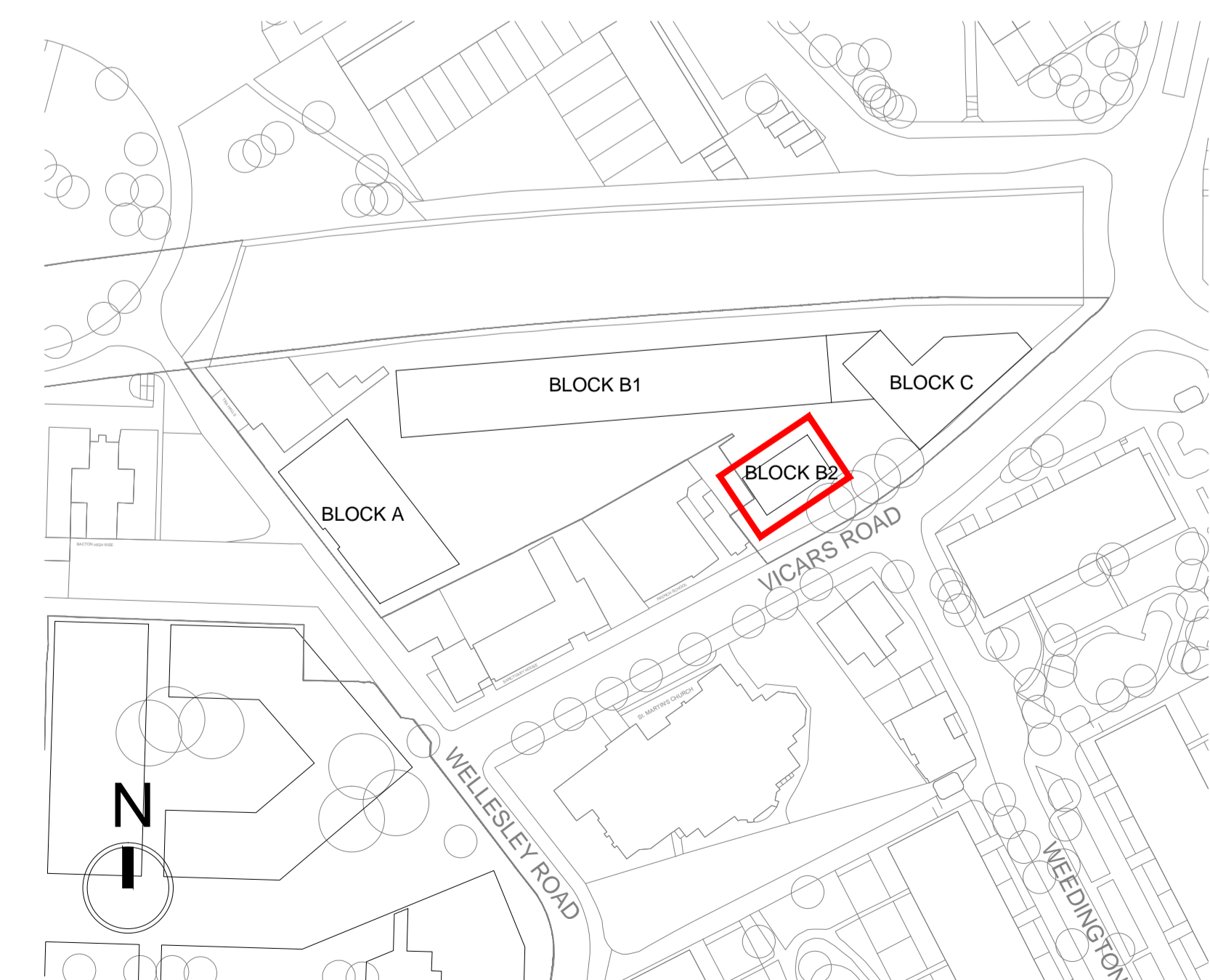

DHO SITE - BLOCK B2 SECOND FLOOR PLAN

