

SUB-CONTRACTOR OVERLAYS:
ROLTON M&E: ——— (drawings '12-0083 M 515', '12-0083 M 547')
HARMONY TIMBER: ——— (drawings 'f01047 ## Wall Layout' series)

job	BACTON LOW RISE CAMDEN	drawn	RR	date	06.16
drawing	GENERAL ARRANGEMENT PLAN FIRST FLOOR BLOCK B2 EXTERNAL WALL LAYOUT	scale:	1:50 @ A1 1:100 @ A3	job no:	1952
drawing no.	GA-P-B2- L01	rev.	as below		

rev.	date	description	issued by	checked by
C1	03.06.16	first construction issue	RR	JD

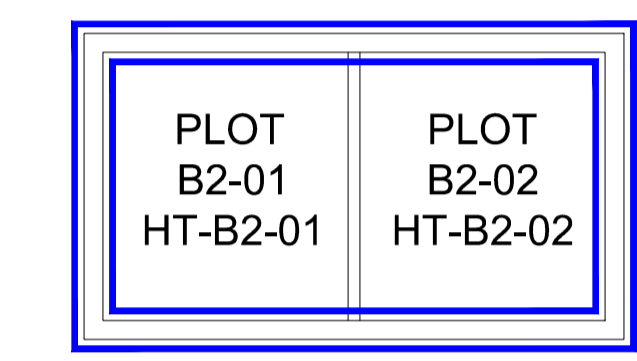
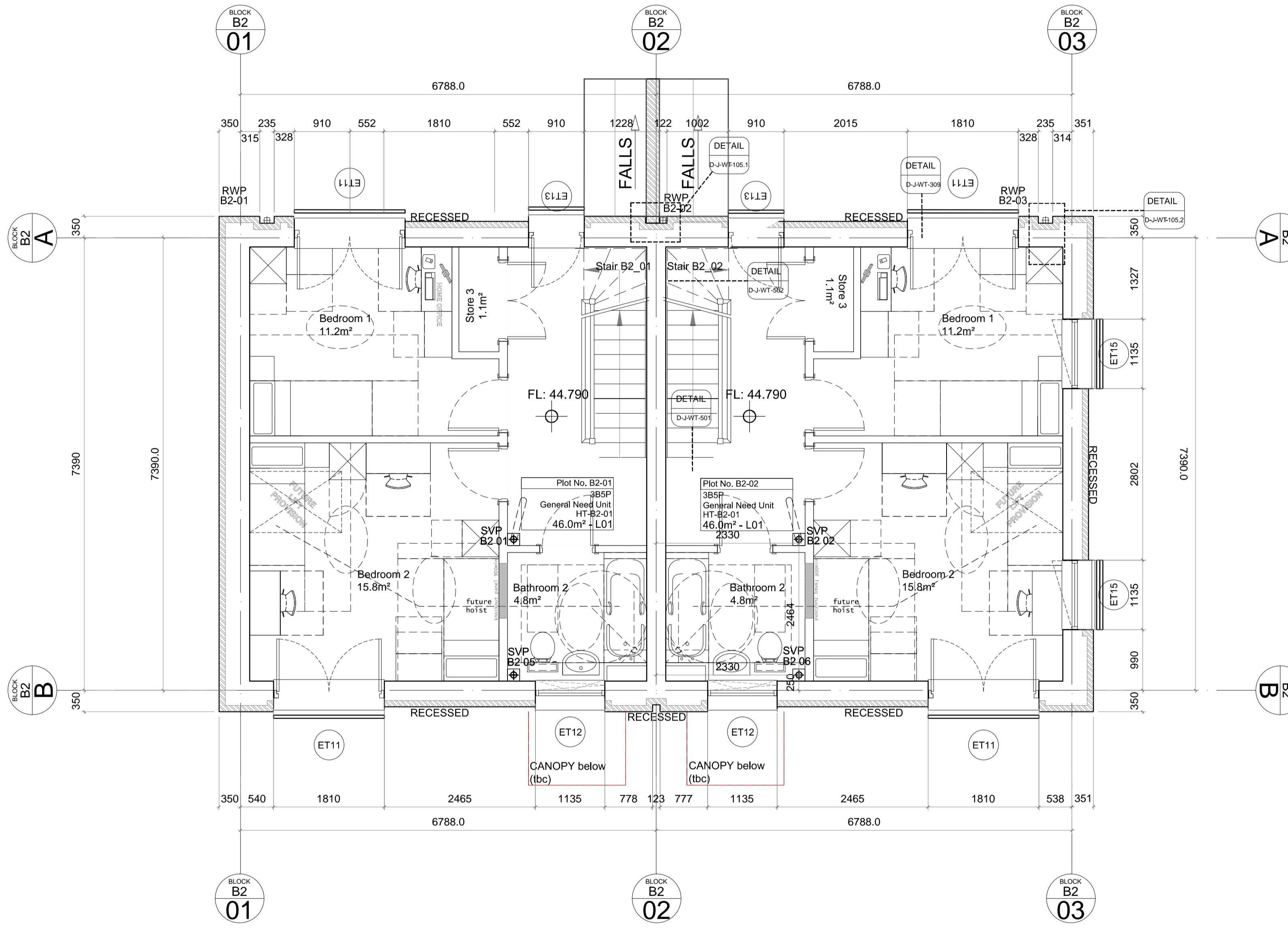

BLOCK B2 - ACOUSTIC KEY PLAN (NTS)

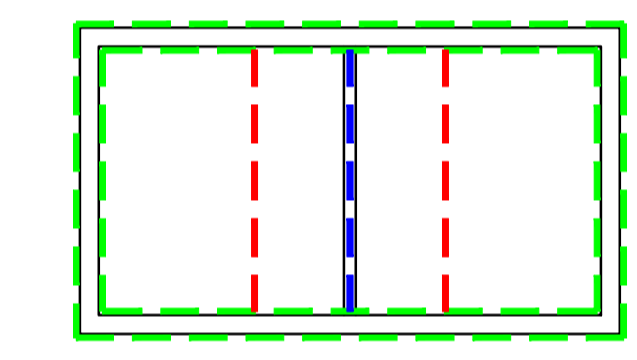

BLOCK B2 - WALL TYPE KEY PLAN NTS

- NOTES:**
- Kitchen Types based on "Commodore Kitchens Rev E" layouts received 14.10.14
 - m2 (GIA) areas notes
 - RC structure to be based on SE structural layouts received 12.09.14
 - External works paving types based on Oakden Landscape designs layouts dated 14.03.05
 - Based on CLT layouts 03.08.14
 - structural walls dimensioned to finishes
 - internal partitions dimensioned to finishes
 - Preferred external rain water pipes shown
 - Preferred expansion joint locations based on Ancon mark-ups dated 02.06.14
 - Fall arrest layout based on Walksafe by Latchways dated 07.05.13; Project reference number 4782-06 Rev A
 - Door reference numbers as per SC-IO to follow
 - Door x-x measures 300mm clear on pull side of door
 - Indicative service riser dimensions (details to be provided by M&E engineer)
 - Kitchen type reference as per SC-KT to follow
 - [MR] denotes moisture resistant plasterboard
- TO BE READ IN CONJUNCTION WITH**
- Survey Information dwg: 16181_OGL GreenHatch Group Topographical Survey dated 23.09.11
 - Landscape based on Camlins dwgs dated 05.07.2013
 - Specialist Landscape Consultant details to follow
 - "GA-E series" elevation dwgs
 - "SC" series schedule dwgs to follow
 - M&E Engineer's Drawings
 - Engineer's Drawings
 - Land Registry Plan NGL23321 & NGL940868

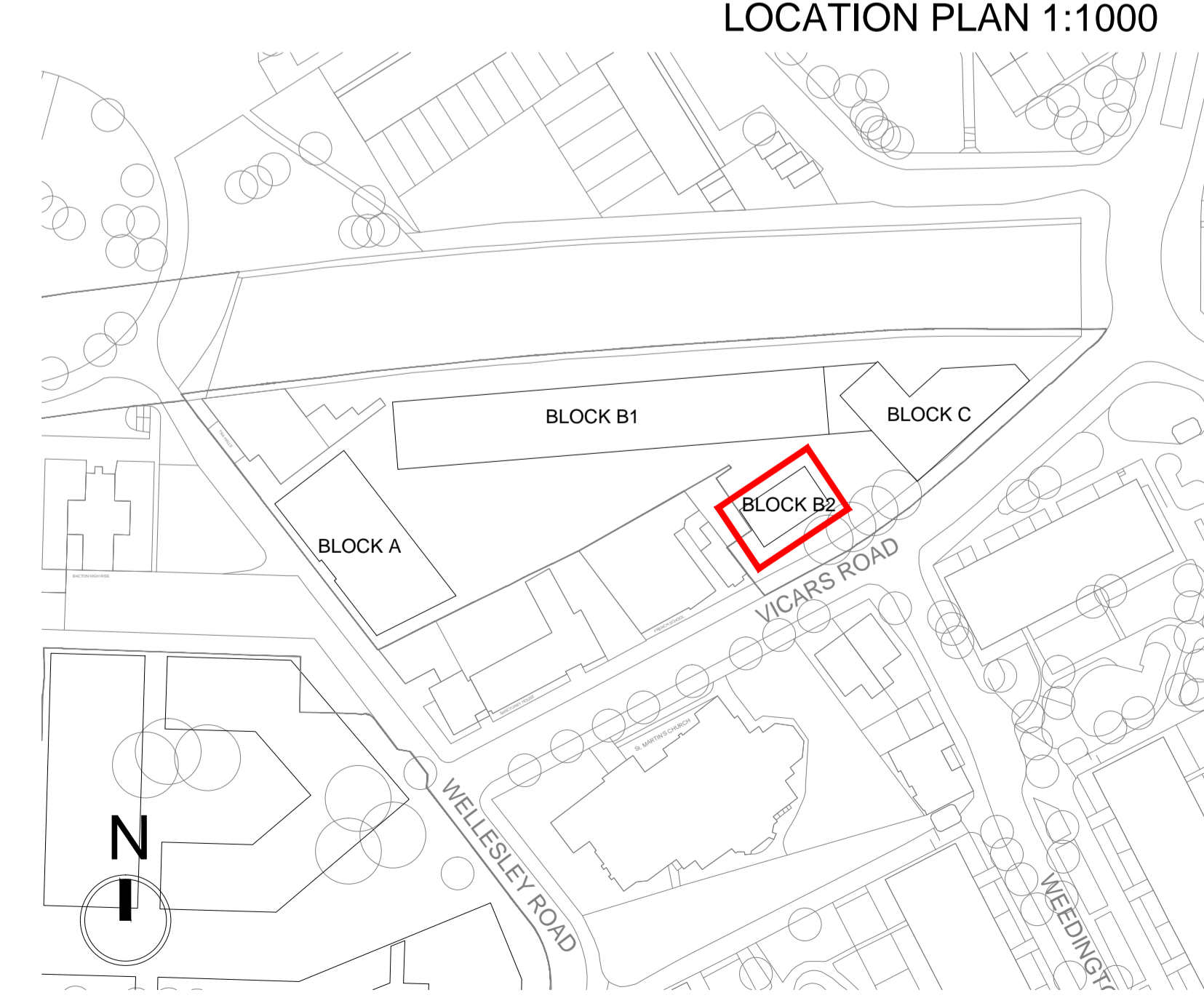

LOCATION PLAN 1:1000

DHO SITE - BLOCK B2 FIRST FLOOR PLAN

