

5 no Air Conditioning pipework drops to low roof, runs horizontal and drops again on wall face to high level and enters building at high level ground floor.

Edge of Low Roof

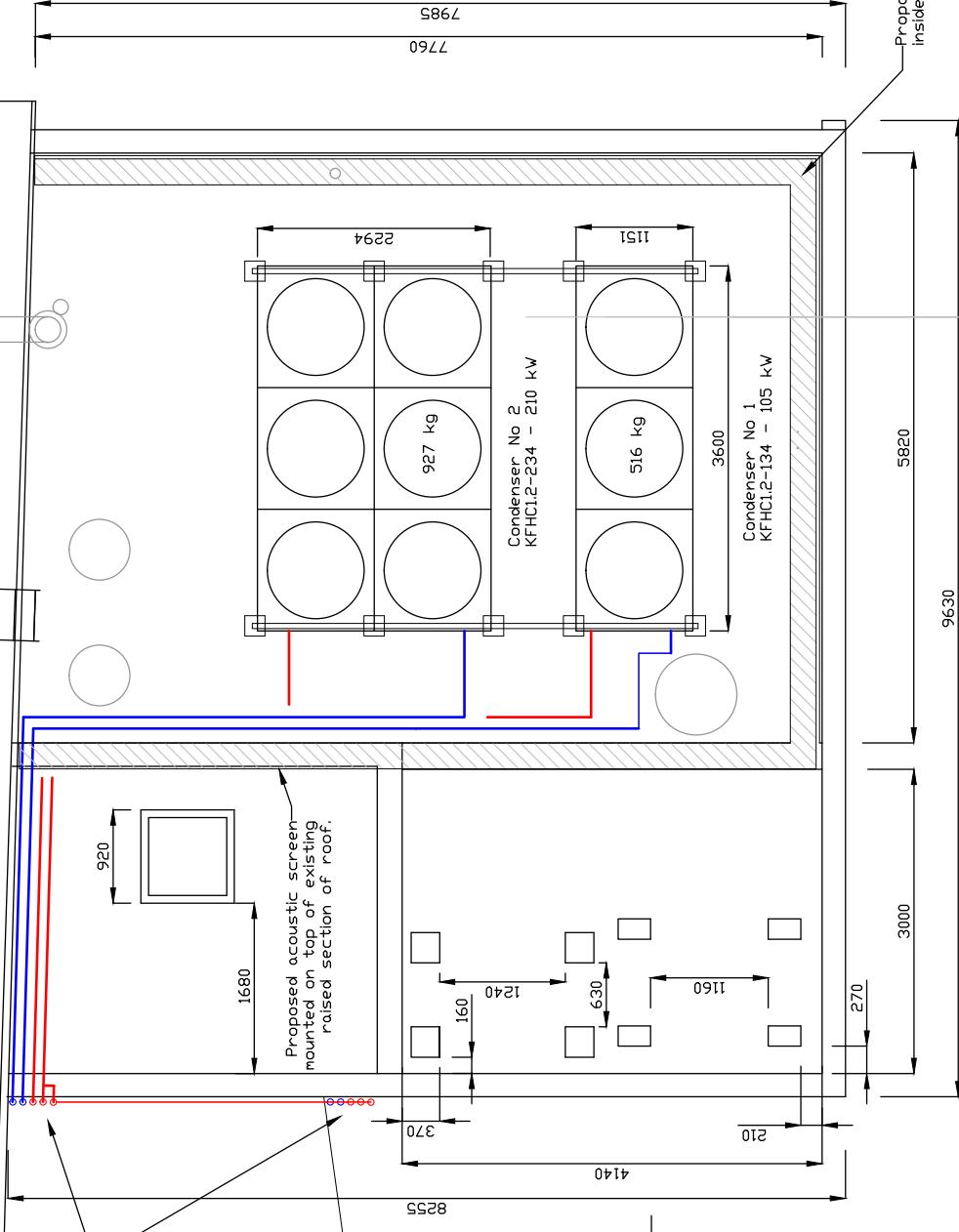

MODIFIED TANK ROOM LAYOUT

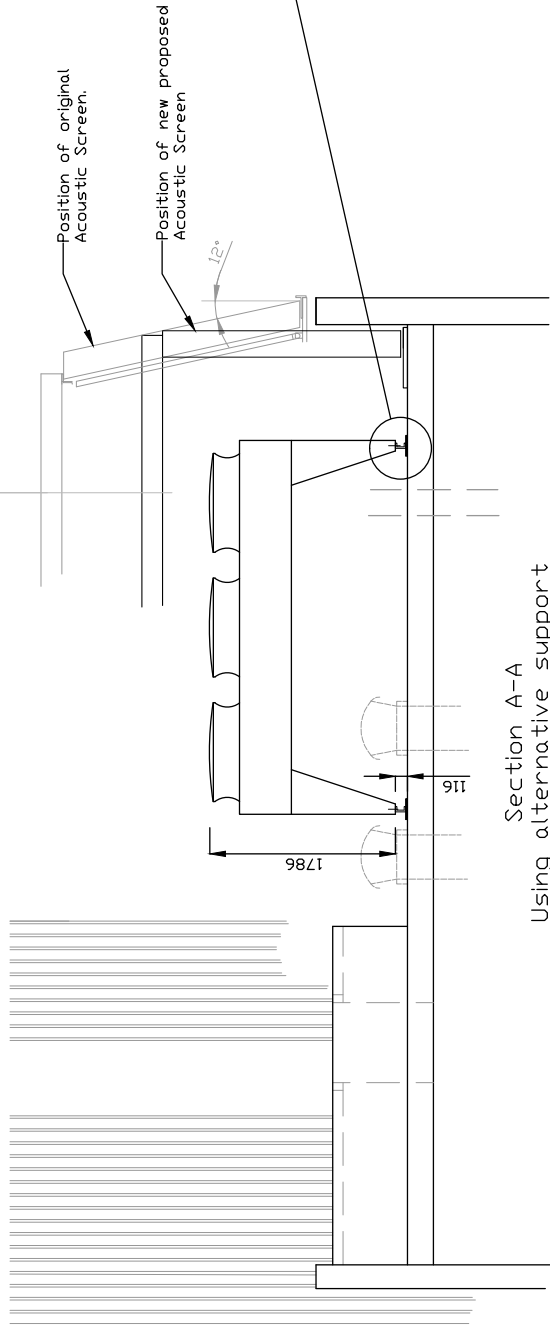

Section A-A
Using alternative support system e.g. 'Big Foot'

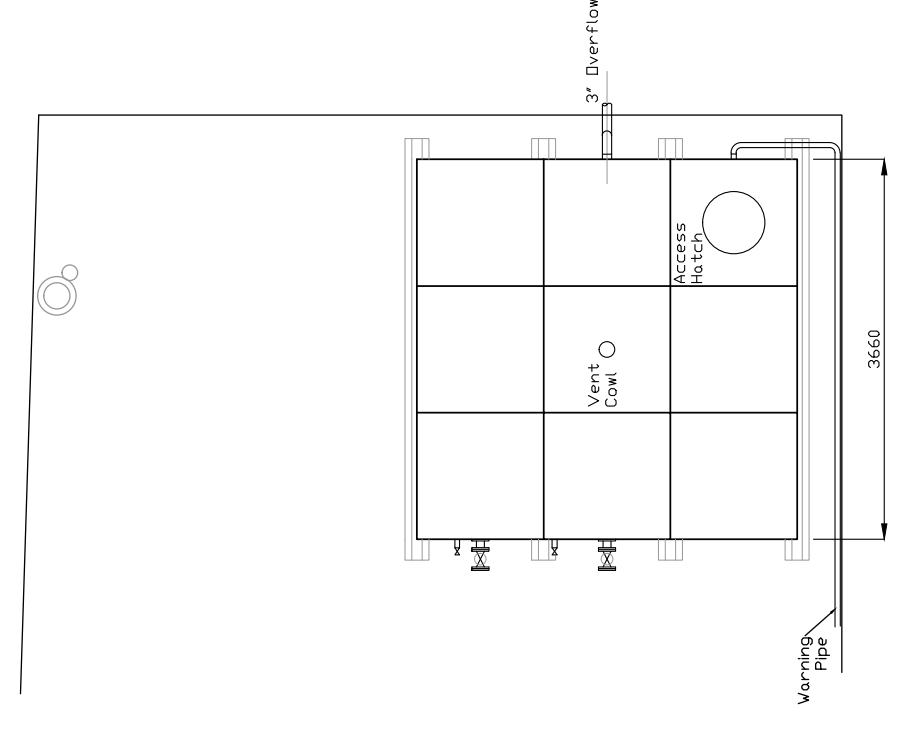
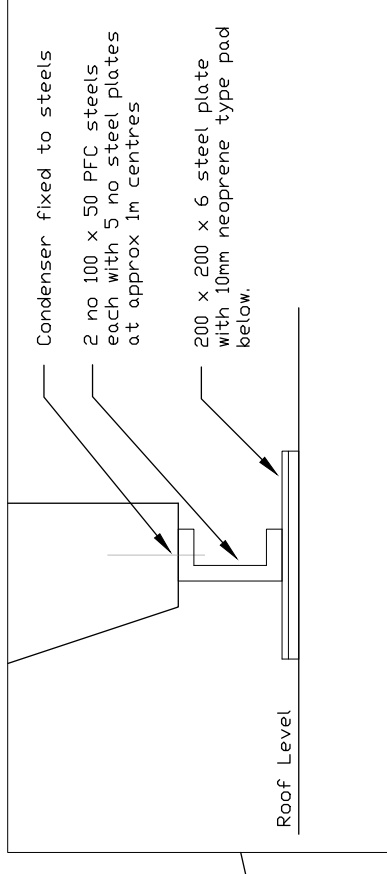

Rev C - Proposed acoustic screen shown to surround plant area only - 22 April 16

Rev B - New access hatch framed out with steel beams anchored to wall of tank room as advised by Fenton Holloway. - 15 April 16

Rev A - Condenser support method changed to suit structural engineers comments. Proposed modified acoustic screen shown - 13 April 16

Rev D - Proposed new Access Hatch omitted from contract - 29 April 16



Comfort Service & Maintenance Ltd
comfort works, newchapel road
lingfield, surrey, rh7 6le

Title: Proposal for Chiller No 1 alteration to Air Cooled DX System - Roof Layout
Client: Really Useful Group Theatres

Scale: 1:50 @ A2
Date: 3 Mar 16
Drawn By: MFP

Project: New London Theatre
Drawing No: S11340/9 Rev D
Air Conditioning Engineers
Tel: 01342 830600 Fax: 01342 830605
Email: service@comfort.uk.com