

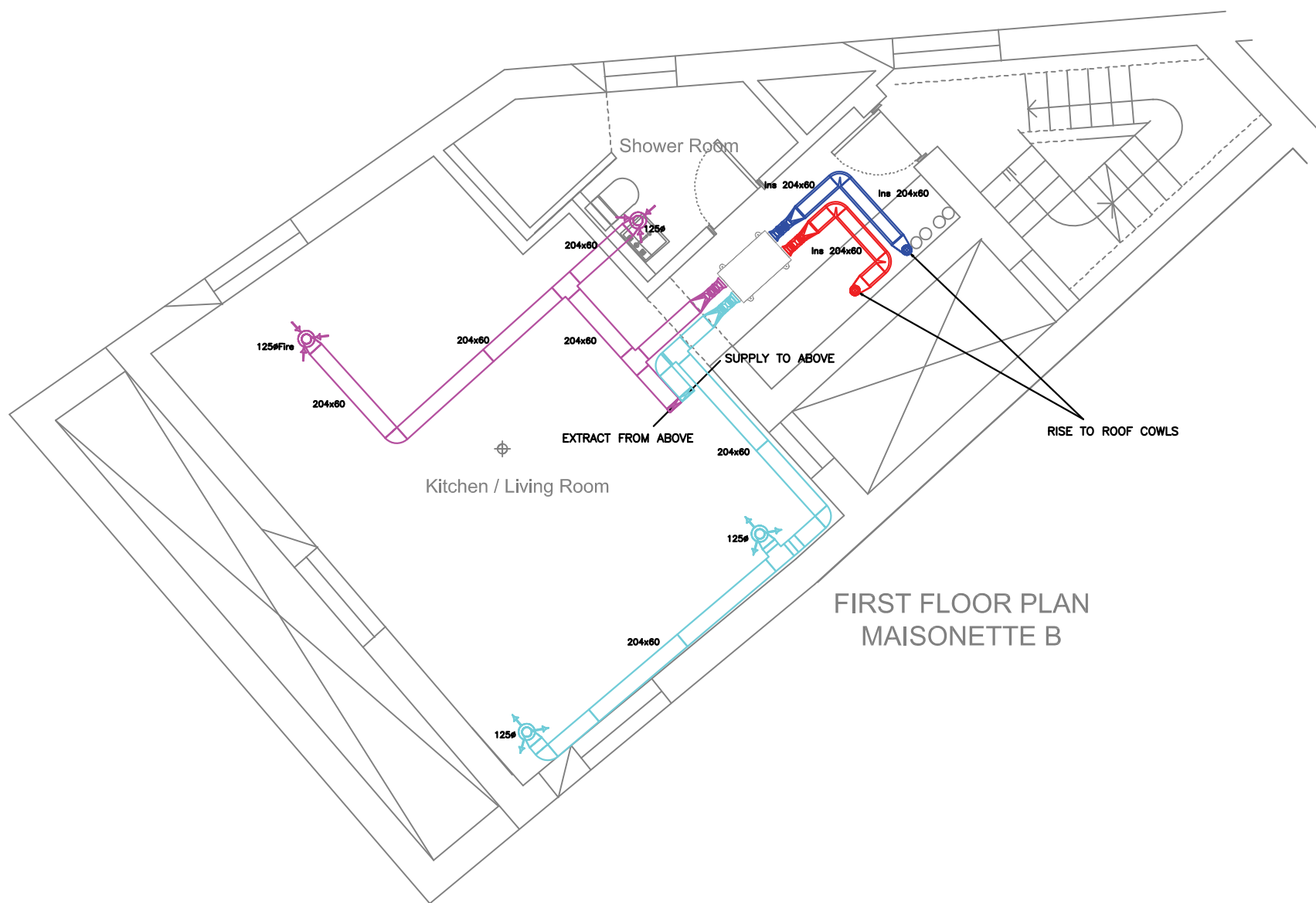

Project No.	Drawing No.	Revision.
QRXG 62615	2-1	A

Legend

- Round Uninsulated
- Round Insulated
- Rectangular Uninsulated
- Rectangular Insulated
- Supply
- Extract
- Inlet
- Outlet
- Fire Collar
- Condensate Drain



1. Unit(s):- Stratum 275 QVI MVHR unit vertically Mounted as indicated.
2. The position of the ventilation unit and the duct runs are indicative only.
3. The external discharge termination should be positioned 2m apart in accordance with current Building Regulations.
4. The system utilises insulate rigid ducting 150mm & 125mm dia. Along with 204x60mm rigid rectangular ducting. Also insulated flexible and rigid ducting.
5. A condensate drain must be fitted to run to the building waste water system in accordance with the Building Regulation H1.
6. The condensate drain must be fitted with a water trap and should be insulated in unheated areas.
7. This proposal assumes that the ceiling void (Apartments require 150mm minimum)and void spaces are sufficient to allow for the ventilation unit & ducting.
8. All Ducting located in loft spaces roof voids etc which are unheated, must be insulated , together with the duct runs from the unit to atmosphere.
9. We have assumed that the installation balancing and commissioning of the ventilation systems will be to BPEC standards.
10. It has been assumed that provision has been made by others for a separate air supply to fixed equipment such as wood burning stoves and cooking ranges, to comply with the manufacturers recommendations and the current addition of document J of the Building Regulations.
11. Please note:-To reduce the possibility of air noise generation and to reduce the system resistance , we recommend a minimum rise of 750mm of flex/ducting off the ventilation units spigots.
12. It has been assumed there is a minimum of 1m clearance around the ventilation unit to allow for l access and maintenance.

Haverstock Hill & Prince of Wales Road
MVHR System

**First Floor
Maisonette B**

**Haverstock Hill & Prince of Wales Road
MVHR System**

Redring Xpelair Group

Redring Xpelair Group Limited
Newcombe House, Newcombe Way,
Orton Southgate, Peterborough,
Cambridgeshire, PE2 6SE
Telephone: +44(0) 1733 456789
Fax: +44(0) 1733 310606

Client:
VentfiltersRus Ltd
Project:
Haverstock Hill & Prince of Wales Road
Drawing:
Proposed MVHR continuous extract
incorporating heat recovery
ventilation system.

Date:
17/06/16

Design:
C.D.G. Scale:
1:75

Copyright © 2013 Redring Xpelair Group Ltd.

This design is the exclusive property of Redring Xpelair Group Ltd. The design drawing is strictly private and confidential and the copying, duplication or reproduction of the design is expressly forbidden without the written consent of Redring Xpelair Group Ltd. Any unauthorised amendments to the design will constitute an infringement of copyright and any deviation of the design may render the design ineffective which will consequently void any potential liability of Redring Xpelair Group Ltd for the performance of the design.

DO NOT SCALE

Legend

- Round Uninsulated
- Round Insulated
- Rectangular Uninsulated
- Rectangular Insulated
- Supply
- Extract
- Inlet
- Outlet
- Fire Collar
- Condensate Drain

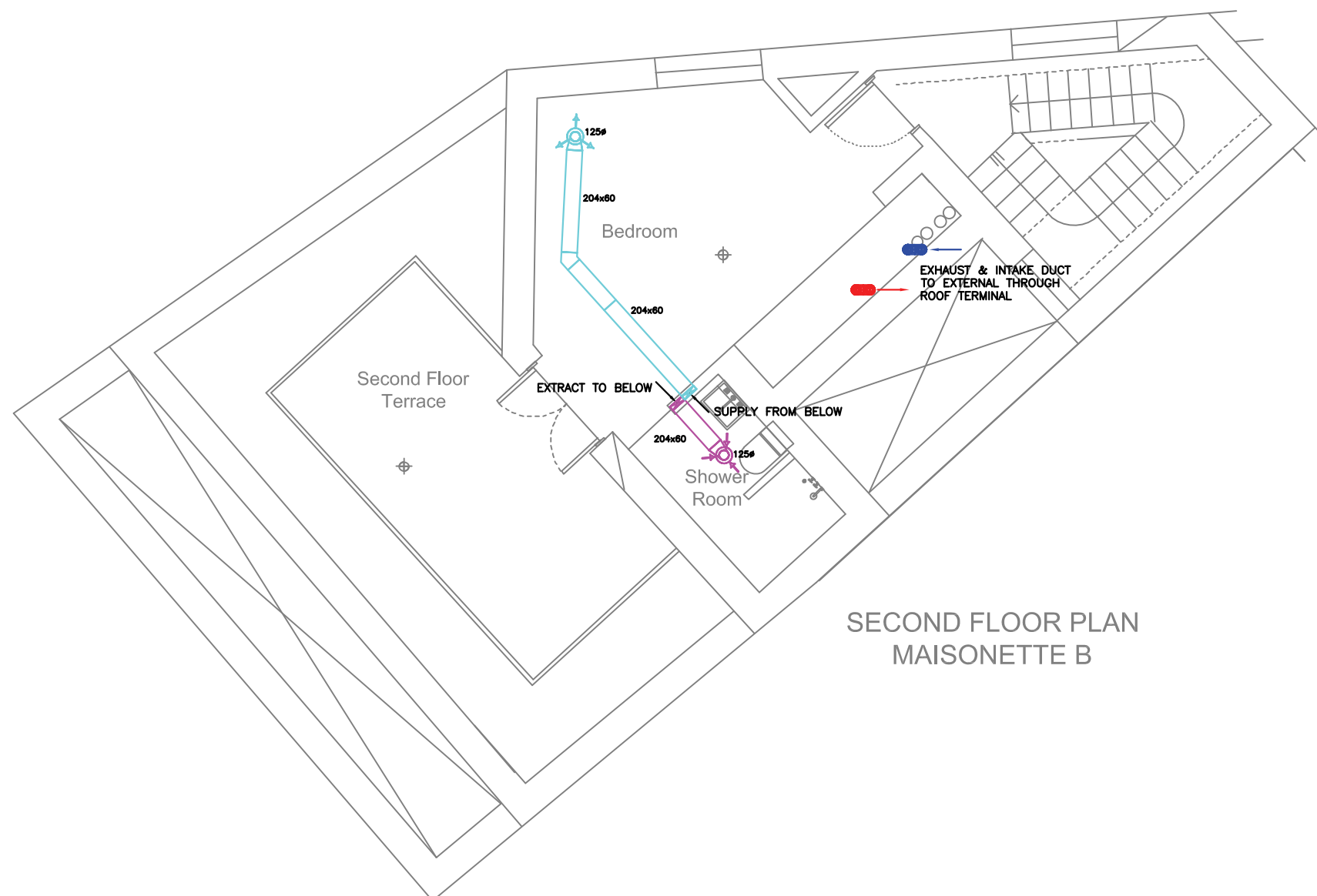

SECOND FLOOR PLAN
MAISONETTE B

Haverstock Hill & Prince of Wales Road
MVHR System

- Unit(s) - Stratum 275 QVI MVHR unit vertically Mounted as indicated.
- The position of the ventilation unit and the duct runs are indicative only.
- The external discharge termination should be positioned 2m apart in accordance with current Building Regulations.
- The system utilises insulate rigid ducting 150mm & 125mm dia. Along with 204x60mm rigid rectangular ducting. Also insulated flexible and rigid ducting.
- A condensate drain must be fitted to run to the building waste water system in accordance with the Building Regulation H1.
- The condensate drain must be fitted with a water trap and should be insulated in unheated areas.
- This proposal assumes that the ceiling void (Apartments require 150mm minimum) and void spaces are sufficient to allow for the ventilation unit & ducting.
- All Ducting located in loft spaces roof voids etc which are unheated, must be insulated, together with the duct runs from the unit to atmosphere.
- We have assumed that the installation balancing and commissioning of the ventilation systems will be to BPEC standards.
- It has been assumed that provision has been made by others for a separate air supply to fixed equipment such as wood burning stoves and cooking ranges, to comply with the manufacturers recommendations and the current addition of document J of the Building Regulations.
- Please note:-To reduce the possibility of air noise generation and to reduce the system resistance, we recommend a minimum rise of 750mm of flex/ducting off the ventilation units spigots.
- It has been assumed there is a minimum of 1m clearance around the ventilation unit to allow for access and maintenance.

Second Floor Maisonette B

Copyright © 2013 Redring Xpelair Group Ltd.

This design is the exclusive property of Redring Xpelair Group Ltd. The design drawing is strictly private and confidential and the copying, duplication or reproduction of the design is expressly forbidden without the written consent of Redring Xpelair Group Ltd. Any unauthorised amendments to the design will constitute an infringement of copyright and any deviation of the design may render the design ineffective which will consequently void any potential liability of Redring Xpelair Group Ltd for the performance of the design.

Haverstock Hill & Prince of Wales Road MVHR System

DO NOT SCALE

Redring Xpelair Group

Redring Xpelair Group Limited
Newcombe House, Newcombe Way,
Orton Southgate, Peterborough,
Cambridgeshire, PE2 6SE
Telephone: +44(0) 1733 456789
Fax: +44(0) 1733 310606











Client:
VentfiltersRus Ltd
Project:
Haverstock Hill & Prince of Wales Road
Drawing:
Proposed MVHR continuous extract
incorporating heat recovery
ventilation system.

Date:
17/06/16

Design:
C.D.G.

Scale:
1:75

Legend

-  Round Uninsulated
-  Round Insulated
-  Rectangular Uninsulated
-  Rectangular Insulated
-  Supply
-  Extract
-  Inlet
-  Outlet
-  Fire Collar
-  Condensate Drain

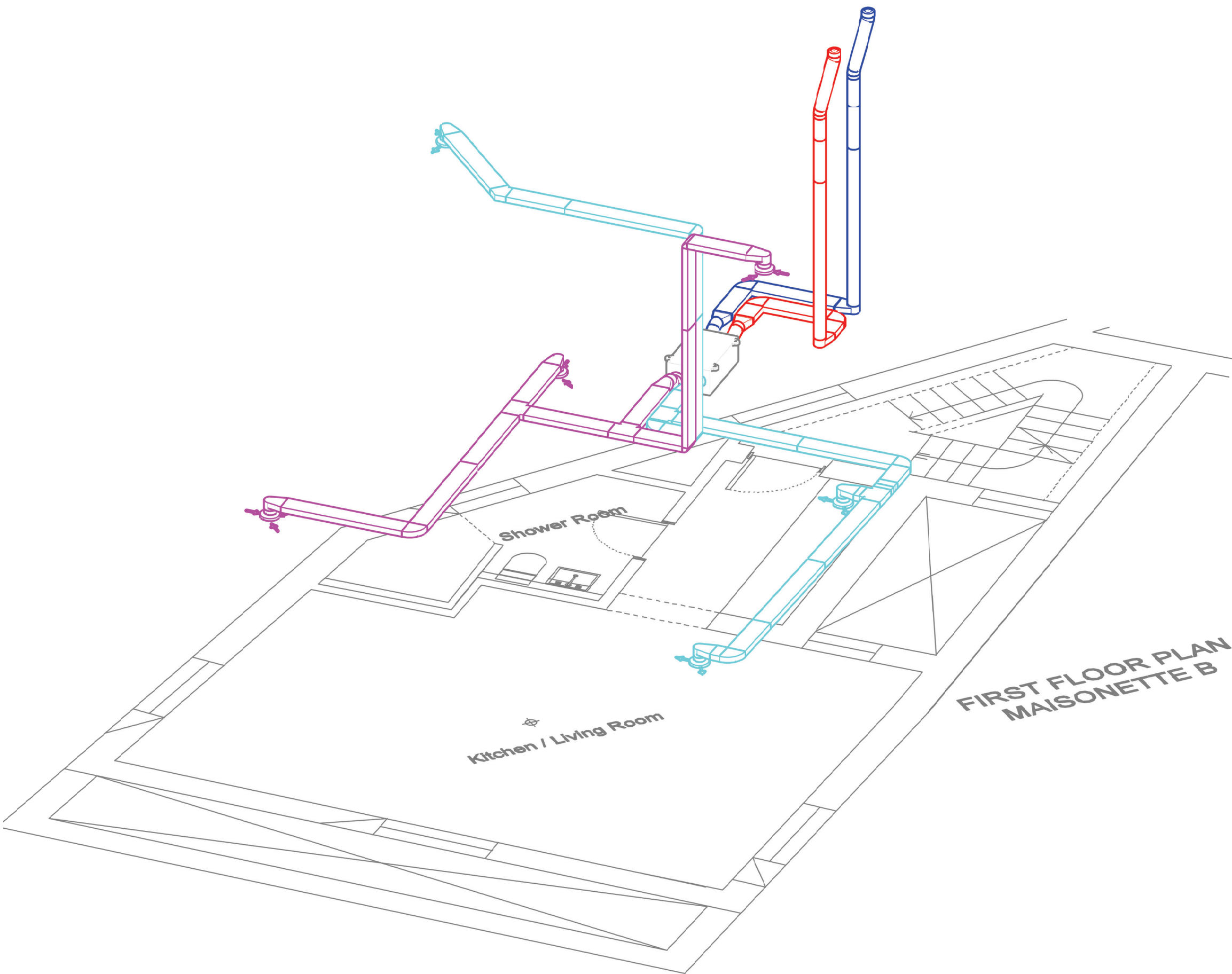

1. Unit(s):- Stratum 275 QVI MVHR unit vertically Mounted as indicated.
2. The position of the ventilation unit and the duct runs are indicative only.
3. The external discharge termination should be positioned 2m apart in accordance with current Building Regulations.
4. The system utilises insulate rigid ducting 150mm & 125mm dia. Along with 204x60mm rigid rectangular ducting. Also insulated flexible and rigid ducting.
5. A condensate drain must be fitted to run to the building waste water system in accordance with the Building Regulation H1.
6. The condensate drain must be fitted with a water trap and should be insulated in unheated areas.
7. This proposal assumes that the ceiling void (Apartments require 150mm minimum)and void spaces are sufficient to allow for the ventilation unit & ducting.
8. All Ducting located in loft spaces roof voids etc which are unheated, must be insulated , together with the duct runs from the unit to atmosphere.
9. We have assumed that the installation balancing and commissioning of the ventilation systems will be to BPEC standards.
10. It has been assumed that provision has been made by others for a separate air supply to fixed equipment such as wood burning stoves and cooking ranges, to comply with the manufacturers recommendations and the current addition of document J of the Building Regulations.
11. Please note:-To reduce the possibility of air noise generation and to reduce the system resistance , we recommend a minimum rise of 750mm of flex/ducting off the ventilation units spigots.
12. It has been assumed there is a minimum of 1m clearance around the ventilation unit to allow for l access and maintenance.

**Haverstock Hill & Prince of Wales Road
MVHR System**

**Isometric
Maisonette B**

**Haverstock Hill & Prince of Wales Road
MVHR System**

Copyright © 2013 Redring Xpelair Group Ltd.

This design is the exclusive property of Redring Xpelair Group Ltd. The design drawing is strictly private and confidential and the copying, duplication or reproduction of the design is expressly forbidden without the written consent of Redring Xpelair Group Ltd. Any unauthorised amendments to the design will constitute an infringement of copyright and any deviation of the design may render the design ineffective which will consequently void any potential liability of Redring Xpelair Group Ltd for the performance of the design.

 **Redring Xpelair Group**

Redring Xpelair Group Limited
Newcombe House, Newcombe Way,
Orton Southgate, Peterborough,
Cambridgeshire, PE2 6SE
Telephone: +44(0) 1733 456789
Fax: +44(0) 1733 310606

Client:
VentfiltersRus Ltd
Project:
Haverstock Hill & Prince of Wales Road
Drawing:
Proposed MVHR continuous extract
incorporating heat recovery
ventilation system.

Date:
17/06/16

Design:
C.D.G.

Scale:
N.T.S.

DO NOT SCALE