

- ANNOTATION KEY:
- 01 Existing windows to be refurbished throughout. Paintwork to be stripped back and re-painted in a 'bronze' colour (general note).
  - 02 Existing external Portland stonework to be repaired/cleaned to all elevations (general note) plus new pigeon deterrent applied.
  - 03 Existing signage/shopfront to retail unit at round-first floor to be retained. No works proposed to this area.
  - 04 Original Portland stone detailing and cornice work to be repaired/reconditioned where necessary
  - 05 Proposed set-back, toughened glass balustrade to roof terrace perimeter (incl. concealed up-lighter to base of glazed panel)
  - 06 New full height glazing to new elevation to provide service and maintenance access to existing external terrace (PPC frame/ RAL colour tbc). Refer To dwg 'P(-)23 for localised elevation and section.
  - 07 Perforated metal panels to form screening to roof level plant (2.5m above roof terrace ff)
  - 08 Applied through colour render (white finish) to extension of existing lift/stair core serving 7th floor roof terrace. PPC coping profile to head of rendered elevation (RAL colour tbc)
  - 09 Full height glazed frontage to 7th floor stair/lift core. To include full height glazed access doors to terrace area
  - 10 Existing service grilles/louvers replaced with metal framed glazed units to match existing unit within listed, southern facade i.e. to match original fabric.
  - 11 Glazed unit to be introduced to Portland stone facade to provide daylight to new atrium beyond. (PPC frame/ RAL colour tbc).

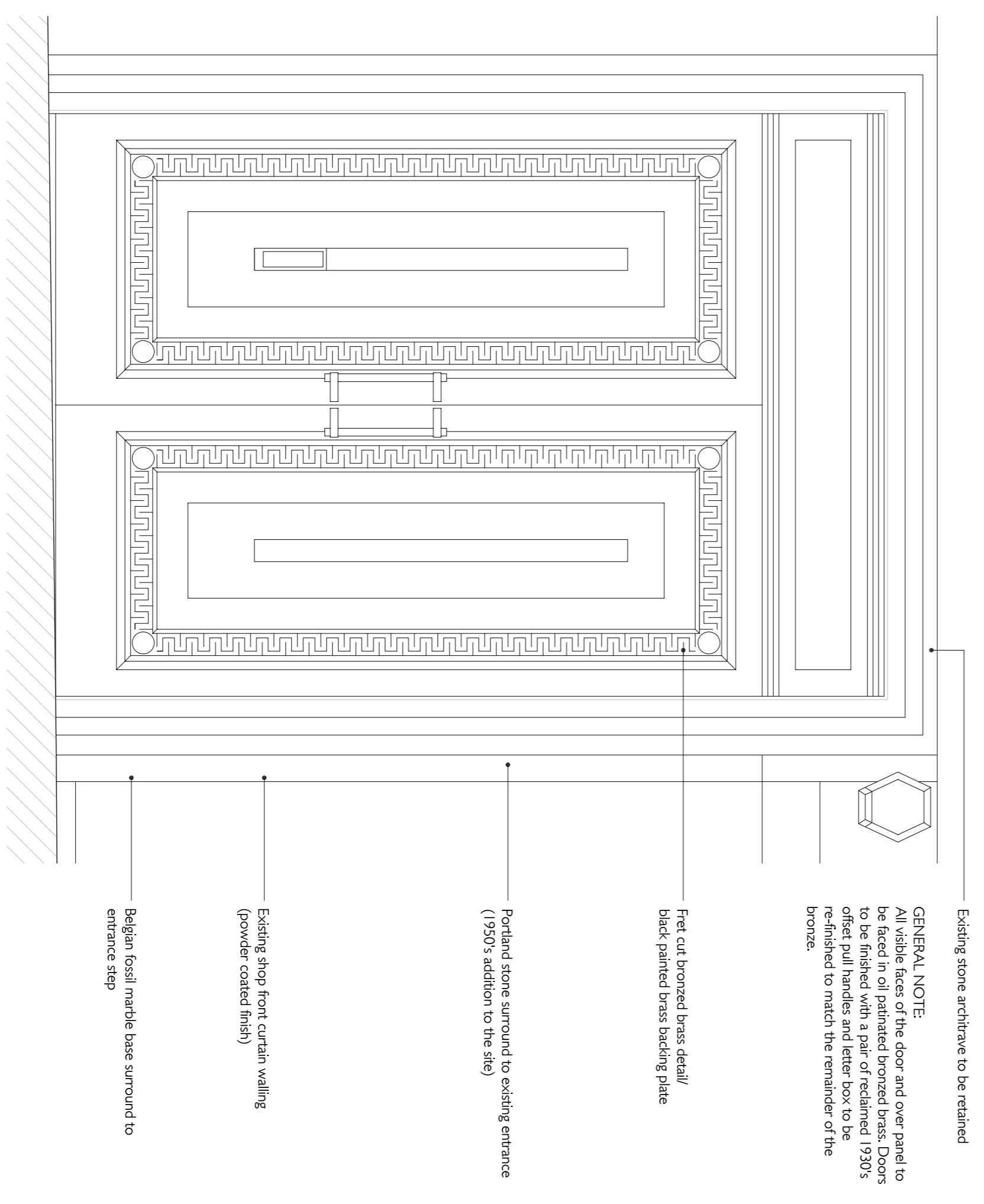

PROPOSED RECEPTION ENTRANCE - DETAIL 01  
SCALE 1:20

REVISION	DATE	BY	DESCRIPTION
1	17/06/16	DU	PLANNING SUBMISSION
2	18/07/16	DU	WINDOW POLLUTION AMENDMENT (ITEM 06)

DESIGNER	ARCHITECT	SCALE	DATE
TREHEARN ARCHITECTS	1:100	07/16	16/05

PROJECT	CLIENT
TOTTENHAM HOUSE	CORINTHIAN HOUSE
TOTTENHAM COURT ROAD, LONDON	

CONTACT	PHONE	EMAIL
020 7323 1775	07 16 1100@AI	1100@AI

PROJECT NO.	DRAWING NO.
1665	P(-)10

- GENERAL NOTE:
1. DO NOT SCALE FROM THIS DRAWING
  2. THE DIMENSIONS SHOWN ON THIS DRAWING ARE BASED ON SURVEY DATA PROVIDED BY FREEMER SURVEYS.
  3. ALL LEVELS AND DIMENSIONS TO BE CHECKED ON SITE AND ANY DISCREPANCIES NOTED TO THE ARCHITECT IMMEDIATELY.
  4. THIS DRAWING IS TO BE READ IN CONJUNCTION WITH ALL RELEVANT CONSULTANTS DRAWINGS AND SPECIFICATIONS.
  5. THIS DRAWING IS COPYRIGHT AND MUST NOT BE REPRODUCED WITHOUT THE PRIOR WRITTEN AGREEMENT OF THE ARCHITECT.

- REFERENCES:
1. Refer to 'P(-)100' for elevation views