



Proposed Restoration of Athlone
House, Hampstead Lane, London

Transport Statement

For

SHH Architects

Document Control Sheet

Transport Statement

Athlone House, Hampstead Lane

SHH Architects

This document has been issued and amended as follows:

Date	Issue	Prepared by	Approved by
17 June 2016	1st Draft	Peter Sturgeon	Peter Sturgeon
21 June 2016	Final	Peter Sturgeon	Peter Sturgeon

Contents

1.0	Introduction.....	1
2.0	Baseline Conditions.....	2
3.0	Proposed Access Arrangements.....	4
4.0	Parking and Servicing	6
5.0	Summary and Conclusion	7

Figures

- 2.1 Site Location Plan

Appendices

- A Site Location Plan
- B ATC Data
- C PTAL Report
- D Proposed Site Access
- E Pre Application Correspondence with London Borough of Haringey
- F Proposed Site Access Detailed Design Drawings
- G Road Safety Audit
- H Swept Path Analysis

1.0 Introduction

- 1.1 Motion has been appointed by SHH Architects to provide transport guidance and advice on the restoration proposals for Athlone House on Hampstead Lane in Camden. The restoration will allow the use of the building as a family home. There are also two smaller houses on the site, The Gate House and Caenwood Cottage, which will also be restored and will be used for staff/guest/security accommodation. Access to the site is currently by way of an access from Hampstead Lane, which also serves Caenwood Court, an adjacent residential development.
- 1.2 Athlone House is a grand building originally constructed as a family home in about 1870 and was occupied as a family dwelling until 1942. It was then used by the RAF and subsequently as a convalescent home until 2003 when the site was sold. Caenwood Court, a residential development of 3 apartment buildings, was then constructed on the eastern part of the original site. A site location plan is attached at **Appendix A**. Planning permission for the demolition of Athlone House and construction of a new house was refused at appeal last year, application reference 2013/7242/P.
- 1.3 The restoration proposals include the provision of a new dedicated point of access to the site, an extension to Athlone House and Caenwood Cottage as well as landscaping works.
- 1.4 The remainder of this report comprises four sections as follows:
 - ▶ **Section 2** – Baseline Conditions;
 - ▶ **Section 3** – Proposed Access Arrangements;
 - ▶ **Section 4** – Parking and Servicing; and
 - ▶ **Section 5** – Summary and Conclusions.

2.0 Baseline Conditions

Existing Site Use

- 2.1 Athlone House, Caenwood Cottage and The Gate House are all currently vacant and have not been in use for a number of years. Access to the site is by way of a shared access with Caenwood Court, located at the north eastern corner of the site.

Strategic Location

- 2.2 The site is located on Hampstead Lane, adjacent to the north eastern extent of Hampstead Heath. The site is bound by Hampstead Lane to the north, Hampstead Heath to the south and west and Caenwood Court to the east. The site is located at the northern extent of the London Borough of Camden, with Hampstead Lane lying within the London Borough of Haringey.

Local Highway Network

- 2.3 Hampstead Lane a two-lane single carriageway road that provides access to Highgate to the east and, via Spaniard Road, the A502 North End Way/Heath Street to the south west. Hampstead Lane is subject to a 20mph speed limit, which was introduced throughout the borough of Haringey in March 2016, with the exception of some main roads and roads managed by Transport for London. An Automatic Traffic Count (ATC) was carried out on Hampstead Lane outside the site from Saturday 4th June 2016 to Monday 6th June 2016. This showed that average speeds on Hampstead Lane are just under 30 mph. A copy of this data is attached at [Appendix B](#).

Accessibility by Foot

- 2.4 Pedestrian footways are provided on both sides of Hampstead Lane in the vicinity of the site. These provide access to shops, restaurants and other local facilities in Highgate Village, less than 10 minutes' walk to the east. To the immediate west of the site, pedestrian access is provided to Hampstead Heath, where trials and paths provide access across the heath and on towards Hampstead to the south west.

Accessibility by Cycle

- 2.5 Transport for London's (TfL) Local Cycling Guide 14 shows cycle routes and roads that are signed for use by cyclists, or have been recommended by cyclists. Hampstead Lane to the east and west of the site is shown as a road recommended for use by cyclists. Hampstead Lane provides access to other roads recommended for use by cyclists as well as off road cycle routes on Hampstead Heath.

Accessibility by Bus

- 2.6 The closest bus stops to the site are located on Hampstead Lane to the immediate west of the site. These stops provide access to routes 210 and 603, which provide access to Highgate Village, Finsbury Park, Muswell Hill, Brent Cross and Swiss Cottage.

Accessibility by Underground

- 2.7 The closest underground station to the site is Highgate, approximately 1.4 kilometres walk to the north east of the site. Highgate Station is located on the northern line, which provides services between High Barnet to the north and Morden to the south.

Public Transport Accessibility Levels

- 2.8 Public Transport Accessibility Levels (PTALs) provide a guide to the relative accessibility of an area. PTAL scores range from 1 to 6b, where 6b is the highest score and 1 is the lowest. Using the TfL's WebCAT (Web-based Connectivity Assessment Toolkit) the site achieves a PTAL of 1b, which represents below average accessibility by public transport. A copy of the PTAL assessment is attached at **Appendix C**.

3.0 Proposed Access Arrangements

- 3.1 The proposals include the provision of a new point of access to the site, which is considered appropriate for a grand house of this type and has merit from a security perspective, which is an important consideration for the future occupant of the property. The new access would be an alternative point of access to the property for small vehicles. The existing access would be used by large delivery vehicles such as furniture delivery vehicles.
- 3.2 The proposed point of access is located on Hampstead Road, some 25 metres to the west of the existing shared access with Caenwood Court. There is no parking on Hampstead Lane in the vicinity of the proposed access and the road is straight as it passes the site. The ATC surveys undertaken on Hampstead Lane show that average vehicle speeds on Hampstead Lane are less than 30 mph and that the 85th percentile speed (the speed at which no more than 15% of traffic exceeds) is 34.2 mph eastbound and 30.8 mph westbound.
- 3.3 It is necessary to ensure that appropriate visibility splays can be achieved at the site access junction to ensure that there is adequate inter-visibility between vehicles on the major and minor arms. A visibility splay comprises two elements, the X distance and the Y distance.
- 3.4 The Y distance represents the distance that a driver who is about to exit from the minor arm can see along the major road whilst the X distance is the distance back along the minor arm from which visibility is measured. The Y distance is based upon stopping sight distance for 85th percentile wet weather speeds. There was no rain when the ATC was undertaken and therefore, a correction factor of a 4kph deduction is made to account for wet weather speeds. This equates to a speed of 31.7 mph, resulting in a stopping sight distance of 46 metres. From the proposed site access, an X distance of 2.1 metres is achievable. The proposed access arrangement is shown on the plan attached at **Appendix D**.
- 3.5 As noted, the new access will provide an alternative point of access and vehicle movements via both points of access will be infrequent. The provision of a new point of access has a number of transport benefits, which are detailed below;
- ▶ The provision of a new access would reduce any potential disturbance by vehicles to occupants of Caenwood Court, particularly during construction works.
 - ▶ It has been observed that congestion can occur at the existing access if vehicles are delayed or unable to access Caenwood Court. With 21 flats, an unmanned security gate, and limited parking within the site, there can be quite an accumulation of tradesmen's vans and delivery vans. This is not only inconvenient for residents, but also unsafe as it potentially obscures visibility, and vehicles could back up onto the road. It would also compromise the security of the new owner of Athlone House, by preventing him being able to access/exit through his single gate. The provision of a new access provides opportunity for small vehicles to avoid any congestion.
 - ▶ The existing access is located immediately adjacent a westbound bus stop on Hampstead Lane and buses using the stop restrict visibility for vehicles leaving the access.
 - ▶ There is potential for conflict at the existing access between a vehicle turning left in from Hampstead Lane and a vehicle leaving Caenwood Court as visibility between vehicles manoeuvring in this way is very limited.

Pre Application Discussions

- 3.6 The proposal has been discussed with officers at Camden Council who support the creation of the new access for architectural/land use planning/heritage reasons. As noted, Athlone House sits in the northern extent of the London Borough of Camden and the highway authority for Hampstead Lane is the London Borough of Haringey. The provision of a new point of access to the site has been the subject of correspondence with Haringey highway officers, a copy of which is attached at **Appendix E**. Haringey highway officers confirmed that the highway authority had no objection to the proposed point of access subject to an independent Stage 1 and 2 Road Safety Audit.
- 3.7 It should be noted that as the proposals for work on site have developed, the proposed access has moved west by about 25 metres from the location presented to Haringey highway officers. The current access arrangement, as shown in **Appendix B**, has been the subject of a Stage 1 and 2 Road Safety Audit, which is discussed below.

Road Safety Audit

- 3.8 A Stage 1 and 2 Road Safety Audit (RSA), has been undertaken by Gateway TSP. A copy of the detailed design drawings that were the subject of the audit are attached at **Appendix F**, whilst a copy of the audit is attached at **Appendix G**.
- 3.9 The RSA identified one issue, with regard to the use of the new access by large vehicles. The relevant text from the audit has been reproduced below.

Problem

Potential collisions if accessing large vehicles protrude into Hampstead Lane

Location: Main access to Athlone House

The distance between the carriageway of Hampstead Lane and the gate at the access to Athlone House appears to be approximately 6.4m. It is possible that large vehicles waiting to access Athlone House could protrude back onto Hampstead Lane. This could lead to collisions between large vehicles waiting to access Athlone House and vehicles travelling along Hampstead Lane.

Recommendation

Ensure that large vehicles (likely to be a small number of servicing vehicles) continue to enter Athlone House via the existing, retained access. The proposed access should present no safety problems for the majority of accessing vehicles.

- 3.10 As noted, large delivery vehicles would use the existing access. This arrangement accords with the recommendation of the Road Safety Auditor and as such, it is not considered that there are any road safety issues associated with the provision of the proposed additional access.
- 3.11 The RSA also commented on one other matter that was identified during the course of the audit but not an issue that is considered would affect the safe operation of the site access. This related to surface water gathering at the junction of Hampstead Lane and Caenwood Court, despite the site visit taking place on a dry sunny day. The audit notes that this has led to detritus obscuring the double yellow lines on the south side of Hampstead Lane. The Highway Authority has been notified of this issue to enable them to investigate whether there is an issue with highway drainage or underground services.

4.0 Parking and Servicing

Parking

- 4.1 The development proposals include a provision of a single storey garage extension to Caenwood Cottage. The garage provides parking for up to four cars and provides sufficient space to accommodate requirements blue badge holder parking as well as opportunity to charge electric vehicles. In addition, parking for up to three vehicles will be located adjacent to a service courtyard to the immediate north of Athlone House. Camden Borough Council's November 2010 Development Policies document contains parking standards for development. The maximum car parking standard for residential development is 1 space per dwelling.
- 4.2 The scale of the main house means that a range of people would be needed to assist with the day to day running of the property including cleaners, caterers, gardeners etc. Given the accessibility of the site, it is considered appropriate that parking is provided at a level to facilitate this activity. It is noted the provision of car parking at this site above the borough's usual maximum residential parking standard has been accepted as recently as 2014, in connection with application reference 2013/7242/P, which proposed parking for up to 7 cars for three properties on site.
- 4.3 The garage extension includes a garden shed and these outbuildings provide ample storage facilities for cycles.

Servicing

- 4.4 The existing point of access will be used by service and delivery vehicles. The extension to the north of Athlone House contains servicing facilities that are designed to accommodate vehicles up to 8 metres in length, which could visit the site on occasion, to deliver items of furniture for example. Swept path analysis showing an 8 metre 7.5 tonne box van manoeuvring to and from the site is attached at **Appendix H**.
- 4.5 A refuse store will be located at the north eastern corner of the site, which will allow refuse vehicles to collect waste and recycling material from the existing access when approaching or leaving Caenwood Court.

5.0 Summary and Conclusion

- 5.1 The Transport Statement considers the transport and highway aspects of the restoration proposals for Athlone House. Consideration has been given to the proposed access arrangements, parking and servicing facilities
- 5.2 In summary, it is considered; that;
- ▶ The new point of access can operate safely and efficiently and offers an improvement over the existing situation;
 - ▶ The proposed access has been the subject of a Stage 1 and 2 Road Safety Audit and it is considered that there are no road safety issues associated with the proposed access;
 - ▶ Car parking has been provided at a level that is appropriate given the scale of Athlone House and the accessibility of the site;
 - ▶ The proposals accommodate parking for blue badge holders and allow for charging of electric vehicles; and
 - ▶ The site has been designed to provide appropriate facilities for service and delivery vehicles.
- 5.3 It is therefore considered that there is no reason why the proposals should be resisted on traffic or transportation grounds.

Appendix A

Site Location Plan

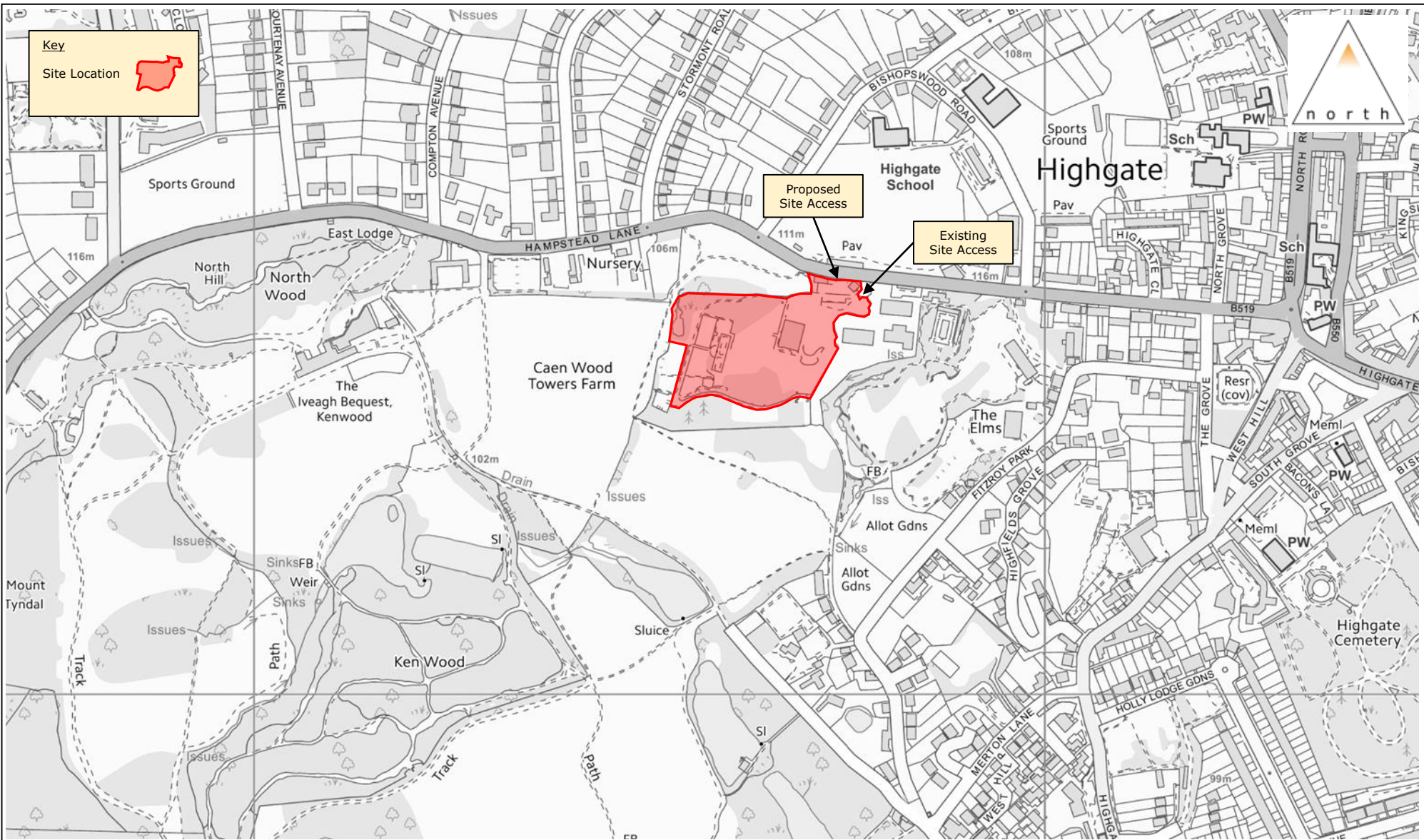

Appendix B

ATC Data

20401		HIGHGATE								
		JUNE 2016			Posted Speed Limit (PSL)	Total Vehicles	5 Day Ave.	7 Day Ave.	85%ile Speed	Mean Speed
Site	Location	Direction	Start Date	End Date						
Site No: 20401001	Hampstead Lane, Highgate (LC) TQ 27749 87539	Channel: Eastbound	Sat 04-Jun-16	Mon 06-Jun-16	20	15796	6113	5750	34.2	28.3
		Channel: Westbound	Sat 04-Jun-16	Mon 06-Jun-16		17848	6749	6406	30.8	25.8

20401 HIGHGATE Site No: 20401001 Location Hampstead Lane, Highgate (LC)
 Sat 04-Jun-16 to Mon 06-Jun-16 Channel: Eastbound

TIME PERIOD	TOTAL VEHICLES	MOTOR-CYCLES	MOTOR-CYCLES%	CARS	CARS %	LGV	LGV %	HGV	HGV %	BUS	BUS %
Sat 04-Jun-16											
00:00	87	2	2.3	76	87.4	5	5.8	4	4.6	0	0.0
01:00	43	0	0.0	39	90.7	3	7.0	1	2.3	0	0.0
02:00	47	1	2.1	43	91.5	3	6.4	0	0.0	0	0.0
03:00	35	1	2.9	31	88.6	3	8.6	0	0.0	0	0.0
04:00	12	0	0.0	10	83.3	1	8.3	1	8.3	0	0.0
05:00	30	1	3.3	23	76.7	2	6.7	4	13.3	0	0.0
06:00	63	3	4.8	44	69.8	12	19.1	4	6.4	0	0.0
07:00	110	9	8.2	82	74.6	13	11.8	6	5.5	0	0.0
08:00	161	8	5.0	125	77.6	19	11.8	7	4.4	2	1.2
09:00	236	14	5.9	186	78.8	27	11.4	9	3.8	0	0.0
10:00	259	8	3.1	230	88.8	13	5.0	8	3.1	0	0.0
11:00	277	13	4.7	239	86.3	16	5.8	9	3.3	0	0.0
12:00	346	10	2.9	309	89.3	20	5.8	7	2.0	0	0.0
13:00	317	10	3.2	290	91.5	12	3.8	5	1.6	0	0.0
14:00	298	9	3.0	267	89.6	15	5.0	7	2.4	0	0.0
15:00	259	8	3.1	232	89.6	13	5.0	6	2.3	0	0.0
16:00	344	8	2.3	313	91.0	16	4.7	7	2.0	0	0.0
17:00	365	15	4.1	327	89.6	15	4.1	8	2.2	0	0.0
18:00	368	13	3.5	338	91.9	11	3.0	6	1.6	0	0.0
19:00	333	10	3.0	308	92.5	6	1.8	8	2.4	1	0.3
20:00	232	13	5.6	203	87.5	10	4.3	6	2.6	0	0.0
21:00	175	6	3.4	160	91.4	3	1.7	6	3.4	0	0.0
22:00	136	3	2.2	124	91.2	4	2.9	5	3.7	0	0.0
23:00	173	6	3.5	157	90.8	6	3.5	4	2.3	0	0.0
12H,7-19	3340	125	3.7	2938	88.0	190	5.7	85	2.5	2	0.1
16H,6-22	4143	157	3.8	3653	88.2	221	5.3	109	2.6	3	0.1
18H,6-24	4452	166	3.7	3934	88.4	231	5.2	118	2.7	3	0.1
24H,0-24	4706	171	3.6	4156	88.3	248	5.3	128	2.7	3	0.1

20401 HIGHGATE Site No: 20401001 Location Hampstead Lane, Highgate (LC)
 Sat 04-Jun-16 to Mon 06-Jun-16 Channel: Eastbound

TIME PERIOD	TOTAL VEHICLES	MOTOR-CYCLES	MOTOR-CYCLES%	CARS	CARS %	LGV	LGV %	HGV	HGV %	BUS	BUS %
Sun 05-Jun-16											
00:00	139	3	2.2	126	90.7	6	4.3	4	2.9	0	0.0
01:00	82	3	3.7	75	91.5	4	4.9	0	0.0	0	0.0
02:00	55	2	3.6	48	87.3	4	7.3	1	1.8	0	0.0
03:00	43	0	0.0	39	90.7	4	9.3	0	0.0	0	0.0
04:00	21	1	4.8	20	95.2	0	0.0	0	0.0	0	0.0
05:00	35	0	0.0	30	85.7	4	11.4	1	2.9	0	0.0
06:00	43	1	2.3	33	76.7	5	11.6	4	9.3	0	0.0
07:00	62	4	6.5	50	80.7	4	6.5	4	6.5	0	0.0
08:00	107	13	12.2	82	76.6	8	7.5	4	3.7	0	0.0
09:00	185	15	8.1	162	87.6	3	1.6	5	2.7	0	0.0
10:00	244	8	3.3	222	91.0	6	2.5	8	3.3	0	0.0
11:00	268	20	7.5	236	88.1	5	1.9	7	2.6	0	0.0
12:00	316	14	4.4	284	89.9	10	3.2	8	2.5	0	0.0
13:00	412	21	5.1	379	92.0	7	1.7	5	1.2	0	0.0
14:00	355	10	2.8	333	93.8	4	1.1	8	2.3	0	0.0
15:00	357	13	3.6	324	90.8	12	3.4	8	2.2	0	0.0
16:00	352	13	3.7	320	90.9	12	3.4	7	2.0	0	0.0
17:00	385	17	4.4	354	92.0	7	1.8	7	1.8	0	0.0
18:00	390	15	3.9	359	92.1	8	2.1	8	2.1	0	0.0
19:00	356	9	2.5	329	92.4	9	2.5	9	2.5	0	0.0
20:00	255	9	3.5	235	92.2	7	2.8	4	1.6	0	0.0
21:00	192	2	1.0	176	91.7	7	3.7	7	3.7	0	0.0
22:00	215	3	1.4	199	92.6	8	3.7	5	2.3	0	0.0
23:00	108	2	1.9	96	88.9	6	5.6	4	3.7	0	0.0
12H,7-19	3433	163	4.8	3105	90.5	86	2.5	79	2.3	0	0.0
16H,6-22	4279	184	4.3	3878	90.6	114	2.7	103	2.4	0	0.0
18H,6-24	4602	189	4.1	4173	90.7	128	2.8	112	2.4	0	0.0
24H,0-24	4977	198	4.0	4511	90.6	150	3.0	118	2.4	0	0.0

TIME PERIOD	TOTAL VEHICLES	MOTOR-CYCLES	MOTOR-CYCLES%	CARS	CARS %	LGV	LGV %	HGV	HGV %	BUS	BUS %
Mon 06-Jun-16											
00:00	56	0	0.0	48	85.7	4	7.1	4	7.1	0	0.0
01:00	30	0	0.0	28	93.3	1	3.3	1	3.3	0	0.0
02:00	12	1	8.3	11	91.7	0	0.0	0	0.0	0	0.0
03:00	19	1	5.3	13	68.4	5	26.3	0	0.0	0	0.0
04:00	25	0	0.0	21	84.0	2	8.0	2	8.0	0	0.0
05:00	45	0	0.0	30	66.7	10	22.2	5	11.1	0	0.0
06:00	207	2	1.0	162	78.3	33	15.9	8	3.9	2	1.0
07:00	535	18	3.4	445	83.2	57	10.7	15	2.8	0	0.0
08:00	535	14	2.6	447	83.6	62	11.6	12	2.2	0	0.0
09:00	407	14	3.4	339	83.3	46	11.3	8	2.0	0	0.0
10:00	413	13	3.2	339	82.1	47	11.4	12	2.9	2	0.5
11:00	353	8	2.3	291	82.4	41	11.6	13	3.7	0	0.0
12:00	277	8	2.9	222	80.1	38	13.7	8	2.9	1	0.4
13:00	332	7	2.1	272	81.9	39	11.8	12	3.6	2	0.6
14:00	339	9	2.7	277	81.7	38	11.2	13	3.8	2	0.6
15:00	406	8	2.0	356	87.7	27	6.7	13	3.2	2	0.5
16:00	403	14	3.5	347	86.1	27	6.7	14	3.5	1	0.3
17:00	397	20	5.0	335	84.4	23	5.8	18	4.5	1	0.3
18:00	355	20	5.6	320	90.1	7	2.0	8	2.3	0	0.0
19:00	330	21	6.4	281	85.2	15	4.6	13	3.9	0	0.0
20:00	219	14	6.4	187	85.4	13	5.9	5	2.3	0	0.0
21:00	163	13	8.0	139	85.3	5	3.1	6	3.7	0	0.0
22:00	154	8	5.2	132	85.7	9	5.8	5	3.3	0	0.0
23:00	101	1	1.0	91	90.1	5	5.0	4	4.0	0	0.0
12H,7-19	4752	153	3.2	3990	84.0	452	9.5	146	3.1	11	0.2
16H,6-22	5671	203	3.6	4759	83.9	518	9.1	178	3.1	13	0.2
18H,6-24	5926	212	3.6	4982	84.1	532	9.0	187	3.2	13	0.2
24H,0-24	6113	214	3.5	5133	84.0	554	9.1	199	3.3	13	0.2

20401 HIGHGATE Site No: 20401001 Location Hampstead Lane, Highgate (LC)
 Sat 04-Jun-16 to Mon 06-Jun-16 Channel: Eastbound

TIME PERIOD	TOTAL VEHICLES	MOTOR-CYCLES	MOTOR-CYCLES%	CARS	CARS %	LGV	LGV %	HGV	HGV %	BUS	BUS %
Daily Totals											
Sat 04-Jun-16	4706	171	3.6	4156	88.3	248	5.3	128	2.7	3	0.1
Sun 05-Jun-16	4977	198	4.0	4511	90.6	150	3.0	118	2.4	0	0.0
Mon 06-Jun-16	6113	214	3.5	5133	84.0	554	9.1	199	3.3	13	0.2
-	-	-	-	-	-	-	-	-	-	-	-
-	-	-	-	-	-	-	-	-	-	-	-
-	-	-	-	-	-	-	-	-	-	-	-
Total Vehicles											
[--]	15796	583	3.7	13800	87.6	952	5.8	445	2.8	16	0.1

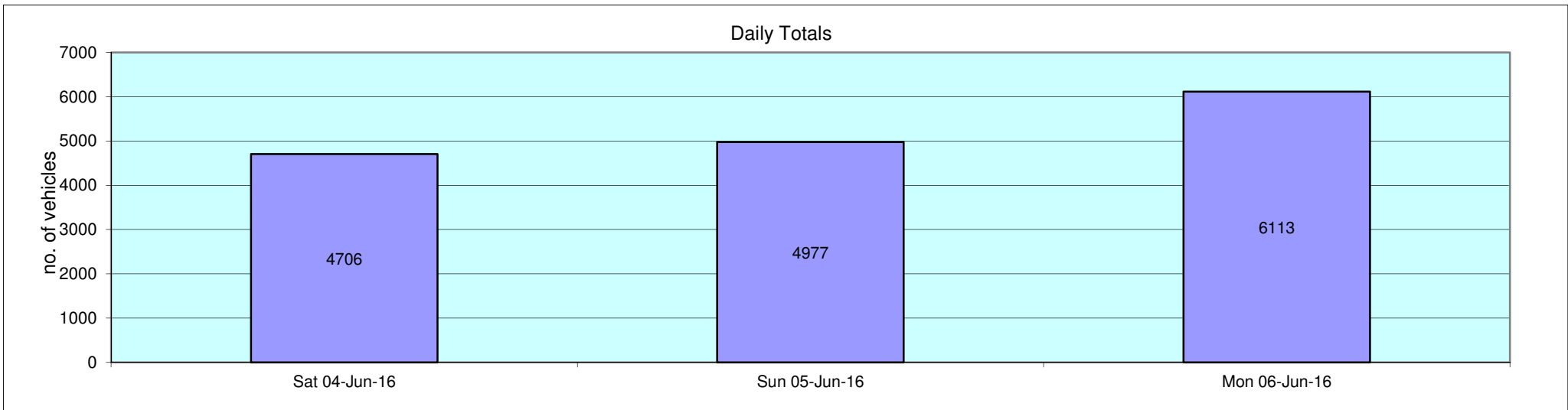

20401		HIGHGATE			Site No: 20401001		Location Hampstead Lane, Highgate (LC)									
#REF!		Channel: Eastbound														
Time Period	Total Vehicles	85%ile Speed	Mean Speed	Stand Dev.	<6Mph	6-<11	11-<16	16-<21	21-<26	26-<31	31-<36	36-<41	41-<46	46-<51	51-<56	=>56
Sat 04-Jun-16																
00:00	87	35.2	30.6	4.9	0	0	0	2	9	38	29	7	2	0	0	0
01:00	43	36.1	31.8	5.2	0	0	0	0	5	14	17	5	2	0	0	0
02:00	47	38.7	32.6	5.9	0	0	0	1	5	11	17	10	3	0	0	0
03:00	35	38.1	31.8	7.4	0	0	0	0	7	12	9	3	2	1	1	0
04:00	12	34.4	31	3.7	0	0	0	0	0	7	4	1	0	0	0	0
05:00	30	39.3	32.5	6.8	0	0	0	2	2	8	9	6	3	0	0	0
06:00	63	38.7	32.9	6.2	0	1	0	1	6	9	27	17	2	0	0	0
07:00	110	35.8	30.9	6.4	0	0	1	2	16	42	33	8	6	1	1	0
08:00	161	35.9	30.3	6.4	0	1	2	7	22	57	48	20	2	1	1	0
09:00	236	34.1	27.5	6.1	0	0	6	24	66	76	45	19	0	0	0	0
10:00	259	33.1	27.8	5.7	0	0	8	20	48	122	51	5	4	1	0	0
11:00	277	34.1	28.3	5.7	0	0	6	21	55	111	67	15	2	0	0	0
12:00	346	33.8	28.3	5.8	0	3	8	17	65	162	69	17	4	1	0	0
13:00	317	34.7	28.6	6.3	0	5	8	15	55	132	73	26	3	0	0	0
14:00	298	34.2	28.1	6	0	0	7	21	75	109	63	18	4	1	0	0
15:00	259	34.2	28.5	5.9	0	0	4	23	42	113	59	12	5	1	0	0
16:00	344	33.5	28.1	5.4	0	1	6	18	81	144	84	7	1	2	0	0
17:00	365	34.5	28.7	5.7	0	0	8	23	67	137	107	21	2	0	0	0
18:00	368	34	28.5	5.4	0	1	5	18	76	161	85	21	0	1	0	0
19:00	333	34.1	28	6.5	0	3	12	24	63	135	74	15	5	1	1	0
20:00	232	34.5	29.3	5.4	0	0	5	4	41	100	66	14	0	2	0	0
21:00	175	34.3	28.8	5.7	0	0	2	6	42	74	37	9	3	2	0	0
22:00	136	34.3	29.5	5.9	0	0	0	5	25	63	33	4	4	1	0	1
23:00	173	30.5	26.7	4.5	0	0	2	7	65	81	12	6	0	0	0	0
12H,7-19	3340	34.3	28.5	5.9	0	11	69	209	668	1366	784	189	33	9	2	0
16H,6-22	4143	34.4	28.6	5.9	0	15	88	244	820	1684	988	244	43	14	3	0
18H,6-24	4452	34.3	28.5	5.9	0	15	90	256	910	1828	1033	254	47	15	3	1
24H,0-24	4706	34.5	28.7	5.9	0	15	90	261	938	1918	1118	286	59	16	4	1

20401		HIGHGATE			Site No: 20401001		Location Hampstead Lane, Highgate (LC)									
#REF!		Channel: Eastbound														
Time Period	Total Vehicles	85%ile Speed	Mean Speed	Stand Dev.	<6Mph	6-<11	11-<16	16-<21	21-<26	26-<31	31-<36	36-<41	41-<46	46-<51	51-<56	=>56
Sun 05-Jun-16																
00:00	139	25.9	23.4	4.2	0	0	5	19	95	15	3	2	0	0	0	0
01:00	82	29.1	24.8	4.2	0	1	1	5	46	26	3	0	0	0	0	0
02:00	55	35.2	30.1	5.9	0	0	1	2	7	21	18	5	0	1	0	0
03:00	43	35.7	30.4	6.1	0	0	0	3	6	14	14	4	2	0	0	0
04:00	21	35.4	30.2	5.5	0	0	0	2	0	11	5	3	0	0	0	0
05:00	35	40.1	33.5	6.5	0	0	0	1	2	8	15	4	4	1	0	0
06:00	43	39.9	32.9	7.6	0	0	1	0	7	10	8	13	2	2	0	0
07:00	62	35.8	29.7	6.7	0	0	2	5	9	16	21	8	1	0	0	0
08:00	107	37.2	30.3	7.7	0	2	6	3	10	32	34	15	4	1	0	0
09:00	185	35	28.9	6.9	0	1	8	17	20	67	55	12	4	0	1	0
10:00	244	34.7	29	5.8	0	0	4	14	47	87	75	14	2	1	0	0
11:00	268	34	28.1	6	0	0	13	11	58	115	50	19	1	1	0	0
12:00	316	34.1	28.3	5.8	0	3	8	10	71	134	69	17	4	0	0	0
13:00	412	32.5	27.1	5.6	0	2	11	29	117	172	63	15	2	1	0	0
14:00	355	33	27.7	5.6	0	0	5	30	86	156	60	14	2	1	1	0
15:00	357	30.9	26.9	4.9	0	2	4	25	102	172	44	7	1	0	0	0
16:00	352	33	27.6	5.5	0	1	8	22	90	150	70	8	2	0	1	0
17:00	385	32.2	27.3	5.3	0	4	7	16	113	172	63	7	3	0	0	0
18:00	390	34	28.4	5.5	0	1	6	16	98	153	96	17	2	0	1	0
19:00	356	33.5	28.3	5.3	0	1	6	12	81	168	68	17	2	1	0	0
20:00	255	35.8	30.6	5.9	0	1	2	5	33	104	74	25	8	3	0	0
21:00	192	34.6	29.6	5.5	0	0	2	6	27	92	49	12	3	0	0	1
22:00	215	34.8	29.3	6.3	0	1	3	9	38	92	51	17	1	0	2	1
23:00	108	36.7	31.7	5.1	0	0	1	0	8	41	39	16	3	0	0	0
12H,7-19	3433	33.7	27.9	5.8	0	16	82	198	821	1426	700	153	28	5	4	0
16H,6-22	4279	34	28.2	5.8	0	18	93	221	969	1800	899	220	43	11	4	1
18H,6-24	4602	34.1	28.4	5.9	0	19	97	230	1015	1933	989	253	47	11	6	2
24H,0-24	4977	34.1	28.3	5.9	0	20	104	262	1171	2028	1047	271	53	13	6	2

20401		HIGHGATE			Site No: 20401001		Location Hampstead Lane, Highgate (LC)									
#REF!		Channel: Eastbound														
Time Period	Total Vehicles	85%ile Speed	Mean Speed	Stand Dev.	<6Mph	6-<11	11-<16	16-<21	21-<26	26-<31	31-<36	36-<41	41-<46	46-<51	51-<56	=>56
Mon 06-Jun-16																
00:00	56	39.8	32.3	7.6	0	0	0	2	7	19	13	8	5	0	2	0
01:00	30	42.7	35	7.2	0	0	0	0	3	5	11	4	6	0	1	0
02:00	12	37.8	31.4	7.6	0	0	0	0	3	4	2	2	0	1	0	0
03:00	19	38.7	33.2	7.1	0	0	1	0	0	5	7	5	0	1	0	0
04:00	25	38.9	33.3	6.4	0	0	0	0	3	5	11	3	2	1	0	0
05:00	45	44.1	35.3	8.3	0	0	0	1	6	6	12	9	6	4	1	0
06:00	207	38.2	31.6	6.6	0	1	4	6	20	59	69	37	9	2	0	0
07:00	535	33.3	27.7	5.7	0	2	19	40	97	249	101	27	0	0	0	0
08:00	535	31	25.2	6.4	0	8	39	77	145	186	64	15	1	0	0	0
09:00	407	34.5	29.4	5.3	0	0	4	18	63	172	126	18	5	1	0	0
10:00	413	33.7	27.8	5.7	0	2	4	34	107	161	78	25	2	0	0	0
11:00	353	34.2	28.2	6	0	1	10	29	65	139	88	18	3	0	0	0
12:00	277	34.5	29.6	4.8	0	0	2	9	33	137	78	16	2	0	0	0
13:00	332	34	28.3	5.9	0	0	14	17	57	151	71	18	4	0	0	0
14:00	339	33.5	27.5	5.9	0	2	5	36	83	127	70	11	5	0	0	0
15:00	406	30.5	25.6	5.3	0	1	15	46	146	151	41	4	2	0	0	0
16:00	403	30.8	26.2	5.2	0	1	10	48	118	172	48	6	0	0	0	0
17:00	397	32.7	26.3	6.8	0	7	26	42	92	152	54	22	1	1	0	0
18:00	355	33.9	27.7	6	0	1	17	27	67	139	88	16	0	0	0	0
19:00	330	34.1	27.9	6.4	0	3	14	18	76	122	75	17	4	1	0	0
20:00	219	35.1	29.9	5.8	0	0	2	9	35	82	70	15	4	1	1	0
21:00	163	35.3	29.6	6	0	1	3	8	23	59	51	17	1	0	0	0
22:00	154	34.9	30.3	5.3	0	0	1	3	17	72	48	8	3	2	0	0
23:00	101	36.5	31.8	5.6	0	0	0	2	9	33	40	13	3	0	1	0
12H,7-19	4752	33.3	27.3	5.9	0	25	165	423	1073	1936	907	196	25	2	0	0
16H,6-22	5671	33.8	27.7	6.1	0	30	188	464	1227	2258	1172	282	43	6	1	0
18H,6-24	5926	33.9	27.8	6.1	0	30	189	469	1253	2363	1260	303	49	8	2	0
24H,0-24	6113	34.1	28	6.2	0	30	190	472	1275	2407	1316	334	68	15	6	0

20401 HIGHGATE Site No: 20401001 Location Hampstead Lane, Highgate (LC)
 #REF! Channel: Eastbound

Time Period	Total Vehicles	85%ile Speed	Mean Speed	Stand Dev.	<6Mph	6-<11	11-<16	16-<21	21-<26	26-<31	31-<36	36-<41	41-<46	46-<51	51-<56	=>56
-------------	----------------	--------------	------------	------------	-------	-------	--------	--------	--------	--------	--------	--------	--------	--------	--------	------

Daily Totals

Sat 04-Jun-16	4706	34.5	28.7	5.9	0	15	90	261	938	1918	1118	286	59	16	4	1
Sun 05-Jun-16	4977	34.1	28.3	5.9	0	20	104	262	1171	2028	1047	271	53	13	6	2
Mon 06-Jun-16	6113	34.1	28	6.2	0	30	190	472	1275	2407	1316	334	68	15	6	0
-	-	-	-	-	-	-	-	-	-	-	-	-	-	-	-	-
-	-	-	-	-	-	-	-	-	-	-	-	-	-	-	-	-
-	-	-	-	-	-	-	-	-	-	-	-	-	-	-	-	-

Total Vehicles

[--]	15796	34.2	28.3	6.0	0	65	384	995	3384	6353	3481	891	180	44	16	3
------	-------	------	------	-----	---	----	-----	-----	------	------	------	-----	-----	----	----	---

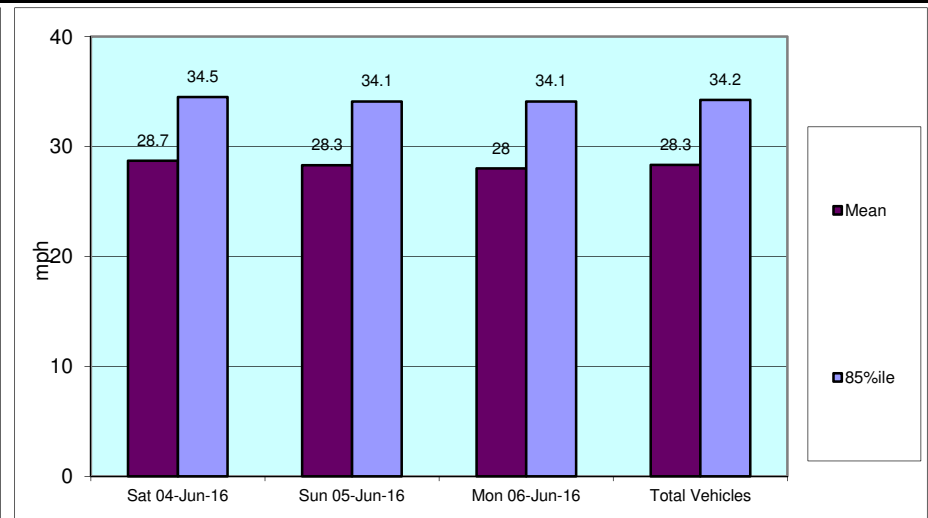
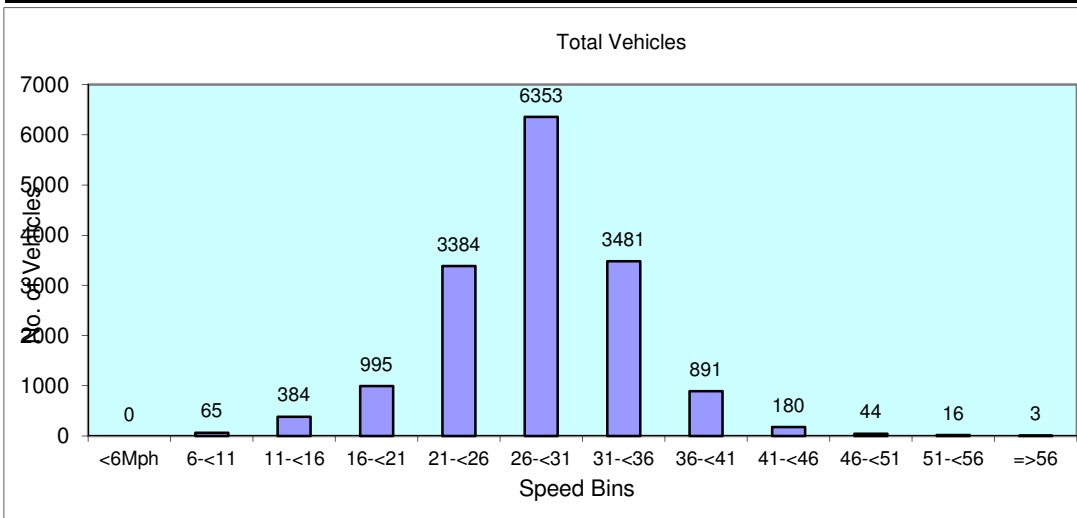

20401	HIGHGATE		Site No: 20401001	Location		Hampstead Lane, Highgate (LC)			
	Channel: Eastbound								
TIME PERIOD	Sat 04/06/16	Sun 05/06/16	Mon 06/06/16	Tue 07/06/16	Wed 08/06/16	Thu 09/06/16	Fri 10/06/16	5-Day Av	7-Day Av
Week Begin: 04-Jun-16									
00:00	87	139	56	-	-	-	-	56	72
01:00	43	82	30	-	-	-	-	30	39
02:00	47	55	12	-	-	-	-	12	23
03:00	35	43	19	-	-	-	-	19	25
04:00	12	21	25	-	-	-	-	25	23
05:00	30	35	45	-	-	-	-	45	41
06:00	63	43	207	-	-	-	-	207	163
07:00	110	62	535	-	-	-	-	535	407
08:00	161	107	535	-	-	-	-	535	420
09:00	236	185	407	-	-	-	-	407	351
10:00	259	244	413	-	-	-	-	413	367
11:00	277	268	353	-	-	-	-	353	330
12:00	346	316	277	-	-	-	-	277	292
13:00	317	412	332	-	-	-	-	332	341
14:00	298	355	339	-	-	-	-	339	335
15:00	259	357	406	-	-	-	-	406	378
16:00	344	352	403	-	-	-	-	403	387
17:00	365	385	397	-	-	-	-	397	391
18:00	368	390	355	-	-	-	-	355	362
19:00	333	356	330	-	-	-	-	330	334
20:00	232	255	219	-	-	-	-	219	226
21:00	175	192	163	-	-	-	-	163	169
22:00	136	215	154	-	-	-	-	154	160
23:00	173	108	101	-	-	-	-	101	112
12H,7-19	3340	3433	4752	-	-	-	-	4752	4362
16H,6-22	4143	4279	5671	-	-	-	-	5671	5254
18H,6-24	4452	4602	5926	-	-	-	-	5926	5526
24H,0-24	4706	4977	6113	-	-	-	-	6113	5750
Am	11:00	11:00	08:00	-	-	-	-	-	-
Peak	277	268	535	-	-	-	-	535	460
Pm	18:00	13:00	15:00	-	-	-	-	-	-
Peak	368	412	406	-	-	-	-	406	401

20401	HIGHGATE	Site No: 20401001	Location	Hampstead Lane, Highgate (LC)					
		Channel: Eastbound							
TIME PERIOD	Sat	Sun	Mon	Tue	Wed	Thu	Fri	5-Day	7-Day
	04/06/16	05/06/16	06/06/16	07/06/16	08/06/16	09/06/16	10/06/16	Av	Av

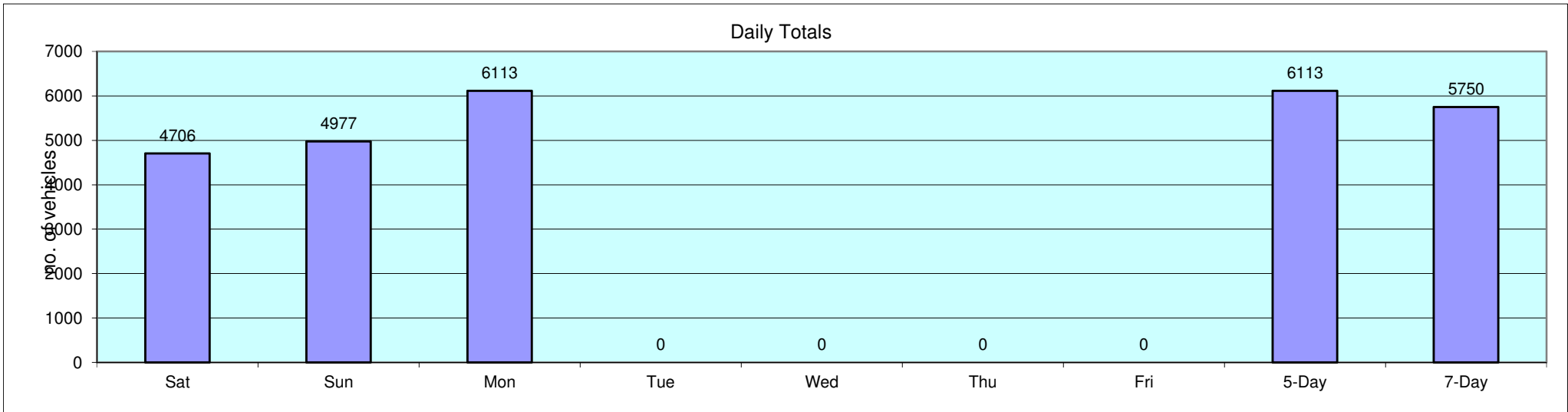

20401 HIGHGATE Site No: 20401001 Location Hampstead Lane, Highgate (LC)
 Sat 04-Jun-16 to Mon 06-Jun-16 Channel: Westbound

TIME PERIOD	TOTAL VEHICLES	MOTOR-CYCLES	MOTOR-CYCLES%	CARS	CARS %	LGV	LGV %	HGV	HGV %	BUS	BUS %
Sat 04-Jun-16											
00:00	88	1	1.1	78	88.6	3	3.4	6	6.8	0	0.0
01:00	71	3	4.2	62	87.3	3	4.2	3	4.2	0	0.0
02:00	57	0	0.0	53	93.0	4	7.0	0	0.0	0	0.0
03:00	36	2	5.6	33	91.7	1	2.8	0	0.0	0	0.0
04:00	26	1	3.9	22	84.6	3	11.5	0	0.0	0	0.0
05:00	60	4	6.7	45	75.0	9	15.0	2	3.3	0	0.0
06:00	67	4	6.0	50	74.6	7	10.5	6	9.0	0	0.0
07:00	111	12	10.8	86	77.5	7	6.3	5	4.5	1	0.9
08:00	232	11	4.7	177	76.3	35	15.1	9	3.9	0	0.0
09:00	297	9	3.0	245	82.5	34	11.5	9	3.0	0	0.0
10:00	304	11	3.6	264	86.8	18	5.9	11	3.6	0	0.0
11:00	340	13	3.8	299	87.9	21	6.2	7	2.1	0	0.0
12:00	354	16	4.5	300	84.8	27	7.6	11	3.1	0	0.0
13:00	390	15	3.9	335	85.9	33	8.5	7	1.8	0	0.0
14:00	364	13	3.6	324	89.0	15	4.1	12	3.3	0	0.0
15:00	321	15	4.7	281	87.5	14	4.4	11	3.4	0	0.0
16:00	305	15	4.9	264	86.6	17	5.6	9	3.0	0	0.0
17:00	319	4	1.3	295	92.5	11	3.5	9	2.8	0	0.0
18:00	250	12	4.8	221	88.4	7	2.8	10	4.0	0	0.0
19:00	268	8	3.0	240	89.6	13	4.9	7	2.6	0	0.0
20:00	201	7	3.5	180	89.6	8	4.0	6	3.0	0	0.0
21:00	184	12	6.5	159	86.4	9	4.9	4	2.2	0	0.0
22:00	194	6	3.1	175	90.2	7	3.6	6	3.1	0	0.0
23:00	289	73	25.3	192	66.4	5	1.7	19	6.6	0	0.0
12H,7-19	3587	146	4.1	3091	86.2	239	6.7	110	3.1	1	0.0
16H,6-22	4307	177	4.1	3720	86.4	276	6.4	133	3.1	1	0.0
18H,6-24	4790	256	5.3	4087	85.3	288	6.0	158	3.3	1	0.0
24H,0-24	5128	267	5.2	4380	85.4	311	6.1	169	3.3	1	0.0

20401 HIGHGATE Site No: 20401001 Location Hampstead Lane, Highgate (LC)
 Sat 04-Jun-16 to Mon 06-Jun-16 Channel: Westbound

TIME PERIOD	TOTAL VEHICLES	MOTOR-CYCLES	MOTOR-CYCLES%	CARS	CARS %	LGV	LGV %	HGV	HGV %	BUS	BUS %
Sun 05-Jun-16											
00:00	514	258	50.2	179	34.8	4	0.8	72	14.0	1	0.2
01:00	282	125	44.3	124	44.0	1	0.4	32	11.4	0	0.0
02:00	82	6	7.3	72	87.8	2	2.4	2	2.4	0	0.0
03:00	57	0	0.0	53	93.0	4	7.0	0	0.0	0	0.0
04:00	53	1	1.9	47	88.7	5	9.4	0	0.0	0	0.0
05:00	36	2	5.6	31	86.1	2	5.6	1	2.8	0	0.0
06:00	45	3	6.7	40	88.9	1	2.2	1	2.2	0	0.0
07:00	86	11	12.8	62	72.1	7	8.1	6	7.0	0	0.0
08:00	161	25	15.5	128	79.5	4	2.5	4	2.5	0	0.0
09:00	246	22	8.9	206	83.7	8	3.3	10	4.1	0	0.0
10:00	343	28	8.2	297	86.6	7	2.0	11	3.2	0	0.0
11:00	354	22	6.2	307	86.7	14	4.0	11	3.1	0	0.0
12:00	383	27	7.1	344	89.8	5	1.3	7	1.8	0	0.0
13:00	431	27	6.3	389	90.3	4	0.9	11	2.6	0	0.0
14:00	438	28	6.4	386	88.1	14	3.2	10	2.3	0	0.0
15:00	381	27	7.1	339	89.0	3	0.8	12	3.2	0	0.0
16:00	361	16	4.4	334	92.5	6	1.7	5	1.4	0	0.0
17:00	363	16	4.4	332	91.5	8	2.2	7	1.9	0	0.0
18:00	343	17	5.0	307	89.5	14	4.1	5	1.5	0	0.0
19:00	308	14	4.6	283	91.9	6	2.0	5	1.6	0	0.0
20:00	237	7	3.0	215	90.7	8	3.4	7	3.0	0	0.0
21:00	163	8	4.9	146	89.6	4	2.5	5	3.1	0	0.0
22:00	164	6	3.7	146	89.0	7	4.3	5	3.1	0	0.0
23:00	140	3	2.1	125	89.3	7	5.0	5	3.6	0	0.0
12H,7-19	3890	266	6.8	3431	88.2	94	2.4	99	2.5	0	0.0
16H,6-22	4643	298	6.4	4115	88.6	113	2.4	117	2.5	0	0.0
18H,6-24	4947	307	6.2	4386	88.7	127	2.6	127	2.6	0	0.0
24H,0-24	5971	699	11.7	4892	81.9	145	2.4	234	3.9	1	0.0

20401 HIGHGATE Site No: 20401001 Location Hampstead Lane, Highgate (LC)
 Sat 04-Jun-16 to Mon 06-Jun-16 Channel: Westbound

TIME PERIOD	TOTAL VEHICLES	MOTOR-CYCLES	MOTOR-CYCLES%	CARS	CARS %	LGV	LGV %	HGV	HGV %	BUS	BUS %
Mon 06-Jun-16											
00:00	70	3	4.3	55	78.6	6	8.6	6	8.6	0	0.0
01:00	38	0	0.0	33	86.8	2	5.3	3	7.9	0	0.0
02:00	21	2	9.5	17	81.0	2	9.5	0	0.0	0	0.0
03:00	21	1	4.8	17	81.0	3	14.3	0	0.0	0	0.0
04:00	24	0	0.0	14	58.3	10	41.7	0	0.0	0	0.0
05:00	54	1	1.9	44	81.5	7	13.0	2	3.7	0	0.0
06:00	185	8	4.3	149	80.5	22	11.9	6	3.2	0	0.0
07:00	336	16	4.8	286	85.1	20	6.0	14	4.2	0	0.0
08:00	463	17	3.7	396	85.5	32	6.9	18	3.9	0	0.0
09:00	331	12	3.6	279	84.3	26	7.9	14	4.2	0	0.0
10:00	335	7	2.1	275	82.1	42	12.5	8	2.4	3	0.9
11:00	342	13	3.8	263	76.9	57	16.7	9	2.6	0	0.0
12:00	353	26	7.4	271	76.8	42	11.9	14	4.0	0	0.0
13:00	352	14	4.0	293	83.2	31	8.8	12	3.4	2	0.6
14:00	394	18	4.6	327	83.0	39	9.9	10	2.5	0	0.0
15:00	586	18	3.1	503	85.8	49	8.4	16	2.7	0	0.0
16:00	624	22	3.5	528	84.6	60	9.6	13	2.1	1	0.2
17:00	622	32	5.1	535	86.0	46	7.4	9	1.5	0	0.0
18:00	543	25	4.6	480	88.4	25	4.6	13	2.4	0	0.0
19:00	383	27	7.1	324	84.6	22	5.7	10	2.6	0	0.0
20:00	232	23	9.9	199	85.8	5	2.2	5	2.2	0	0.0
21:00	181	6	3.3	165	91.2	5	2.8	5	2.8	0	0.0
22:00	163	7	4.3	145	89.0	6	3.7	5	3.1	0	0.0
23:00	96	4	4.2	81	84.4	4	4.2	7	7.3	0	0.0
12H,7-19	5281	220	4.2	4436	84.0	469	8.9	150	2.8	6	0.1
16H,6-22	6262	284	4.5	5273	84.2	523	8.4	176	2.8	6	0.1
18H,6-24	6521	295	4.5	5499	84.3	533	8.2	188	2.9	6	0.1
24H,0-24	6749	302	4.5	5679	84.2	563	8.3	199	3.0	6	0.1

20401 HIGHGATE Site No: 20401001 Location Hampstead Lane, Highgate (LC)
 Sat 04-Jun-16 to Mon 06-Jun-16 Channel: Westbound

TIME PERIOD	TOTAL VEHICLES	MOTOR-CYCLES	MOTOR-CYCLES%	CARS	CARS %	LGV	LGV %	HGV	HGV %	BUS	BUS %
Daily Totals											
Sat 04-Jun-16	5128	267	5.2	4380	85.4	311	6.1	169	3.3	1	0.0
Sun 05-Jun-16	5971	699	11.7	4892	81.9	145	2.4	234	3.9	1	0.0
Mon 06-Jun-16	6749	302	4.5	5679	84.2	563	8.3	199	3.0	6	0.1
-	-	-	-	-	-	-	-	-	-	-	-
-	-	-	-	-	-	-	-	-	-	-	-
-	-	-	-	-	-	-	-	-	-	-	-
Total Vehicles											
[--]	17848	1268	7.1	14951	83.8	1019	5.6	602	3.4	8	0.0

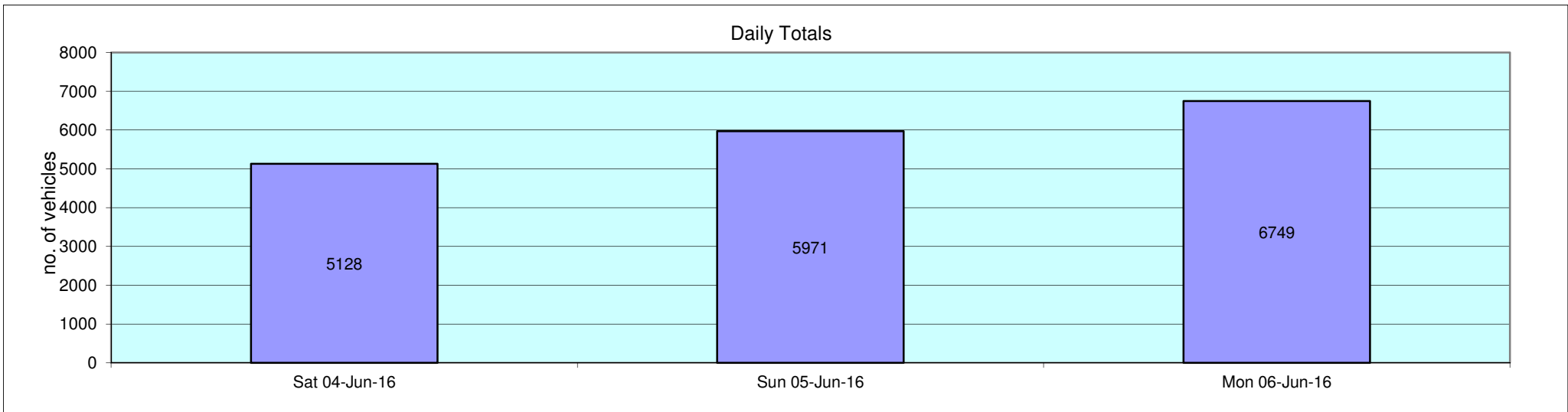

20401		HIGHGATE			Site No: 20401001		Location Hampstead Lane, Highgate (LC)									
#REF!		Channel: Westbound														
Time Period	Total Vehicles	85%ile Speed	Mean Speed	Stand Dev.	<6Mph	6-<11	11-<16	16-<21	21-<26	26-<31	31-<36	36-<41	41-<46	46-<51	51-<56	=>56
Sat 04-Jun-16																
00:00	88	34.1	28.6	5.6	0	0	0	3	26	36	15	5	3	0	0	0
01:00	71	34.4	29.4	5.4	0	0	1	2	11	33	19	4	0	1	0	0
02:00	57	34.1	29.5	5.5	0	1	0	0	9	28	16	2	0	1	0	0
03:00	36	35.6	30.9	6.1	0	0	0	1	6	12	12	2	3	0	0	0
04:00	26	35.5	29.3	6	0	0	0	2	5	10	5	4	0	0	0	0
05:00	60	38.5	31.5	6.3	0	0	0	0	10	23	16	3	8	0	0	0
06:00	67	37.8	31.3	7.3	0	0	1	2	12	18	21	7	4	1	1	0
07:00	111	34.1	28.3	5.8	0	0	2	8	26	41	27	5	2	0	0	0
08:00	232	30.7	26.6	4.7	0	0	0	25	73	105	24	5	0	0	0	0
09:00	297	30.6	25.8	5	0	0	2	34	136	87	28	9	1	0	0	0
10:00	304	29.7	24.8	5.1	0	0	12	45	129	96	18	3	0	1	0	0
11:00	340	30.2	25.8	4.8	0	0	9	34	123	145	25	4	0	0	0	0
12:00	354	29.9	25.2	5	0	1	7	49	149	120	22	5	0	1	0	0
13:00	390	31.1	26.8	5.4	0	3	8	26	123	170	45	12	3	0	0	0
14:00	364	30.4	25.9	4.8	0	0	10	27	149	140	34	3	1	0	0	0
15:00	321	29.6	24.2	5.3	0	3	13	54	147	77	24	3	0	0	0	0
16:00	305	30	25.5	5	0	0	2	35	142	100	20	4	1	0	0	1
17:00	319	32.2	27	5.3	0	0	7	25	96	131	49	10	1	0	0	0
18:00	250	32.3	27.2	5.1	0	0	5	16	75	104	45	4	1	0	0	0
19:00	268	31.2	27.1	5	0	0	5	8	99	114	35	6	0	0	0	1
20:00	201	32.8	27.7	5.3	0	1	1	10	59	88	32	7	3	0	0	0
21:00	184	30.8	26.1	5.6	0	0	4	23	66	66	15	8	2	0	0	0
22:00	194	33.1	27.6	5.5	0	0	2	18	50	80	34	8	2	0	0	0
23:00	289	28.2	22.3	5.6	0	0	27	104	89	56	9	2	2	0	0	0
12H,7-19	3587	30.6	25.9	5.2	0	7	77	378	1368	1316	361	67	10	2	0	1
16H,6-22	4307	30.8	26.2	5.3	0	8	88	421	1604	1602	464	95	19	3	1	2
18H,6-24	4790	30.8	26	5.4	0	8	117	543	1743	1738	507	105	23	3	1	2
24H,0-24	5128	31	26.2	5.5	0	9	118	551	1810	1880	590	125	37	5	1	2

20401		HIGHGATE			Site No: 20401001		Location Hampstead Lane, Highgate (LC)									
#REF!		Channel: Westbound														
Time Period	Total Vehicles	85%ile Speed	Mean Speed	Stand Dev.	<6Mph	6-<11	11-<16	16-<21	21-<26	26-<31	31-<36	36-<41	41-<46	46-<51	51-<56	=>56
Sun 05-Jun-16																
00:00	514	21.4	17	4.8	1	18	224	189	60	19	2	0	1	0	0	0
01:00	282	24.8	18.8	5.5	0	6	82	127	32	26	9	0	0	0	0	0
02:00	82	31.5	26.5	6	0	0	4	10	19	35	11	2	1	0	0	0
03:00	57	35.7	30.7	7	0	0	1	1	10	19	18	5	2	0	0	1
04:00	53	38.8	31.8	6.8	0	0	1	0	6	22	10	10	2	2	0	0
05:00	36	37.1	31.1	6.3	0	0	0	1	5	14	9	5	1	1	0	0
06:00	45	35.7	29.4	7.8	0	0	1	3	12	13	9	4	0	3	0	0
07:00	86	35.3	28.3	7.1	0	0	4	7	24	18	23	7	3	0	0	0
08:00	161	32.9	27.5	5.6	0	0	3	12	46	66	24	8	2	0	0	0
09:00	246	30.9	26.3	5.1	0	0	2	29	86	92	31	5	1	0	0	0
10:00	343	30.7	26.1	5.1	0	0	6	25	155	112	35	7	2	1	0	0
11:00	354	30.6	26.1	4.8	0	0	5	26	156	123	33	11	0	0	0	0
12:00	383	30.1	25.4	4.9	0	1	8	49	153	139	28	5	0	0	0	0
13:00	431	29.3	24.3	4.9	0	1	15	74	193	126	15	7	0	0	0	0
14:00	438	29.7	24.8	4.8	0	2	12	52	208	133	27	3	1	0	0	0
15:00	381	29.7	24.7	5.3	0	2	15	57	153	129	22	1	1	0	1	0
16:00	361	29.9	25.1	5.1	1	1	9	42	168	109	26	4	0	0	1	0
17:00	363	30	25.1	4.8	0	0	6	57	150	118	30	2	0	0	0	0
18:00	343	32.4	27.1	5.4	0	0	9	24	102	140	57	8	3	0	0	0
19:00	308	32.8	27.8	5	0	0	1	16	90	136	51	11	2	1	0	0
20:00	237	32.5	27.8	4.8	0	0	2	12	59	116	41	6	1	0	0	0
21:00	163	33.1	27.7	5.6	0	0	2	6	58	59	31	3	3	0	1	0
22:00	164	32.3	27.8	5.2	0	0	1	4	54	73	27	3	0	0	2	0
23:00	140	35.8	30.5	6	0	0	0	3	26	52	38	15	3	3	0	0
12H,7-19	3890	30.4	25.6	5.2	1	7	94	454	1594	1305	351	68	13	1	2	0
16H,6-22	4643	30.7	25.9	5.3	1	7	100	491	1813	1629	483	92	19	5	3	0
18H,6-24	4947	30.9	26.1	5.4	1	7	101	498	1893	1754	548	110	22	8	5	0
24H,0-24	5971	30.7	25.1	6.2	2	31	413	826	2025	1889	607	132	29	11	5	1

20401		HIGHGATE			Site No: 20401001		Location Hampstead Lane, Highgate (LC)									
#REF!		Channel: Westbound														
Time Period	Total Vehicles	85%ile Speed	Mean Speed	Stand Dev.	<6Mph	6-<11	11-<16	16-<21	21-<26	26-<31	31-<36	36-<41	41-<46	46-<51	51-<56	=>56
Mon 06-Jun-16																
00:00	70	35.3	30.2	6.2	0	0	0	1	18	21	22	4	2	2	0	0
01:00	38	36.7	31	6.3	0	0	0	2	5	12	12	6	0	1	0	0
02:00	21	34.8	29.5	5.8	0	0	0	2	3	7	7	2	0	0	0	0
03:00	21	41.6	34.2	6.7	0	0	0	0	1	7	6	3	3	1	0	0
04:00	24	39.9	33.3	6	0	0	0	0	1	10	5	5	3	0	0	0
05:00	54	38.7	32	7.9	0	0	1	1	8	16	14	10	2	0	1	1
06:00	185	35.1	29.2	6.4	0	0	5	11	33	68	49	13	5	0	1	0
07:00	336	30.8	26.5	4.9	0	0	9	17	125	140	36	9	0	0	0	0
08:00	463	28.8	23.6	4.9	0	2	18	102	212	106	21	2	0	0	0	0
09:00	331	30.2	25.7	4.8	0	1	8	23	147	120	29	2	0	1	0	0
10:00	335	30	25.5	5.2	0	0	10	31	147	120	21	3	2	0	0	1
11:00	342	29.7	24.9	4.9	0	0	11	52	133	126	16	4	0	0	0	0
12:00	353	30.6	26.5	4.5	0	0	5	19	132	155	39	1	2	0	0	0
13:00	352	30.2	25.6	4.9	0	1	7	35	149	128	28	3	0	1	0	0
14:00	394	30	24.7	5.3	0	1	24	46	168	119	32	4	0	0	0	0
15:00	586	29.5	24.9	4.4	0	0	7	78	288	178	32	2	1	0	0	0
16:00	624	29.6	24.8	4.8	0	1	20	78	291	193	37	3	1	0	0	0
17:00	622	30.4	26.2	4.7	0	1	8	46	235	270	52	8	1	1	0	0
18:00	543	31.5	26.3	5.5	0	3	18	50	171	211	79	11	0	0	0	0
19:00	383	31.7	26.8	5.1	0	1	10	20	130	155	61	4	2	0	0	0
20:00	232	35	29.7	6.2	0	0	3	9	42	88	68	15	3	3	0	1
21:00	181	34.3	28.4	5.8	0	1	4	6	45	69	43	11	2	0	0	0
22:00	163	32.2	27.7	4.8	0	0	1	4	55	72	25	4	2	0	0	0
23:00	96	34	28.3	6.1	0	0	1	5	29	36	17	3	5	0	0	0
12H,7-19	5281	30.2	25.4	4.9	0	10	145	577	2198	1866	422	52	7	3	0	1
16H,6-22	6262	30.6	25.9	5.2	0	12	167	623	2448	2246	643	95	19	6	1	2
18H,6-24	6521	30.7	25.9	5.2	0	12	169	632	2532	2354	685	102	26	6	1	2
24H,0-24	6749	30.8	26.1	5.4	0	12	170	638	2568	2427	751	132	36	10	2	3

20401 HIGHGATE Site No: 20401001 Location Hampstead Lane, Highgate (LC)
 #REF! Channel: Westbound

Time Period	Total Vehicles	85%ile Speed	Mean Speed	Stand Dev.	<6Mph	6-<11	11-<16	16-<21	21-<26	26-<31	31-<36	36-<41	41-<46	46-<51	51-<56	=>56
-------------	----------------	--------------	------------	------------	-------	-------	--------	--------	--------	--------	--------	--------	--------	--------	--------	------

Daily Totals

Sat 04-Jun-16	5128	31	26.2	5.5	0	9	118	551	1810	1880	590	125	37	5	1	2
Sun 05-Jun-16	5971	30.7	25.1	6.2	2	31	413	826	2025	1889	607	132	29	11	5	1
Mon 06-Jun-16	6749	30.8	26.1	5.4	0	12	170	638	2568	2427	751	132	36	10	2	3
-	-	-	-	-	-	-	-	-	-	-	-	-	-	-	-	-
-	-	-	-	-	-	-	-	-	-	-	-	-	-	-	-	-
-	-	-	-	-	-	-	-	-	-	-	-	-	-	-	-	-
-	-	-	-	-	-	-	-	-	-	-	-	-	-	-	-	-

Total Vehicles

[--]	17848	30.8	25.8	5.7	2	52	701	2015	6403	6196	1948	389	102	26	8	6
------	-------	------	------	-----	---	----	-----	------	------	------	------	-----	-----	----	---	---

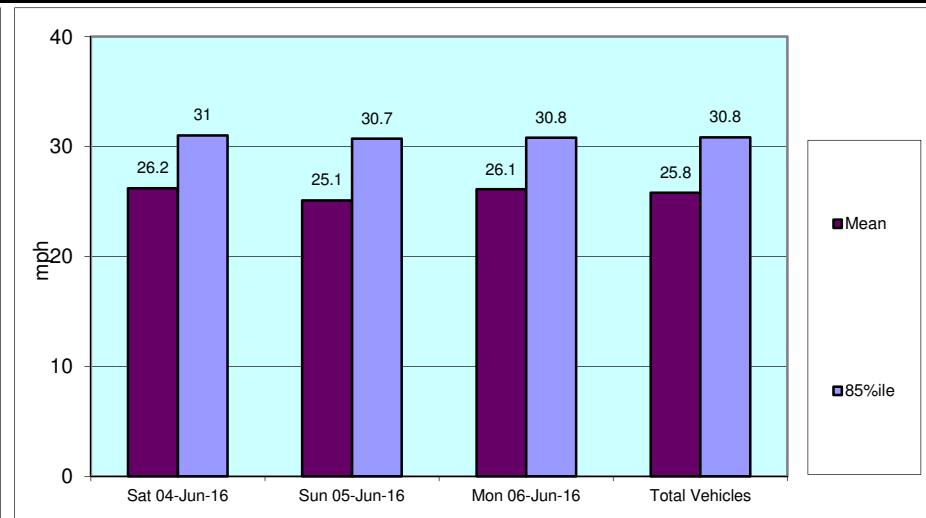
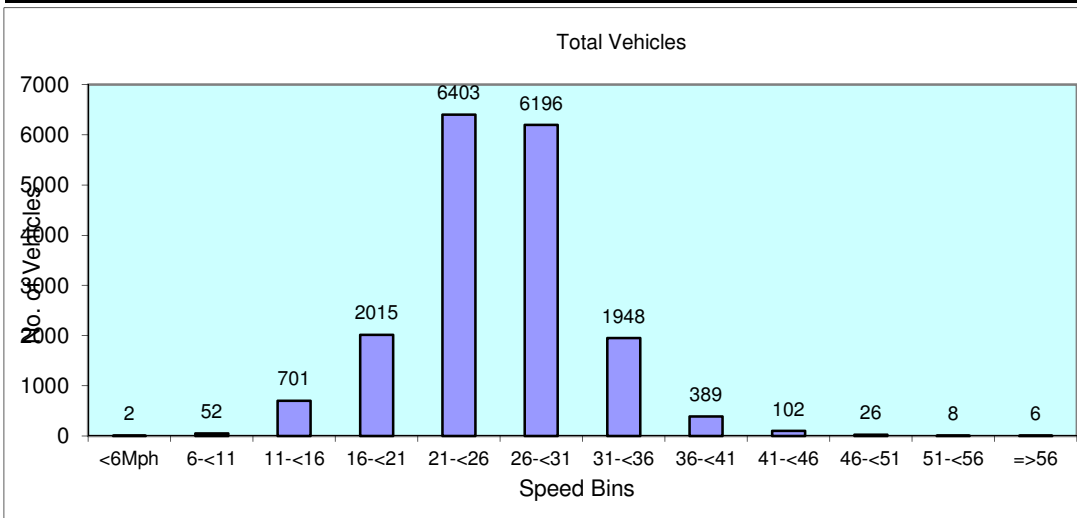

20401	HIGHGATE		Site No: 20401001	Location		Hampstead Lane, Highgate (LC)			
	Channel: Westbound								
TIME PERIOD	Sat 04/06/16	Sun 05/06/16	Mon 06/06/16	Tue 07/06/16	Wed 08/06/16	Thu 09/06/16	Fri 10/06/16	5-Day Av	7-Day Av
Week Begin: 04-Jun-16									
00:00	88	514	70	-	-	-	-	70	136
01:00	71	282	38	-	-	-	-	38	78
02:00	57	82	21	-	-	-	-	21	35
03:00	36	57	21	-	-	-	-	21	28
04:00	26	53	24	-	-	-	-	24	28
05:00	60	36	54	-	-	-	-	54	52
06:00	67	45	185	-	-	-	-	185	148
07:00	111	86	336	-	-	-	-	336	268
08:00	232	161	463	-	-	-	-	463	387
09:00	297	246	331	-	-	-	-	331	314
10:00	304	343	335	-	-	-	-	335	332
11:00	340	354	342	-	-	-	-	342	343
12:00	354	383	353	-	-	-	-	353	357
13:00	390	431	352	-	-	-	-	352	369
14:00	364	438	394	-	-	-	-	394	396
15:00	321	381	586	-	-	-	-	586	519
16:00	305	361	624	-	-	-	-	624	541
17:00	319	363	622	-	-	-	-	622	542
18:00	250	343	543	-	-	-	-	543	473
19:00	268	308	383	-	-	-	-	383	356
20:00	201	237	232	-	-	-	-	232	228
21:00	184	163	181	-	-	-	-	181	179
22:00	194	164	163	-	-	-	-	163	168
23:00	289	140	96	-	-	-	-	96	130
12H,7-19	3587	3890	5281	-	-	-	-	5281	4840
16H,6-22	4307	4643	6262	-	-	-	-	6262	5751
18H,6-24	4790	4947	6521	-	-	-	-	6521	6049
24H,0-24	5128	5971	6749	-	-	-	-	6749	6406
Am	11:00	00:00	08:00	-	-	-	-	-	-
Peak	340	514	463	-	-	-	-	463	453
Pm	13:00	14:00	16:00	-	-	-	-	-	-
Peak	390	438	624	-	-	-	-	624	564

20401	HIGHGATE	Site No: 20401001	Location	Hampstead Lane, Highgate (LC)					
		Channel: Westbound							
TIME PERIOD	Sat	Sun	Mon	Tue	Wed	Thu	Fri	5-Day	7-Day
	04/06/16	05/06/16	06/06/16	07/06/16	08/06/16	09/06/16	10/06/16	Av	Av

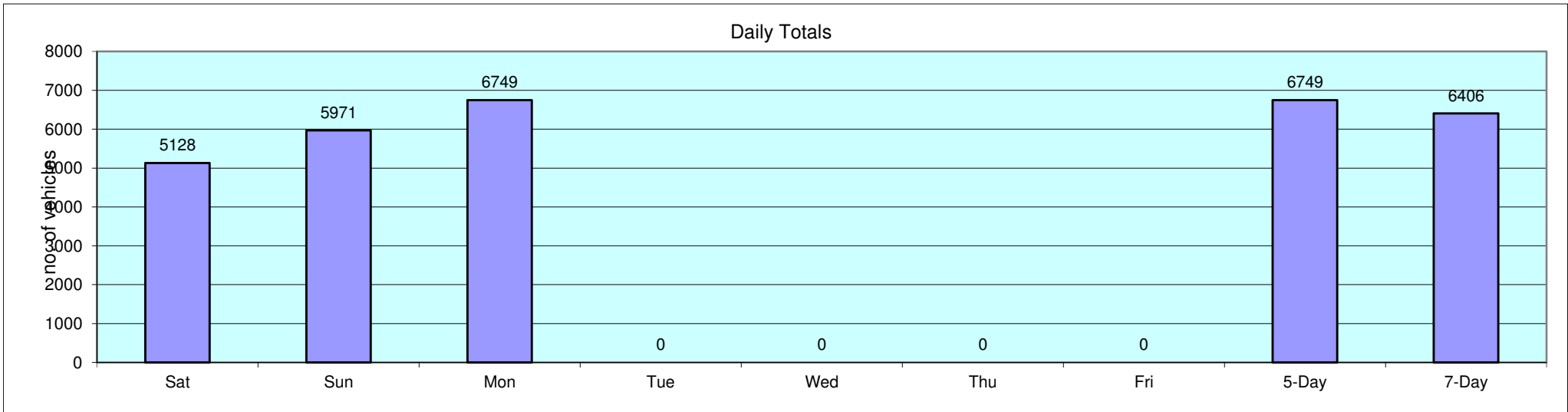

Appendix C

PTAL Report

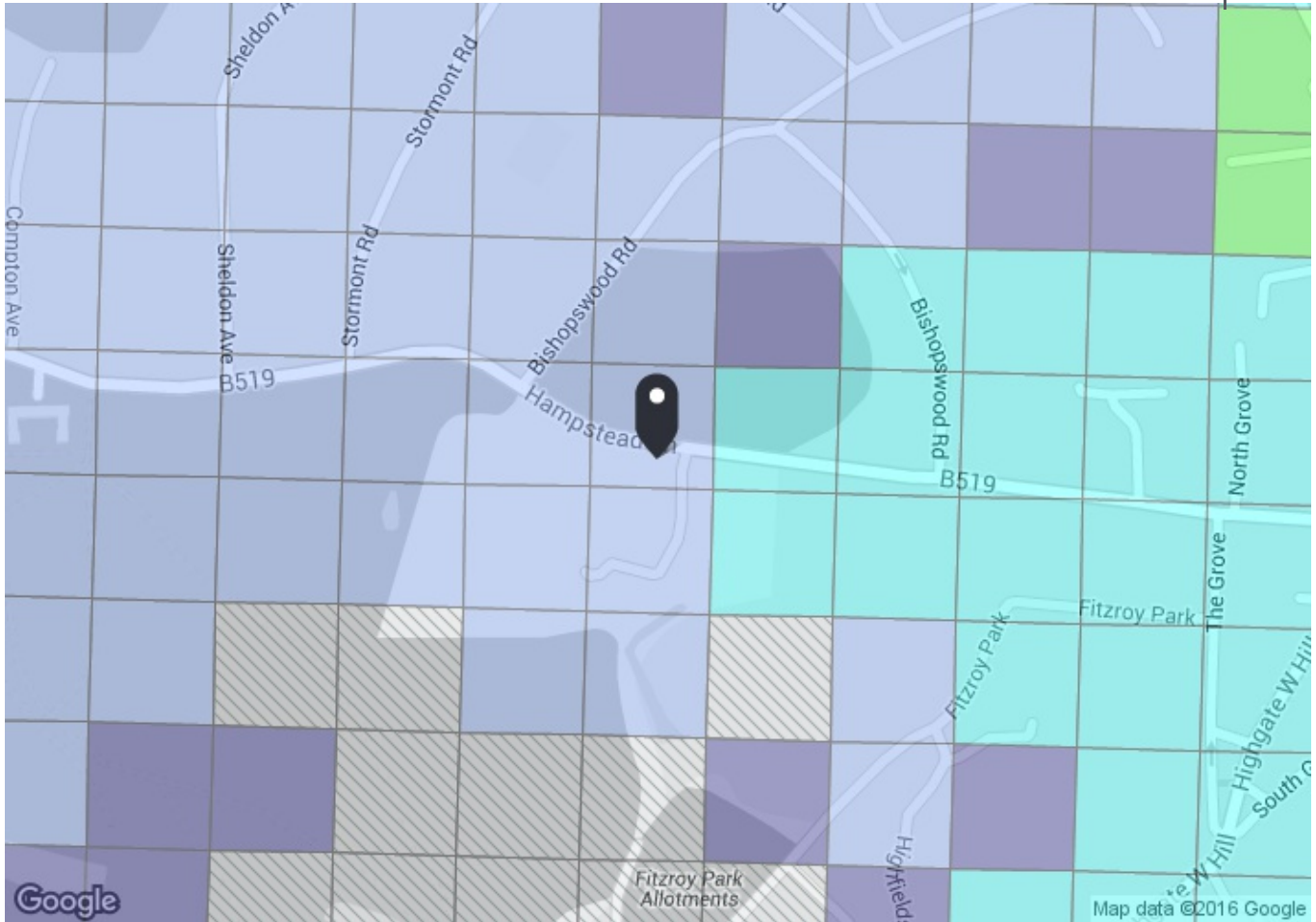

PTAL output for 2011 (Base year)
1 b

24 Hampstead Ln, London N6 4SA, UK

Easting: 527752, Northing: 187516

Grid Cell: 118167

Report generated: 17/06/2016

Calculation Parameters

Day of Week	M-F
Time Period	AM Peak
Walk Speed	4.8 kph
Bus Node Max. Walk Access Time (mins)	8
Bus Reliability Factor	2.0
LU Station Max. Walk Access Time (mins)	12
LU Reliability Factor	0.75
National Rail Station Max. Walk Access Time (mins)	12
National Rail Reliability Factor	0.75

Map key - PTAL

	0 (Worst)		1a
	1b		2
	3		4
	5		6a
	6b (Best)		

Map layers

- PTAL (cell size: 100m)

Calculation data

Mode	Stop	Route	Distance (metres)	Frequency(vph)	Walk Time (mins)	SWT (mins)	TAT (mins)	EDF	Weight	AI
Bus	ATHLONE HOUSE HOSPITAL	210	83.24	7.5	1.04	6	7.04	4.26	1	4.26
Total Grid Cell AI:									4.26	

Appendix D

Proposed Site Access

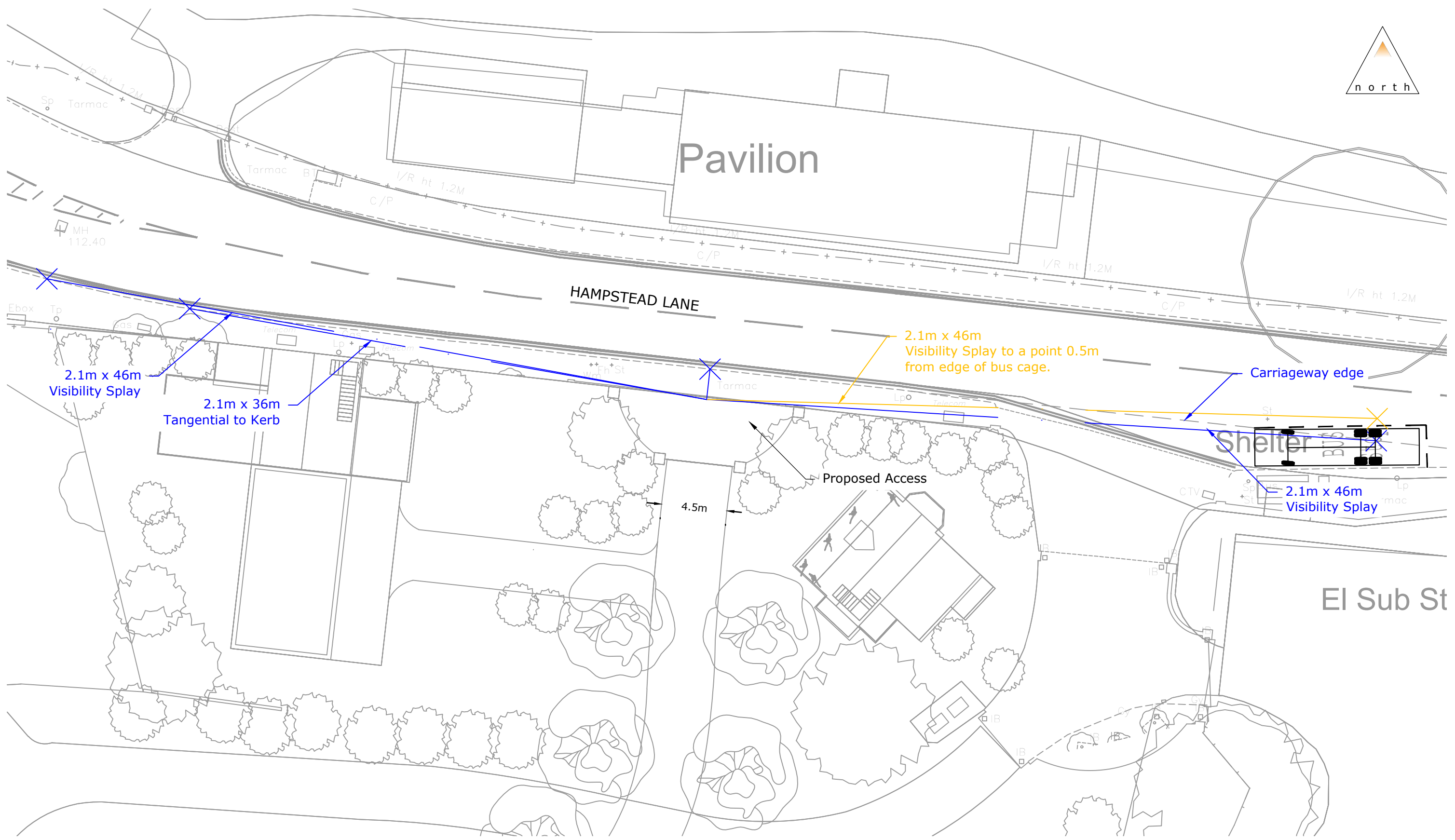
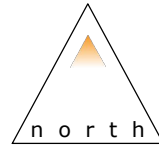

2.1m x 46m
Visibility Splay

2.1m x 36m
Tangential to Kerb

2.1m x 46m
Visibility Splay to a point 0.5m
from edge of bus cage.

Carriageway edge

2.1m x 46m
Visibility Splay

HAMPSTEAD LANE

Pavilion

Proposed Access

Shelter

El Sub St

L:\Projects\shathl 160202\Drawings\160202-02.dwg

© Crown Copyright 2012. All rights reserved. Licence number 100043407

Trident II - 11.30m 3-Axle	
Overall Length	11.273m
Overall Width	2.495m
Overall Body Height	4.140m
Min Body Ground Clearance	0.311m
Track Width	2.363m
Lock-to-lock time	4.00s
Curb to Curb Turning Radius	8.535m

84 North Street
Guildford
Surrey
GU1 4AU
T: 01483 531 300

Golden Cross House
8 Duncannon Street
London
WC2N 4JF
T: 020 7031 8141

www.motion.co.uk

Project: Athlone House, Hampstead Lane		
Title: Proposed Access Visibility Splays		
Scale: 1:250 (@ A3)		
Notes:		
Drawing: 160202-02	Revision: -	

Appendix E

Pre Application Correspondence with London Borough of Haringey

Pete Sturgeon

From: Richards Maurice <Maurice.Richards@haringey.gov.uk>
Sent: 07 April 2016 09:20
To: Pete Sturgeon; Pinamonti-Hyde Ian
Subject: RE: Athlone House Site Access

Peter

Sorry for not responding to this earlier, we wouldn't object to the proposed new access subject to and independent Stage 1 and 2 road safety audit.

Regards

Maurice

Maurice Richards
Principal Transportation Planner

Haringey Council
River Park House, 225 High Road, London N22 8HQ

T. 020 8489 5575

M. 07971668536

Maurice.Richards@haringey.gov.uk

www.haringey.gov.uk

twitter@haringeycouncil

[facebook.com/haringeycouncil](https://www.facebook.com/haringeycouncil)

Please consider the environment before printing this email.

From: Pete Sturgeon [mailto:psturgeon@motion.co.uk]

Sent: 06 April 2016 10:19

To: Pinamonti-Hyde Ian

Cc: Richards Maurice

Subject: Re: Athlone House Site Access

Ian,

Thanks for this. I'll go through the guidance and obtain accident stats and audit.

The need for the access is listed in my original email of 23rd March. Given the reasons listed, can you comment as to whether the highway authority would accept that there is merit in providing the new access.

Kind regards,

Pete

Sent from my iPhone

On 5 Apr 2016, at 13:06, Pinamonti-Hyde Ian <ian.Pinamonti-Hyde@haringey.gov.uk> wrote:

Peter,

I've had a look at your drawings/location plan and have looked on Google earth and can see approximately where your client intends to place the proposed access.

It is fair to say that in terms of visibility and position, this could work purely in visibility splay terms as the appropriate visibility splays can be achieved. However to fully consider the new crossover/access proposal, you'll need to detail all the appropriate information referred to as being needed in Haringey's online Crossover guide and accompanying guidance note;

<http://www.haringey.gov.uk/parking-roads-and-travel/roads-and-streets/road-care-and-maintenance/vehicle-crossover-dropped-kerbs>

In addition to this, any application submission should provide us with information on;

1. The absolute need for the proposed access in the first place – why it is required and why two accesses where there is currently one is desirable from the Highway Authority perspective
2. Any relevant accompanying highway safety information – such as accident statistics and a safety audit for the proposed access to ensure all issues are considered.

Regards,

Ian

From: Pete Sturgeon
Sent: 23 March 2016 11:19
To: maurice.richards@haringey.gov.uk
Subject: Athlone House Site Access

Dear Maurice,

I trust you are well.

I have been appointed to provide traffic and highway advice in respect of the proposed refurbishment of Athlone House on Hampstead Lane. The site is in Camden, but as Hampstead Lane is within Haringey, I've attached a site location plan for your reference. You may know the site, but I'll provide some background. Athlone House is a grand house originally constructed as a family home in about 1870 and was occupied as a family dwelling until 1942. It was then used by the RAF and subsequently as a convalescent home until 2003 when the site was sold. A residential development of 3 apartment buildings (Caenwood Court) was then constructed on the eastern part of the original site. Planning permission for the demolition of Athlone House and construction of a new house was refused at appeal last year.

It is now proposed that the original house be refurbished to enable its use by my client as a family home once more. There are two smaller houses on the site which will also be refurbished and are likely be used for staff accommodation. Access to the site is currently by way of an access from Hampstead Lane, which also serves Caenwood Court. As a part of the current proposal, we are looking to provide a new dedicated point of access to the site some 40 metres west of the current access. The existing access would be retained but would not be the primary point of access to Athlone House. The proposals are still in development, but it is thought that the existing access would be retained for emergency use, or it may be of some use for a refuse vehicle traveling between Athlone House and Caenwood Court. Drawing 160202-01 shows the proposed new point of access and demonstrates that 2.4 x 43 metre visibility splays (in accordance with Manual for

Streets) can be achieved. There is no parking on Hampstead Lane in the vicinity of the proposed access and the road is straight as it passes the site. The form of the access proposed is the same as that of another property on Hampstead Lane to the east (Beechcroft), a photo of which I attach.

A separate point of access is considered appropriate for a grand house of this type and there is evidence to suggest that there would have been an access to the site in the location now proposed in the past. Security is an important concern for my client and there is significant merit in the property having two points of access. The proposal has been discussed with officers at Camden Council who support the creation of the new access for architectural/land use planning/heritage reasons, and consider it satisfactory from a transport perspective. I consider that there are a number of transport merits to the provision of a new point of access, which I detail below.

- The provision of a new access would reduce any potential disturbance by vehicles to occupants of Caenwood Court, particularly during construction works.
- It has been observed that congestion can occur at the existing access if vehicles are delayed or unable to access Caenwood Court. With 21 flats, an unmanned security gate, and limited parking within the site, there can be quite an accumulation of tradesmen's vans and delivery vans. This is not only inconvenient for residents, but also unsafe as it potentially obscures visibility, and vehicles could back up onto the road. It would also compromise the security of the new owner of Athlone House, by preventing him being able to access/exit through his single gate. The provision of a new access would reduce the potential for this congestion to restrict access to Athlone House or to be exacerbated by Athlone House being brought back into use.
- The existing access is located immediately adjacent a westbound bus stop on Hampstead Lane and buses using the stop restrict visibility for vehicles leaving the access.
- There is potential for conflict at the existing access between a vehicle turning left in from Hampstead Lane and a vehicle leaving Caenwood Court as visibility between vehicles manoeuvring in this way is very limited.

I'd be grateful if you could consider this proposal and let me know whether the highway authority would consider such an arrangement to be acceptable.

I look forward to hearing from you in due course.

Kind Regards,

Peter Sturgeon | Associate Director

motion | 8 Duncannon Street, London WC2N 4JF

t 020 7031 8141 | m 07853 221976 | e psturgeon@motion-uk.co.uk | w www.motion-uk.co.uk

The information in this email is confidential and is intended solely for the addressee(s). Access to this email by anyone else is unauthorised. If you are not an intended recipient, you must not read, use or disseminate the information contained in this email. Any views expressed in this message are those of the individual sender, except where the sender specifically states them to be the views of Motion.

This email has been scanned by the Symantec Email Security.cloud service.
For more information please visit <http://www.symanteccloud.com>

This email and any files transmitted with it are confidential, may be subject to legal privilege and are intended only for the person(s) or organisation(s) to whom this email is addressed. Any unauthorised use, retention, distribution, copying or disclosure is strictly prohibited. If you have received this email in error, please notify the system administrator at Haringey Council immediately and delete this e-mail from your system. Although this e-mail and any attachments are believed to be free of any virus or other defect which might affect any computer or system into which they are received and opened, it is the responsibility of the recipient to ensure they are virus free and no responsibility is accepted for any loss or damage from receipt or use thereof. All communications sent to or from external third party organisations may be subject to recording and/or monitoring in accordance with relevant legislation.

This email has been scanned by the Symantec Email Security.cloud service.
For more information please visit <http://www.symanteccloud.com>

<160202-01.pdf>

<Site Location Plan.pdf>

<Beechwood entrance.jpg>

This email has been scanned by the Symantec Email Security.cloud service.
For more information please visit <http://www.symanteccloud.com>

This email and any files transmitted with it are confidential, may be subject to legal privilege and are intended only for the person(s) or organisation(s) to whom this email is addressed. Any unauthorised use, retention, distribution, copying or disclosure is strictly prohibited. If you have received this email in error, please notify the system administrator at Haringey Council immediately and delete this e-mail from your system. Although this e-mail and any attachments are believed to be free of any virus or other defect which might affect any computer or system into which they are received and opened, it is the responsibility of the recipient to ensure they are virus free and no responsibility is accepted for any loss or damage from receipt or use thereof. All communications sent to or from external third party organisations may be subject to recording and/or monitoring in accordance with relevant legislation.

This email has been scanned by the Symantec Email Security.cloud service.
For more information please visit <http://www.symanteccloud.com>

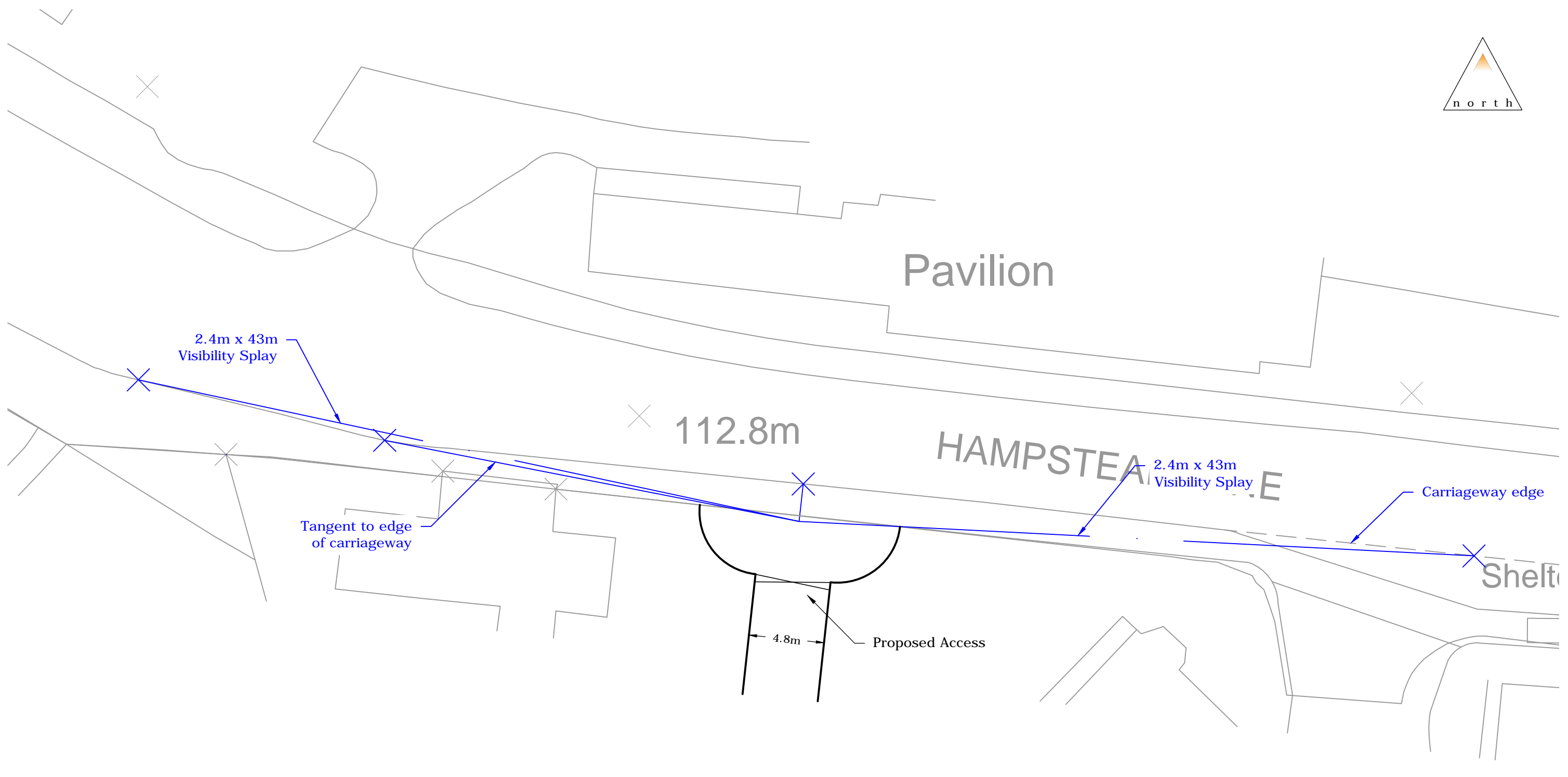

L:\Projects\shathl 160202\Drawings\160202-01.dwg

© Crown Copyright 2012. All rights reserved. Licence number 100043407



232 High Street
Guildford
Surrey
GU1 3JF

T: 01483 531 300

Golden Cross House
8 Duncannon Street
London
WC2N 4JF

T: 020 7031 8141

www.motion-uk.co.uk

Project:
Athlone house, Hampstead Lane

Title:
Proposed Access

Scale: 1:250 (@ A3)

Notes:

Drawing:
160202-01

Revision:
-

Appendix F

Proposed Site Access Detailed Design Drawings

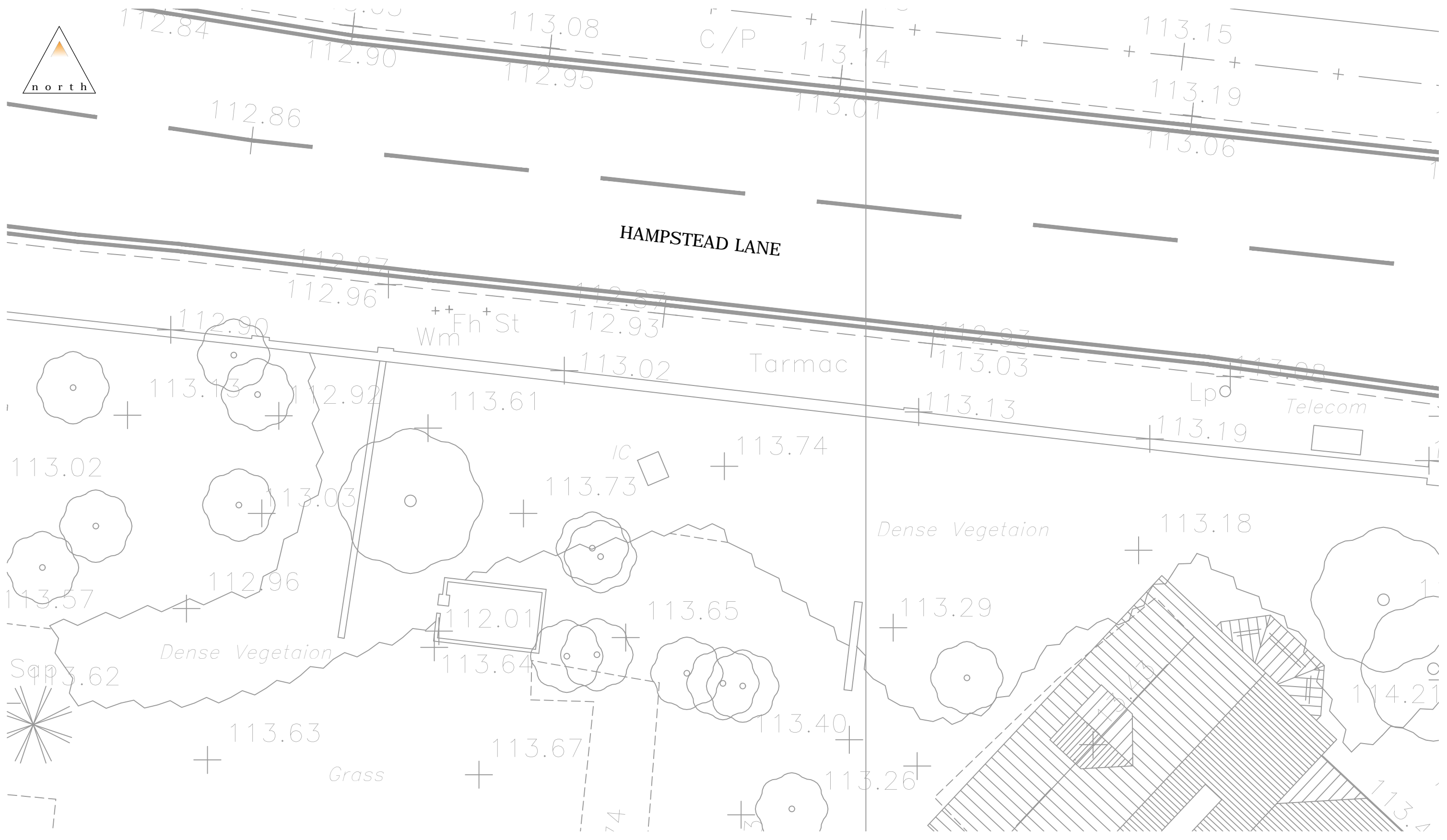
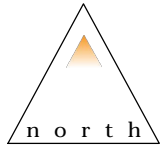

L:\Projects\shathl 160202\Drawings\Detailed Design\160202-001a.dwg

© Crown Copyright 2012. All rights reserved. Licence number 100043407



84 North Street
Guildford
Surrey
GU1 4AU
T: 01483 531 300

Golden Cross House
8 Duncannon Street
London
WC2N 4JF
T: 020 7031 8141

www.motion.co.uk

Project:
Athlone House, Hampstead Lane

Title:
**Proposed Access
Existing Survey**

Scale: 1:100 (@ A3)

Notes:

Drawing:
160202-001

Revision:
A

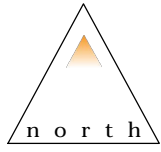

HAMPSTEAD LANE

Proposed Dropped Kerb

Proposed Footway Crossover

Tarmac

Proposed New Wall

Dense Vegetaion

Proposed New Wall

Proposed Access Gates

Dense Vegetaion

Grass

C/P

++ Fh + St
Wm

Lpo

Telecom

IC

Sap

L:\Projects\shathl 160202\Drawings\Detailed Design\160202-101a.dwg

© Crown Copyright 2012. All rights reserved. Licence number 100043407



84 North Street
Guildford
Surrey
GU1 4AU
T: 01483 531 300

Golden Cross House
8 Duncannon Street
London
WC2N 4JF
T: 020 7031 8141

www.motion.co.uk

Project:
Athlone House, Hampstead Lane

Title:
Proposed Access
General Arrangement

Scale: 1:100 (@ A3)

Notes:

Drawing:
160202-101

Revision:
A

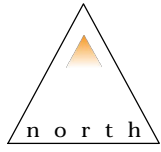

Setting Out Co-ordinates			
Point	Easting	Northing	Level
P01	527739.51	187529.84	112.87
P02	527740.30	187529.75	112.87
P03	527752.24	187528.45	112.94
P04	527753.03	187528.37	112.95
P05	527740.10	187527.83	113.00
P06	527752.04	187526.59	113.14
P07	527748.00	187522.79	113.06
P08	527743.22	187523.31	113.00

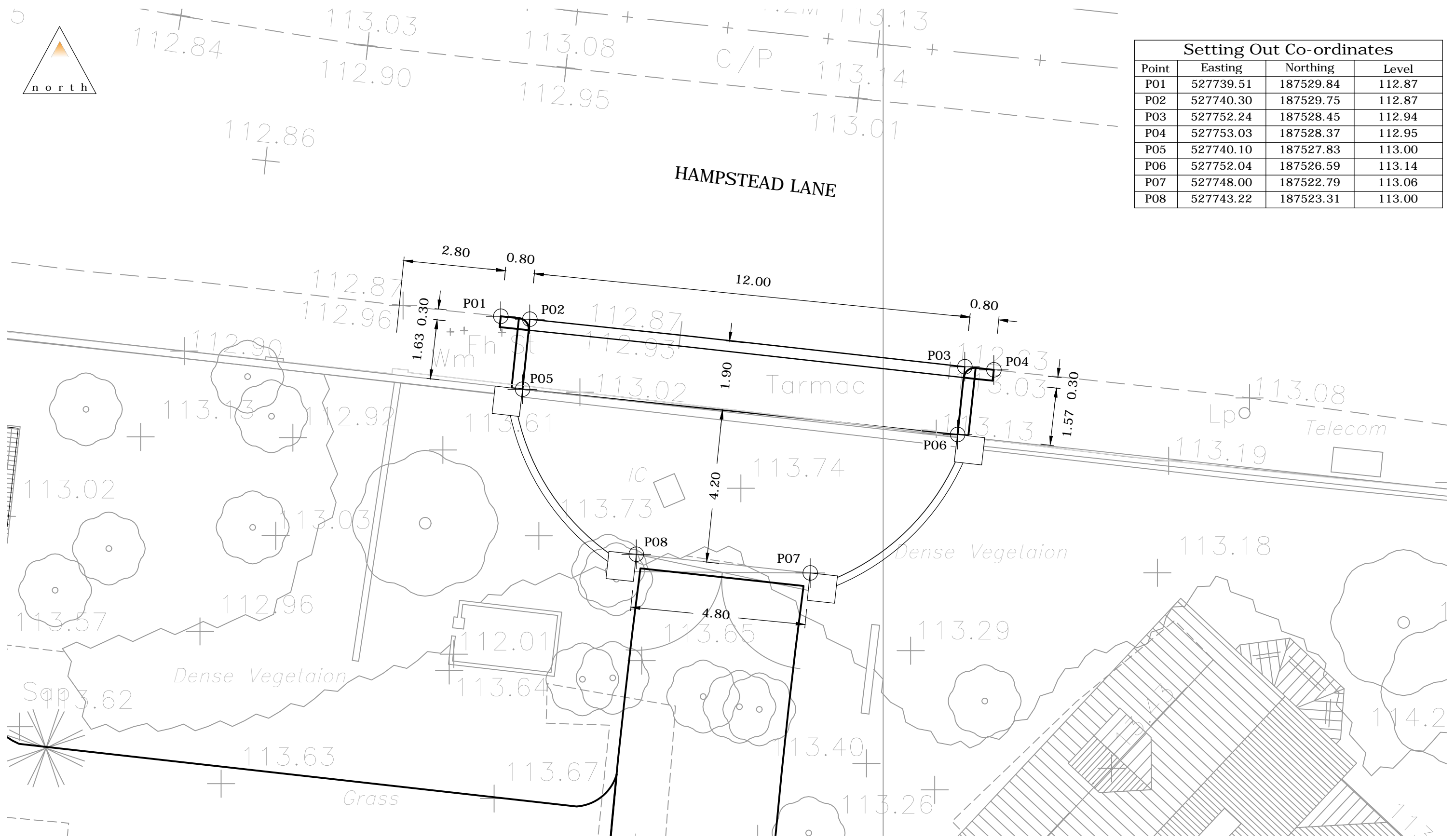

L:\Projects\shathl 160202\Drawings\Detailed Design\160202-201a.dwg



84 North Street
 Guildford
 Surrey
 GU1 4AU
 T: 01483 531 300

Golden Cross House
 8 Duncannon Street
 London
 WC2N 4JF
 T: 020 7031 8141

www.motion.co.uk

Project:
Athlone House, Hampstead Lane

Title:
**Proposed Access
 Setting Out**

Scale: 1:100 (@ A3)

Notes:

Drawing:
160202-201

Revision:
A

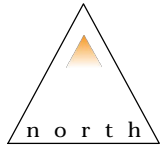

HAMPSTEAD LANE

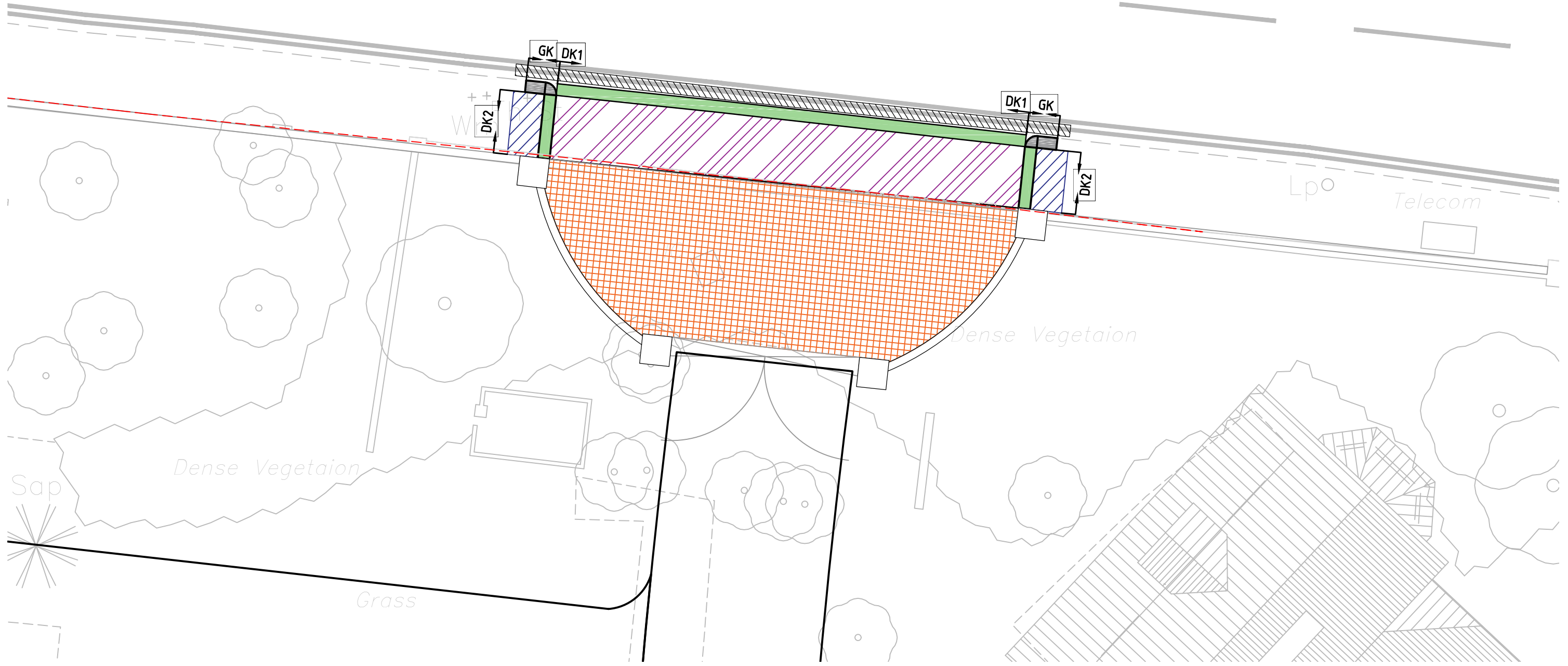

L:\Projects\shathl 160202\Drawings\Detailed Design\160202-401a.dwg

Legend	
	Highway Boundary
	300 x 200mm granite quadrant
	300 x 200mm granite kerb
	300 x 200mm granite dropped kerb
	100 x 100mm granite setts
	20mm footway resurfacing
	40mm carriageway resurfacing
	Full depth crossover construction
	Granite dropped kerb, 25mm upstand
	Granite dropped kerb, 0mm upstand
	Granite kerb, 90mm upstand

© Crown Copyright 2012. All rights reserved. Licence number 100043407

motion

84 North Street
Guildford
Surrey
GU1 4AU
T: 01483 531 300

Golden Cross House
8 Duncannon Street
London
WC2N 4JF
T: 020 7031 8141

www.motion.co.uk

Project: Athlone House, Hampstead Lane	
Title: Proposed Access Construction Areas	
Scale: 1:100 (@ A3)	
Notes:	Revision: A
Drawing: 160202-401	

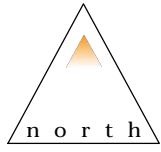

HAMPSTEAD LANE

C/P

++
Wm

Farmac

Lpo

Telecom



Dense Vegetaion



Dense Vegetaion

Grass

Sap

Legend

-  Excavate to full construction depth
-  Plane off 40mm carriageway surfacing
-  Plane off 20mm footway surfacing

-  Existing tree/vegetation to be removed
-  Existing kerb to be removed
-  Existing wall to be demolished



84 North Street
Guildford
Surrey
GU1 4AU
T: 01483 531 300

Golden Cross House
8 Duncannon Street
London
WC2N 4JF
T: 020 7031 8141

www.motion.co.uk

Project:
Athlone House, Hampstead Lane

Title:
Proposed Access
Site Clearance

Scale: 1:100 (@ A3)

Notes:

Drawing:
160202-601

Revision:
A

L:\Projects\shathl\160202\Drawings\Detailed Design\160202-601a.dwg

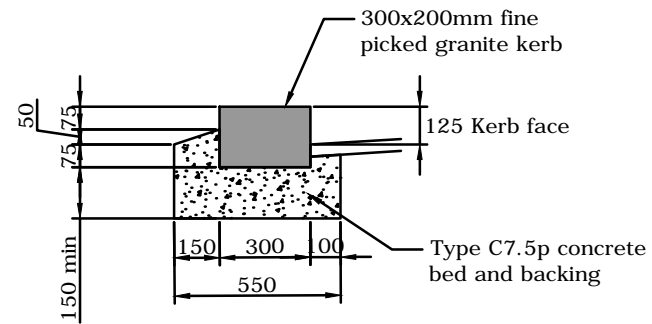

Granite Kerb Construction Detail

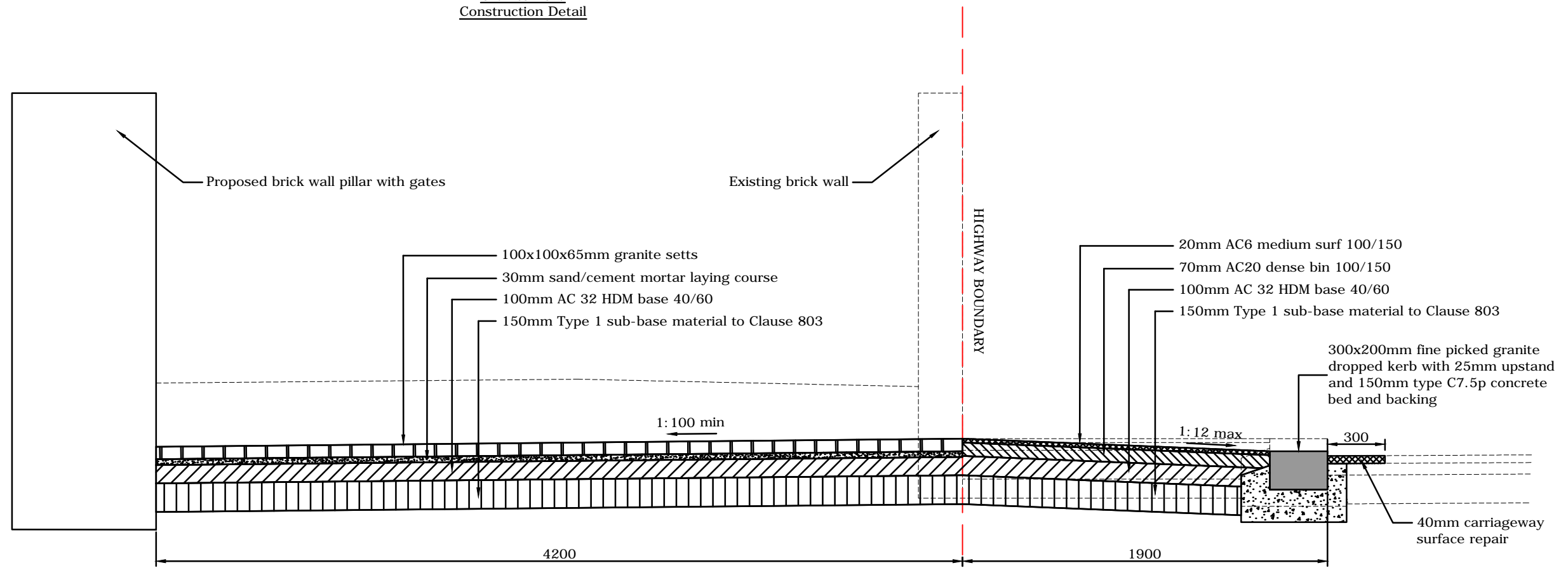

Heavy Duty Vehicular Crossover Construction Detail

L:\Projects\shathl 160202\Drawings\Detailed Design\160202-801a.dwg



84 North Street
Guildford
Surrey
GU1 4AU
T: 01483 531 300

Golden Cross House
8 Duncannon Street
London
WC2N 4JF
T: 020 7031 8141

Project:
Athlone House, Hampstead Lane

Title:
Proposed Access
Standard Construction Details

Scale: 1:25 (@ A3)

Notes:

Drawing:
160202-801

Revision:
A

Appendix G

Road Safety Audit

**ATHLONE HOUSE, HAMPSTEAD LANE,
HIGHGATE**

Proposed Access

**Stage 1/2 Road Safety Audit
Requested by Motion**

June 2016

FINAL



Project: Athlone House, Hampstead Lane, Highgate
Proposed Access

Client: Motion

Document: Stage 1/2 Road Safety Audit

Gateway TSP ref: WJT/SG/16-0504 RSA1 d1_3

Issue date: 17th June 2016

Status: Final 1.3

Authorised by: WJT

© Copyright Gateway TSP 2016



Transport Planning & Design

Surrey Technology Centre
40 Occam Road
Guildford
GU2 7YG

01483 685220
admin@gateway-tsp.co.uk
www.gateway-tsp.co.uk

CONTENTS

1	Introduction	1
2	Items Considered by this Road Safety Audit.....	3
3	Problems Identified by this Road Safety Audit	4
5	Audit Team Statement.....	7

Appendices

- Appendix A: Location Plan
- Appendix B: Designer's Response

1 INTRODUCTION

- 1.1** This report describes a Stage 1/2 Road Safety Audit (RSA) of proposed highway access works on Hampstead Lane, in Highgate, North London, to facilitate the redevelopment of Athlone House.
- 1.2** The highway works considered by this Audit comprise a single access to the redeveloped site. The access will be 4.5m wide with a widened area at the junction with Hampstead Lane. A secondary access, via Caenwood Court, will be retained.
- 1.3** The B519 Hampstead Road is a single carriageway road, running generally east to west with no waiting at any time parking restrictions (double yellow lines) on both sides. The area is lit by system of street-lighting and there are footways on both sides. It is subject to the London Borough of Haringey's Borough-wide 20mph speed limit.
- 1.4** This Road Safety Audit was carried out by Bill Tootill and Steve Giles between 3rd and 7th June 2016. The Audit consisted of a desktop study and a site visit, which was carried out on 6th June 2016, when the weather was dry and sunny and the road surface was dry. No traffic congestion was observed during the site inspection.
- 1.5** The Audit Team is independent of the project design team and has had no involvement in the design process. This RSA considers only the road safety implications of the proposed highway works.
- 1.6** This RSA has been undertaken in accordance with the relevant sections of document HD19/15, part of the Design Manual for Roads and Bridges (DMRB). The Safety Audit Team has examined only road safety implications of the scheme and has not verified compliance of the design to any other criteria. Problems identified in this report are considered by the Audit Team to merit action in order to improve the safety of the scheme and to minimise accident risks for all users.

- 1.7** Whilst reference may be made to design standards, this report is not intended to provide a design check. The Auditors have reported only on matters that might have an adverse effect on road safety in the context of the chosen design and no attempt is made to justify the scheme or the appropriateness of the design.
- 1.8** Recommendations contained within this report are aimed at addressing potential road safety problems. However, there may be other acceptable ways to overcome a particular problem, taking into account wider constraints and opportunities; the Auditors would be pleased to discuss such alternative solutions as appropriate. The recommendations contained herein do not absolve the Designer of his/her responsibilities.

Personal Injury Collisions (PIC) Data

- 1.9** The PIC data provided shows that two collisions occurred in the vicinity of the scheme in the latest three years' available data. One of these involved serious injuries and the other involved slight injuries.
- 1.10** The serious PIC occurred on Thursday 22nd May 2014. It was single vehicle collision in which a motorcycle was believed to have struck an object in the carriageway, resulting in serious injuries to the rider.
- 1.11** The slight PIC occurred on Monday 3rd March 2014. A pedestrian crossing Hampstead Lane, away from a controlled crossing and masked by a parked or stationary vehicle, was struck by a car, resulting in slight injuries to the pedestrian.

2 ITEMS CONSIDERED BY THIS ROAD SAFETY AUDIT

Document ref.	Rev.	Originator	Title
160202-001	A	Motion	Proposed Access, Existing Survey
160202-02	-	Motion	Proposed Access, Visibility Splays
160202-101	A	Motion	Proposed Access, General Arrangement
160202-201	A	Motion	Proposed Access, Setting Out
160202-401	A	Motion	Proposed Access, Construction Access
160202-601	A	Motion	Proposed Access, Site Clearance
160202-801	A	Motion	Proposed Access, Standard Construction Details

Additional/background information provided to the Audit Team

- NThe results of a speed survey, carried out between Saturday 4th and Monday 6th June, was also supplied to the Road Safety Audit Team.

3 PROBLEMS IDENTIFIED BY THIS ROAD SAFETY AUDIT

Checklist A1 – General Matters

3.1 Problem

Potential collisions if accessing large vehicles protrude into Hampstead Lane

Location: New access to Athlone House

The distance between the carriageway of Hampstead Lane and the gate at the access to Athlone House appears to be approximately 6.4m. It is possible that large vehicles waiting to access Athlone House could protrude back onto Hampstead Lane. This could lead to collisions between large vehicles waiting to access Athlone House and vehicles travelling along Hampstead Lane.

Recommendation

Ensure that large vehicles (likely to be a small number of servicing vehicles) continue to enter Athlone House via the existing, retained access. The proposed access should present no safety problems for the majority of accessing vehicles.

Checklist A2 – Local Alignment

3.2 The Audit Team raises no concerns at this Stage 1/2 RSA in respect of local alignment.

Checklist A3 – Junctions

3.3 The Audit Team raises no concerns at this Stage 1/2 RSA in respect of junctions.

Checklist A4 – Non-motorised User Provision

3.4 The Audit Team raises no concerns at this Stage 1/2 RSA in respect of Non-motorised User Provision.

Checklist A5 – Road Signs, Carriageway Markings and Lighting

- 3.5** The Audit Team raises no concerns at this Stage 1/2 RSA in respect of Road Signs, Carriageway Markings and Lighting.

4 OTHER MATTERS

4.1 In the course of the site inspection the Audit Team noted the following additional points:

- i) Despite it being a dry, sunny day with dry road surfaces elsewhere, surface water was observed at the junction of Hampstead Lane and Caenwood Court. This appears to be a long-standing problem as it has led to detritus downstream, which obscures the double yellow lines on the south side of Hampstead Lane.A photograph showing a road junction. On the right side, there is a brick wall and a utility pole. The road surface is paved, and there is a significant amount of surface water and detritus (leaves, twigs) on the right side of the road, obscuring the double yellow lines. The background shows trees and a clear sky.
- ii) It should be ensured that the existing double yellow lines on the south side of Hampstead Lane are reinstated, following implementation of the scheme.

5 AUDIT TEAM STATEMENT

5.1 We certify that this Road Safety Audit has been carried out in accordance with document HD 19/15.

Audit Team Leader

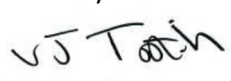
Bill Tootill
BA (Hons), MCIHT, CMILT, MSoRSA, HA Cert Comp
Principal Road Safety Consultant
Signed: 

Date: 17/06/2016

Audit Team Member

Steve Giles
BEng (Hons), IEng, FIHE, MCIHT, MICE, CMILT, MSoRSA, HE Cert Comp
Director, Gateway TSP
Signed: 

Date: 17/06/2016

APPENDIX A
Location Plan

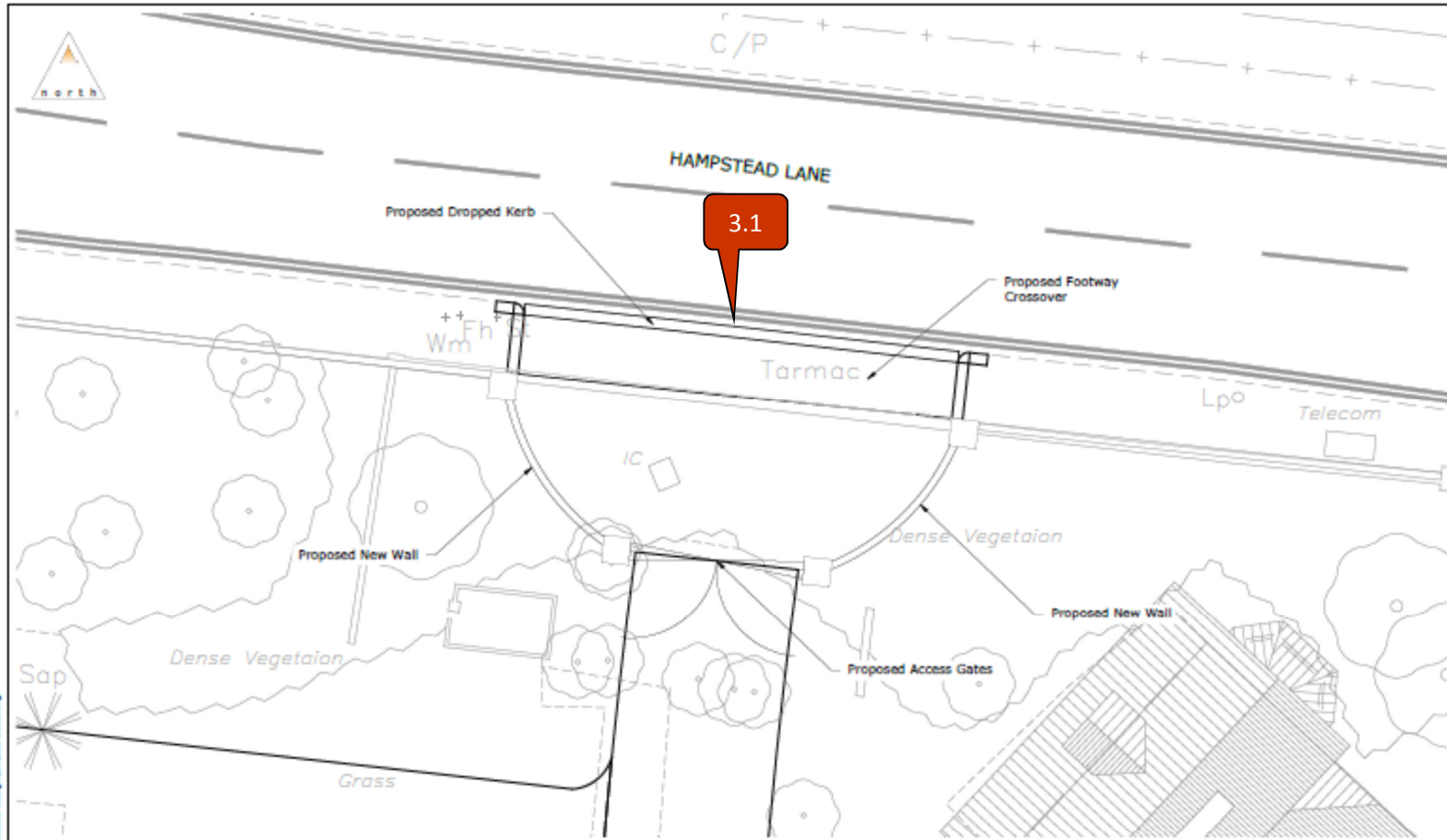

L:\Projects\160202\Drawings\Detailed Design\160202-101a.dwg

© Crown Copyright 2012. All rights reserved. License number 10004067

motion

16 North Street
Colchester
Suffolk
CO1 1JL
T: 0206 751 500

Golden Cross House
8 Deodar Road
London
SW18 7TP
T: 020 755 6141

www.motion.co.uk

Project: Athlone House, Hampstead Lane	
Title: Proposed Access General Arrangement	
Scale: 1:100 (A3)	
Drawn: 160202-101	Revised: A

APPENDIX B
Designer's Response

Project: Athlone House, Hampstead Lane, Highgate
Proposed Access

Client: Motion

Document: Stage 1/2 Road Safety Audit

Gateway TSP ref: WJT/SG/16-0504 RSA1 d1_3

Status: Final

Issue date: 17/06/2016

Item No.	Audit Team Recommendation	Designer's Response
3.1	Ensure that large vehicles (likely to be a small number of servicing vehicles) continue to enter Athlone House via the existing, retained access. The proposed access should present no safety problems for the majority of accessing vehicles.	Large servicing and delivery vehicles will use the existing retained access.
3.2	N/A	
3.3	N/A	
3.4	N/A	
3.5	N/A	

Project: Athlone House, Hampstead Lane, Highgate
Proposed Access
Client: Motion
Document: Stage 1/2 Road Safety Audit
Gateway TSP ref: WJT/SG/16-0504 RSA1 d1_3
Status: Final
Issue date: 17/06/2016

Designer's Statement:

I confirm that I have considered the items that have arisen in the Stage 1 Road Safety Audit Report and my response to its recommendations are set out above.

A handwritten signature in black ink, appearing to read "Peter Sturgeon". The signature is fluid and somewhat abstract, with a long horizontal stroke extending to the right.

Peter Sturgeon

.....
Designer

Date: 21/06/2016

Highway Authority/Project Sponsor/ Client Organisation Statement:

I accept/do not accept the Designer's Response (*delete as appropriate*)

.....
On behalf of Highway Authority/Project Sponsor/Client Organisation
(*delete as appropriate*)

Date:

Appendix H

Swept Path Analysis

L:\Projects\shathl 160202\Drawings\160202-TK05a.dwg

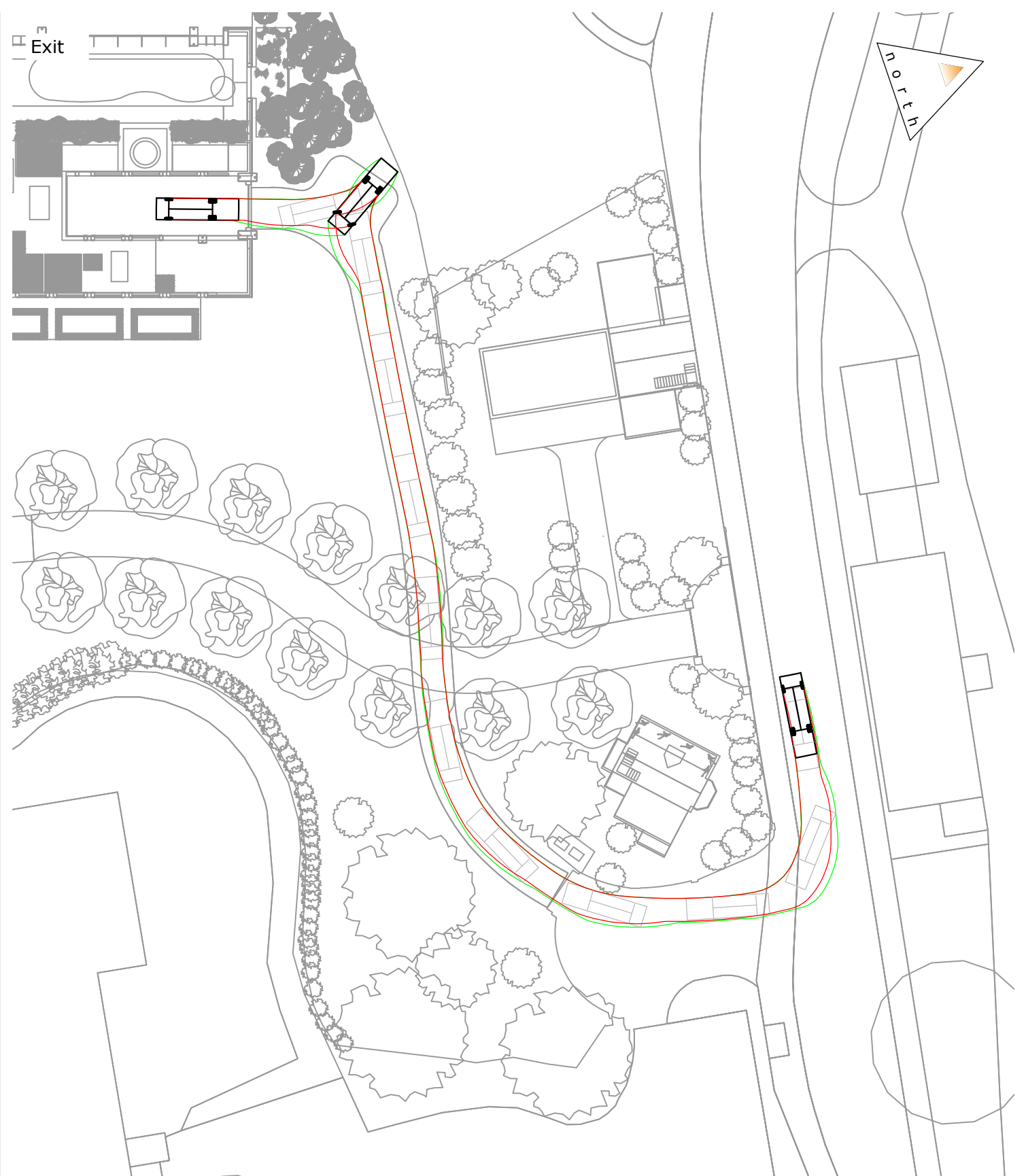
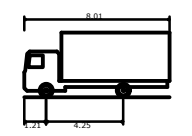
7.5t Box Van
 Overall Length 8.010m
 Overall Width 2.100m
 Overall Body Height 3.536m
 Min Body Ground Clearance 0.351m
 Track Width 2.064m
 Lock-to-lock time 4.00s
 Curb to Curb Turning Radius 7.400m



84 North Street Guildford Surrey GU1 4AU
 T: 01483 531 300

Golden Cross House 8 Duncannon Street London WC2N 4JF
 T: 020 7031 8141

www.motion.co.uk

Project: Athlone House, Hampstead Lane	
Title: Swept Path Analysis 7.5t Box Van	
Scale: 1:500 (@ A3)	
Notes:	Revision: A
Drawing: 160202-TK05	