

NOTES:

Refer to Services Engineer's Drawings and Specifications for full details of Mechanical and Electrical Services. Layouts indicated on drawing is for design intent and setting out purposes only.

Contractor to report to Architect any variations in given dimensions which may deviate from Design Intent. Details and setting out including ceiling heights to be confirmed and agreed post strip out.

Luminaires generally to be set out centrally between internal walls or other boundaries such as existing rooflights, unless otherwise noted.

Suspended lighting conduits to run neatly and aligned in relation to suspended luminaires and to align to the same hung level.

All high-level ductwork and low-level trunking shown indicatively. To run neatly along wall edges and align centrally with downstand beams where applicable.

Fire detector locations to be confirmed with UCL in relation to existing infrastructure.

Setting-out of luminaires, ventilation diffusers, grilles, fan coil units and servicing routes to be co-ordinated at construction.

Existing externally mounted Condenser Units to be retained. Refer to MEP Information.

Existing soffit approx +3115mm. Note areas of downstand-beams in existing ceiling (approx 250mm).

Note lighting integrated within teapoint shelving.

New Fan Cooling Unit to be mounted on wall at high level.

New fittings to be centred around on existing ceiling rose; to be retained and protected.

LIGHTING KEY:

- Suspended Linear Luminaire
- Lighting Infill Panel
- Circular Luminaire
- Wall-Mounted Luminaire
- Emergency Luminaire
- Presence Detector
- Fire Detector & Sounder
- CO₂ Detector

MECHANICAL SERVICES KEY:

- Ventilation Unit

SERVICE ROUTING:

- Suspended Lighting Conduit
- Low Level trunking

Refer to Services Engineer's Information for full details of routing methods.

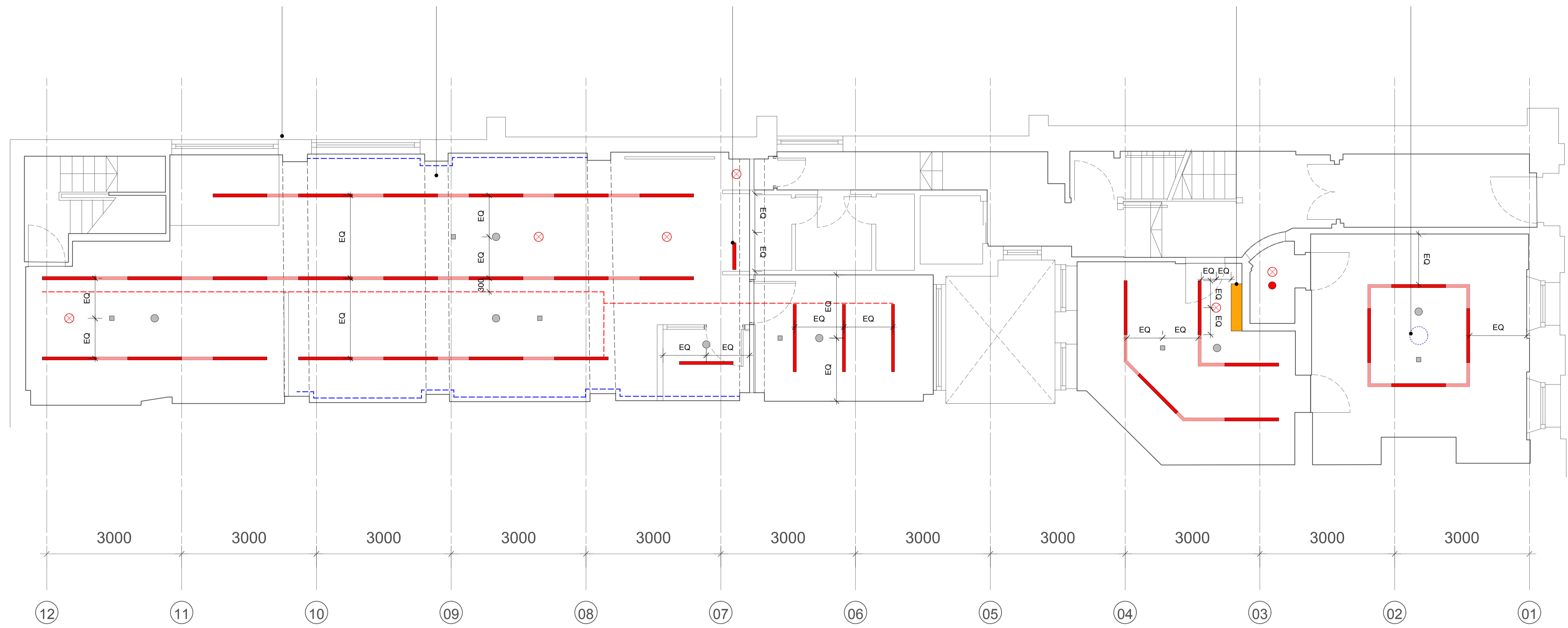

Revisions

1	18/05/2016	Issue For Planning
---	------------	--------------------

Copyright Hawkins Brown Architects LLP

No implied license exists. This drawing should not be used to calculate areas for the purposes of valuation. Do not scale this drawing. All dimensions to be checked on site by the contractor and such dimensions to be their responsibility. All work must comply with relevant British Standards and Building Regulations requirements. Drawing errors and omissions to be reported to the architect.

Scale	1:50 at A1	Date	April 2016
Drawn by	TC	Checked by	EM
Job Number	HB1607	Status	Planning

Project
UCL 7 Queen Square
Institute of Neurology

Drawing
Proposed Ground Floor
Reflected Ceiling Plan

Hawkins\Brown

159 St John Street London EC1V 4QJ 020 7336 8030t mail@hawkinsbrown.com www.hawkinsbrown.com

Drawing No. & Revision
1607_7QS_PL_35_201 P1