



Temporary collective fall protection to be installed around lower area of parapet during works.



Existing, redundant electrical box and connected wiring to be removed. Fixing locations to be made good.

Any work beyond the line of the higher parapet to be planned. Zone to be visibly demarked during works.

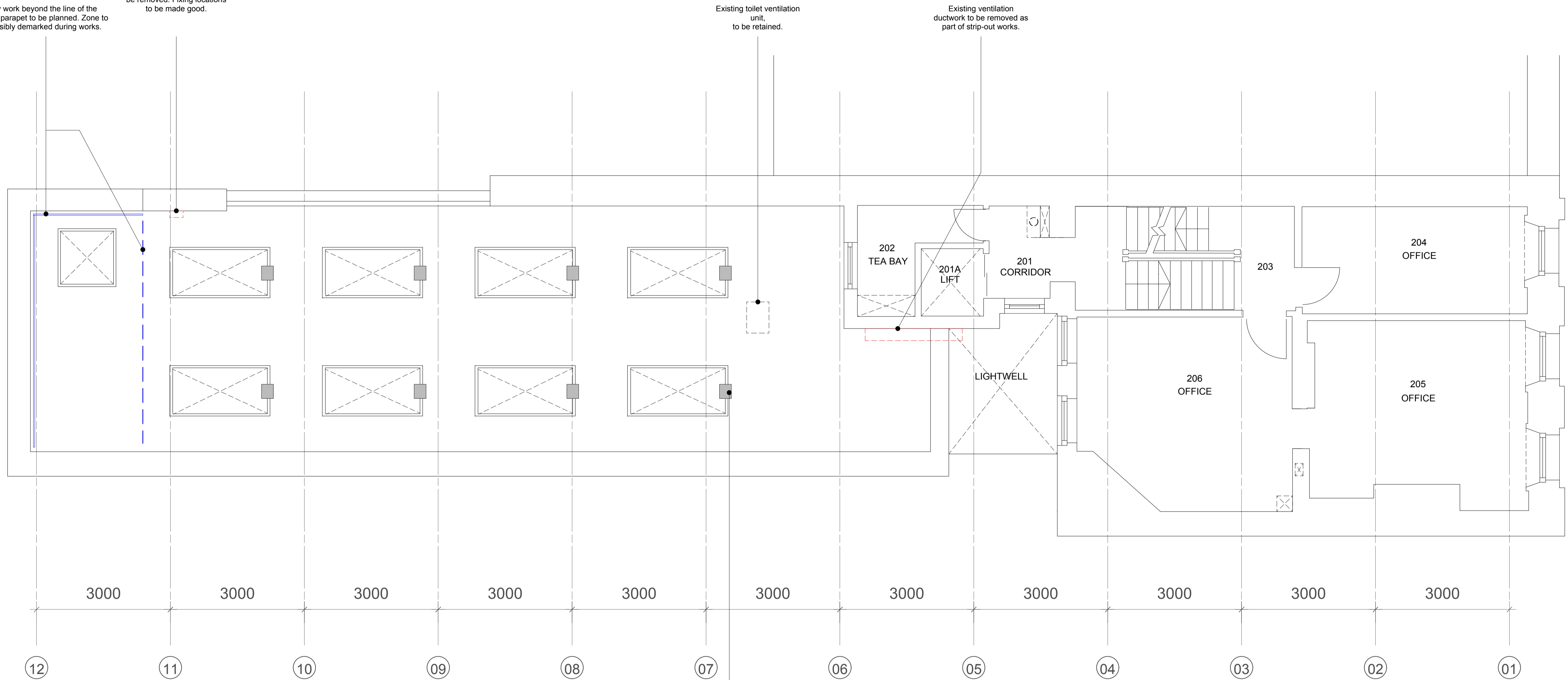

Existing rooflight fans to be replaced.  
Refer to MEP Information.



Revisions		
1	28/04/2016	Issue for Planning

Copyright Hawkins Brown Architects LLP  
No implied license exists. This drawing should not be used to calculate areas for the purposes of valuation. Do not scale this drawing. All dimensions to be checked on site by the contractor and such dimensions to be their responsibility. All work must comply with relevant British Standards and Building Regulations requirements. Drawing errors and omissions to be reported to the architect.

Scale	(1:100 at A3) 1:50 at A1	Date	April 2016
Drawn by	TC	Checked by	EM
Job Number	HB1607	Status	Planning

Project  
UCL 7 Queen Square  
Institute of Neurology  
Drawing  
Second Floor Roof Level  
Proposed

**HawkinsBrown**  
159 St John Street London EC1V 4QJ 020 7336 8030t  
mail@hawkinsbrown.com www.hawkinsbrown.com  
Drawing No. & Revision  
1607\_7QS\_PL\_00\_204 P1