

Walls and ceiling within stairwell to be repaired. Make good all holes and redecorate.

Contractor to check and overhaul existing primary and secondary glazing, to ensure in good working order.

Interior veneered timber door with glazed side screen including interstitial blind.

Interior veneered timber door with vision panel.

New Teapoint.

Contractor to check and overhaul existing penetrations and alterations to original bricks walls within lightwell.

Existing holes to be removed and made good where possible. New holes to be minimised and made good.

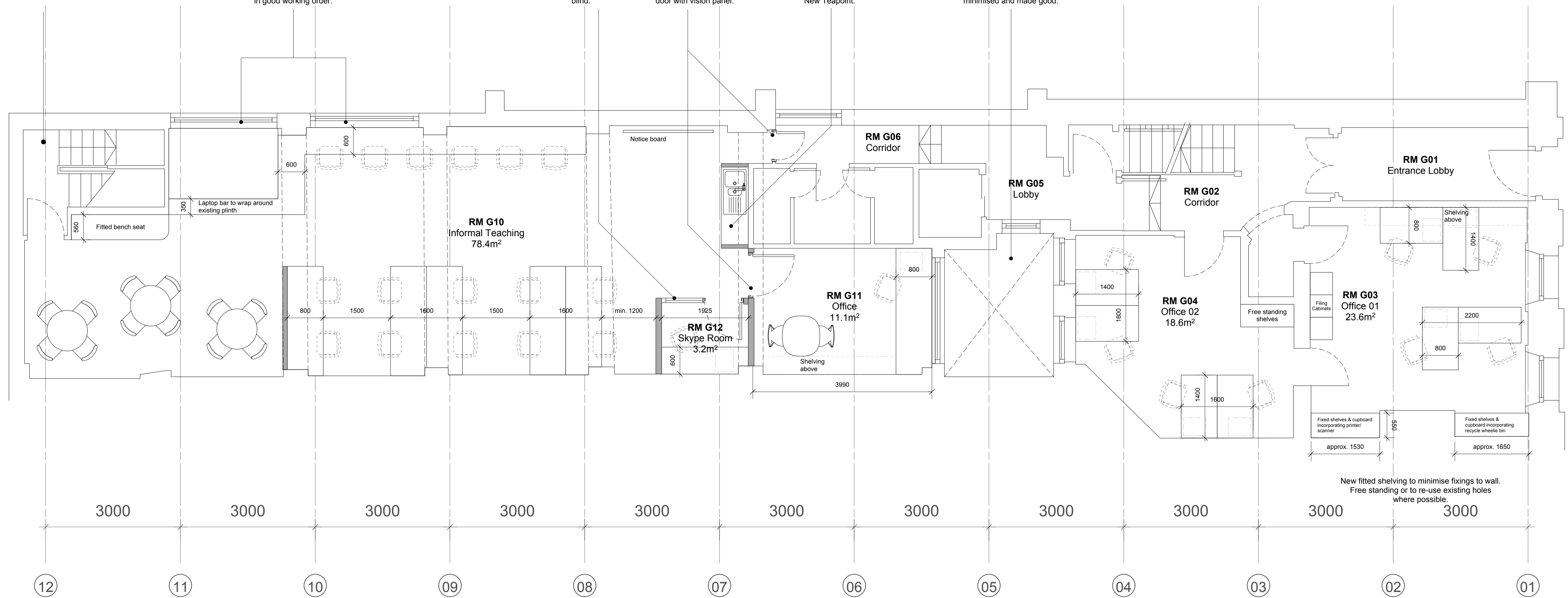

New fitted shelving to minimise fixings to wall. Free standing or to re-use existing holes where possible.

Revisions		
1	28/04/2016	Issue For Planning

Copyright Hawkins Brown Architects LLP

No implied license exists. This drawing should not be used to calculate areas for the purposes of valuation. Do not scale this drawing. All dimensions to be checked on site by the contractor and such dimensions to be their responsibility. All work must comply with relevant British Standards and Building Regulations requirements. Drawing errors and omissions to be reported to the architect.

Scale	(1:100 at A3)	Date	April 2016
1:50 at A1		Checked by	EM
Drawn by	TC	Status	Planning
Job Number	HB1607		

Project
UCL 7 Queen Square
Institute of Neurology

Drawing
Ground Floor General Layout
Proposed

HawkinsBrown

159 St John Street
London
EC1V 4QJ
020 7336 8030t

mail@hawkinsbrown.com
www.hawkinsbrown.com

Drawing No. & Revision
1607_7QS_PL_00_201 P1