

This drawing is protected under Copyright and at no time must any portion of this drawing be reproduced or copied in anyway without the permission of Morgan Lovell.
All dimensions must be checked on site and NOT scaled from this drawing.

SUBJECT TO SITE SURVEY
CHECK SURVEY UNDERTAKEN ONLY
BUILDING PARAMETERS TAKEN FROM DRAWINGS PROVIDED
BUILDING PARAMETERS TAKEN FROM AS BUILT DRAWINGS PROVIDED

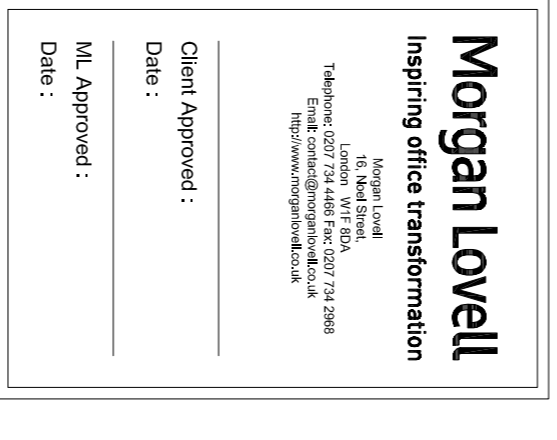

Rev	Revision	By	Date
8	ACCESS CONTROL AND GROUND UNIT ADDED TO ELEVATION	CP	27.05.16
A	AREA MATCHED & UPDATED	CP	22.04.16
	FIRST ISSUE	CP	23.03.16

CONSTRUCTION

Morgan Lovell

16 Neal Street London, W1F 8DA
Tel: 0207 734 4466 Fax: 0207 734 2988 E: contact@morganlovell.com
W: <http://www.morganlovell.com>

Client
The Alan Turing Institute

Project
The British Library
96 Euston Road
London
NW1 2DB

Title
First Floor
Joinery Item 14

Scale
1:20 @ A1
Designer/Drawn By
ASD/CP
Checked By / Date
TC

Project No.	Floor	Drawing No.	Rev
ML2061	01	608	B

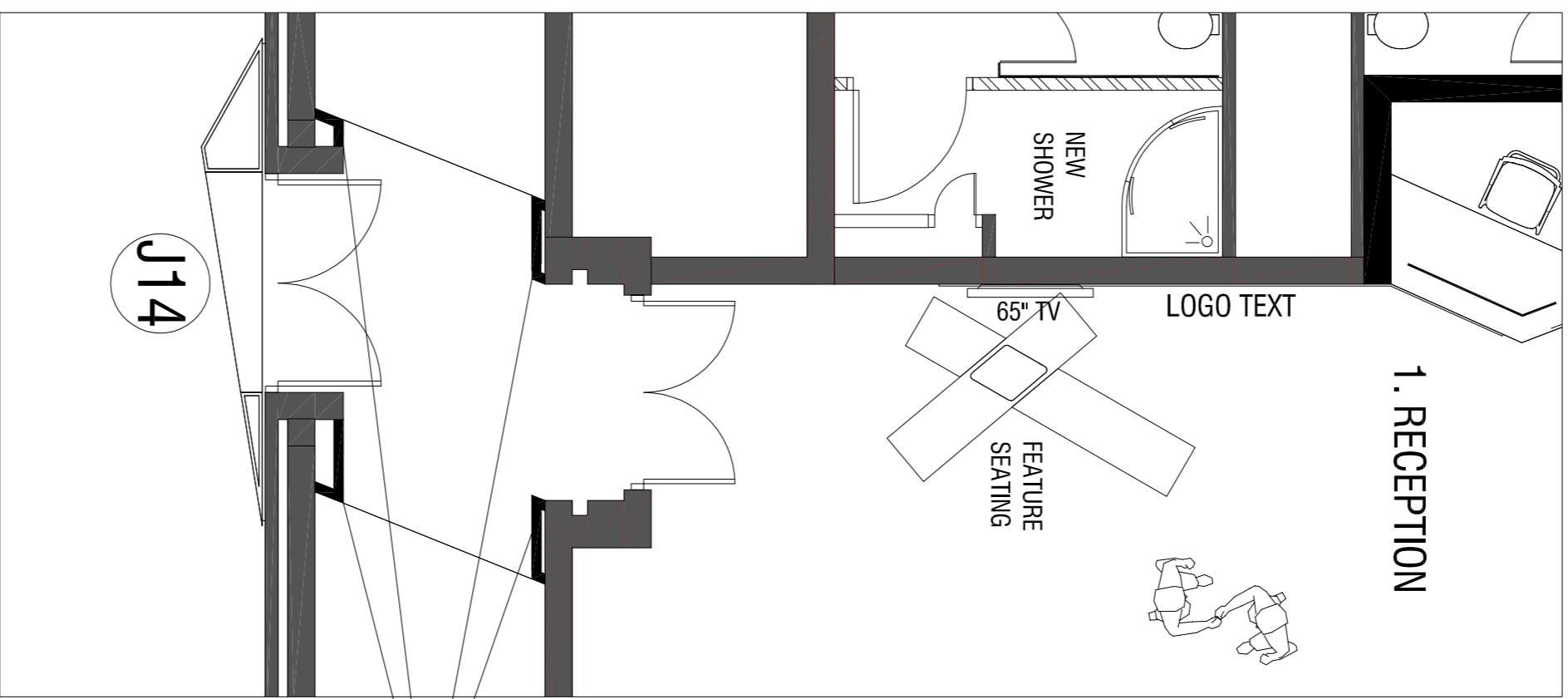
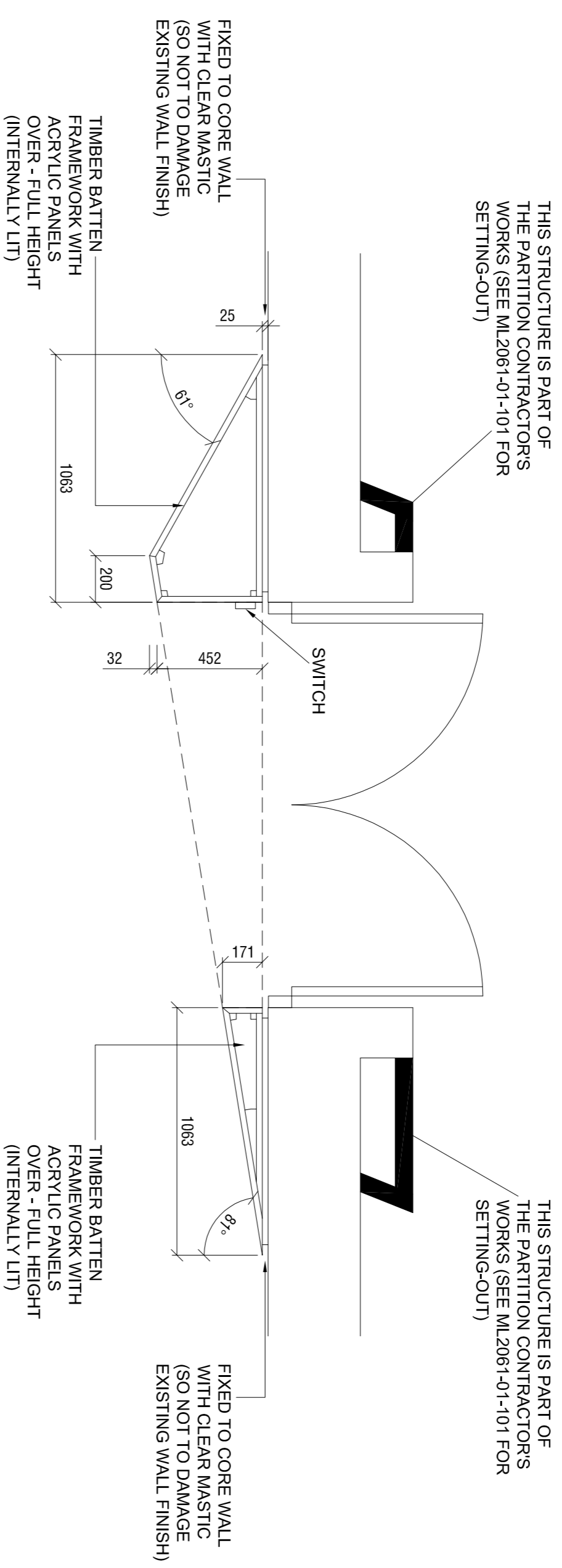

DETAIL LOCATION PLAN
Scale 1:50

THIS STRUCTURE IS PART OF THE PARTITION CONTRACTORS WORKS (SEE ML2061-01-101 FOR SETTING-OUT)

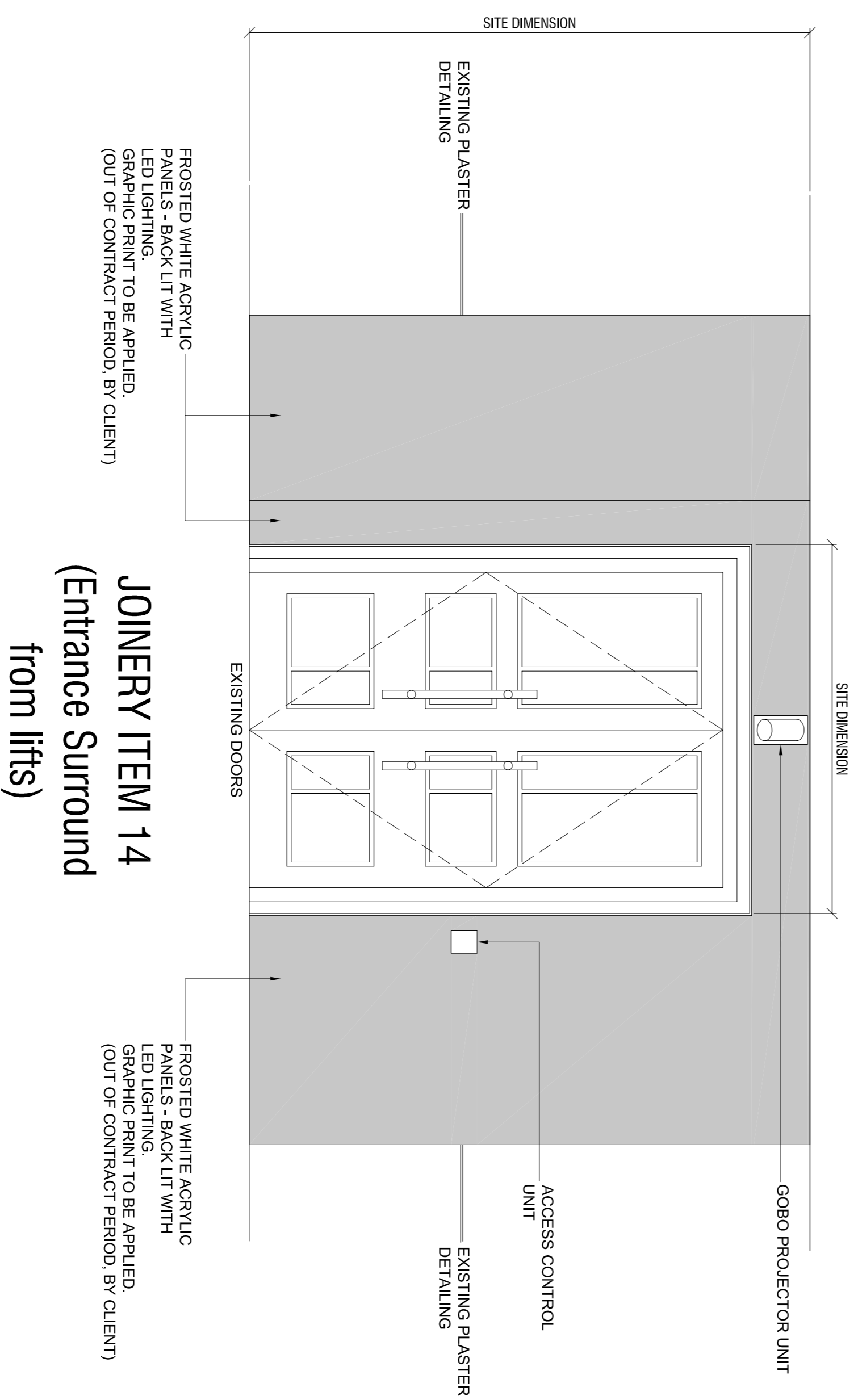

JOINERY ITEM 14
(Entrance Surround from lifts)

THIS STRUCTURE IS PART OF THE PARTITION CONTRACTORS WORKS (SEE ML2061-01-101 FOR SETTING-OUT)