

Secant Pile Wall Elevation A

Secant Pile Wall Elevation B

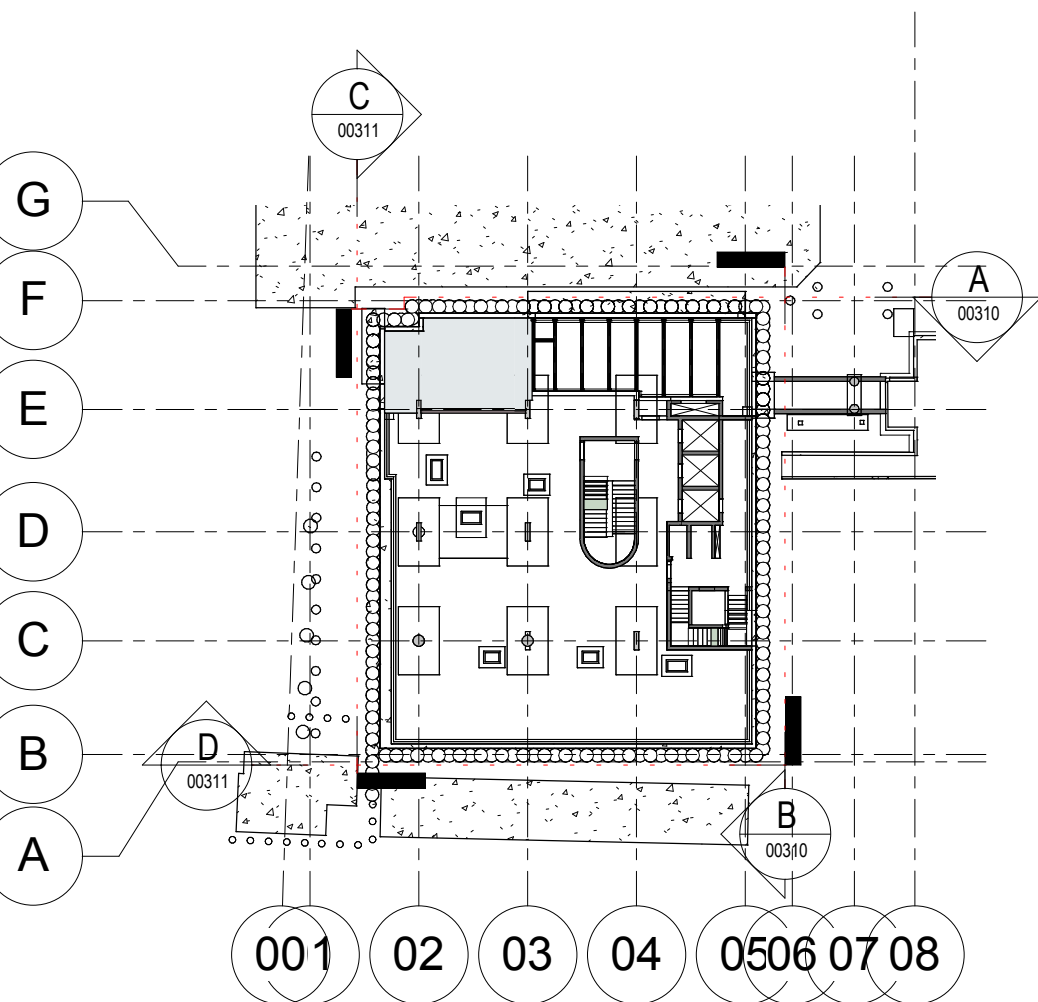

Key Plan - Secant Pile Wall Elevations

NOTES:

1. This drawing is to be read in conjunction with all relevant Architects and Engineers drawings, details and specifications.
2. Do not scale this drawing. All details and dimensions are to be checked by the contractor and fabricator onsite prior to commencement of construction/fabrication. Any discrepancies are to be reported to the Engineer. Any existing dimensions noted on this drawing are to be checked by the contractor prior to commencement of works.
3. Any ambiguities, omissions and errors on the drawings, shall be brought to the Engineers attention immediately.
4. All dimensions are in millimetres unless noted otherwise.
5. All works to be carried out in accordance with the relevant British Standards, Codes of Practice and Building Practice.
6. Contractor to ascertain the location of all services on site prior to starting any excavations works and report and potential problems immediately.

P02	CAPPING BEAM LEVELS REVISED	04/12/15	AL	SS
P01	PRELIMINARY TENDER ISSUE	09/11/15	AL	SS
Rev:	Description:	Date:	By:	Chkd:

**curtins consulting**

Curtins Consulting Ltd  
40 Compton Street, London, EC1V 0BD  
t: 020 7324 2240 f: 020 7324 2241  
e: london@curtins.com www.curtins.com

Structures • Civils • Environmental • Infrastructure • Urban Regeneration • Health & Safety • Dispute Resolution  
Birmingham • Bristol • Cardiff • Douglas • Edinburgh • Kendal • Leeds • Liverpool • London • Manchester • Nottingham

Status: STAGE 4A ISSUE

Project: UCL - NEW STUDENT CENTRE

Drg Title: SECANT PILE WALL ELEVATIONS SHEET 1 OF 2

Scale:	Size:	First Issue:	Drawn:	Checked:
As indicated	A1	14/05/2015	AL	SS

Drg No:	Rev:
031- 51- 0200- DR- S- 00310- ZZ	P02