

All dimensions are shown in millimetres unless otherwise stated.

Approval _____
 Date _____
 Status **A** - _____
 B _____
 C _____

For material description refer to drawing FA-A-099

Revisions	Date	By
01 Updated	22.04.16	LHA
--	--	--
--	--	--
--	--	--

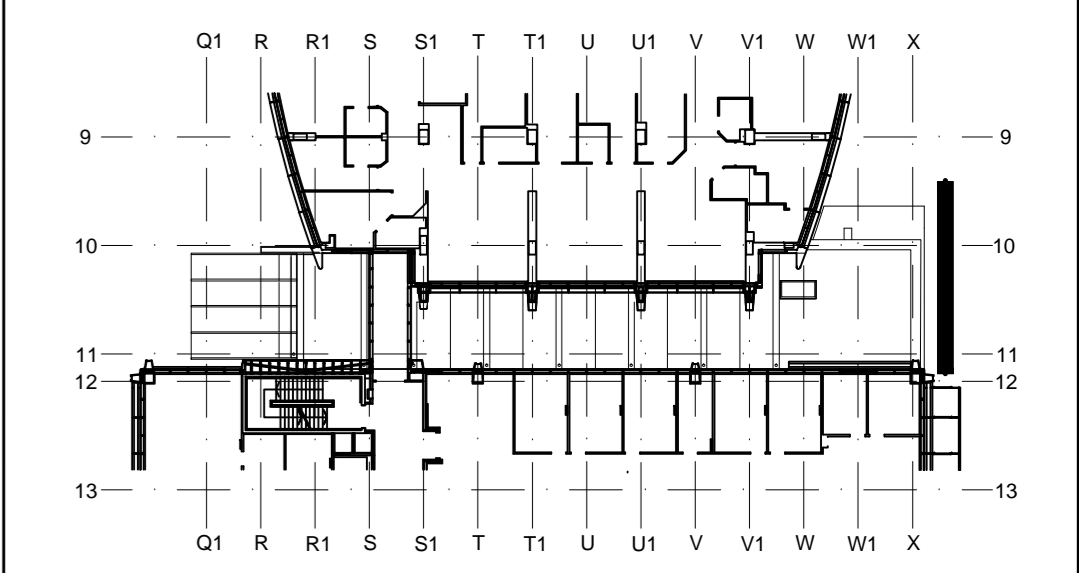

Key Plan.

Client

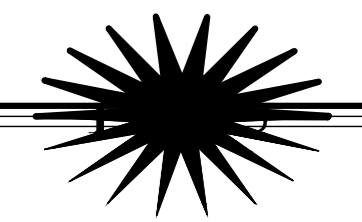

HEALTH MANAGEMENT (UCLH) plc

Architect

PM DEVEREUX
 200 Upper Richmond Road
 London, SW15 2SH

Contractor

FAHRNI façade systems
 Fahrni AG
 Bernstrasse 84
 CH-3250 Lyss
 Tel: +41(0)32 387 2525
 Fax: +41(0)32 387 2521

Job Title
 University College London Hospitals
 A&E Redevelopment
 Infill (Phase VI)

Drawing Title
 Elevation
 Gower Street
 East

North Drawing Status
 FOR APPROVAL

File	FA-A-001+.dwg	Scale	1:20@A0
Date	14.03.16	Drawn	LHA
Job Number Fahrni	22-13505	Checked	CSP
Job Number Client		Drawing Number	FA-A-001
		Revision	01

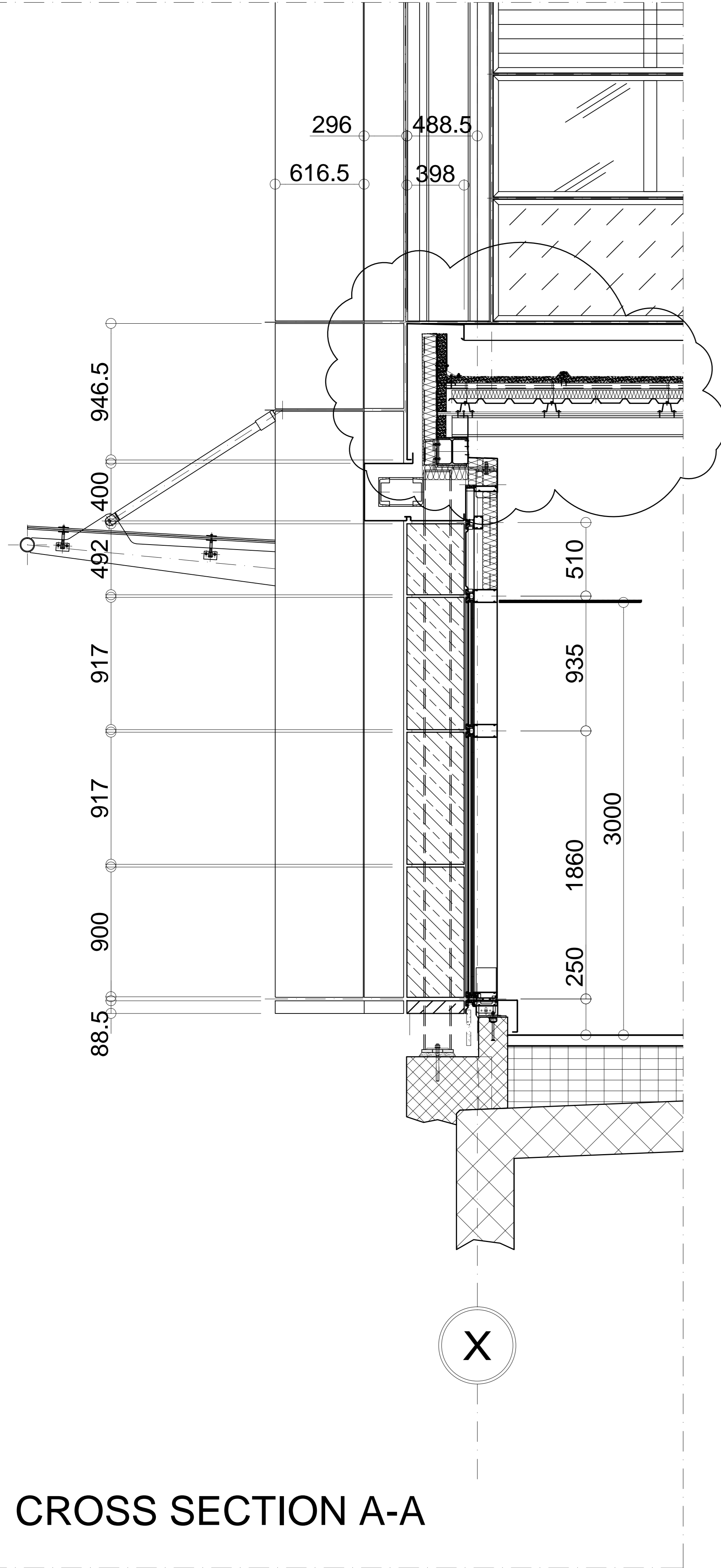

CROSS SECTION A-A

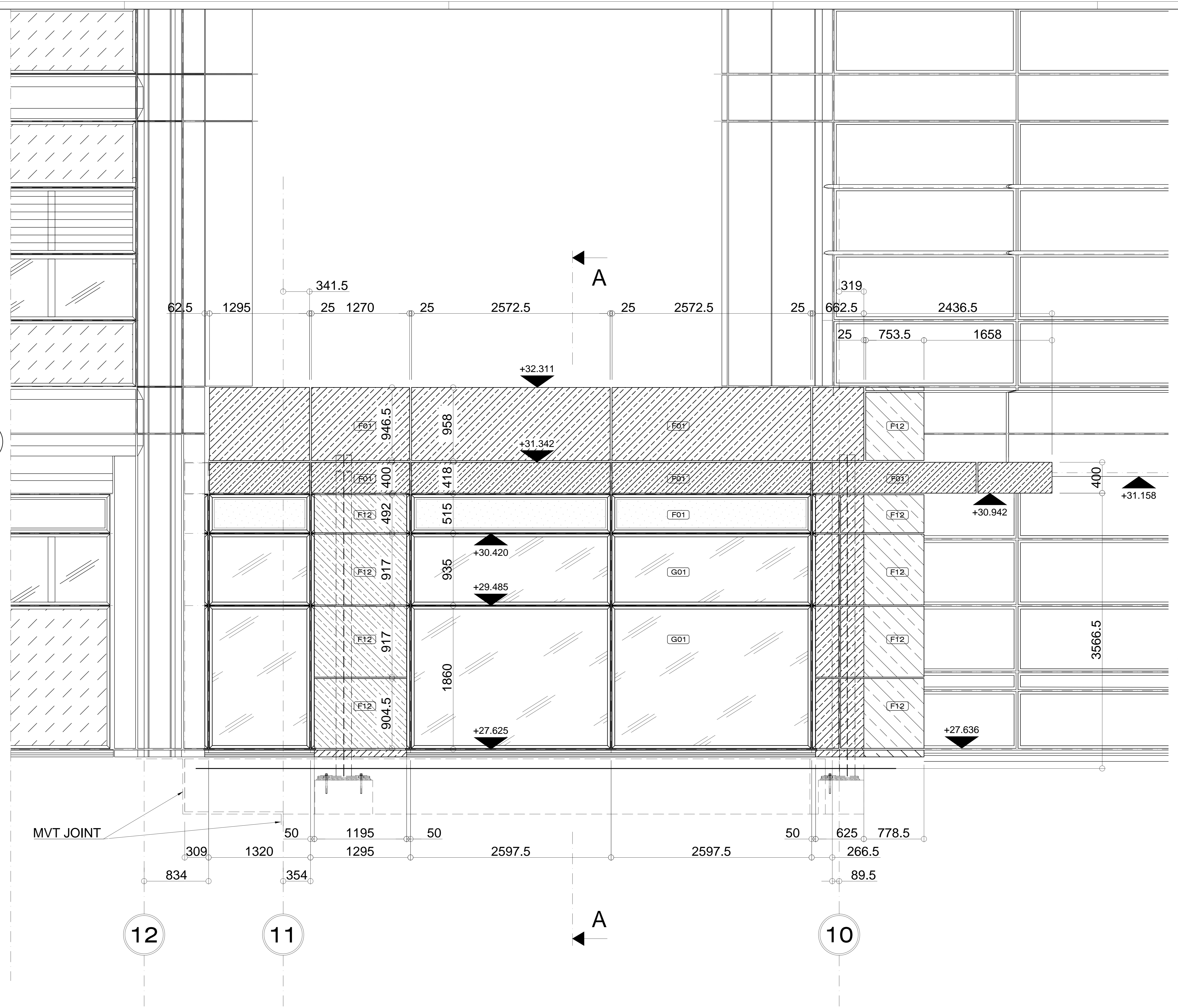

ELEVATION- GOWER STREET - EAST - FA-A-001