

## MATERIALS

M00	Not in Fahrni work package / by others
M01	Extrusions for Profiles ALLOY 6063/T6
M02	Extrusions for Brackets ALLOY 6005/T6
M03	Extrusions for Tubes, Angles and Plates ALLOY 6060/T5-T6
M04	Aluminium Sheet 1.0mm
M05	Aluminium Sheet 2.0mm
M06	Aluminium Sheet 3.0mm
M07	Steel Sheet - Galvanized 1.5mm
M08	Steel Sheet - Galvanized 2.0mm
M09	Steel S 275 JR
M10	Stainless Steel AISI 304
M11	Stainless steel AISI 316
M12	Spacer - closed-cell rigid plastic - "Forex-classic" - 19mm - (Datasheet O&M)
M13	Mineralwool Insulation 80Kg/m3 - (Datasheet O&M)
M14	Rockwool "SP Firestop 120" - (Datasheet O&M)
M15	Cast-in Channel Jordahl (Stainless Steel AISI 316 - 1.4571-)
M16	Stainless Steel AISI 304 - Fixings or Anchors
M17	Stainless Steel AISI 316 - Fixings or Anchors
M18	Aluminium - Fixings or Anchors
M19	Waterproofing Sealant - DOW 797 Black - (Datasheet O&M)
M20	Polyethylene Foil 0.5mm.
M21	Waterproofing Membrane 1.2mm - Synthetic Rubber-
M22	Air and Water Seal - one part sealant - Gyso 444 - (Datasheet O&M)
M23	Backing Rod for Silicone Sealing - Polyethylene closed cells -
M24	Structural Sealing - two part silicone - DOW 993 Black - Factory use - (Datasheet O&M)
M25	Gasket for Air and Water Sealing - EPDM extrusion colour black - 71±5 Shore "A"
M26	-
M27	Gasket for Air Sealing - EPDM extrusion colour white RAL 9010 - 71±5 Shore "A"
M28	Glass setting-block - Silicone profile - hardness 71±5 Shore "A"
M29	Polyurethane Cellular Foam, mono adhesive - Compriband 600 - (Datasheet O&M)
M30	Backing for Structural Silicone Sealing - Norton V2100 Black - (Datasheet O&M)
M31	Polyethylene Plate - P.E. -
M32	Extrusions for brackets support ALLOY 6082/T6
M33	Stainless Steel AISI 304 / Nylon Anchors (External use)
M34	Aluminium Insect Screening Mesh.
M35	Extruded Polystyrene Insulation (XPS)

## MATERIALS

M36	Steel Sheet - Galvanized 3.0mm
M37	Steel Sheet - Galvanized 4.0mm
M38	Viscoelastic Damping Material - 5.1mm - Teroform - (Datasheet O&M)
M39	Aluminium Sheet 1.5mm
M40	Cavity Filler Epoxy Mortar - "Sikadur -31 Rapid" - (Datasheet O&M)
M41	Aluminium Sheet 5.0mm
M42	Double Coated Polyethylene Foam Tape - Gyso Mount 1400 - (Datasheet O&M)
M43	Aluminium Sheet 6mm
M44	Galvanized Steel Fixings or Anchors
M45	Mineralwool Insulation 23Kg/m3 - (Datasheet O&M)
M46	Aluminium Sheet 4.0mm
M47	Delrin POM Acetal Plastic
M48	Butyl Foil Tape - Gyso V738 100mm - (Datasheet O&M)
M49	Spacer - closed-cell rigid plastic - "Forex-classic" - 6mm - (Datasheet O&M)
M50	Waterproofing Sealant - DOW 797 clear (for canopy) - (Datasheet O&M)
M51	Bird Protection Stainless Steel - width 8mm (TBC)

## GLASS TYPES

G01	Double glazed unit vision 34mm Outer pane: 6.0mm - "Parsol Green", fully toughened, heat soaked tested. Cavity: 16mm - Air filled - Natural anodized glass spacer (silver). Inner pane: 12mm - float clear glass, fully toughened, heat soaked tested.
G02	-
G03	Single glass 6.0mm - "Parsol Green", fully toughened, heat soaked tested - with Emalit EW19-WW on face 2 -
G04	Laminated safety glass 21.5mm "canopy" Upper pane: 10mm - float "Parsol Green", heat strengthened (TVG). PVB layers 1.52mm Lower pane: 10mm - clear glass, heat strengthened (TVG).
G05	-
G06	Outer pane: 6.0mm - float "Parsol green", fully toughened, heat soaked tested. Cavity: 12mm- Air filled - Natural anodized glass spacer (silver). Inner pane: 6.0mm - float clear, fully toughened, heat soaked tested.

## FINISHES

F00	No finish, natural, mill finish
F01	PPC White: Drylac Serie 58, Colour "Reference 29/90153, Shine 800" - (Datasheet OM)
F02	-
F03	Natural Anodized C-0 (10microns)
F04	2 coats zinc rich paint (80microns) "Polyamol Duo-Zinc" -Factory- 1 coat primer (75 microns) "Polyamol Primer" -Factory- 2 coats Polyurethane paint (50 microns) "Kabedur 2M7979" -Site-
F05	Hot dip Galvanized, 610gr/sq.m, 85 microns
F06	Anti-drumming layer
F07	Hot dip Galvanized, 610gr/sq.m, 85 microns 1 coat primer (75 microns) "Polyamol Duo-Zinc" -Factory- 2 coats Polyurethane paint (50 microns) "Kabedur 2M7979" -Factory-
F08	Black Anodized C-35 (5-20microns)
F09	-
F10	PPC RAL9011 Black - 80% Gloss - IGP-HWF-3001 -
F11	PPC RAL9003 White - Metallic Finish - DOOR -
F12	PPC RAL3001 Signaired - TBC -

# MATERIAL MAIN INDEX FA-A-099

For product data refer to O&M Manual

All dimensions are shown in millimetres unless otherwise stated.

Approval \_\_\_\_\_

Date \_\_\_\_\_

Status **A** - \_\_\_\_\_

**B** \_\_\_\_\_

**C** \_\_\_\_\_

Revisions	Date	By
01 Spandrel Glass G03 added	21.04.16	LHA
--	--	--
--	--	--
--	--	--
--	--	--

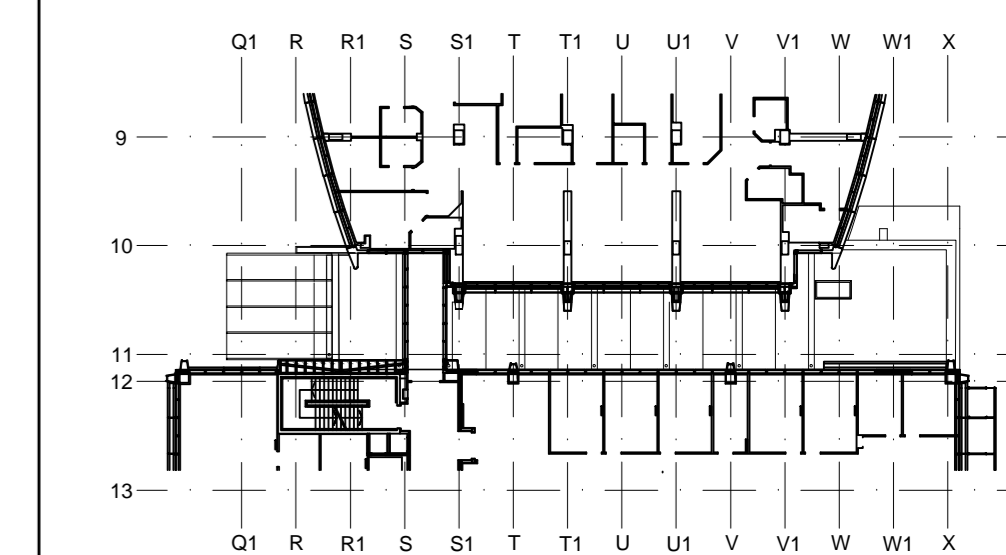

Key Plan.

Client

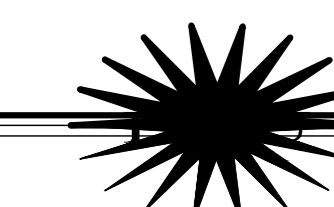

HEALTH MANAGEMENT (UCLH) plc

Architect

**PM DEVEREUX**  
200 Upper Richmond Road  
London, SW15 2SH

Contractor

**FAHRNI** façade systems  
Fahrni AG  
Bernstrasse 84  
CH-3250 Lyss  
Tel: +41(0)32 387 2525  
Fax: +41(0)32 387 2521

Job Title  
**University College London Hospitals  
A&E Redevelopment  
Infill (Phase VI)**

Drawing Title

**MATERIAL MAIN INDEX**  
Description

North		Drawing Status FOR APPROVAL	Scale ___@A0
File	FA-A-099.dwg	Date	13.01.16
Date	13.01.16	Drawn	CSP
Checked	LHA	Job Number Fahrni	22-13505
Job Number Client	FA-A-099	Drawing Number	22-13505
Revision	01	Job Number Client	-