

**Maria Fidelis Catholic School
Phoenix Road/Drummond Crescent
Camden
NW1 1TA**



STATEMENT OF COMMUNITY INVOLVEMENT

tp bennett

for

Kier Construction

June 2016

1 Introduction and background

- 1.1 This Statement of Community Involvement is submitted in support of a planning application made by Kier Construction Limited on behalf of the EFA for the following proposal:

Demolition of existing school buildings and erection of new 5FE secondary school (1,050 pupils including 300 16+) with associated landscaping, multi-use games area (MUGA), cycle parking and servicing.

- 1.2 The existing Maria Fidelis Catholic School FCJ (MFCS) operates on two sites – the lower school at North Gower Street, the upper school at Phoenix Road. The former is directly affected by the High Speed 2 (HS2) proposals and the school is to be amalgamated on its Phoenix Road site. The adjoining site of the former Metropolitan Police garages on Drummond Crescent is being acquired to enable the school to be accommodated. The school's total roll across the two sites is currently in the region of 700 pupils; the new school will be 5FE for years 7-11 (750 pupils) with a further 300 in post-16 education – a total of 1,050.

2 Public consultation

2.1 A public exhibition was held in the School Hall on 18 (3.30-7pm) and 21 (10am-12.30pm) November 2015.

2.2 A leaflet (see Appendix 1) was delivered to 2,000 local residents (see map at Appendix 2). The exhibition boards are reproduced in Appendix 3. The photographs below show local residents attending the exhibition. Leaflets were also displayed at the Somers Town Community Association in Ossulston St.



2.3 Fewer than 20 people attended the exhibition, including several teachers from the school and a local councillor. Five visitor questionnaires were completed.

2.4 The following issues were raised in the questionnaires:

- Clarendon Grove should be incorporated into the school
- Clarendon Grove should be retained and improved (eg straighten the line to enable views through, CCTV and better lighting)
- Maintain pupil entrance on Phoenix Road
- Want community access to the sports and other facilities
- Impacts of construction noise and dust
- Support for new school on single site
- Concern about loss of existing buildings

2.5 Residents' concerns, as summarised above, are all addressed in the submitted planning application documentation.

3 Other local engagement

3.1 A meeting was also held on 14 October 2015 with the Somers Town Project Officer at LB Camden, Jane Debono, to discuss how the school proposals fitted with the imminent Central Somers Town proposals (community hub, housing, new primary school buildings). It was thought the key issues for local residents would be:

- The fact that the school serves a much wider area than the local community
- Impact of construction – one of many nearby major projects (Francis Crick Institute, HS2, Somers Town, 42 Phoenix Road etc)
- Loss of locally listed buildings
- quality of design
- How will the scheme improve the public realm, including Clarendon Grove and the junction of Church Walk/Doric Way/Drummond Crescent

3.2 On Jane Debono's recommendation, a meeting was subsequently held with Sarah Elie from the Neighbourhood Planning Forum; she is also Executive Director of the Somers Town Community Association and the meeting was held at the community centre on Ossulston St. Sarah reiterated that local residents were concerned with the number of major developments in the area and the construction management plan details would be important to get right. The MFCS proposals were understood but did not serve the local community. She also thought that there would be concern about the loss of the locally listed buildings. There was a plan to attend the January NPF meeting, though this did not take place.

LEAFLET for NOVEMBER 2015 CONSULTATION



Public Consultation Meeting for the new

Maria Fidelis CATHOLIC SCHOOL F C J



Wednesday 18th November @ 3.30pm to 7pm in the School Hall

And

Saturday 21st @ 10.00am to 12.30 pm in the School Hall

Maria Fidelis Convent School, Upper School, Phoenix Road, Camden, NW1 1TA

Maria Fidelis Catholic School, Camden, is sponsored by the Education Funding Agency and LB Camden



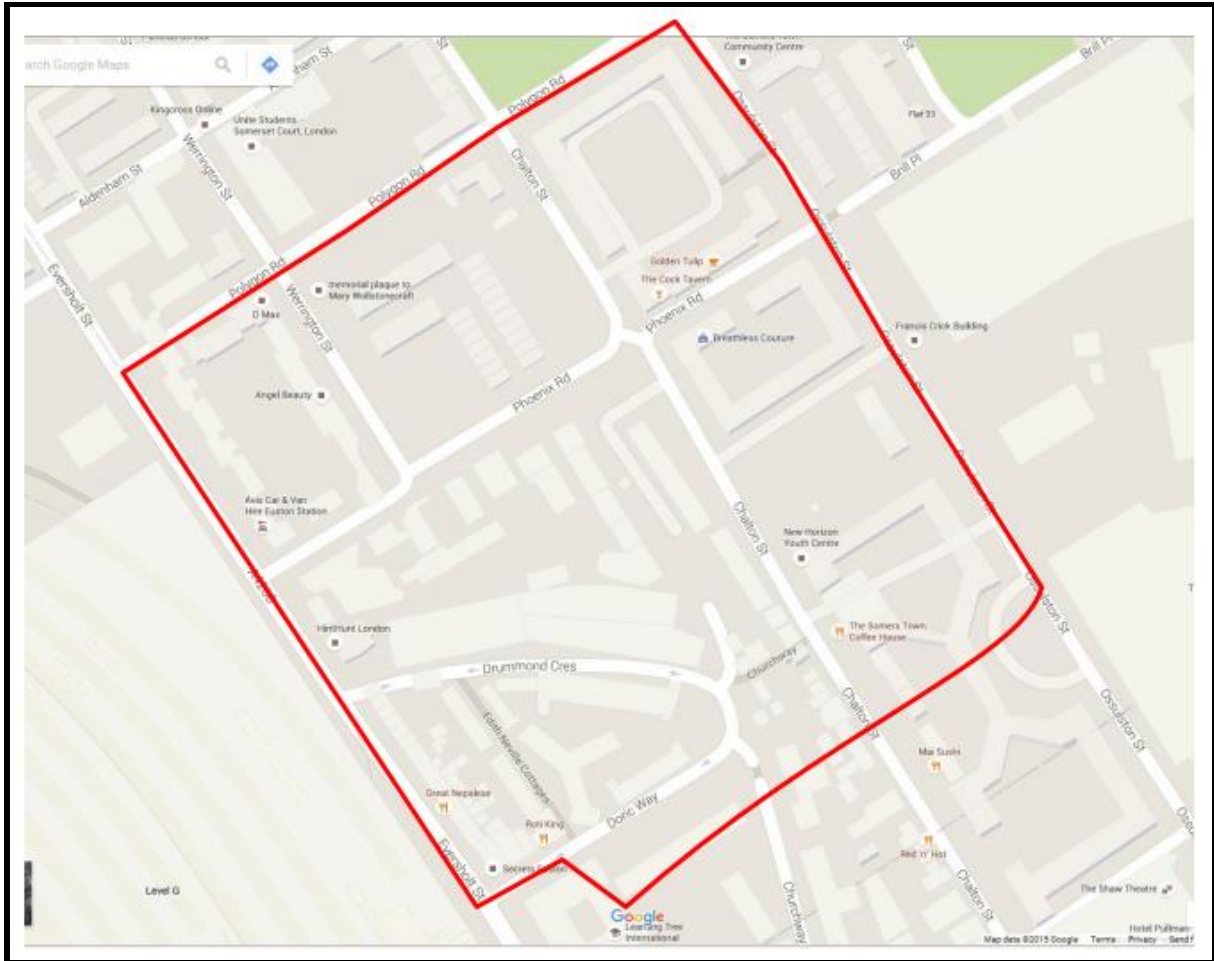



APPENDIX 3: EXHIBITION BOARDS



Site Analysis



Site Analysis - Surrounding Infrastructure



Site Analysis - Buildings to be Demolished

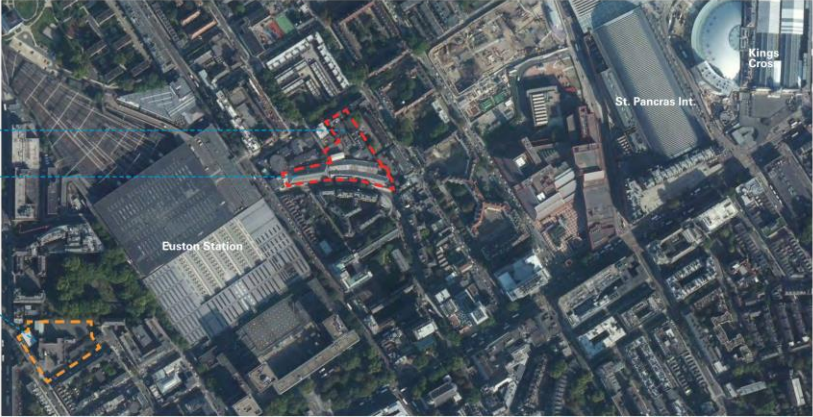



Maria Fidelis (Upper School)

Maria Fidelis (Ex. Metropolitan Police Garages)

Maria Fidelis (Junior School)

Introduction and Site Analysis









1. Phoenix Rd from West



2. Phoenix Rd from East



3. Drummond Crescent from Church Way



4. Drummond Cr.



5. Clarendon Grove

Existing Site





Proposed Site Masterplan

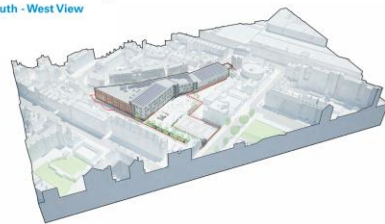
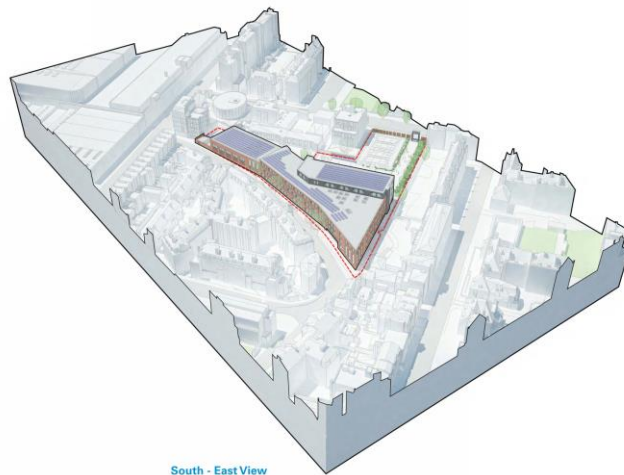

Proposed Massing and Community Use



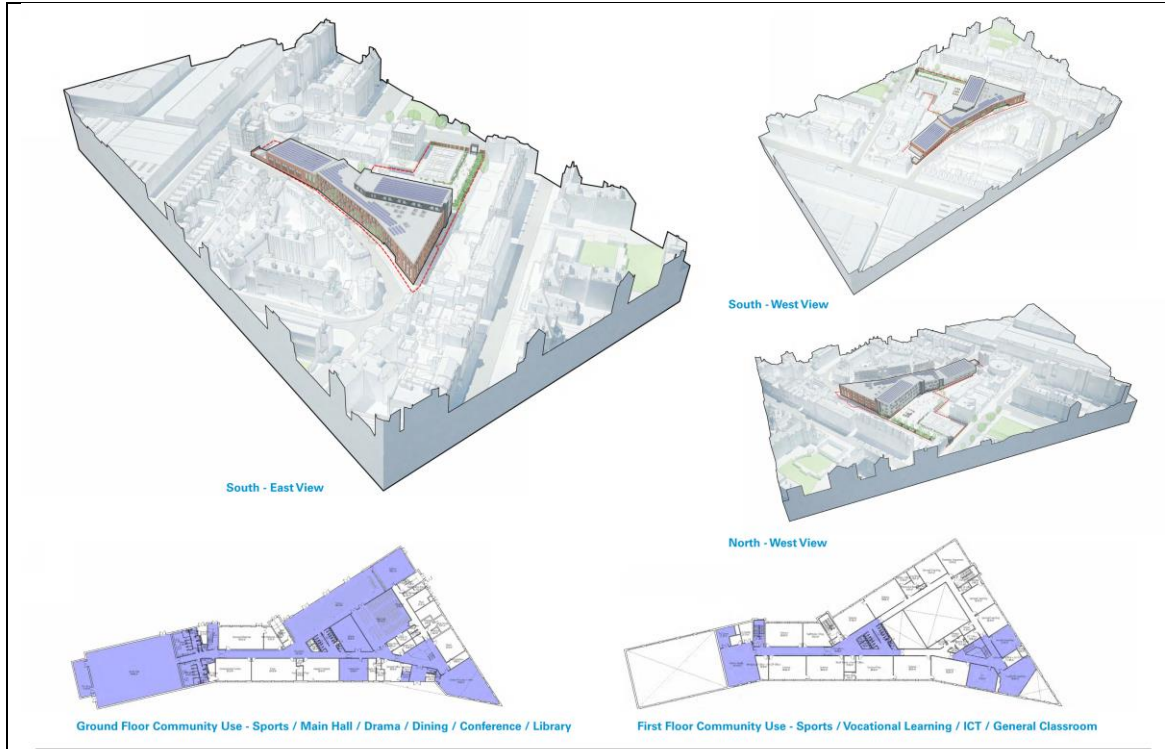

Proposed Massing and Community Use



Drummond Crescent / Clarendon Grove View



View along Phoenix Road from the East



Phoenix Road Boundary and playground areas



Main/Visitor Entrance View



View along Drummond Crescent from Eversholt Street

Proposed Views





South Elevation



North Elevation



East Elevation



West Elevation

Proposed Elevations



Red Multi Facing Brickwork references the existing Drummond Crescent Garage Buildings



Proposed Red Multi Facing Brickwork



Detailed Elevation Bays: Main/Visitor Entrance View, Dance Studio and Library



Examples of brick detailing - Cardinal Pole CS



Examples of dark grey and light grey render

Proposed Materials and Brickwork Detailing



