

William Ellis School main entrance to remain in use throughout the works. Contractor to liaise with school and advise of any potential disruptions.

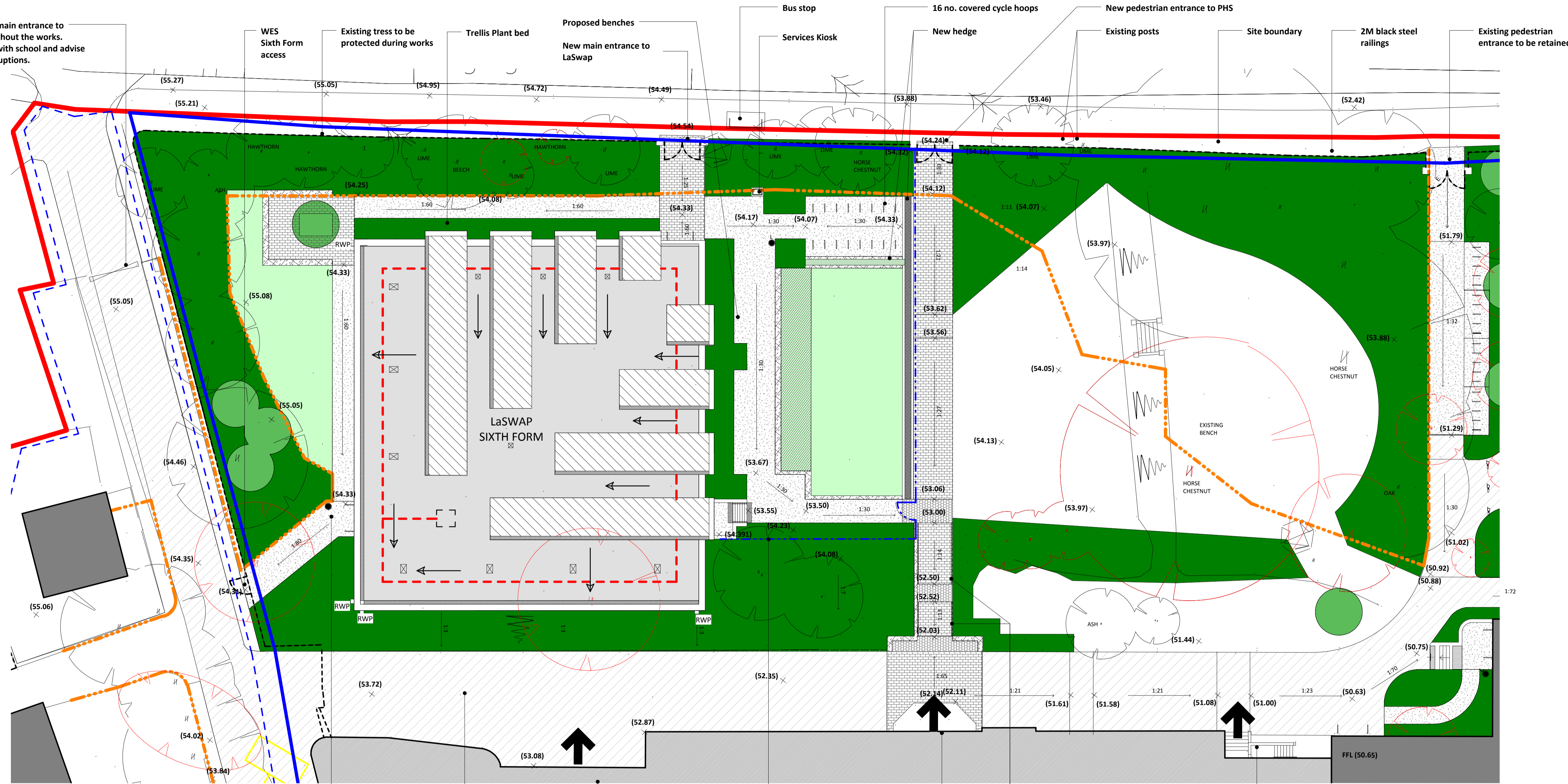

Do not scale from this drawing for construction or acquisition purposes. Responsibility is not accepted for errors made by others in scaling from this drawing. All construction information must be taken from figured dimensions only. All dimensions and levels must be checked on site and discrepancies between drawings and specification must be reported to GSSArchitecture. © Copyright GSSArchitecture

Ordnance Survey © Crown Copyright 2015. All rights reserved. Licence number GSS 100017356.

Map Data Copyright 2015 Google.

Rev.	Date	Drawn	Check	Description
E	15/06/16	FS	BFLA	Roof Plan Added
D	11/05/16	FS	BFLA	Fulcrum kiosk & Plant room's step added
C	29/04/16	FS	BFLA	Trellis plant bed & ramp to plant room added
B	04/04/16	LPMCJ	BFLA	Felled trees identified. Further amendments made to block paving as clouded. Key amended as clouded.
A	23/03/16	FS	BFLA	Block paving added as clouded. Key amended as clouded.

GSSarchitecture

35 HEADLANDS, KETTERING, NORTHANTS, NN15 7ES
 Telephone: 01536 513 165, Fax: 01536 410 226
 Email: gss@gotch.co.uk, Web: www.gssarchitecture.com

Gloucester: 01452 525 019, Harrogate: 01423 815 121

1 Proposed LaSWAP Site Plan
SCALE - 1 : 200@A1

Key

Buildings Footprints	Concrete steps	Proposed hedge. Allowance to be made for 450mm depth of topsoil and 50mm of bark mulch	Lower Roof Level - Sedum Finish
Proposed Bitmac	In situ cast concrete	Proposed Grass	Higher Roof Level - Grey Single ply membrane
Proposed Block paving e.g. Andover washed by Charcon Colour: Silver Grey/ Buff Sizes: 200x100x80mm and 300x200mm	Bench Concrete base with timber top	Existing landscape to retain	Gutter
Proposed Concrete set paving e.g. Andover washed by Charcon Colour: Silver Grey/ Buff Size: 100x100x80mm	Cycle shelter	Existing tarmac	Fall arrest system to aid maintenance of roof. Shown indicatively only.
Hazard Warning Tactile texture	Timber Litter Bin	Car Park space	Roof access hatch
Self Binding Gravel	Proposed Trees	2M Black steel railings	Aluminium downpipe and hopper
Grass reinforcement system. Grassgrid or similar approved	Existing Trees	1.1M Black steel railings	RWP
Timber Deck	Felled Trees	Game Court fence	Falls to be designed by specialist
Low level concrete cast in-situ retaining walls/ seating wall	Shrubs. Allowance to be made for 450mm depth of topsoil and 50mm of bark mulch	Site Boundary	Roof ventilation terminals
No hatch	Escape routes from existing buildings to be maintained during the works	Tree Protective Fencing shown indicatively, refer to arboricultural report for more detail	Proposed handrail
		Proposed handrail	1:3 Fall indicator with gradient

Site Boundary Key

- Red line: Site boundary
- Blue line: Blue ownership line for PHS
- Blue dashed line: Blue ownership line for WES

Note:

- School to be in use throughout the duration of the works.
- Site boundaries to be kept secure at all times.
- Deliveries to be made in accordance with construction traffic management, plan to be submitted to and approved by the Local Authority.
- Contractor to maintain site access throughout the works for emergency vehicles.
- For existing levels and underground services refer to topographical survey and subsite survey.
- All areas affected by constructions works within works areas are to be fully reinstated to at least their original condition.
- Drawing to be read in conjunction with the Arboricultural Report to comply with root protection areas, no dig construction and temporary ground protection requirements.

Drawing List

GA Plan	(00)002
Elevations	(00)011
GA Sections	(00)020
Doors	(31)001
Ceilings	(35)001
Finishes	(40)001
Floor Finishes	(43)001
Room Layouts	(72) series
External Works	(90) series

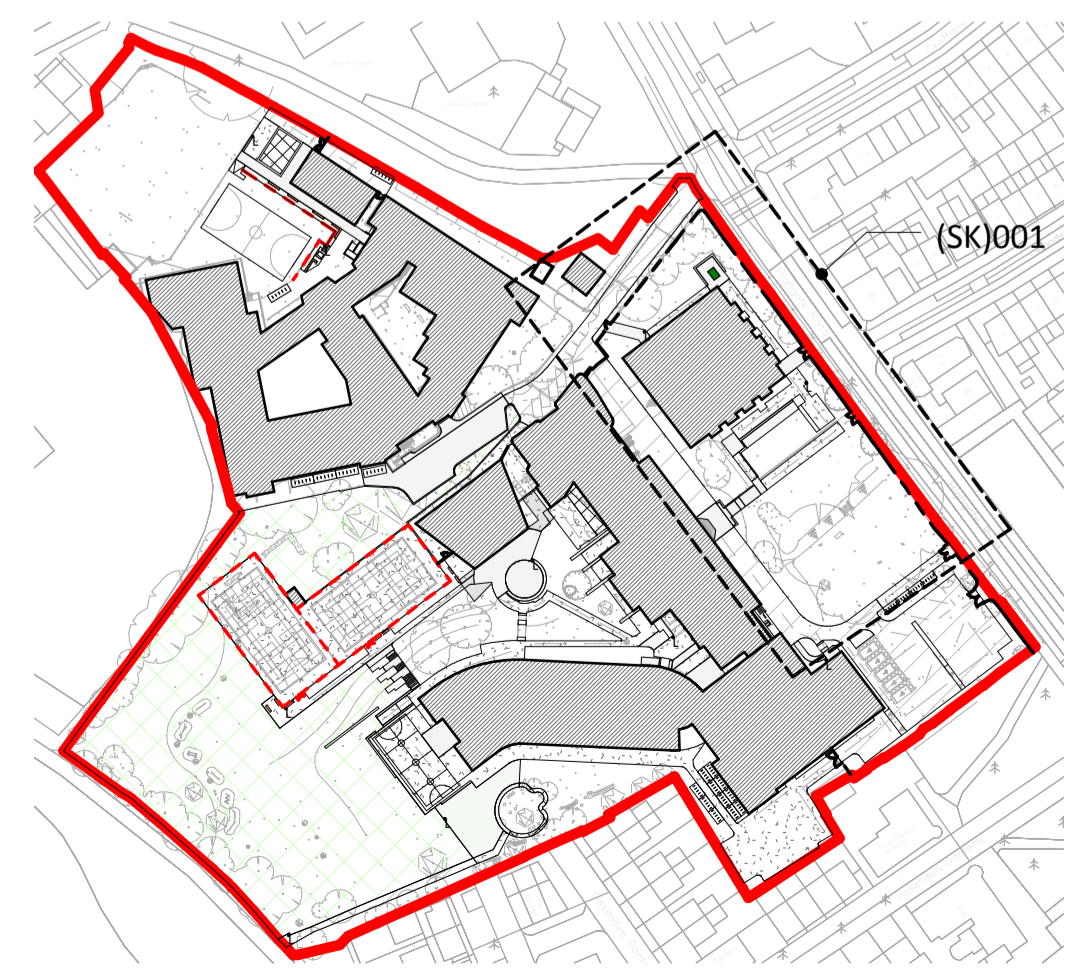

Project Title:
 Parliament Hill School, William Ellis School and LaSWAP Sixth Form

Client:
 Farrans

Drawing Title:
 Proposed LaSWAP Site Plan

File Number: SCH284

Drawn By: LPMCJ

Checked By: BFLA

Scale@A1: As indicated **Date:** 14/03/16

Dwg No: (SK)001 **Rev:** E