

# EXISTING GROUND FLOOR PLAN

Dec 2015

1:50

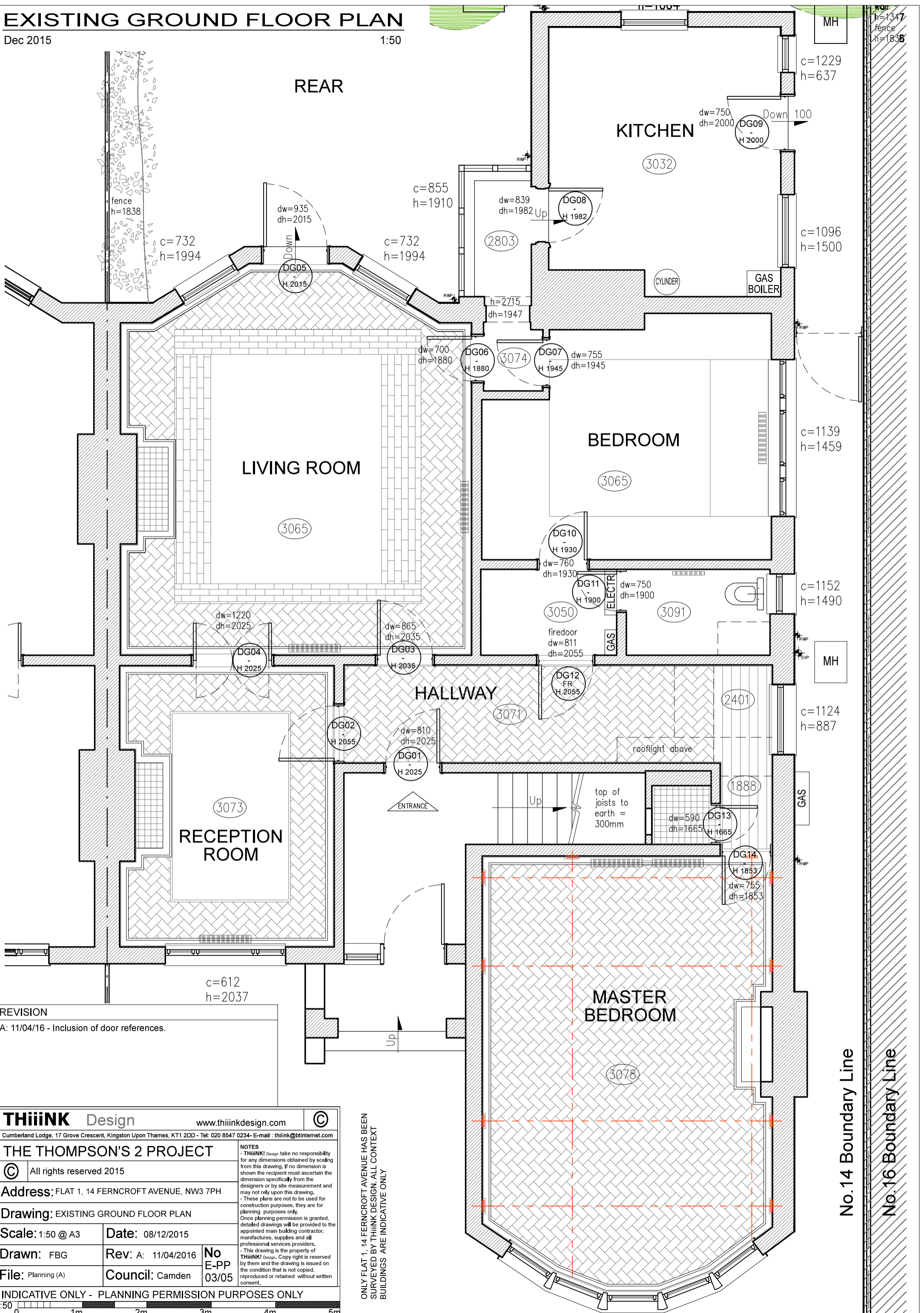

REVISION
A: 11/04/16 - Inclusion of door references.

<b>THiiNK Design</b>		www.thiinkdesign.com	©
Cumberland Lodge, 17 Grove Crescent, Kingston Upon Thames, KT1 2DD - Tel: 020 8547 0234 - E-mail: thiink@btinternet.com			
<b>THE THOMPSON'S 2 PROJECT</b>			
© All rights reserved 2015			
Address: FLAT 1, 14 FERNCROFT AVENUE, NW3 7PH			
Drawing: EXISTING GROUND FLOOR PLAN			
Scale: 1:50 @ A3	Date: 08/12/2015		
Drawn: FBG	Rev: A: 11/04/2016	No E-PP	
File: Planning (A)	Council: Camden	03/05	
INDICATIVE ONLY - PLANNING PERMISSION PURPOSES ONLY			



ONLY FLAT 1, 14 FERNCROFT AVENUE HAS BEEN SURVEYED BY THiiNK DESIGN. ALL CONTEXT BUILDINGS ARE INDICATIVE ONLY

No.14 Boundary Line  
No.16 Boundary Line