

# EXISTING GROUND FLOOR PLAN

Dec 2015

1:100

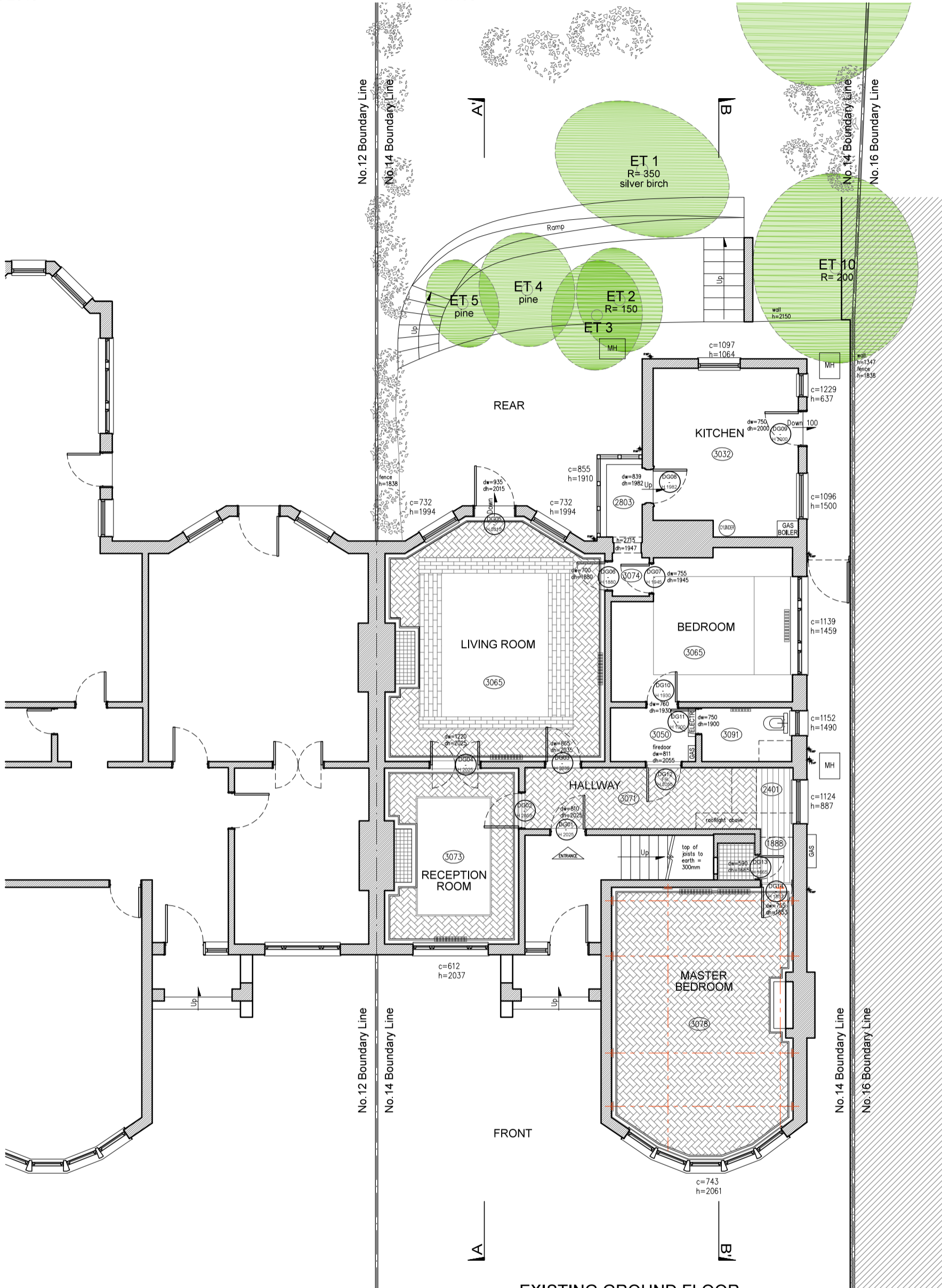

EXISTING GROUND FLOOR

ONLY FLAT 1, 14 FERNCROFT AVENUE HAS BEEN SURVEYED BY THiiNK DESIGN. ALL CONTEXT BUILDINGS ARE INDICATIVE ONLY

**REVISION**

A: 11/04/16 - Inclusion of door references.

**THiiNK Design** www.thiinkdesign.com

Cumberland Lodge, 17 Grove Crescent, Kingston Upon Thames, KT1 2DD - Tel: 020 8547 0234- E-mail : thiink@btinternet.com

**THE THOMPSON'S 2 PROJECT**

© All rights reserved 2015

**Address:** FLAT 1, 14 FERNCROFT AVENUE, NW3 7PH

**Drawing:** EXISTING GROUND FLOOR PLAN

**Scale:** 1:100 @ A3 **Date:** 08/12/2015

**Drawn:** FBG **Rev:** A: 11/04/2016

**File:** Planning (A) **Council:** Camden **No E-PP 02/05**

**NOTES**  
 - THiiNK! Design take no responsibility for any dimensions obtained by scaling from this drawing. If no dimension is shown the recipient must ascertain the dimension specifically from the designers or by site measurement and may not rely upon this drawing.  
 - These plans are not to be used for construction purposes only, they are for planning purposes only. Once planning permission is granted, detailed drawings will be provided to the appointed main building contractor, manufacturer, supplier and all professional services providers.  
 - This drawing is the property of THiiNK! Design. Copy right is reserved by them and the drawing is issued on the condition that is not copied, reproduced or retained without written consent.

INDICATIVE ONLY - PLANNING PERMISSION PURPOSES ONLY

