

Section A-A'
Scale 1:50

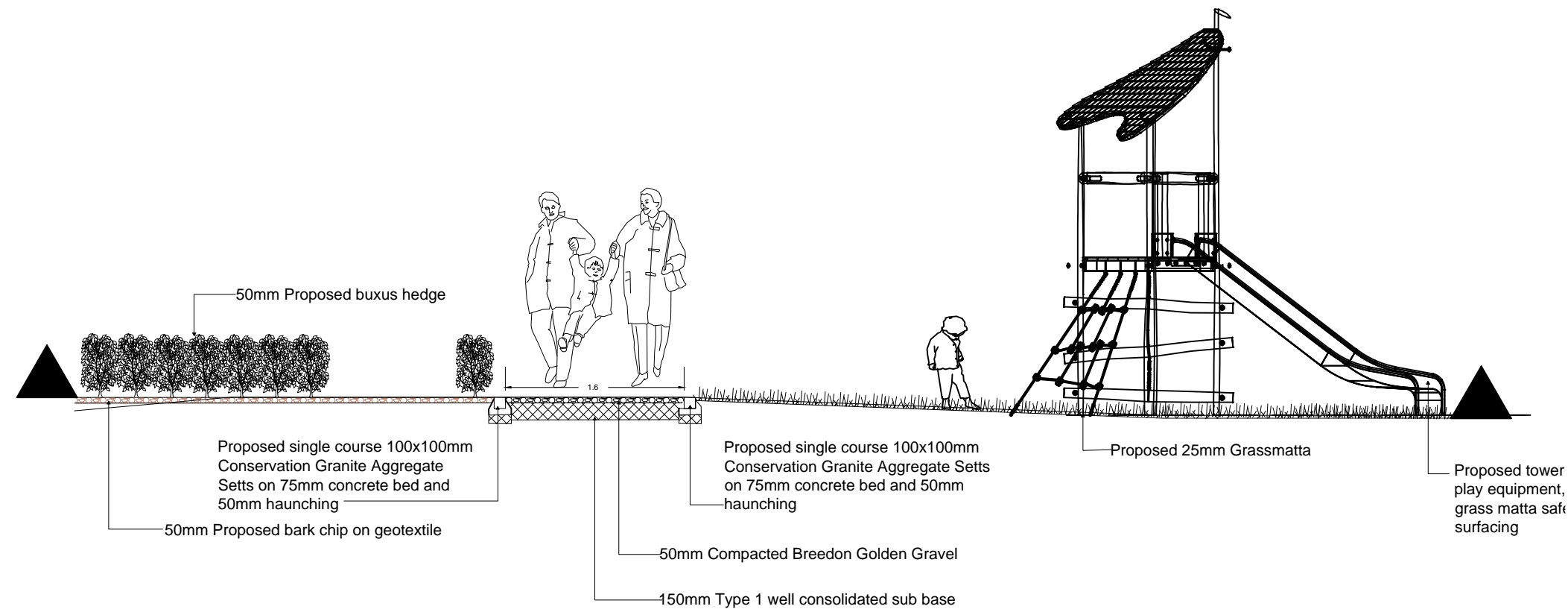

Section B-B'
Scale 1:50

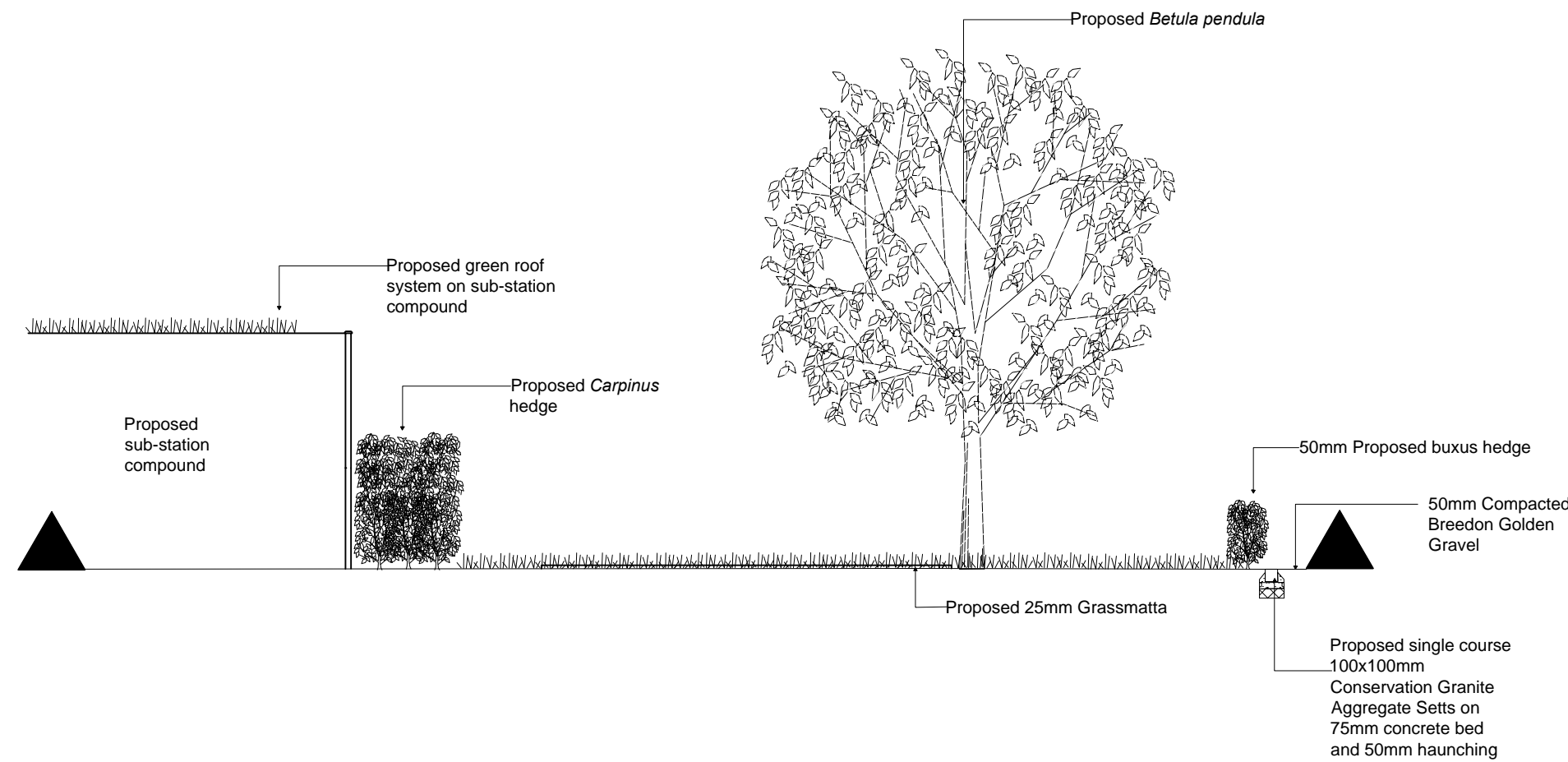

Section C-C'
Scale 1:50

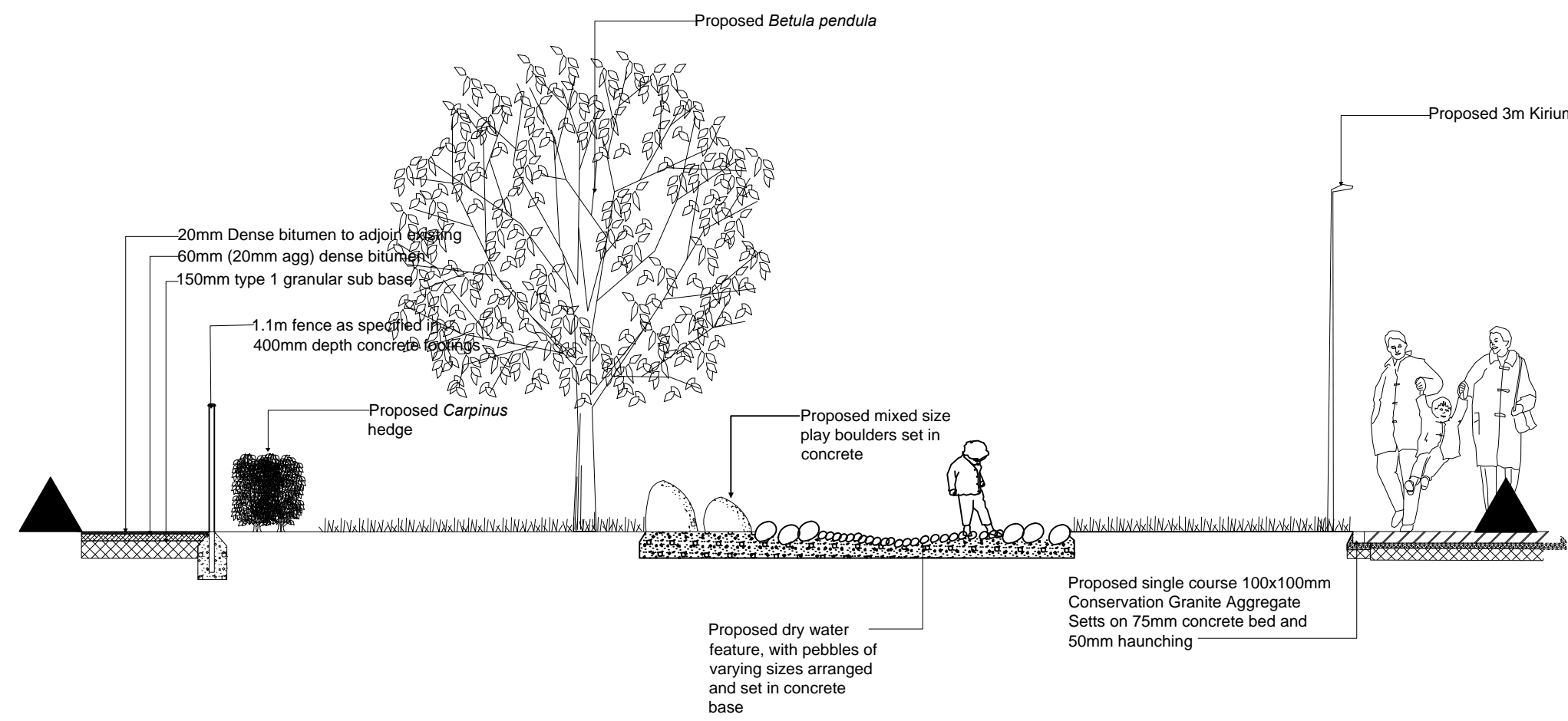

Section D-D'
Scale 1:50

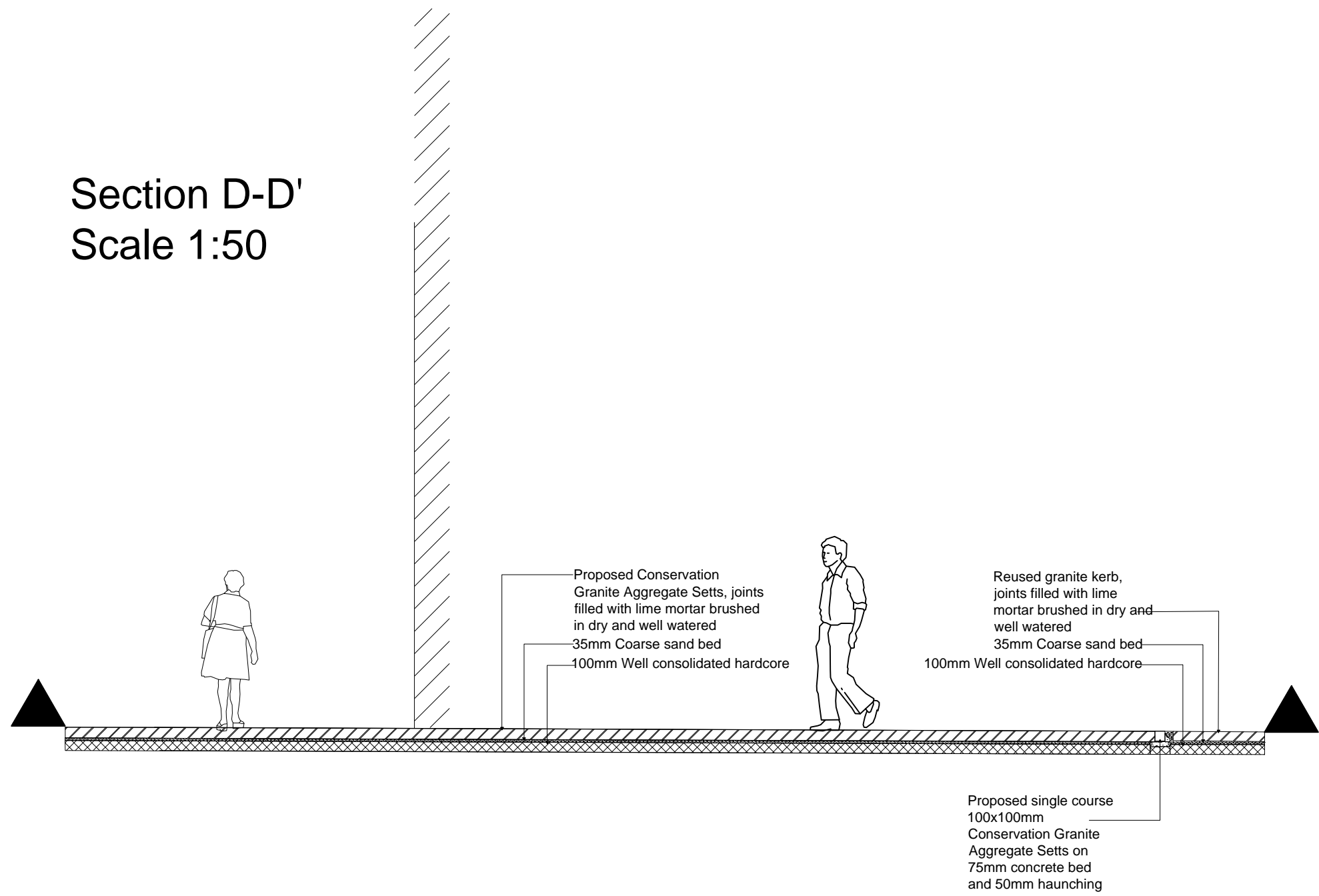

Section E-E'
Scale 1:50

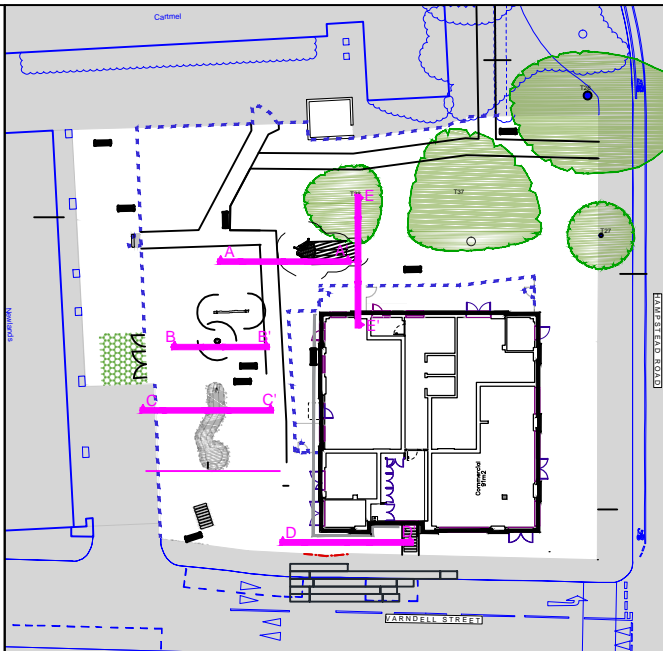
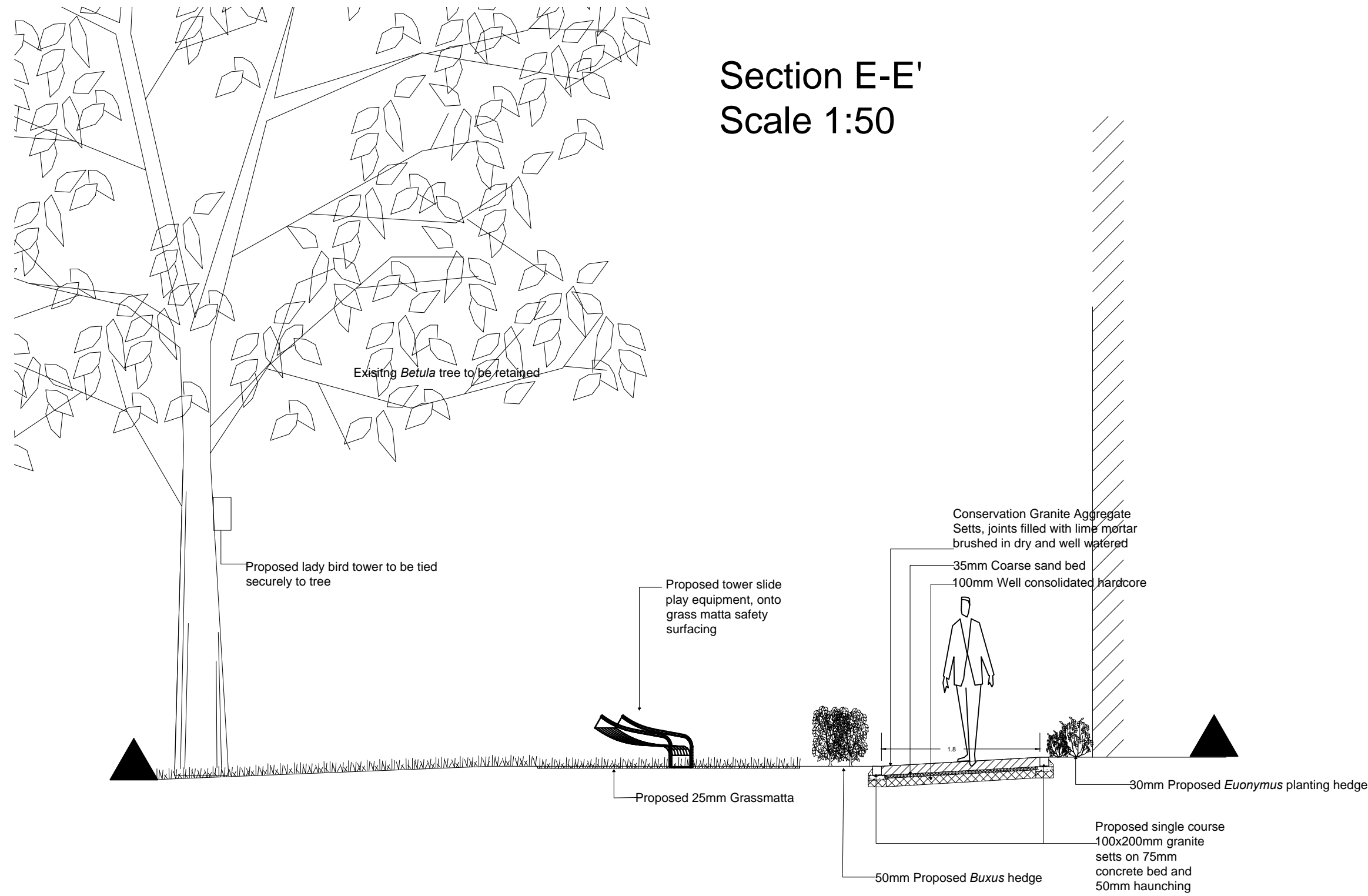

Cross section location plan



Rev	Date	Details	Drawn
B	14.04.16	Add sub-station	JS
A	26.02.16	VE updates	JS

ACD
ENVIRONMENTAL

Ecology
Archaeology
Arboriculture
Landscape Architecture

ACD at these offices:
Rodbourne Rail Business Centre, Grange Lane,
Malmesbury, SN16 0ES
Tel: 01666 825646

Courtyard House, Mill Lane, Godalming, GU7 1EY
Tel: 01483 425714

Suite 6, Crescent House, Yonge Close, Eastleigh, SO50 9SX
Tel: 02382 026 300
email: mail@acdenv.co.uk
www.acdenvironmental.co.uk

Lovell Partnerships Limited

scheme: Regent's Park Estates
Newlands

client: Lovell Partnerships Ltd

drawing: Cross Sections

date: September 2015

scale: 1:50@A1

drawing no: LOV20035-13B

drawn: JNT checked: JS

Copyright of ACD Environmental Ltd. All rights described in Chapter IV of the Copyright, Designs and Patents Act 1988 have been generally asserted: 2011. Copyright of this plan remains with ACD until all fees have been paid in full.