

SUMATRA ROAD

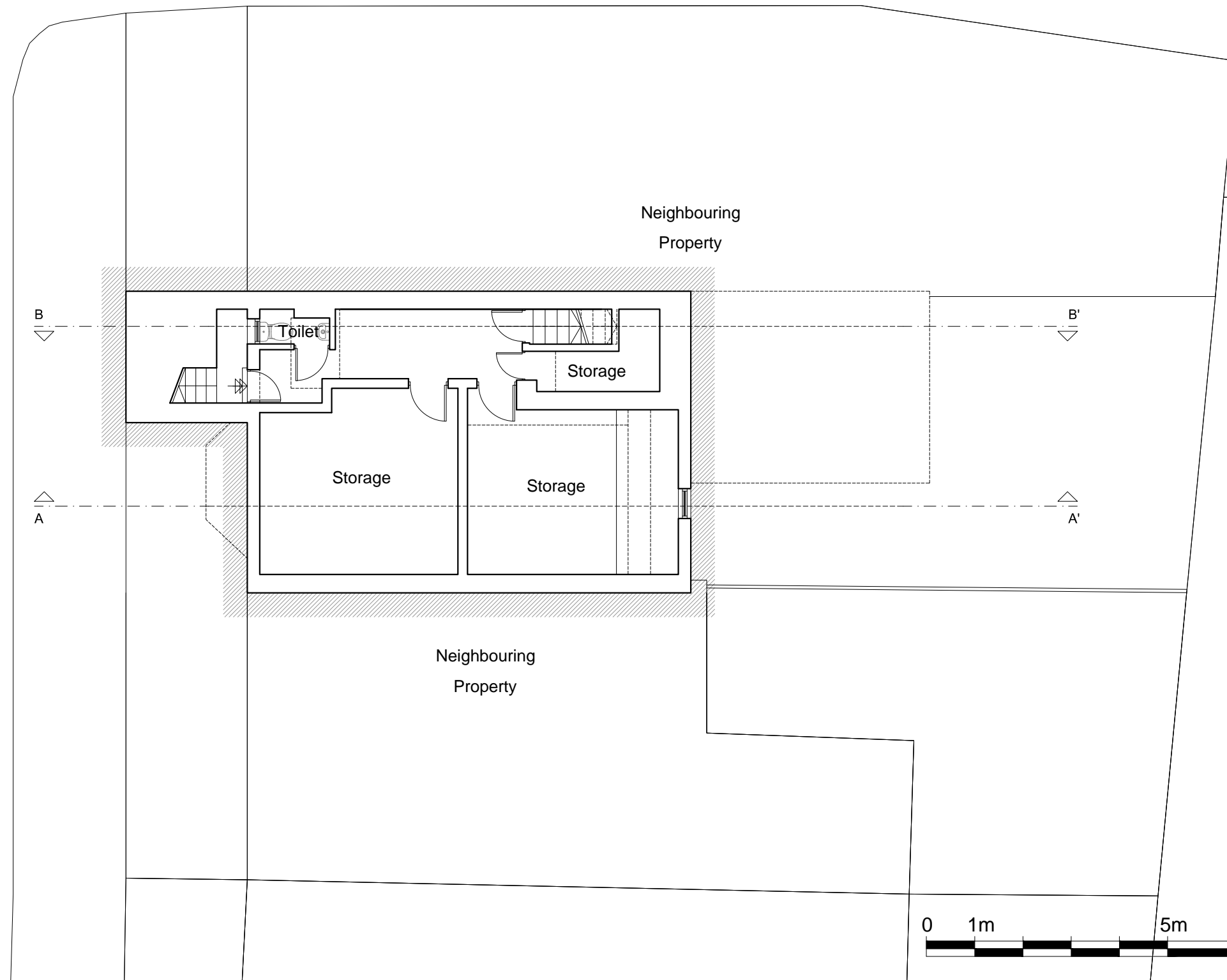

**Dimensions** Written dimensions to be taken in preference to scaled dimensions. The Contractor is responsible for checking all dimensions before work starts.

**Local Authority** All work is to be carried out to the requirements, and to the satisfaction of the Local Authority. These drawings are for planning purposes only.

**Discrepancies** Any discrepancies to be brought to the attention of Drawing And Planning Ltd. Immediately.

**REVISIONS**

REV	DATE	DESCRIPTION	BY	CH

**PROJECT TITLE**  
211 Sumatra Road

**DATE**  
Jun 2016

**REVISION**  
/

**DRAWING TITLE**  
Existing - Basement

**CLIENT**  
RLA Homes Limited

**DRAWING No.**  
SMTRR-P000

**SCALE @ A3**  
1:100

