

## **Annex 3: Details of engagement undertaken**

### **3.1 Engagement log**

### **3.2 Example of community engagement letter and accompanying plans**

### **3.3 Community engagement flyer**

### **3.4 Map of mailout area**

### **3.5 Information boards used at community information events**

NTH Engagement Contacts	Details	Pre-APP Actions	Post-APP Actions
UCL Bartlett School	<ul style="list-style-type: none"> <li>- 4th May 2016 - NTH letter posted providing overview of the demolition project.</li> <li>- 4th May 2016 - Followed up with a call to UCL's Sustainability Manager.</li> <li>- 4th May 2016 - Emailed summary of call and request for meeting with the Director of Property and Accommodation, and Sustainability Manager for the UCL estates.</li> <li>- 9th May 2016 - Meeting held with UCL. Overview of NTH proposals presented and discussed. Generally content and requested that HS2 could 1) consider a controlled crossing at Cardington St (if not already proposed), 2) carry out most of the 'noisy' works during summer period, and 3) consider 'excellent' under Considerate Contractors Scheme (which HS2 have already committed to). Bartlett School will have some research / office work within building facing the Vezey Wing. UCL have vested no further interest for another meeting prior to submission of application to LBC.</li> </ul>	No further action. Comments to be addressed within prior approvals application.	Ongoing co-ordination to be provided.
Maria Fidelis RC Convent School, North Gower Street	<ul style="list-style-type: none"> <li>- 4th May 2016 - NTH letter posted providing overview of the demolition project.</li> <li>- 20th May 2016 - Meeting held with School's Headmistress and Deputy Headmaster (at Phoenix Road Site). NTH proposals, programme and potential impacts discussed at the meeting. It was noted that Gower Street site would likely be busier than usual for duration of NTH works to accommodate Phoenix Road site works. Relocation of Gower Street site expected early 2019 (delay to School's programme). School in favour of bus stop outside NTH relocating (temporarily and permanently) further south of Hampstead Road and closer to the school site. Ongoing meetings between HS2 and School to be held throughout works - frequency to be established when HS2 Contractor are on board. No adverse air quality impacts expected, and will be monitored. No vibration issues will be expected. Noise impacts will be addressed as part of ongoing HS2 assurance to School, as part of the Trigger Action Plan (TAP) and Section 61s. School's 'sanctuary' room for Special Educational Needs to be further investigated in regards to noise, and mitigation (if required) to be agreed as part of TAP and s61s.</li> </ul>	No further action. Comments to be addressed within prior approvals application.	Ongoing co-ordination to be provided.
Network Rail, Power Signal and Maintenance Facility along Cardington Street	<ul style="list-style-type: none"> <li>- 4th May 2016 - NTH letter posted providing overview of the demolition project.</li> <li>- 6th May 2016 - Followed up with call to NR's Programme Sponsor. Acknowledged letter received. Summary email also provided for NR to circulate. HS2 acknowledged 24-7 hour access was required for NR (on Cardington Street) and that the NTH proposals would not affect this.</li> <li>- 19th May 2016. NR emailed and called to confirm their only concern was maintaining 24-7 hour access to their facilities on Cardington Street. HS2 re-assurance provided that this will not be an issue in relation to the NTH works.</li> </ul>	No further action. Comments to be addressed within prior approvals application.	Ongoing co-ordination to be provided.
Thistle Euston Hotel, Cardington Street	<ul style="list-style-type: none"> <li>- 4th May 2016 - NTH letter posted providing overview of the demolition project.</li> <li>- 6th May 2016 - Emailed General Manager of Thistle with brief introduction of NTH project.</li> <li>- 6th May 2016 - Email received from Thistle confirming they are awaiting legal advice to enable engagement on party wall matters.</li> <li>- 12th May 2016 - Meeting held with General Manager. Proposals with timeframes, etc of NTH were discussed. Thistle acknowledged party wall and possible disruptions to the Hotel and awaits more information from HS2 to enable legal to review. More information is to be exchanged between parties to enable party wall award. Ongoing consultation throughout until party wall award is in place.</li> </ul>	No further action. Comments to be addressed within prior approvals application.	Ongoing co-ordination before and during works. Party Wall Agreement to be obtained prior to demolition of NTH.

NTH Engagement Contacts	Details	Pre-APP Actions	Post-APP Actions
NHS Margarete Centre, 108 Hampstead Road	<ul style="list-style-type: none"> <li>- 4th May 2016 - NTH letter posted providing overview of the demolition project.</li> <li>- 6th May 2016 - Attempted to contact NHS Service Manager to introduce and establish contact. However, not available and therefore left a message with a colleague.</li> <li>- 9th May 2016 - Attempted to contact NHS Service Manager again. Message left on answer phone.</li> <li>- 14th May 2016 - Attempted door knock, however premises were closed.</li> <li>- 19th May 2016 - Called and left my details for a call back. A brief introduction / summary of NTH was given to colleague instead of the Services Manager.</li> <li>- 19th May 2016 - Call back received from NHS's Deputy Service Manager. NTH overview provided along with timescales and expectations. No particular concern from NHS, except why they weren't part of the original Bill. HS2 followed up the call with an email providing further information / handouts of the project for NHS circulation.</li> </ul>	No further action.	Ongoing co-ordination to be provided.
TfL Roads and Buses	<ul style="list-style-type: none"> <li>- 4th May 2016 - NTH letter posted providing overview of the demolition project.</li> <li>- 18th May 2016 - Meeting held with TfL and Camden Traffic Working Group. TfL representatives included Lucy Ryan and Timothy Mackay. Camden representative was Rob Slaney. HS2 presented NTH proposals and traffic related information for commenting. Feedback provided was to consider taxis and coaches along Cardington Street and the difficulty to turn left onto Hampstead Road. Bus stop relocation can be temporary prior to permanent relocation being established. Details to be discussed with TfL Buses in due course. All consents can be through the working group to enable TfL and Camden to review together. CMP to include lorry movements and routes if information is available.</li> </ul>	No further action. Comments to be addressed within prior approvals application.	Ongoing co-ordination to be provided.
Camden Town Unlimited, Collective Temperance Hospital, 110 Hampstead Road	<ul style="list-style-type: none"> <li>- 4th May 2016 - NTH letter posted providing overview of the demolition project.</li> <li>- 12th May 2016 - Meeting held with CEO of CTU. NTH proposals tabled and discussed. CTU were fully supportive and well aware of potential disturbances and will work with HS2 during the works. Brief tour of CTU floors also provided. CTU would like confirmation (if possible) that they could stay until the end of their lease agreement. As much notice to CTU on the works is preferred. Appointed HS2 contractor to co-ordinate with CTU throughout the duration of the works.</li> </ul>	No further action. Comments to be addressed within prior approvals application.	Ongoing co-ordination to be provided.
Whitehall Park Property Developer, 106 Hampstead Road	<ul style="list-style-type: none"> <li>- 4th May 2016 - NTH letter posted providing overview of the demolition project.</li> <li>- 6th May 2016 - Attempted to contact owner several times throughout the day, but not available.</li> <li>- 14th May 2016 - Attempted door knock at 10:30am, however premises were closed.</li> </ul>	No further action.	Ongoing co-ordination to be provided.
Surma Community Centre, Bengali Workers Association Health Project. 1 Robert Street	<ul style="list-style-type: none"> <li>- 4th May 2016 - NTH letter posted providing overview of the demolition project.</li> <li>- 6th May 2016 - Attempted to contact owner, but not available until Monday. Message left.</li> <li>- 10th May 2016 - Phone conversation with BWA representative held. BWA seemed very supportive and would drop by into one of the community events (12th or 14th) for more information if needed.</li> <li>- 19th May 2016 - HS2 emailed BWA to share more information about the NTH proposals.</li> </ul>	No further action.	Ongoing co-ordination to be provided.

NTH Engagement Contacts	Details	Pre-APP Actions	Post-APP Actions
Community, 19,902 Addresses (refer to map of catchment area - includes all estates and residences around NTH)	<p>- Community event held at HS2 in Euston, on Thursday (4pm-8pm) 12th May 2016. Number of visitors: 19.</p> <p>- Community event held at HS2 in Euston, on Saturday (10am-2pm) 14th May 2016. Number of visitors: 12.</p> <p>Visitors included residences from Robert Street, local estates and within Euston, Mr Christofi, Lovells Construction, listed building owners, UCL staff and students, local Architects and Camden.</p> <p>General feedback (related to the NTH): Members of public were mainly concerned with 1) lorry / HGV movements and where they would go in relation to the works, 2) how asbestos would be managed, 3) general noise / dust impacts and working hours, and 4) was the NTH listed. One member also wanted to know where the new bus stop would be located (if to be removed). Indicative details are as per Hybrid Bill / AP3, and details will be provided in due course following further consultation with Camden and TfL.</p>	No further action. Comments to be addressed within prior approvals application.	Address feedback forms and respond. Working groups to be established if and when required. Ongoing community engagement to be provided.
Lovell Construction Sites, along Hampstead Road	<p>- 14th May 2016 - Lovells attended community event at HS2 in Euston. Agreed to follow up with meeting to share and co-ordinate programmes.</p> <p>- 16th May 2016 - Email sent to Lovell requesting a meeting. Summary details of NTH provided as attachments.</p> <p>- 19th May 2016 - Called Lovells and left a message for call back. Reception advised Site Manager will be available on Monday. Lovells programme (rev 06a, dated 05.04.15) received through existing HS2-Lovells communications. Their programme considered as part of the development of the NTH application.</p> <p>- 23rd May 2016 - Called Lovells for a meeting with their Contracts Manager. Was advised he will be available from 31st May. Co-ordination to continue throughout NTH programme.</p>	Meeting to be held w/c 30 May subject to Lovells availability.	Ongoing co-ordination to be provided.

Address

Ref: NTH/001/2016

3<sup>rd</sup> May 2016

Dear Sir/Madam,

I would like to inform you of the proposed demolition works to the former National Temperance Hospital (NTH) on Hampstead Road, and to advise you that we will also soon be engaging with the community to keep them informed of our proposals.

In preparation for the construction of the HS2 Station at Euston, HS2 Ltd is planning to demolish the derelict National Temperance Hospital on Hampstead Road. The proposal involves the phased demolition of the Vezey Wing in 2016 and the Insull Wing in 2017/18. Please see attached plan.

The Insull Wing of the NTH is currently home to Collective – a Camden Town Unlimited project offering workspace to start-up businesses. It is also home to HS2 in Euston, an information resource centre for the public to find out more about the project. Collective and HS2 in Euston will remain in operation throughout the demolition of the Vezey Wing.

HS2 Ltd will be seeking approval for demolition works from the London Borough of Camden. It is estimated that this submission will be made to the Council in May / June 2016.

Demolition works at the National Temperance Hospital site prior to Royal Assent (of the High Speed Rail (London – West Midlands) Bill) provide the opportunity to undertake works for HS2 earlier in the programme. This reduces the intensity of concurrent demolition work being undertaken to the west of Euston Station. From Spring 2017, once the first phase of demolition is complete, the site will be used as an HS2 construction compound.

The methodology for demolition is currently being developed and we are seeking to engage with you to address any concerns. The NTH buildings will be carefully demolished and work will take place during times agreed with London Borough of Camden. Best Practicable Means will be applied during the works to minimise noise at neighbouring residential properties and other sensitive receptors.

HS2 will continue to engage with you throughout the planning process and is offering the opportunity to meet with the project team planning the works.

For further information or to arrange a meeting with the project team, please contact Suzanne Crouch (Senior Interface Manager) on **0207 944 4908** or email **hs2enquiries@hs2.org.uk**.

Yours Sincerely,

**Peter Curson**  
Project Director, Euston  
High Speed Two (HS2) Limited

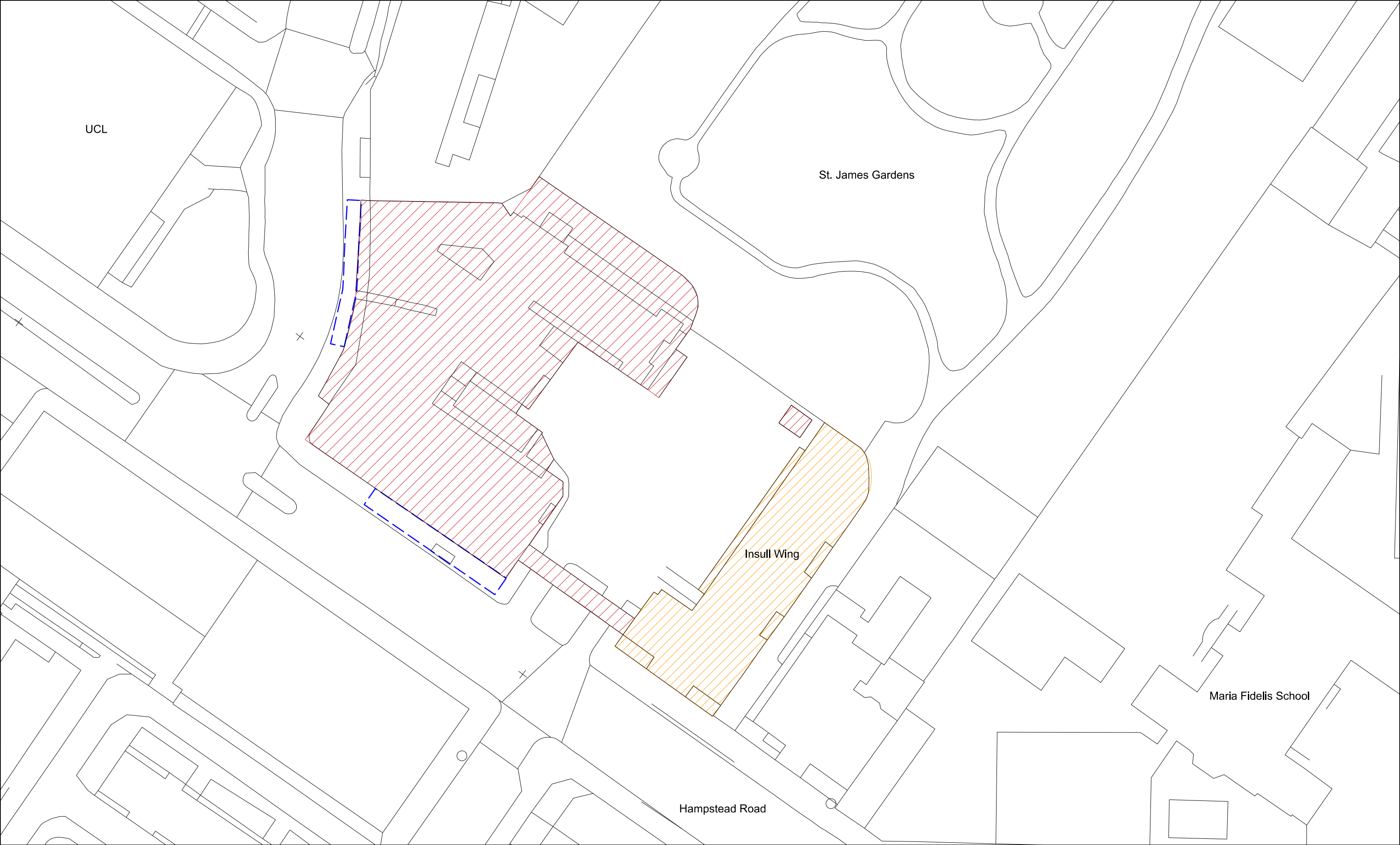

Grade Level

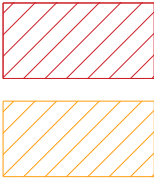

Phase 1 Demolition  
Phase 2 Demolition



Vaults below

Note:  
Please refer to Demolition Methodology

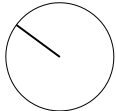



Hampstead Road Elevation

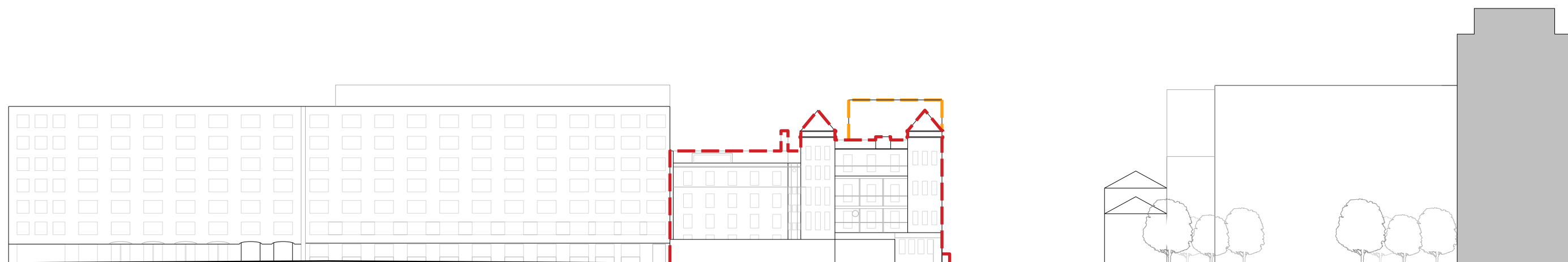

Cardington Street Elevation

## Existing Elevations

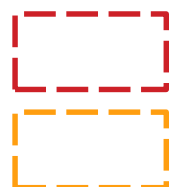

Phase 1 demolition

Phase 2 demolition

Note:  
Please refer to Demolition Methodology

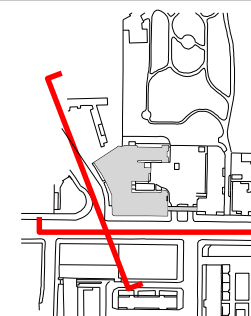

GRIMSHAW - Euston  
NTH Site  
Existing Elevations  
12016-01-Sk-454\_A  
Page 03  
Scale 1:500 @ A3

# HS2 in Euston

## INFORMATION EVENTS – MAY 2016

High Speed Two (HS2) is the new high speed railway for Britain linking London to eight of our largest cities, including Birmingham, Leeds and Manchester.

We are holding information events so you can find out more and ask questions about the project and what it means for the local area.

### Air quality and moving materials by rail

Find out how we plan to:

- reduce and monitor the effects of our construction work on the environment.
- bring in and take out construction material by rail, not road.

### Demolition of NTH

The old National Temperance Hospital (NTH) building will need to be demolished to make way for construction. Part of it is due to come down later this year. Find out how we're planning to do it.

### WHEN ARE THESE EVENTS HAPPENING?

#### Air quality and materials by rail events

Weds 11 May, 4pm-8pm

Fri 13 May, 10am-2pm

#### NTH demolition events

Thurs 12 May, 4pm-8pm

Sat 14 May, 10am-2pm

All events take place at  
HS2 in Euston, our new  
centre in Hampstead Road  
(see map on back)



If you have any questions or you would like to find out more information please contact us:



020 7944 4908



HS2enquiries@hs2.org.uk

Please contact us if you would like a free copy of this leaflet in:

- Large print
- Braille
- Audio

You can also contact us for help and information in a different language.

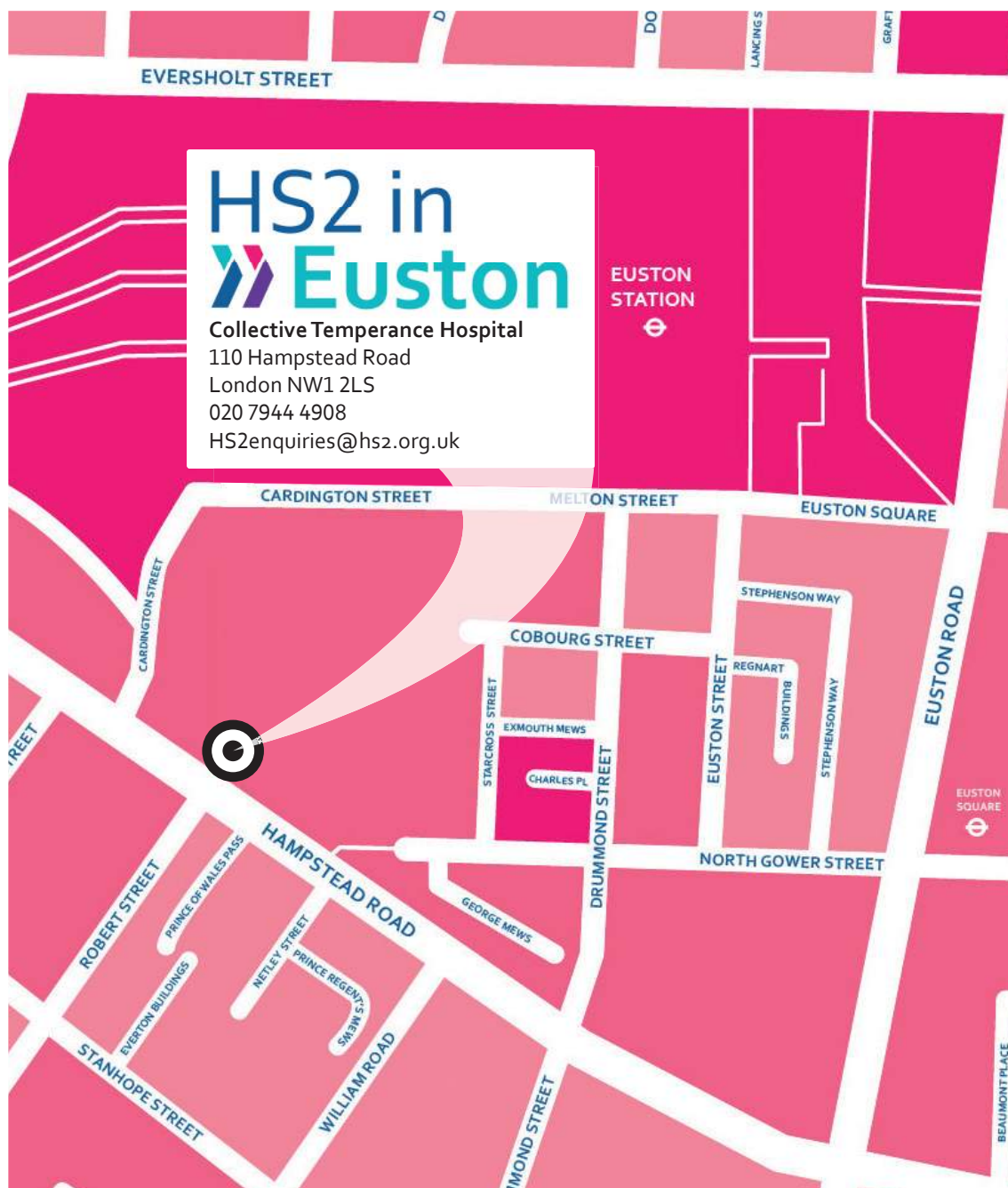



DRAFT

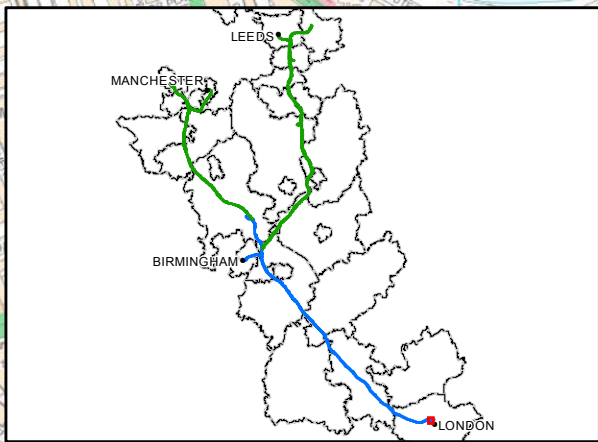
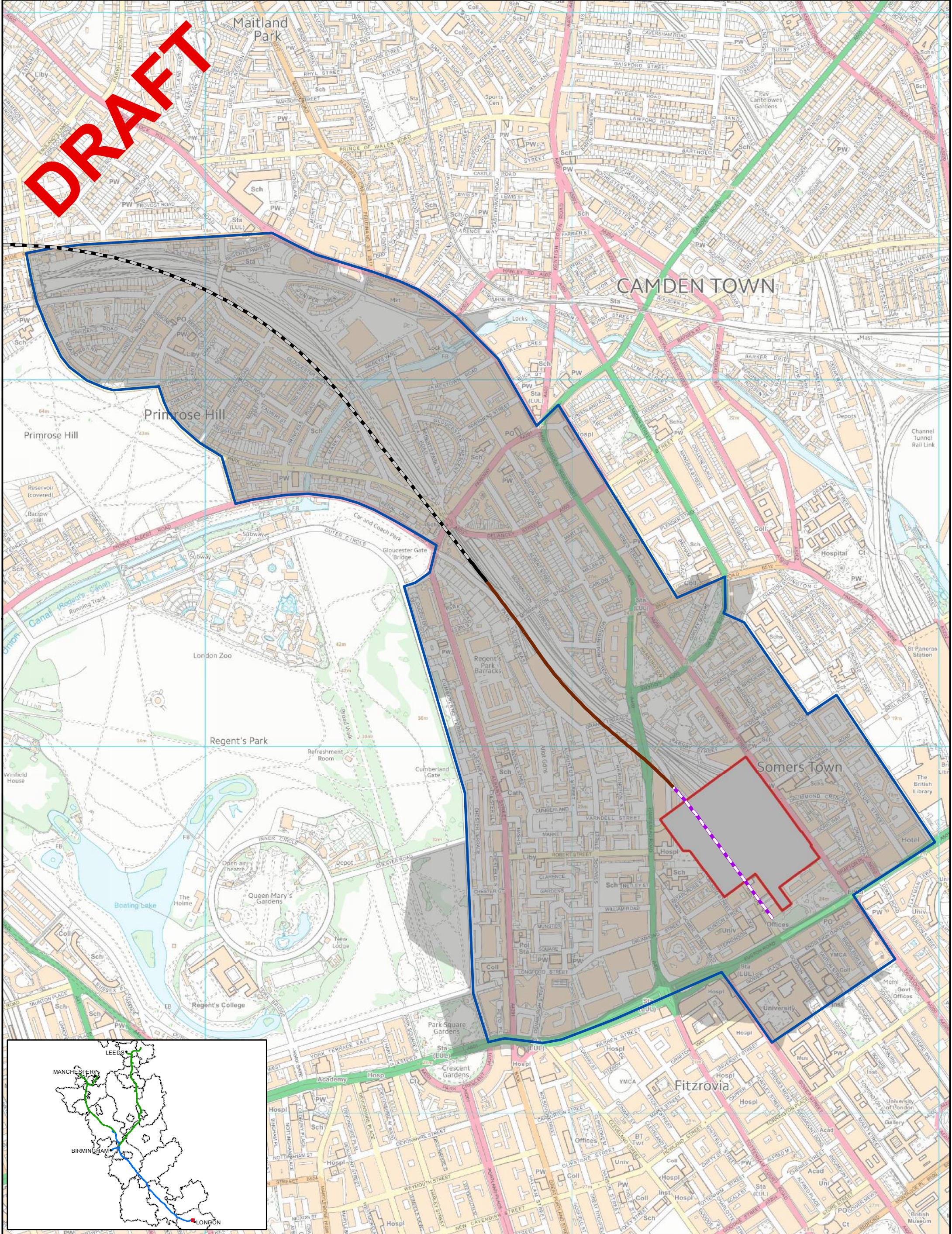

HS2 Ltd accept no responsibility for any circumstances, which arise from the reproduction of this map after alteration, amendment or abbreviation or if it issued in part or issued incomplete in any way.

© Crown copyright and database rights 2015.  
Ordnance Survey Licence Number 100049190.

Derived from (... cite the scale of the BGS data used...) scale BGS Digital Data under licence 2011/111 BP British Geological Survey. © NERC.

Contains Environment Agency information © Environment Agency and database right.

© Crown copyright material is reproduced with the permission of Land Registry under delegated authority from the Controller of HMSO.

This material was last updated on [date] and may not be copied, distributed, sold or published without the formal permission of Land Registry and Ordnance Survey. Only an official copy of a title plan or register obtained from the Land Registry may be used for legal or other official purposes. © Crown Copyright Ordnance Survey.

**Legend**

- AP3 mailout area
- Postcode areas intersecting AP3 mailout area
- AP03 Euston Station footprint
- Phase One SES and AP2 ES alignment July 2015
- Bored Tunnel
- Retaining Wall
- Station
- Tunnel Portal

High Speed Two

Phase One AP3  
Euston Station Mailouts

*Protect*

**hs2**

Scale at A3: 1:9,000

0 100 200 300 400 Metres

Registered in England. Registration number 06791686.  
Registered office: One Canada Square, London E14 5AB.

**Doc Number:** PH1-HS2-ER-MAP-010-000002-P02 **Date:** 28/08/15



## WHAT ARE WE DOING?

- HS2 Ltd is demolishing the former National Temperance Hospital to make way for the construction of the new HS2 station at Euston
- The building will be demolished in phases. It is planned that this work could commence in autumn 2016
- To allow HS2 Ltd to undertake the work, the methodology will be approved by the London Borough of Camden
- The methodology and construction management plan will be submitted to the London Borough of Camden in June 2016

## WHY ARE WE DOING THIS?

- To allow construction work to be undertaken at Euston, a construction compound will be required. This will occupy the National Temperance Hospital site
- Demolishing the NTH site early will reduce the intensity of concurrent demolition work being undertaken to the west of Euston station
- Early demolition reduces the risk of knock-on delays to other works at Euston

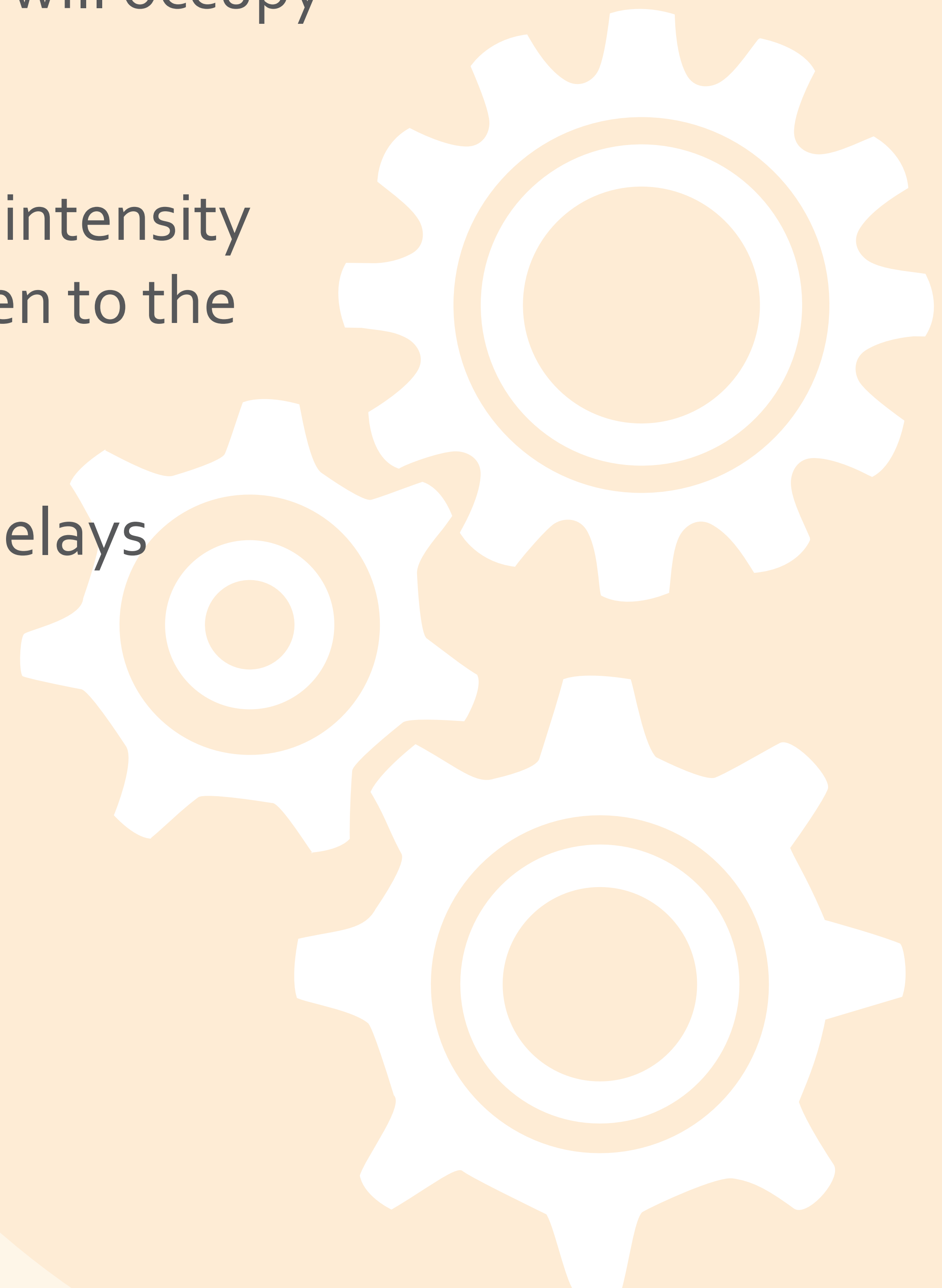

# WHEN WILL THE WORK TAKE PLACE?

## Current Indicative Programme

June 2016 – October 2016	October 2016 – March 2017	April 2017 – November 2017	July 2017 – March 2018
<p>Site secured and hoarded</p> <p>Asbestos removal and removal of internal walls and windows from Vezey Wing</p>	<p>Demolition of Vezey Wing in phases to leave a cleared hoarded site</p>	<p>Construction of HS2 site cabins</p>	<p>Demolition of Insull Wing to leave a cleared site</p> <p>Site to be used as a construction compound</p>

## WHO IS DOING THE WORK?

- The work is being planned and managed by HS2 Ltd, but the demolition will be undertaken by specialist contractors
- All contractors will be bound by the approved methodology and construction management plan
- Contractors will liaise with the community and stakeholders throughout
- The 'Considerate Constructors Scheme' will be followed by contractors



## WHERE ARE WE DOING THE WORK?

The work is being undertaken within the boundary of the National Temperance Hospital

Access will be from Hampstead Road; vehicles should access the site from the north and exit the site to the south

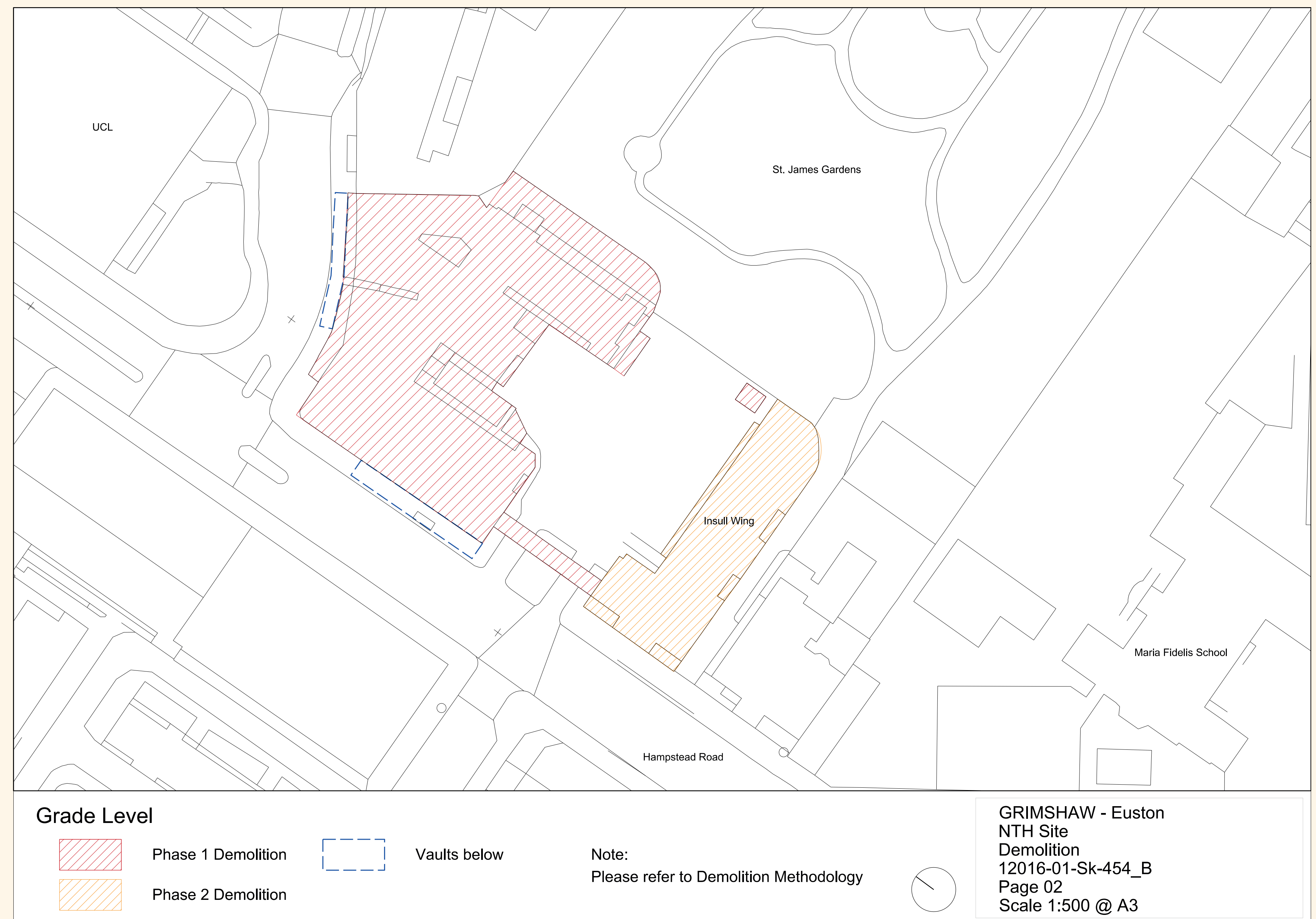

## HOW WILL THE SITE BE MANAGED?

- A construction management plan will be submitted to London Borough of Camden for approval
- The plan will include details of how the site will be managed and what measures are planned to manage effects during demolition
- The contractors will be bound by the approved demolition methodology and relevant HS2 undertakings and assurances





# THE VEZEY WING

