

DO NOT SCALE FROM DRAWINGS EXCEPT FOR PLANNING PURPOSES

Check and verify all dimensions on site before starting work or workshop drawings. All measurements are to structural elements unless otherwise stated.

Report all discrepancies, errors or omissions between drawings, site conditions and all other documents to Guy Goodfellow Ltd.

Please read this drawing in conjunction with all other Architect's, Consultant's and Sub-contractor's drawings.

Materials, components and workmanship are to meet or exceed the requirements of current Building Regulations, British Standards codes of practice, and the appropriate manufacturer's recommendations.

Sanitaryware on drawing is indicative only. All M&E information is to be detailed by Gas Safe and/or NICEIC registered contractor and approved by Guy Goodfellow Ltd.

Listed Buildings may need underpinning and this will require Listed Building Consent.

This drawing is issued on condition that it is not copied, reprinted or disclosed to a third party without the prior written consent of Guy Goodfellow Ltd.

This drawing and design are copyright.
© Guy Goodfellow Ltd

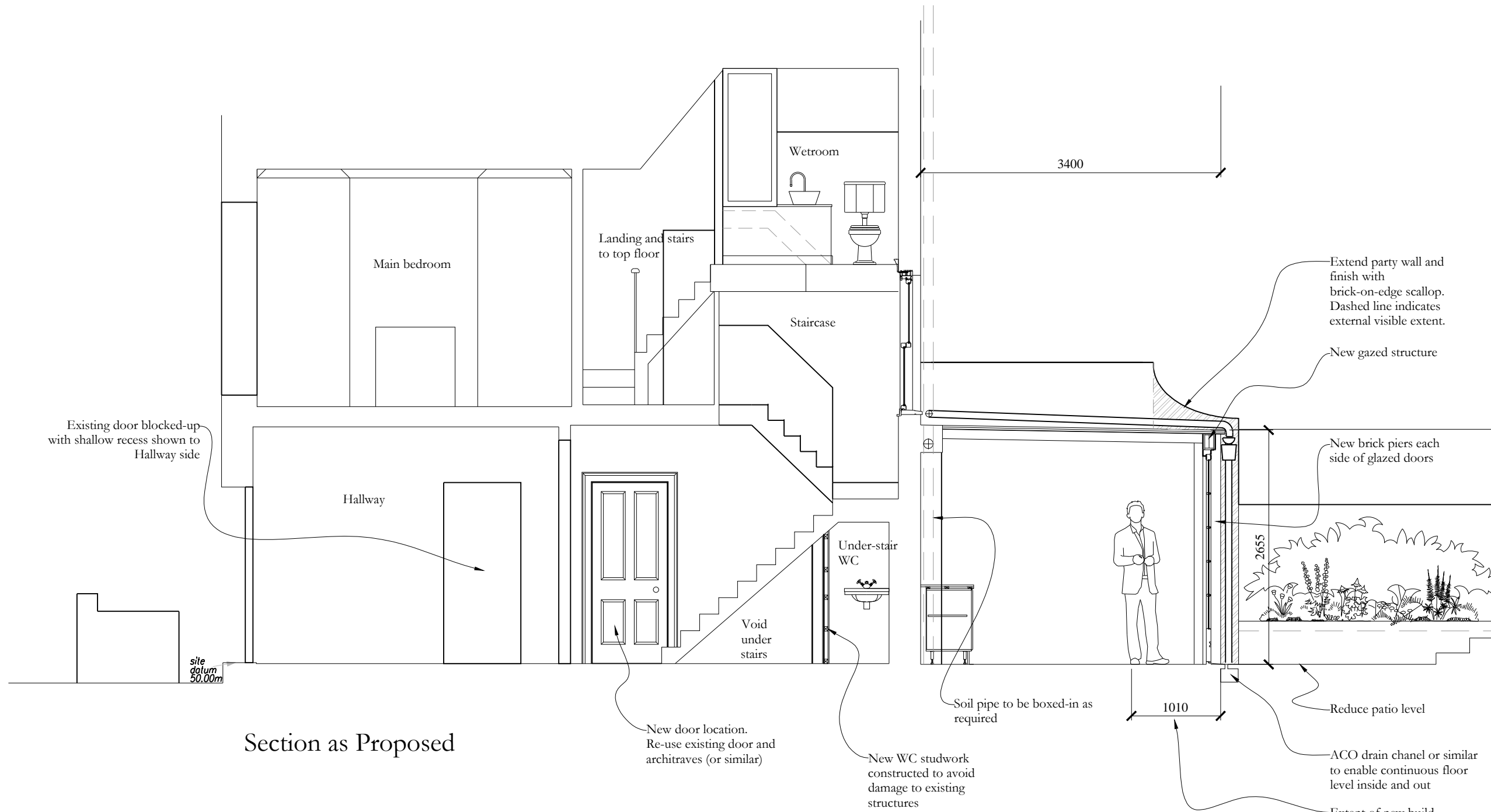

Section as Proposed

Extend party wall and finish with brick-on-edge scallop. Dashed line indicates external visible extent.
New gazed structure

New brick piers each side of glazed doors

Soil pipe to be boxed-in as required

New door location. Re-use existing door and architraves (or similar)

New WC studwork constructed to avoid damage to existing structures

Reduce patio level

Extent of new build increment

Revisions:

REV A - Hallway door changes added, additional information for under-stair WC and Wetroom

PLANNING	
GUY GOODFELLOW INTERIORS AND ARCHITECTURAL DESIGN	
13 LANGTON STREET, LONDON, SW10 0JL +44 (0)207 349 0728 MAIL@GUYGOODFELLOW.COM	
PROJECT	Leverton Street
DRAWING TITLE	Section Proposed Works
SCALE	1:50 @ A3
DRAWN BY	MHE
DATE CREATED	February 2016
DRAWING NUMBER	GGL-LEV-006
REVISION	A
DO NOT SCALE THIS DRAWING ALL DIMENSIONS TO BE CONFIRMED ON SITE ALL DISCREPANCIES TO BE REPORTED TO THE DESIGNERS	