



View of existing entrance

Defined Entrance

The sense of entrance was an important part of the developing brief and this has been influential in the overall massing and facade treatment.

The current un-rational building entrance contains three separate flat roofed building forms, along with a stepped access from street level of four steps and a further staircase configuration upon entering the property. The existing entrance is also unattractive, dark and detracts from the surrounding buildings.

The entrance footpath and retained parking area have been incorporated to define a clear entrance area within the proposed scheme.

Our proposals look to create a clear single storey form with a step free access to comply with 'Part M' and the requirements of 'Lifetime Homes'. The purity of form also relates the proposals strongly to the surrounding dwellings.

The stepped building line both horizontally and vertically and the material variation, which the front entrance is part of also helps to reduce the massing of the house and creates a cluster building form with separate roofs, of a scale in keeping with the surrounding context.

View of existing from entrance driveway adjacent to no.5

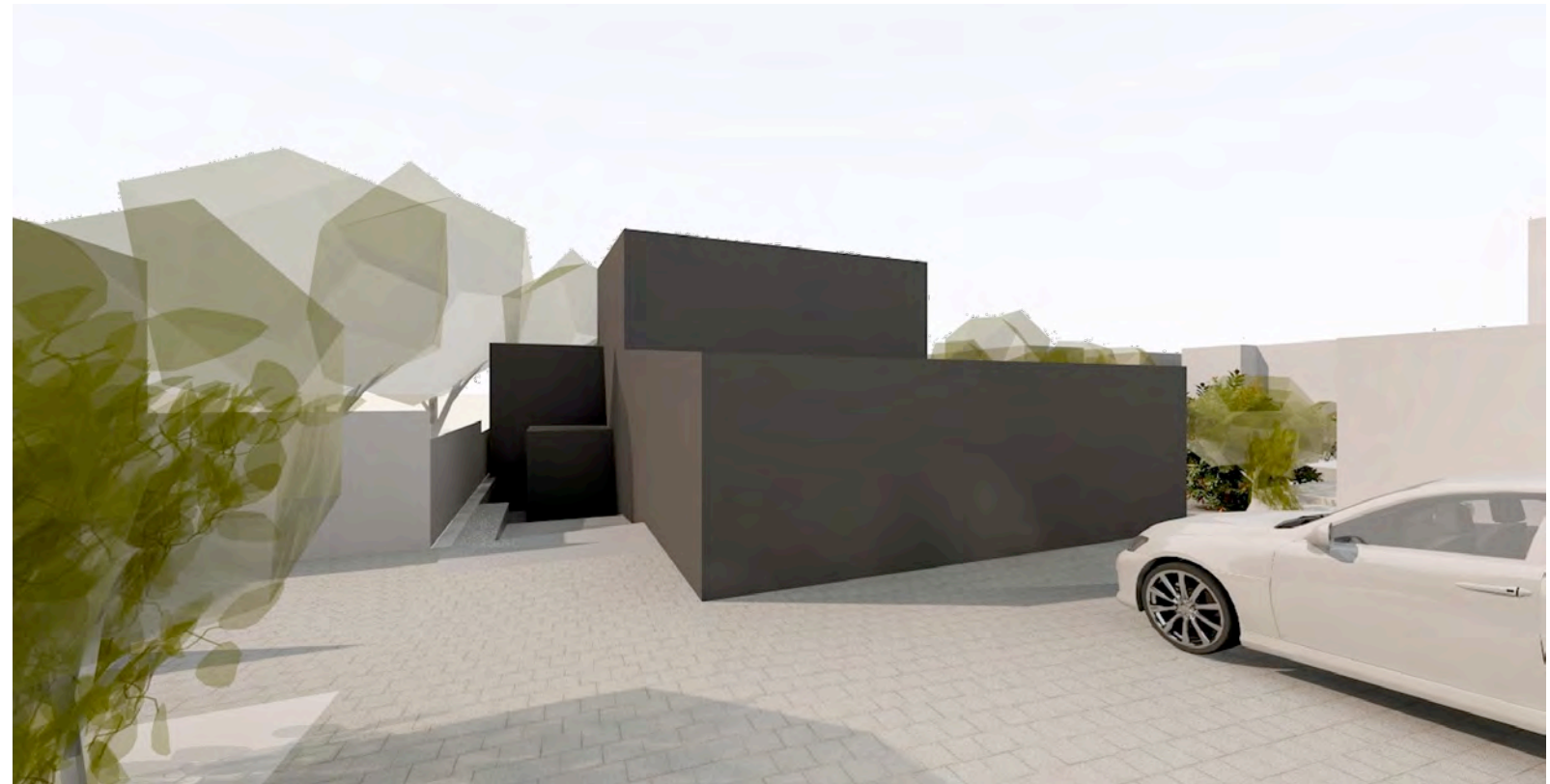

View of proposed from entrance driveway adjacent to no.5

