

PROPOSED GROUND FLOOR PLAN

May 2016

1:50

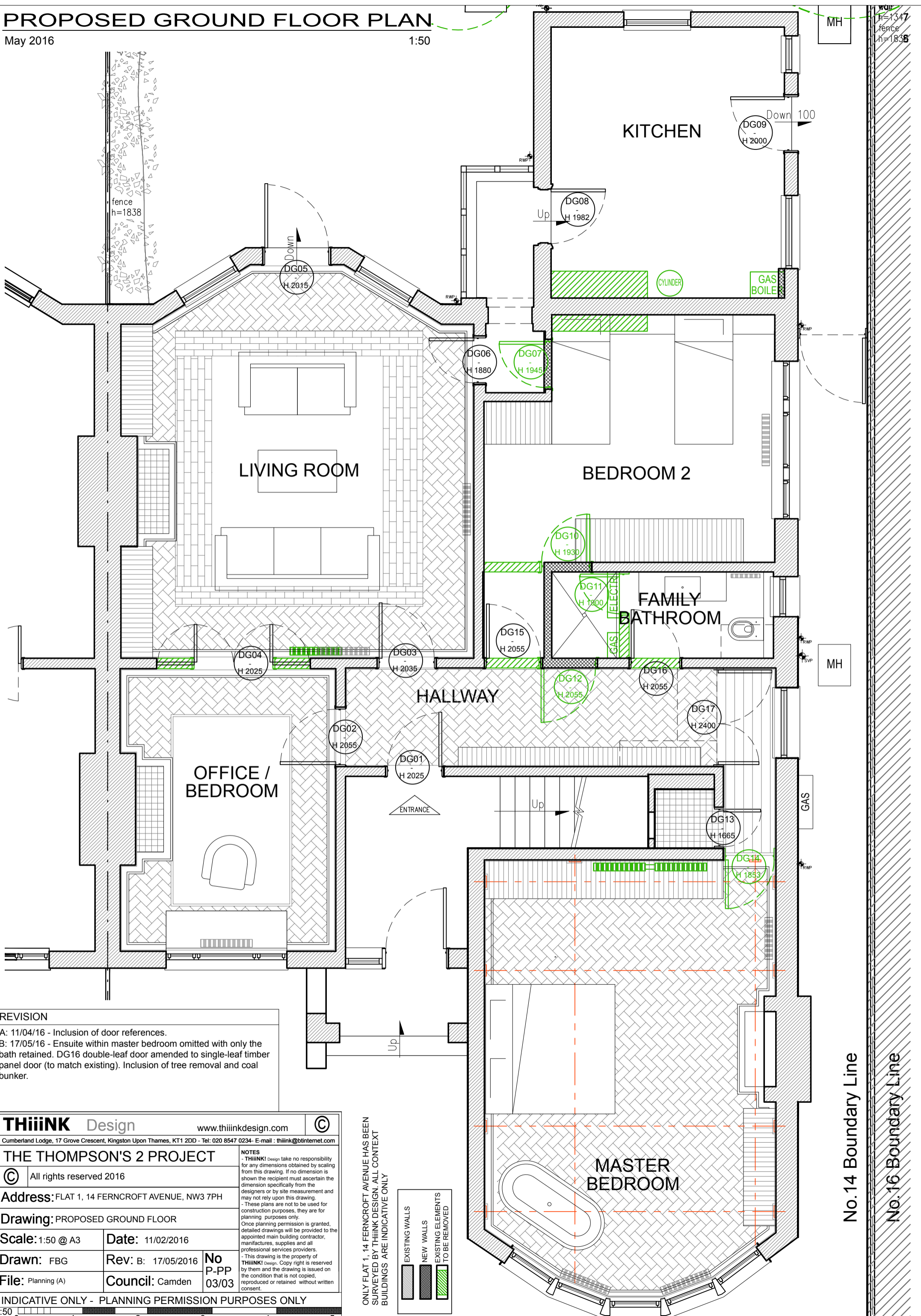

REVISION
A: 11/04/16 - Inclusion of door references.
B: 17/05/16 - Ensuite within master bedroom omitted with only the bath retained. DG16 double-leaf door amended to single-leaf timber panel door (to match existing). Inclusion of tree removal and coal bunker.

THiiNK Design www.thiinkdesign.com		©	
Cumberland Lodge, 17 Grove Crescent, Kingston Upon Thames, KT1 2DD - Tel: 020 8547 0234 - E-mail: thiink@btinternet.com			
THE THOMPSON'S 2 PROJECT			
© All rights reserved 2016			
Address: FLAT 1, 14 FERNCROFT AVENUE, NW3 7PH			
Drawing: PROPOSED GROUND FLOOR			
Scale: 1:50 @ A3	Date: 11/02/2016		
Drawn: FBG	Rev: B: 17/05/2016	No P-PP 03/03	
File: Planning (A)	Council: Camden		
INDICATIVE ONLY - PLANNING PERMISSION PURPOSES ONLY			

NOTES
 - THiiNK! Design take no responsibility for any dimensions obtained by scaling from this drawing. If no dimension is shown the recipient must ascertain the dimension specifically from the designers or by site measurement and may not rely upon this drawing.
 - These plans are not to be used for construction purposes, they are for planning purposes only.
 Once planning permission is granted, detailed drawings will be provided to the appointed main building contractor, manufacturers, suppliers and all professional services providers.
 This drawing is the property of THiiNK! Design. Copy right is reserved by them and the drawing is issued on the condition that is not copied, reproduced or retained without written consent.

ONLY FLAT 1, 14 FERNCROFT AVENUE HAS BEEN SURVEYED BY THiiNK! DESIGN. ALL CONTEXT BUILDINGS ARE INDICATIVE ONLY

