

All dimensions to be verified on site by Main Contractor before the start of any shop drawings or work whatsoever either on their own behalf or that of sub-contractors.

Report any discrepancies to the Contract Administrator at once.  
This drawing is to be read with all relevant Architect's and Engineer's drawings and other relevant information.

© Ingleton Wood LLP

LEGEND: DO NOT SCALE

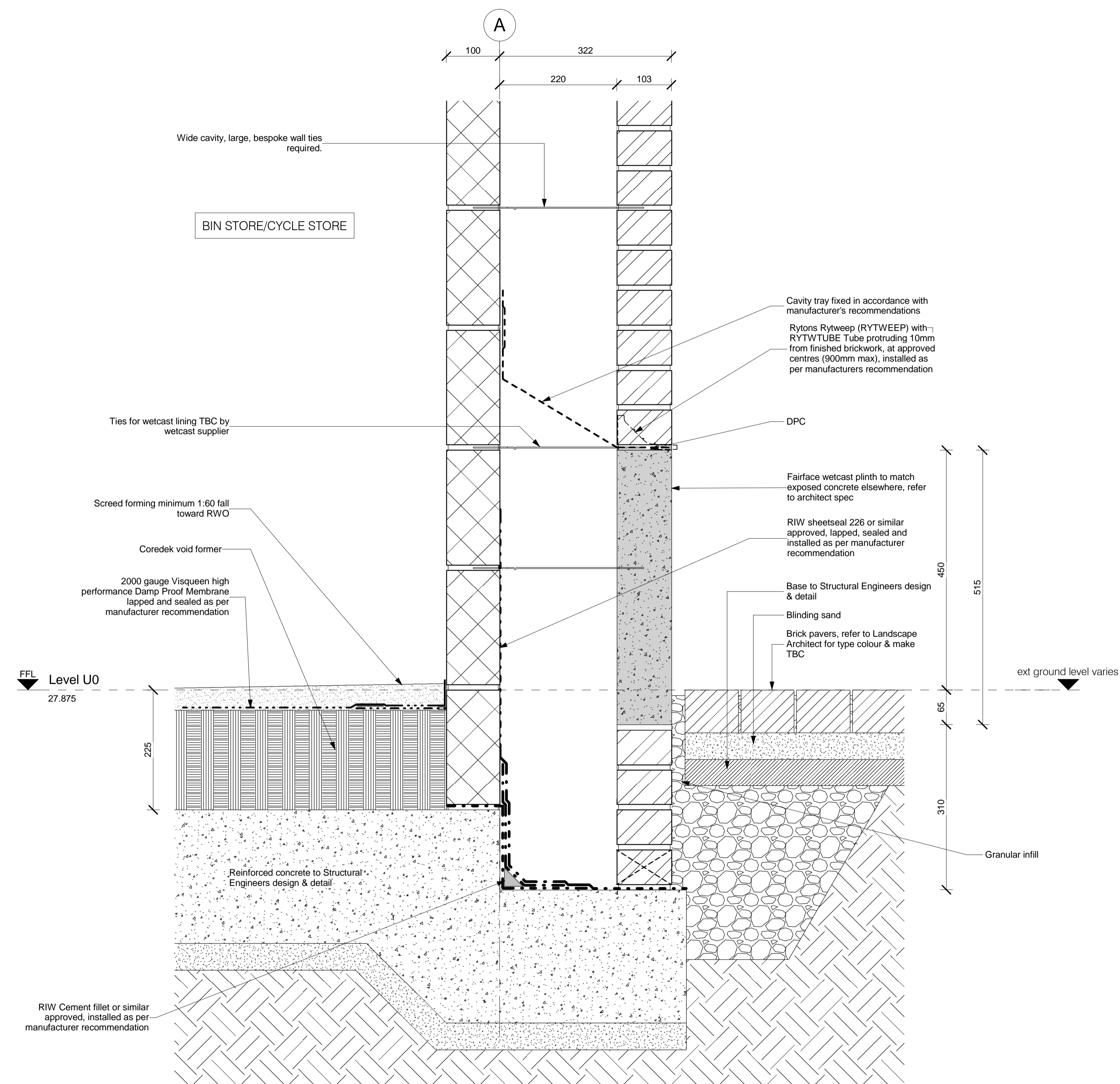

1 External Ground Floor Footing Detail - Bin Store/Cycle Store  
1:5

B	22.04.16	Drawings & annotation amended.	RB	JR
A	29.03.16	First Issue	RB/ET	JR
Rev:	Date:	Description:	Chk:	Apr:
Scale @ A1:		Issuing Office:	Project No:	
1:5		London	84923	
Status: Purpose of Issue:				

**Ingleton Wood**  
Vision, form and function

London  
1 Alie Street  
London E1 8DE  
T: 020 7680 4400  
www.ingletonwood.co.uk

**Billericay**  
**Cambridge**  
**Colchester**  
**London**  
**Norwich**

Project:  
Regents Park Estate  
Plot 1 - Robert Street Car Park  
London  
NW1 3JS

Drawing Title:  
Ground Floor Details - Sheet 05

Client:  
Lovell Partnership Ltd.