

1 Section of Ground Floor Detail (Stretcher Bond) @ Commercial Bins
1:5

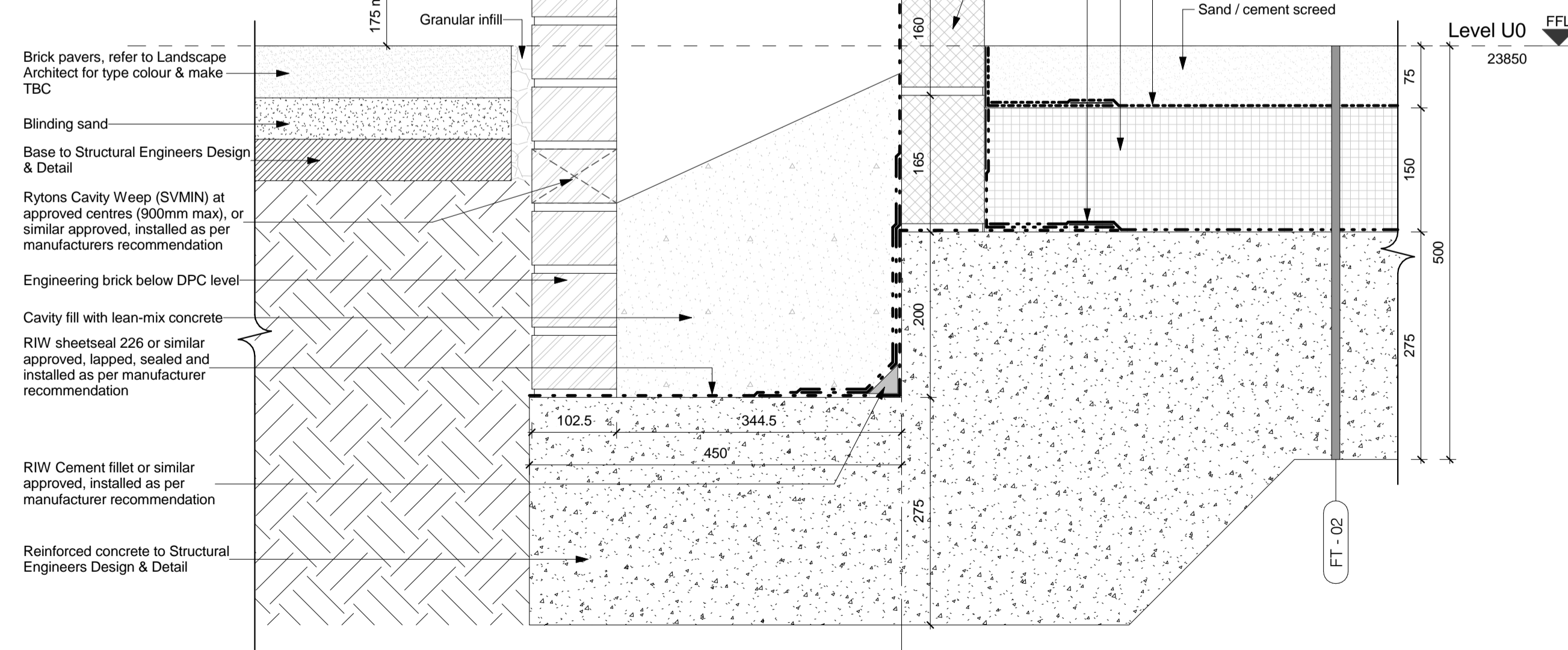

2 Section of Ground Floor Detail (Stretcher Bond) @ Residential Bins
1:5

Masonry Wall Tie Spacing		
	Horizontal Spacing	Vertical Spacing
Distance along wall	Max. 900mm	Max. 450mm
Distance from Openings, Roof Verges, Movement Joints	Max. 225mm	Max. 300mm

Note: Wall ties along wall may correspond to table above or alternatively be spaced such as not to be less than 2.5 ties/m². Wall ties to be installed to manufacturer instructions

ALL JUNCTIONS BETWEEN INTERNAL CEILING & INTERNAL WALLS AND PENETRATIONS IN AIR BARRIER TO BE SEALED WITH FLEXIBLE SEALANT.
ALL PLASTERBOARD JOINT LOCATIONS TO BE TAPED AND JOINT FINISH.
ALL PLASTERBOARD ON DABS TO HAVE CONTINUOUS RIBBON OF ADHESIVE AROUND ALL OPENINGS, ALONG TOP AND BOTTOM OF WALL, AND AT INTERNAL AND EXTERNAL CORNERS.
DETAILS TO BE READ IN CONJUNCTION WITH SECTIONS & GA PLANS - REFER TO SUITABLE PLASTERBOARD TYPE.

NOTE
Wall tie setouts shown indicatively. Set outs & distances between ties to be installed as per manufacturer instructions

PROPOSED U-VALUE TO ACHIEVE	
Ground Floor	0.11 W/m ² .K
External Wall - Brickwork with Mastic	0.10 W/m ² .K
External Wall - Brickwork with Blockwork	0.11 W/m ² .K
Separating Walls: Flat / Communal Areas	TBC
Separating Walls: Flat / Lift Shaft	TBC
Separating Walls: Flat / Flat Party Walls	0.0*
Roof	0.11 W/m ² .K
External Opaque Doors	1.0 W/m ² .K
External Windows	1.5 W/m ² .K (g-value of 0.63)
External Glazed Doors	1.5 W/m ² .K (g-value of 0.63)
AIR PERMEABILITY	4m ³ /m ² .h

* Cavities to be fully filled with mineral wool

All dimensions to be verified on site by Main Contractor before the start of any shop drawings or work whatsoever either on their own behalf or that of sub-contractors.
Report any discrepancies to the Contract Administrator at once.
This drawing is to be read with all relevant Architect's and Engineer's drawings and other relevant information.
© Ingleton Wood LLP

LEGEND: DO NOT SCALE

GENERAL NOTES
This drawing should be read in conjunction with all relevant consultants drawings and specifications.
Setting out dimensions and sizing of all RC elements should be taken from structural engineer's drawings and documentation.

EXTERNAL & INTERNAL WALL SYMBOLS

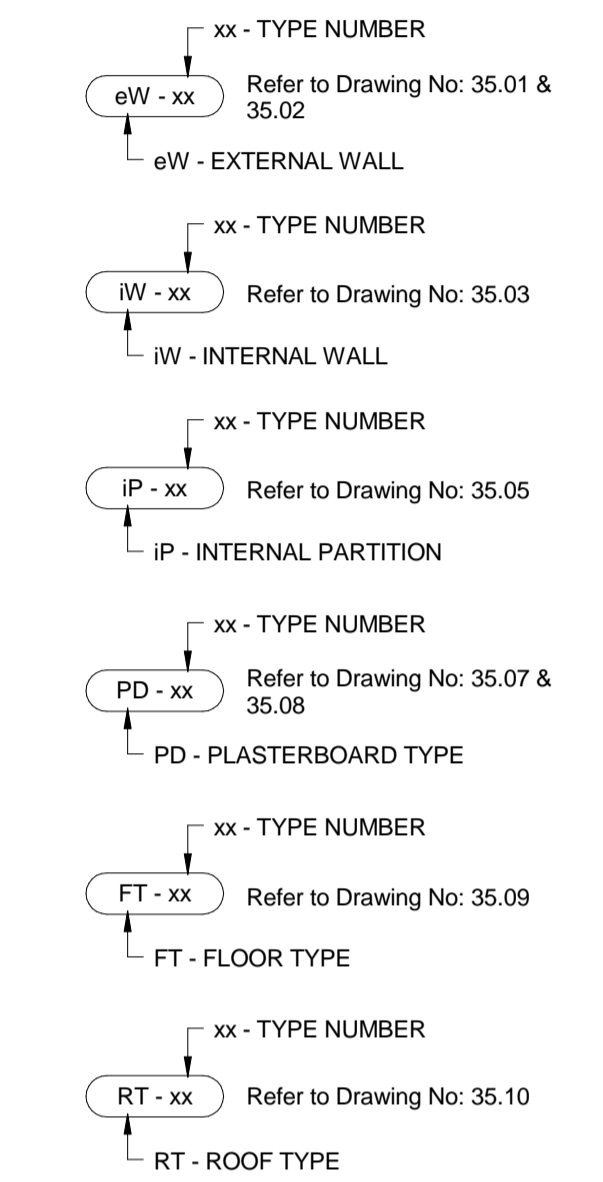

Rev	Date	Description	Chk	Apr
C	13.05.16	OPM changed to gas membrane	XP	JR
B	22.01.16	Construction Issue	XP	JR
A	24.03.16	First Issue	XP	JR

Scale @ A1: 1:5
Issuing Office: London
Project No: 84923
Status: S4
Purpose of Issue: Construction

Ingleton Wood
Vision, form and function
London
1 Alie Street
London E1 8DE
T: 020 7680 4400
www.ingletonwood.co.uk

Project:
Regents Park Estate
Plot 4 - Newlands
Hampstead Road
London NW1 2PS

Drawing Title:
Ground Floor Details - Sheet 03

Client:
Lovell Partnership Ltd.

File Ref:
NL - IW - XX - ZZ - DR - A - 35.13
Revision:
C