

1 Section of 'Bridge Slot' Juliet balcony sill detail @ South Elevation (1st Floor)
1 : 5

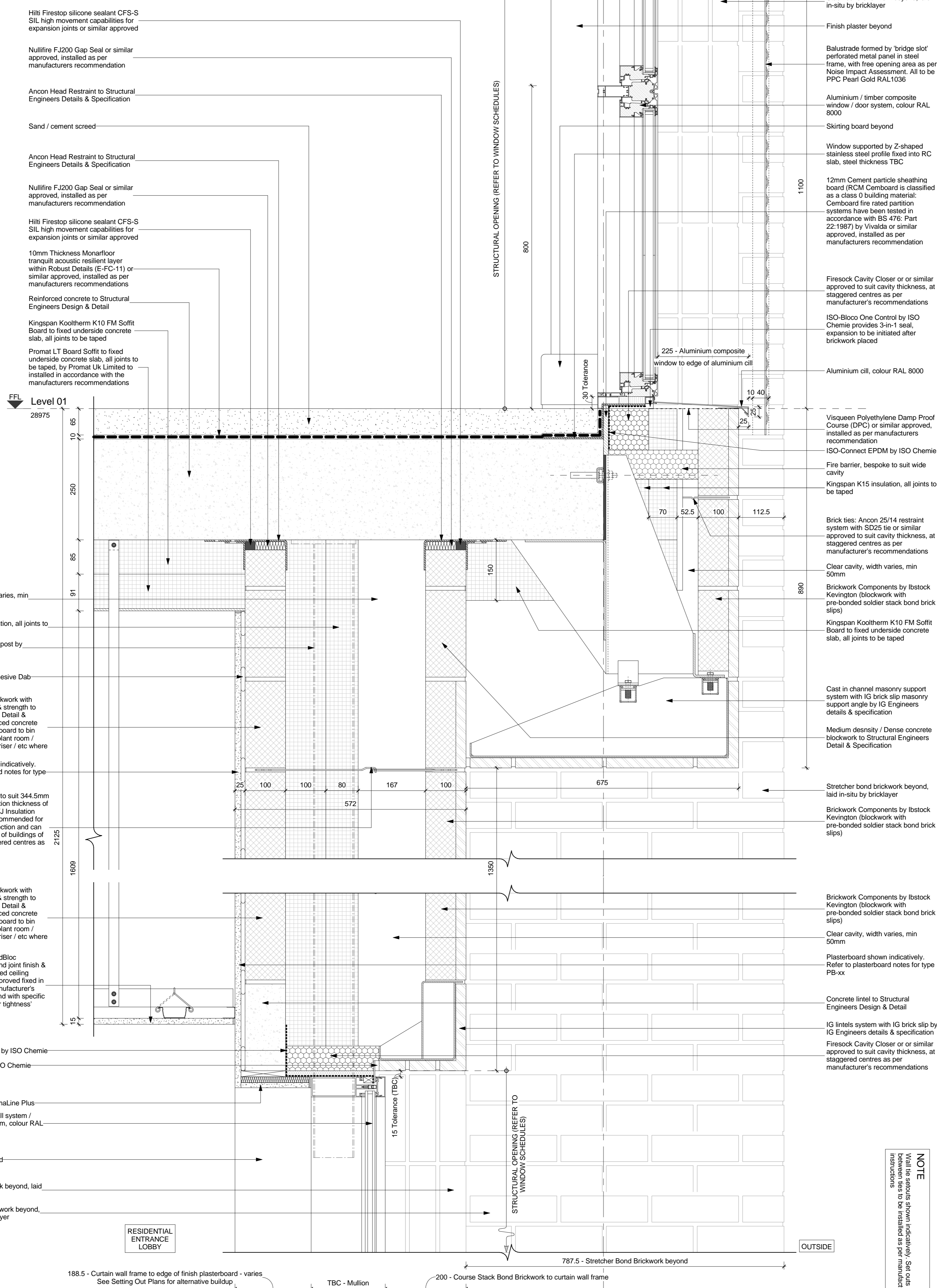

Hilti Firestop silicone sealant CFS-S SIL high movement capabilities for expansion joints or similar approved

Nullifire FJ200 Gap Seal or similar approved, installed as per manufacturers recommendation

Ancon Head Restraint to Structural Engineers Details & Specification

Sand / cement screed

Ancon Head Restraint to Structural Engineers Details & Specification

Nullifire FJ200 Gap Seal or similar approved, installed as per manufacturers recommendation

Hilti Firestop silicone sealant CFS-S SIL high movement capabilities for expansion joints or similar approved

10mm Thickness Monarfloor tranquil acoustic resilient layer within Robust Details (E-FC-11) or similar approved, installed as per manufacturers recommendations

Reinforced concrete to Structural Engineers Design & Detail

Kingspan Kooltherm K10 FM Soffit Board to fixed underside concrete slab, all joints to be taped

Promat LT Board Soffit to fixed underside concrete slab, all joints to be taped, by Promat UK Limited to installed in accordance with the manufacturers recommendations

Level 01
28975

85
250
58
16
2125
1693
5

Clear cavity, width varies, min 50mm

Kingspan K15 insulation, all joints to be taped

Curtain wall support post by manufacturer

Gyproc Dri-Wall Adhesive Dab

Dense concrete blockwork with 1850kg/m² density & strength to Structural Engineers Detail & Specification (fair-faced concrete block and no plasterboard to bin store / cycle store / plant room / water tank / service riser / etc where blockwork exposed)

Plasterboard shown indicatively. Refer to plasterboard notes for type PB-xx

Ancon Two-Part Tie to suit 344.5mm cavity with an insulation thickness of 175mm. The black T.I Insulation Retaining Clip is recommended for use with the inner section and can be used for all types of buildings of any height, at staggered centres as per manufacturer's recommendations

Dense concrete blockwork with 1850kg/m² density & strength to Structural Engineers Detail & Specification (fair-faced concrete block and no plasterboard to bin store / cycle store / plant room / water tank / service riser / etc where blockwork exposed)

15mm Gyproc SoundBloc plasterboard, tape and joint finish & Gyproc MF suspended ceiling system or similar approved fixed in accordance with manufacturer's recommendations and with specific regard to 'lift and air tightness' considerations

ISO-Connect EPDM by ISO Chemie

ISO-Bloco 600 by ISO Chemie

27mm Gyproc ThermaLine Plus

Reynaers curtain wall system / Vision 50 door system, colour RAL 8000

Finish plaster beyond

Stack bond brickwork beyond, laid in-situ by bricklayer

Stretcher bond brickwork beyond, laid in-situ by bricklayer

RESIDENTIAL ENTRANCE LOBBY

188.5 - Curtain wall frame to edge of finish plasterboard - varies See Setting Out Plans for alternative build up

TBC - Mullion

200 - Course Stack Bond Brickwork to curtain wall frame

115.5 - Window frame to edge of finish plasterboard - varies See Setting Out Plans for alternative build up

149

200 - Course Stack Bond Brickwork to aluminium composite window

112.5 - Stretcher Bond Brickwork beyond

OUTSIDE

Stretcher bond brickwork beyond, laid in-situ by bricklayer

Stack bond brickwork beyond, laid in-situ by bricklayer

Finish plaster beyond

Balustrade formed by 'bridge slot' perforated metal panel in steel frame, with free opening area as per Noise Impact Assessment. All to be PPC Pearl Gold RAL1036

Aluminium / timber composite window / door system, colour RAL 8000

Skirting board beyond

Window supported by Z-shaped stainless steel profile fixed into RC slab, steel thickness TBC

1001

12mm Cement particle sheathing board (RCM Cemboard is classified as a class 0 building material: Cemboard fire rated partition systems have been tested in accordance with BS 476: Part 22:1987) by Vivalda or similar approved, installed as per manufacturers recommendation

Firesock Cavity Closer or similar approved to suit cavity thickness, at staggered centres as per manufacturer's recommendations

ISO-Bloco One Control by ISO Chemie provides 3-in-1 seal, expansion to be initiated after brickwork placed

Aluminium cill, colour RAL 8000

225 - Aluminium composite window to edge of aluminium cill

30 Tolerance

10 40

25

70 52.5 100 112.5

688

Visqueen Polyethylene Damp Proof Course (DPC) or similar approved, installed as per manufacturers recommendation

ISO-Connect EPDM by ISO Chemie

Fire barrier, bespoke to suit wide cavity

Kingspan K15 insulation, all joints to be taped

Brick ties: Ancon 25/14 restraint system with SD25 tie or similar approved to suit cavity thickness, at staggered centres as per manufacturer's recommendations

Clear cavity, width varies, min 50mm

Brickwork Components by Ibstock Kevington (blockwork with pre-bonded soldier stack bond brick slips)

Kingspan Kooltherm K10 FM Soffit Board to fixed underside concrete slab, all joints to be taped

Cast in channel masonry support system with IG brick slip masonry support angle by IG Engineers details & specification

Medium density / Dense concrete blockwork to Structural Engineers Detail & Specification

675

1350

15 Tolerance (TBC)

STRUCTURAL OPENING (REFER TO WINDOW SCHEDULES)

787.5 - Stretcher Bond Brickwork beyond

OUTSIDE

STRUCTURAL OPENING (REFER TO WINDOW SCHEDULES)

800

70

52.5

100

112.5

688

Brickwork Components by Ibstock Kevington (blockwork with pre-bonded soldier stack bond brick slips)

Clear cavity, width varies, min 50mm

Plasterboard shown indicatively. Refer to plasterboard notes for type PB-xx

Concrete lintel to Structural Engineers Design & Detail

IG lintels system with IG brick slip by IG Engineers details & specification

Firesock Cavity Closer or similar approved to suit cavity thickness, at staggered centres as per manufacturer's recommendations

Stretcher bond brickwork beyond, laid in-situ by bricklayer

Brickwork Components by Ibstock Kevington (blockwork with pre-bonded soldier stack bond brick slips)

Clear cavity, width varies, min 50mm

Plasterboard shown indicatively. Refer to plasterboard notes for type PB-xx

ISO-Connect EPDM by ISO Chemie

ISO-Bloco 600 by ISO Chemie

27mm Gyproc ThermaLine Plus

Reynaers curtain wall system / Vision 50 door system, colour RAL 8000

Finish plaster beyond

Stack bond brickwork beyond, laid in-situ by bricklayer

Stretcher bond brickwork beyond, laid in-situ by bricklayer

188.5 - Curtain wall frame to edge of finish plasterboard - varies See Setting Out Plans for alternative build up

TBC - Mullion

200 - Course Stack Bond Brickwork to curtain wall frame

787.5 - Stretcher Bond Brickwork beyond

OUTSIDE

Masonry Wall Tie Spacing

Distance along wall	Horizontal Spacing	Vertical Spacing
Openings, Roof Verges, Movement Joints	Max. 900mm	Max. 450mm
	Max. 225mm	Max. 300mm

Note: Wall ties along wall may correspond to table above or alternatively be spaced such as not to be less than 2.5 times. Wall ties to be installed to manufacturer instructions

ALL JUNCTIONS BETWEEN INTERNAL CEILING & INTERNAL WALLS AND PENETRATIONS IN AIR BRICKS TO BE SEALED WITH EASY SEALANT. ALL PLASTERBOARD JOINT LOCATIONS TO BE TAPED AND JOINT FINISH.

ALL PLASTERBOARD ON DABS TO HAVE CONTINUOUS BEBON OF ADHESIVE AROUND ALL OPENINGS, ALONG TOP AND BOTTOM OF WALL AND AT INTERNAL AND EXTERNAL CORNERS. DETAILS TO BE READ IN CONJUNCTION WITH SECTIONS & GA PLANS - REFER TO SUITABLE PLASTERBOARD TYPE.

NOTE

Wall tie secure shown indicatively. Set outs & distances between ties to be installed as per manufacturer instructions

GENERAL NOTES

This drawing should be read in conjunction with all relevant consultant drawings and specifications. Elements should be taken from structural engineer's drawings and documentation.

Setting out dimensions and sizing of all RC elements should be taken from structural engineer's drawings and documentation.

DO NOT SCALE

PROPOSED U-VALUE TO ACHIEVE

Ground Floor	0.11 W/m ² K
External Wall - Brickwork with Mastic	0.10 W/m ² K
External Wall - Brickwork with Blockwork	0.11 W/m ² K
Separating Walls: Fair / Commercial Areas	TBC
Separating Walls: Fair / Lift Shaft	TBC
Separating Walls: Fair / Flat Party Walls	0.0*
Roof	0.11 W/m ² K
External Oblique Doors	1.0 W/m ² K
External Windows	1.3 W/m ² K (g-value of 0.63)
External Glazed Doors	1.5 W/m ² K (g-value of 0.63)
AIR PERMEABILITY	4m ³ /m ² h

* Confirms to be fully filled with mineral wool

Revision Table:

No.	Description	By	Check	Date
1	As Issued

Scale: 1 : 5

Project: 84923

Site: Construction

Ingleton Wood

Vision, form and function

London

1 Aisle Street
London, E1 8DE

London, E1 8DE

London, E1 8DE

London, NW1 2PS

Project: Regents Park Estate
Plot 4 - Newlands
Hampstead Road
London NW1 2PS

Client: Lovell Partnership Ltd.

External Window & Door details - Sheet 11

File No: NL-IV-XX-ZZ-DR-A-35181

Revision: A