

Section B-B'
Scale 1:50

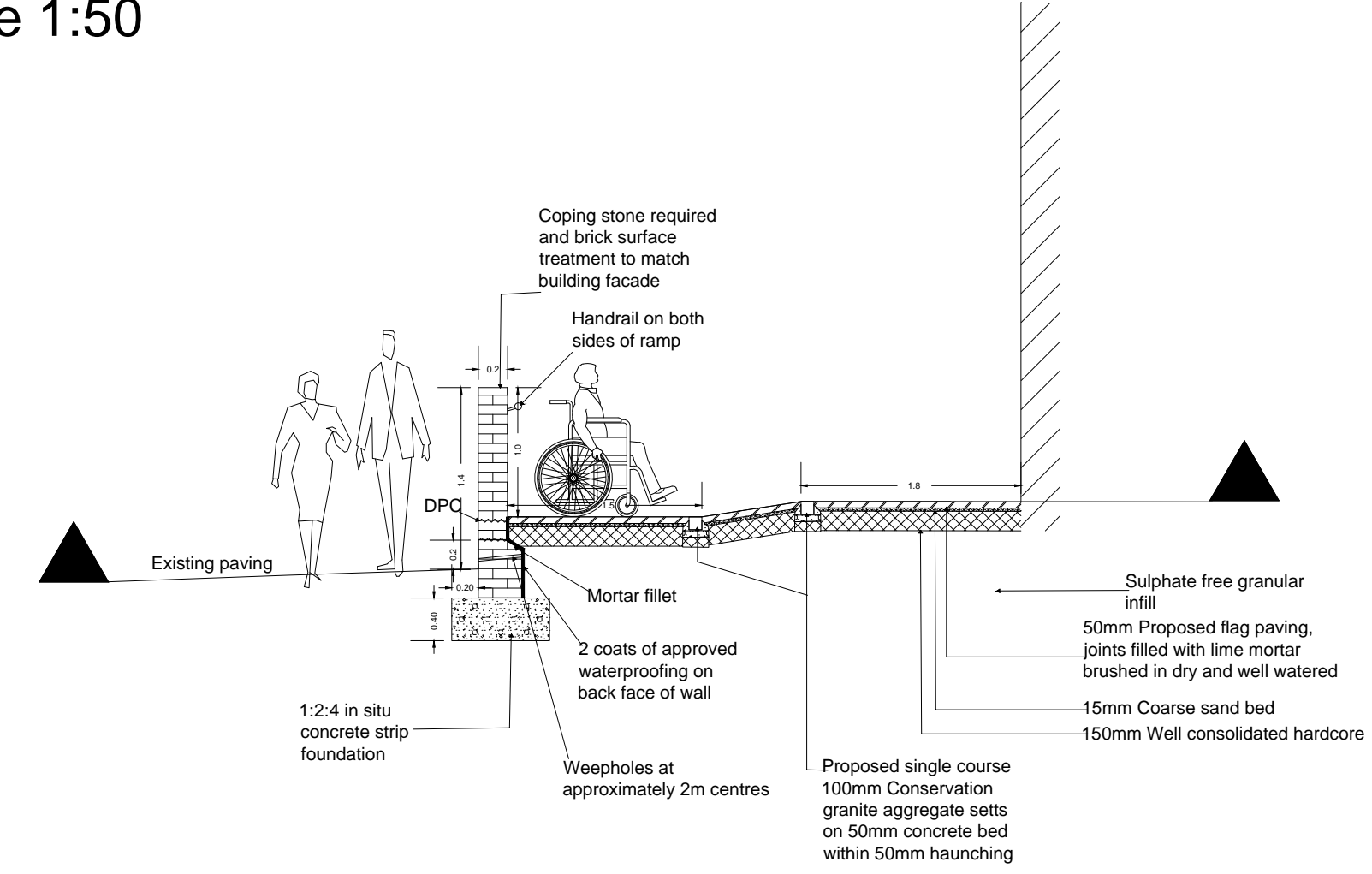

Section C-C'
Scale 1:50

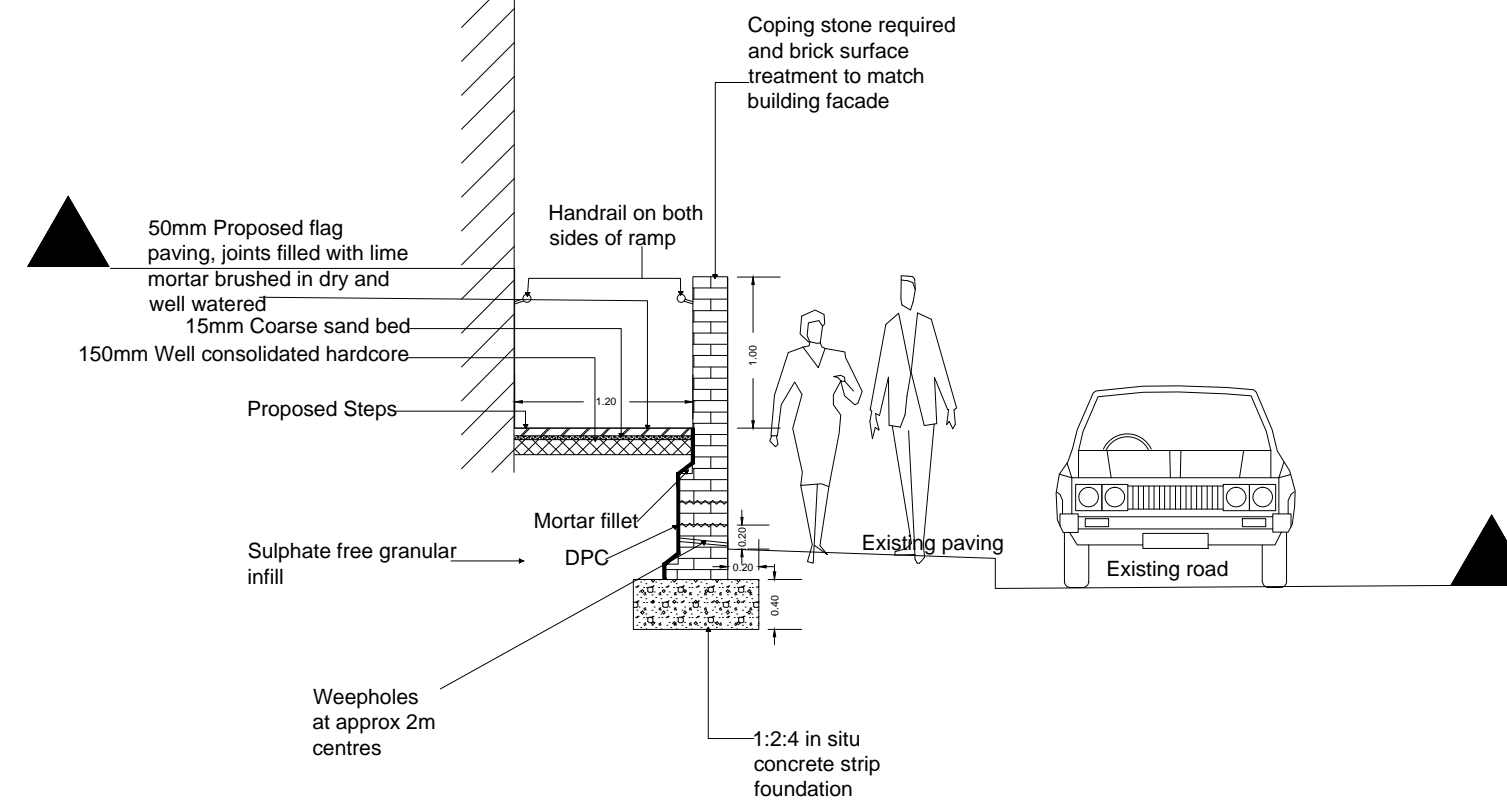

Section D-D'
Scale 1:50

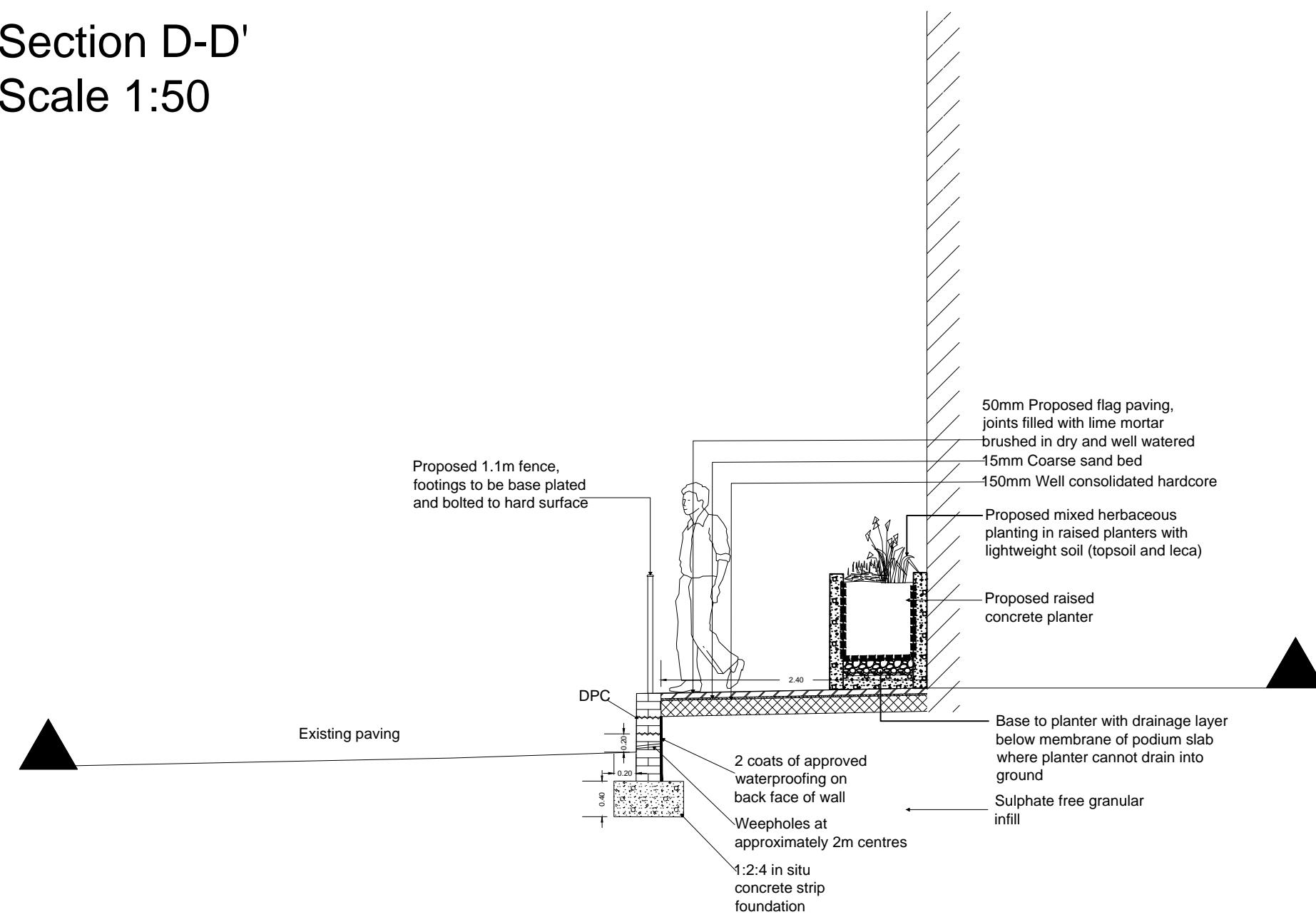

Section E-E'
Scale 1:50

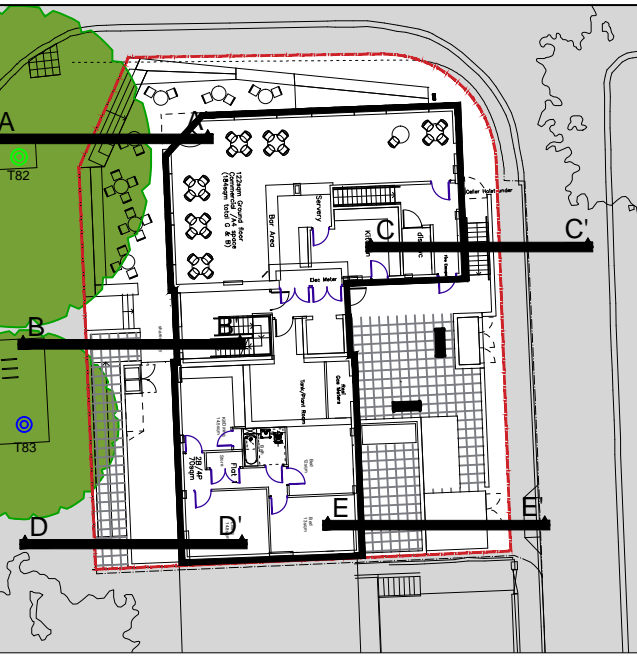
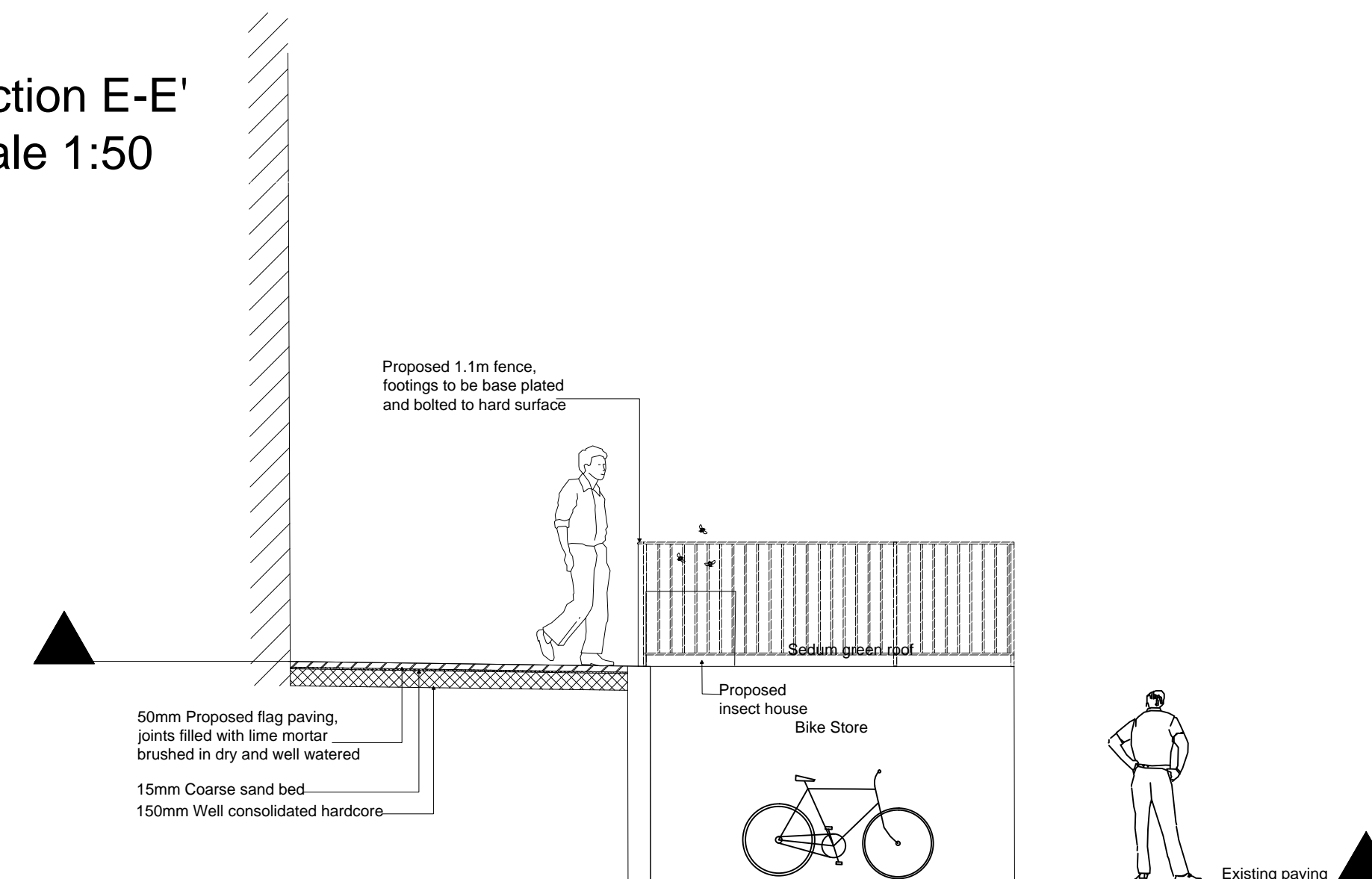

Cross section location plan



Rev	Date	Details	Drawn
C	11.05.16	Amend planter details	JS
B	08.04.16	Client comments	JS
A	26.02.16	VE updates	JS

ACD
ENVIRONMENTAL

Ecology
Arborealiculture
Landscape Architecture

ACD at these offices:
Rodbourne Rail Business Centre, Grange Lane,
Malmesbury, SN16 0ES
Tel: 01666 825646
Courtney House, Mill Lane, Godalming, GU7 1EY
Tel: 01483 425714
Suite 6, Crescent House, Yonge Close, Eastleigh, SO50 9SX
Tel: 02382 026 300
email: mail@acdenv.co.uk
www.acdenvironmental.co.uk

Lovell Partnerships Limited

scheme: Regent's Park Estates
The Victory Pub
client: Lovell Partnerships Ltd
drawing: Cross Sections
date: December 2015
scale: 1:50@A1
drawing no: LOV20038-13C
drawn: JNT checked: JS

Copyright of ACD Environmental Ltd. All rights described in Chapter IV of the Copyright, Designs and Patents Act 1988 have been generally asserted: 2011. Copyright of this plan remains with ACD until all fees have been paid in full.