

Note

All drawings to be read in conjunction with architects and engineer's drawings, relevant details, planting and material schedules, specifications and manufacturer's details.

The accuracy of the survey base drawing is dependent upon the scale at which it is produced. Users should not re-scale this drawing without consent.
DO NOT SCALE OFF DRAWING

Tx
Refer to arboricultural tree survey schedules for detail on existing trees

Redline to be verified by LB Camden. It is assumed that the contractor will carry out works on the Highways under a section 278 agreement to ensure a high quality project with consistency of materials and detailing.

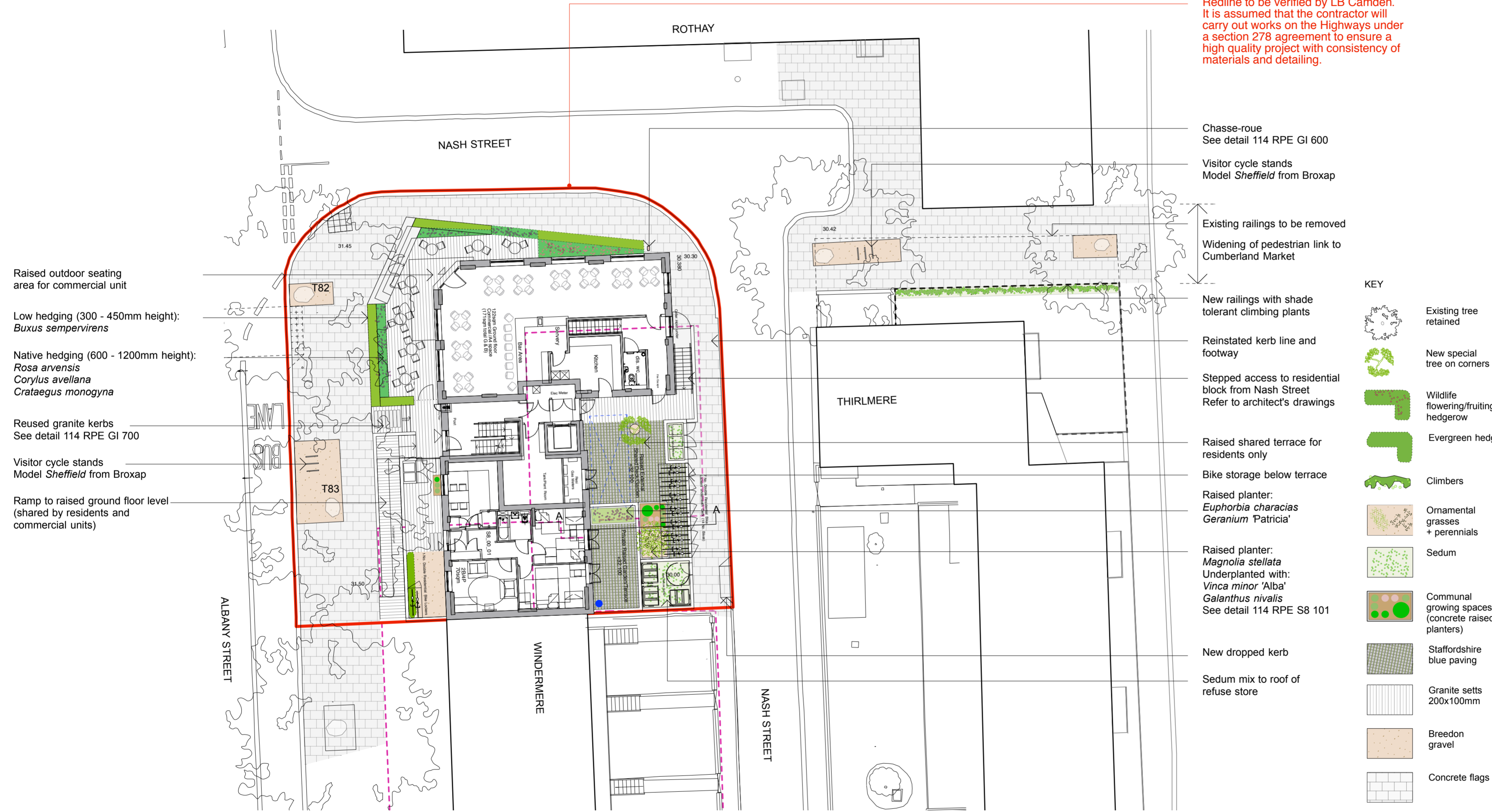

- Raised outdoor seating area for commercial unit
- Low hedging (300 - 450mm height): *Buxus sempervirens*
- Native hedging (600 - 1200mm height): *Rosa arvensis*, *Corylus avellana*, *Crataegus monogyna*
- Reused granite kerbs See detail 114 RPE GI 700
- Visitor cycle stands Model *Sheffield* from Broxap
- Ramp to raised ground floor level (shared by residents and commercial units)

- Chasse-roue See detail 114 RPE GI 600
- Visitor cycle stands Model *Sheffield* from Broxap
- Existing railings to be removed
- Widening of pedestrian link to Cumberland Market
- New railings with shade tolerant climbing plants
- Reinstated kerb line and footway
- Stepped access to residential block from Nash Street Refer to architect's drawings
- Raised shared terrace for residents only
- Bike storage below terrace
- Raised planter: *Euphorbia characias*, *Geranium 'Patricia'*
- Raised planter: *Magnolia stellata* Underplanted with: *Vinca minor 'Alba'*, *Galanthus nivalis* See detail 114 RPE S8 101
- New dropped kerb
- Sedum mix to roof of refuse store

KEY

- Existing tree retained
- New special tree on corners
- Wildlife flowering/fruited hedgerow
- Evergreen hedges
- Climbers
- Ornamental grasses + perennials
- Sedum
- Communal growing spaces (concrete raised planters)
- Staffordshire blue paving
- Granite setts 200x100mm
- Breedon gravel
- Concrete flags
- Reused granite kerbs 300mm wide
- Chasse-roue (reused bollard)
- Highway boundaries
- Stormwater alteration tank
- Water butt

REVISIONS

DATE	REV	NOTES
26/06/15	A	Amended project boundary line
14/08/15	B	Extended drawing

East Architecture landscape urban design
Unit 8
49-59 Old Street
London EC1V 9HX
T 020 7490 3190
E mail@east.uk.com
www.east.uk.com

PROJECT
Regent's Park Estate

CLIENT
LB Camden

DRAWING STATUS
STAGE 3

DATE
August 2015

SCALE
1:200

SIZE
A2

REV
B

DRAWING TITLE
Proposed site plan
Plot 8 / The Victory pub

DRAWING NR
114 RPE S8 100