

Slope difference of floors front to rear diagonally SW to NE corners on reception floor level 170mm drop. 22mm of settlement drop has happened since monitoring began in 1985.

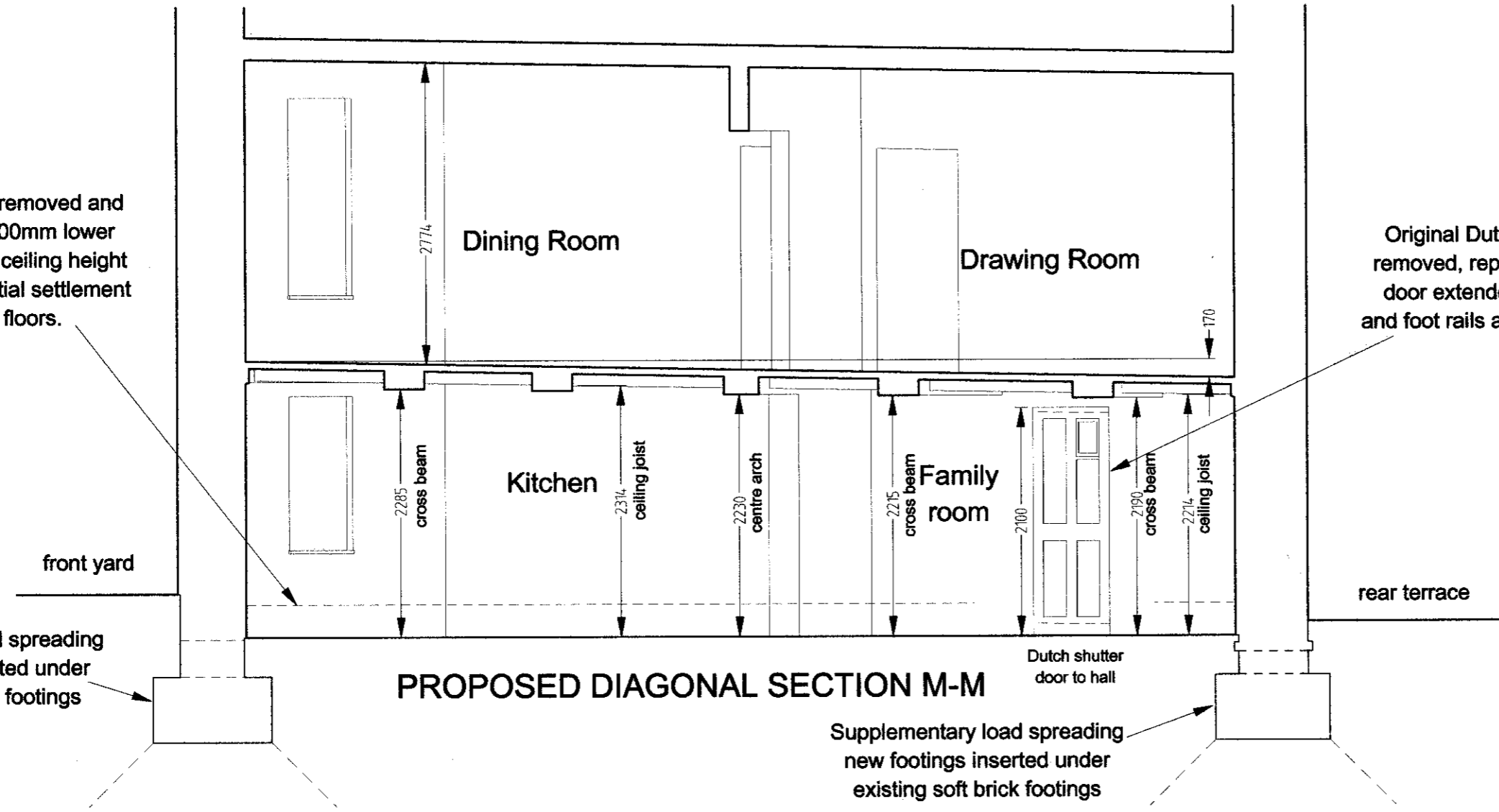

Concrete floor removed and replaced at -300mm lower level to restore ceiling height lost due differential settlement of upper floors.

Original Dutch shutter door and lining frame removed, repaired and replaced 170mm lower. door extended top and bottom to repair head and foot rails and frame extended at foot 130mm.

Supplementary load spreading new footings inserted under existing soft brick footings

Supplementary load spreading new footings inserted under existing soft brick footings

**EXISTING & PROPOSED
DIAGONAL SECTIONS M-M**
44 Downshire Hill, London NW3 1NU
1:50 9 May 2016 53036-2
Claymore Design & Build
copyright 2016