

Rydon

Received	Initial	Date
RYDON	RA	25 Jan 16
Client		
Status A – No Comments		<input checked="" type="checkbox"/>
Status B – Comments, Revise & Resubmit		<input type="checkbox"/>
Status C – Rejected		<input type="checkbox"/>
For Information Only		<input type="checkbox"/>

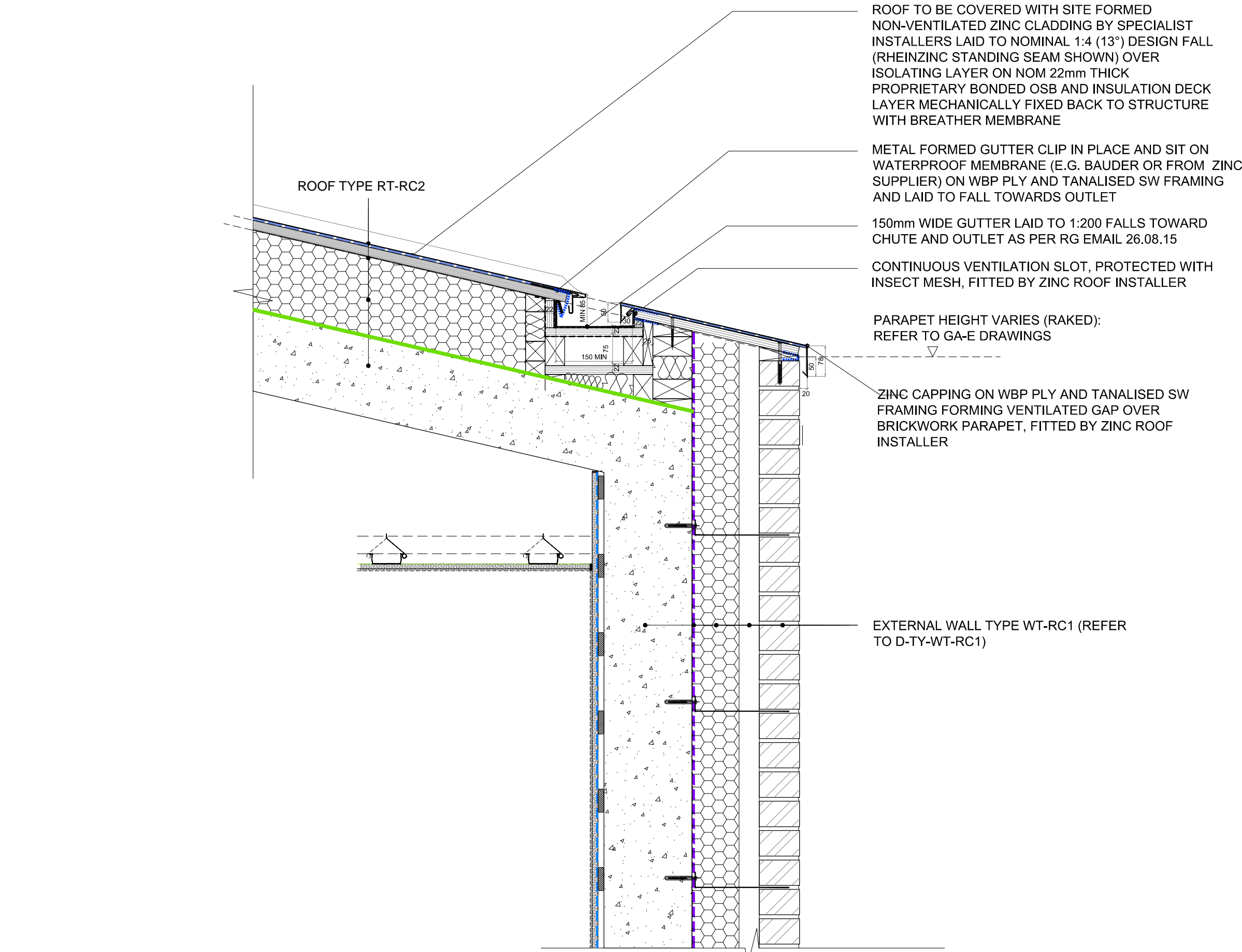

DETAIL - Block C - D-J-RC213 - Cat Ladder head fixing (L08 GL H-08)

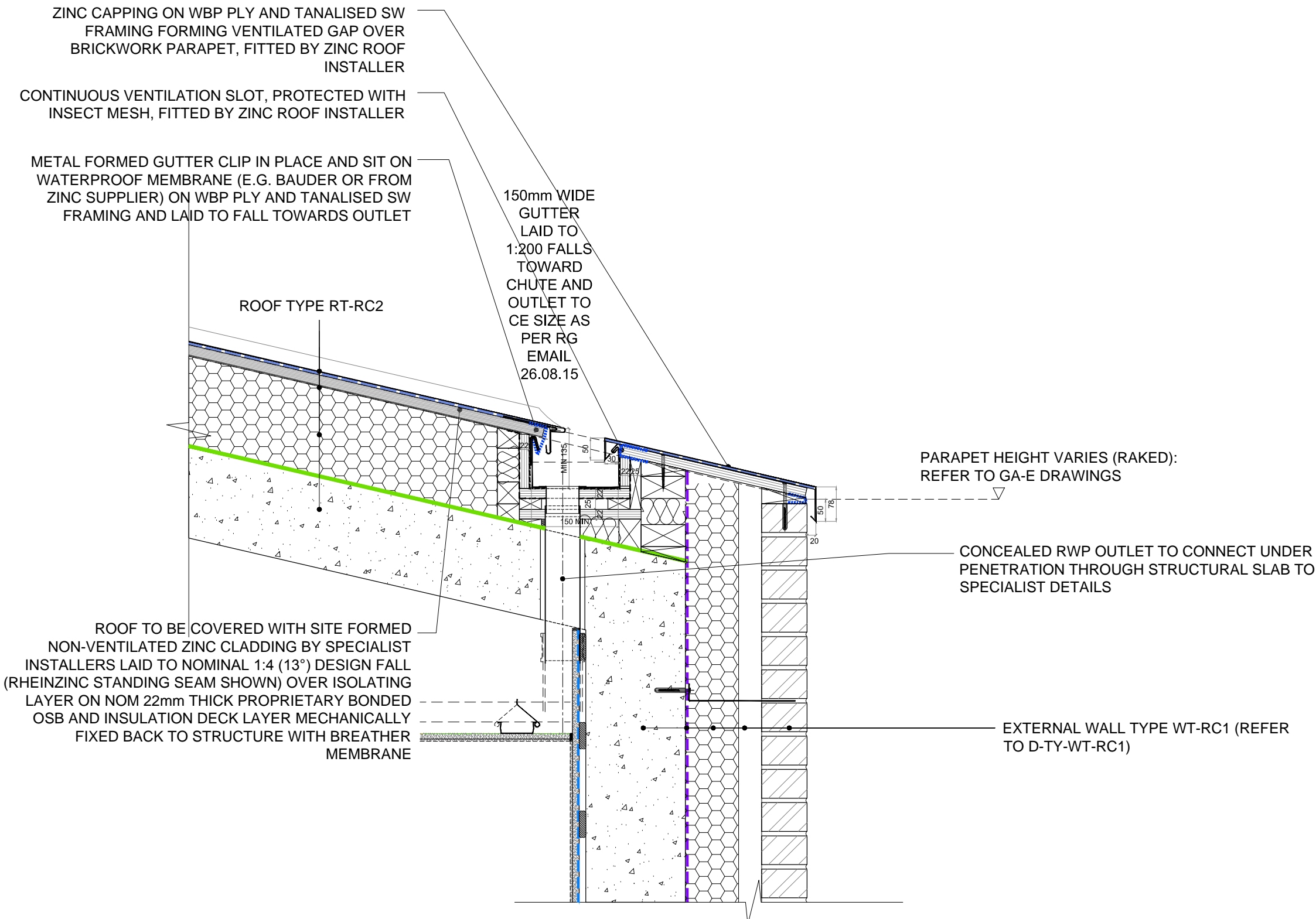

DETAIL - Block C - D-J-RC214 - Box Gutter Concealed RWP Outlet (L08 GL F1-08)

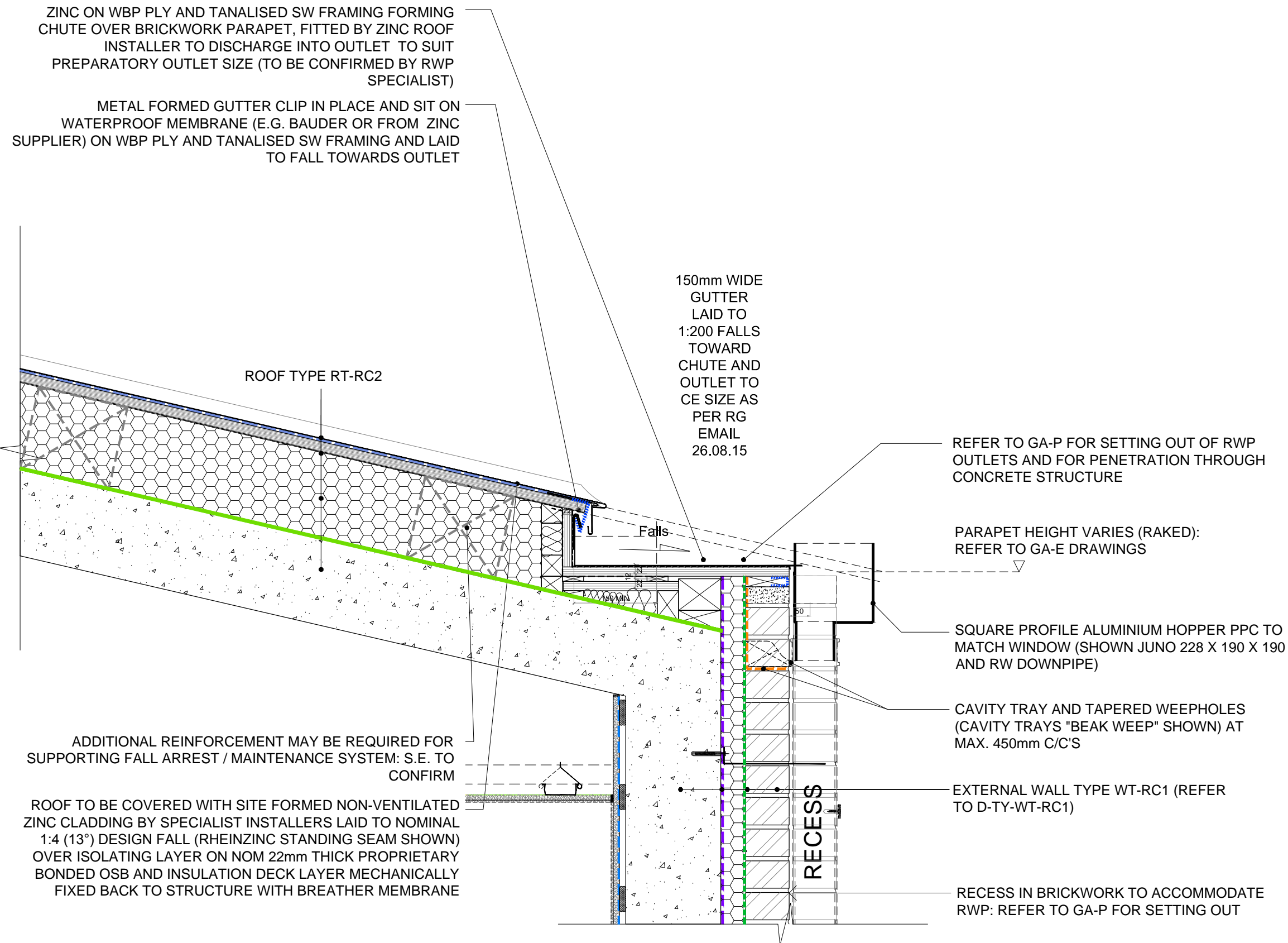

DETAIL - Block C - D-J-RC215 - Box Gutter Chute Outlet & RWP Hopper (L08 GL J-08)

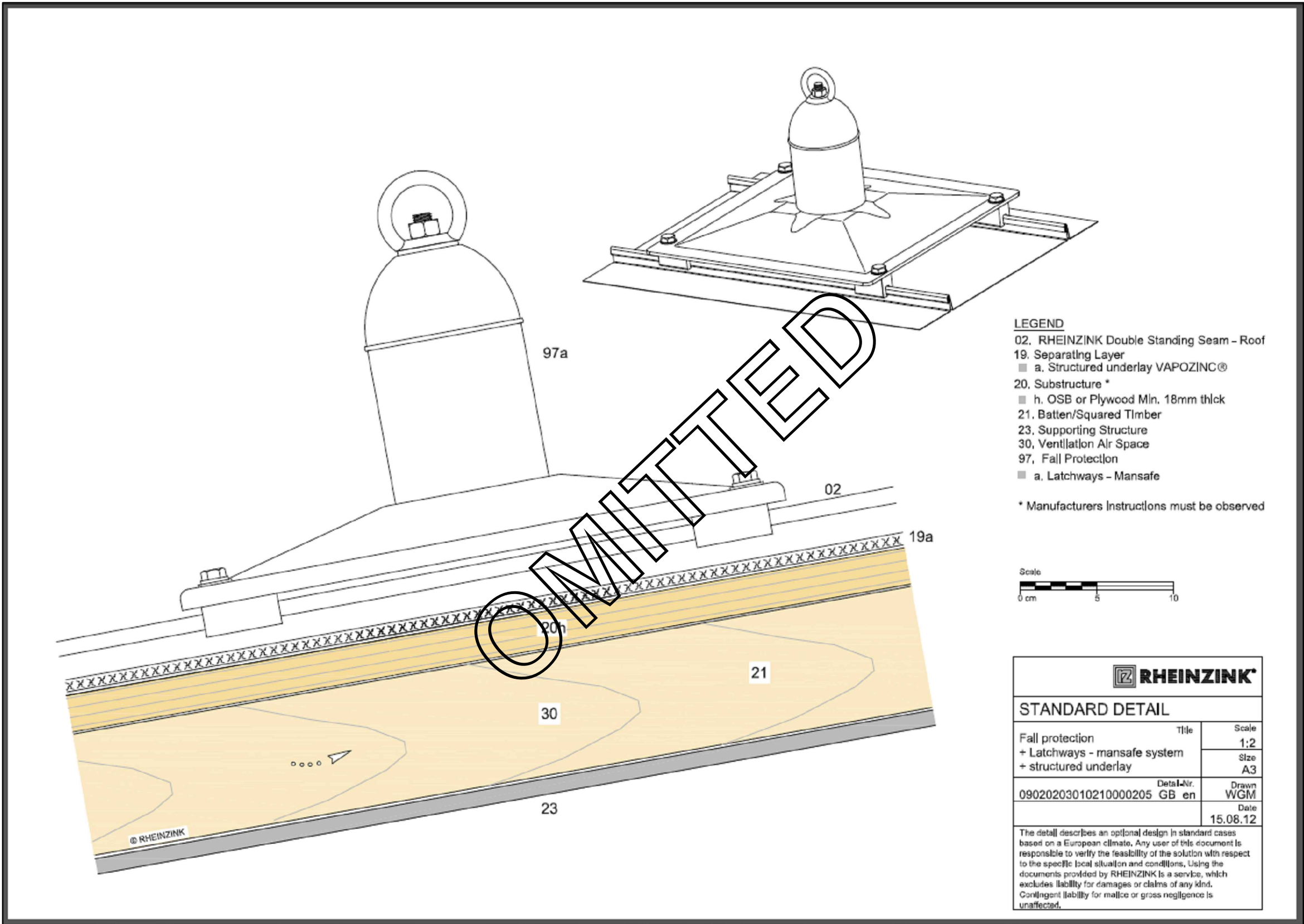

Block C - Fall arrest system  
OPTION A - Clips to standing seam zinc

DETAIL - Block C - D-J-RC216 - Fall Arrest System (L08 GL J-08)