

job	BACTON LOW RISE LONDON NWS	drawn:	date:
drawing	TYPICAL BLOCK C DETAILS External wall junctions - RC125 to RC128	scale:	job no:
		1:10 @ A1 1:20 @ A3	1952
note:	all dimensions to be checked against the commencement of the work. If this drawing exceeds the quantities in any contract, the quantities are to be informed before the work is commenced. For all other than planning application purposes do not scale, use dimensions, this drawing is for reference only.		
revisions		drawing no.	rev.
		D-J-RC125 to D-J-RC128	as below

rev.	date	description	issued by	checked by
C1	20.01.16	First Construction issue	RR	DWW

<i>Rydon</i>		
Received	Initial	Date
RYDON	RA	25 Jan 16
Client		
Status A - No Comments		<input checked="" type="checkbox"/>
Status B - Comments, Revise & Resubmit		<input type="checkbox"/>
Status C - Rejected		<input type="checkbox"/>
For Information Only		<input type="checkbox"/>

FOR NOTES ON BALCONY AND SOFFIT
CONSTRUCTION REFER TO DETAIL D-J-RC601

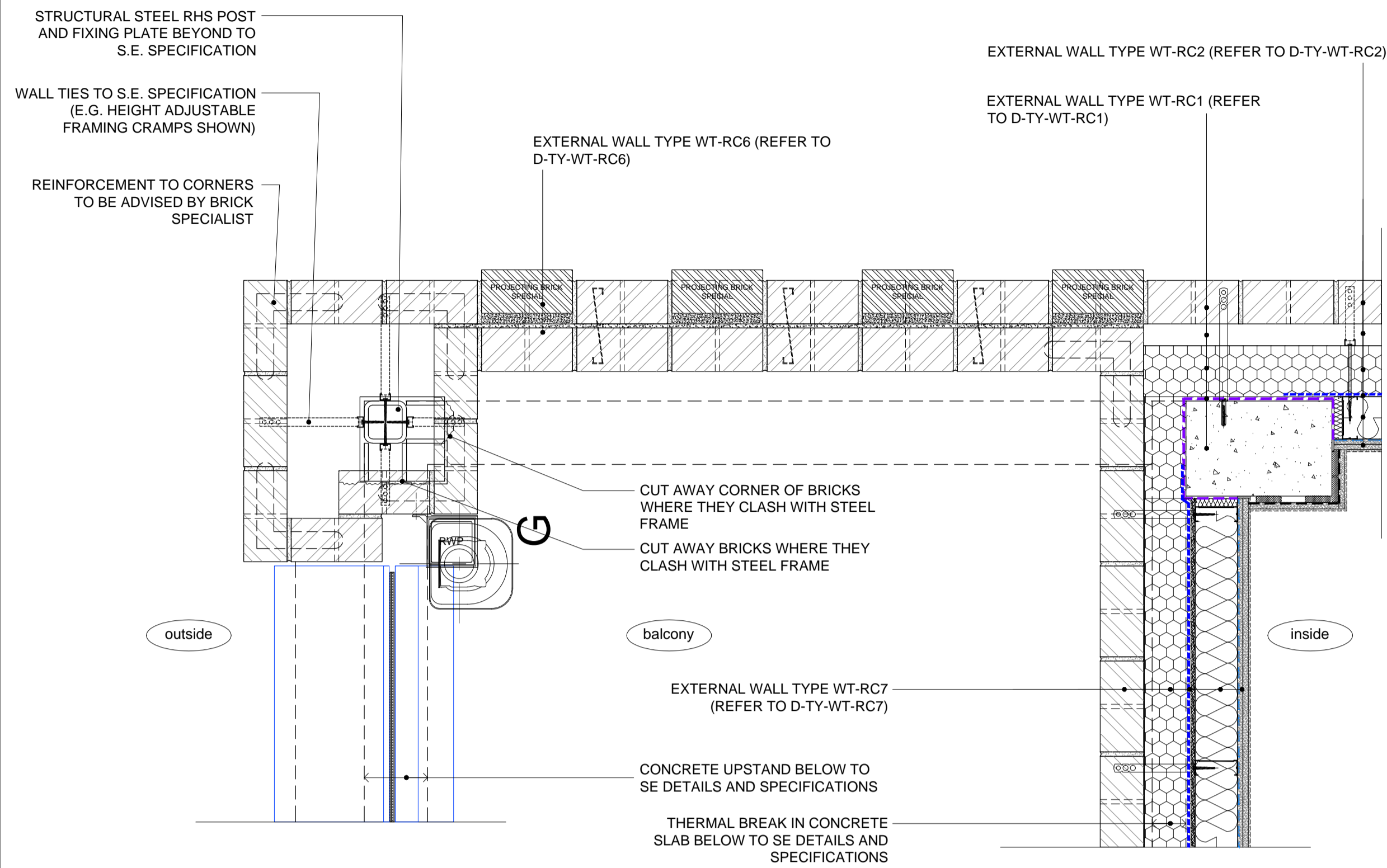

DETAIL - Block C - D-J-RC125 - Structural Post Encapsulation WT-RC1 (L02 GL CC-05)

FOR NOTES ON BALCONY AND SOFFIT
CONSTRUCTION REFER TO DETAIL D-J-RC601

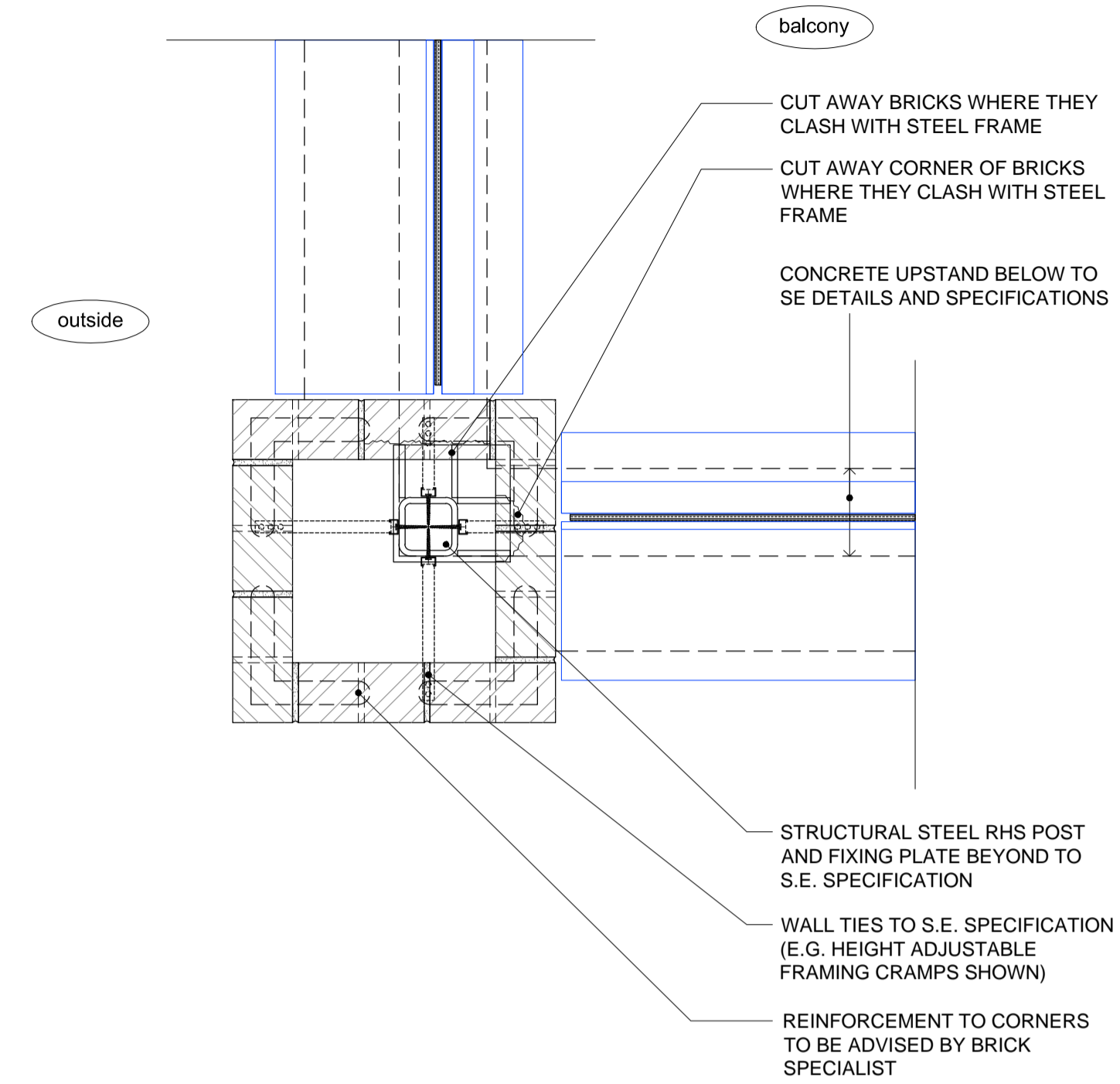

DETAIL - Block C - D-J-RC126 - Structural Post Encapsulation WT-RC1 (L02 GL J-05)

FOR NOTES ON TERRACE AND SOFFIT
CONSTRUCTION REFER TO DETAIL D-J-RC604

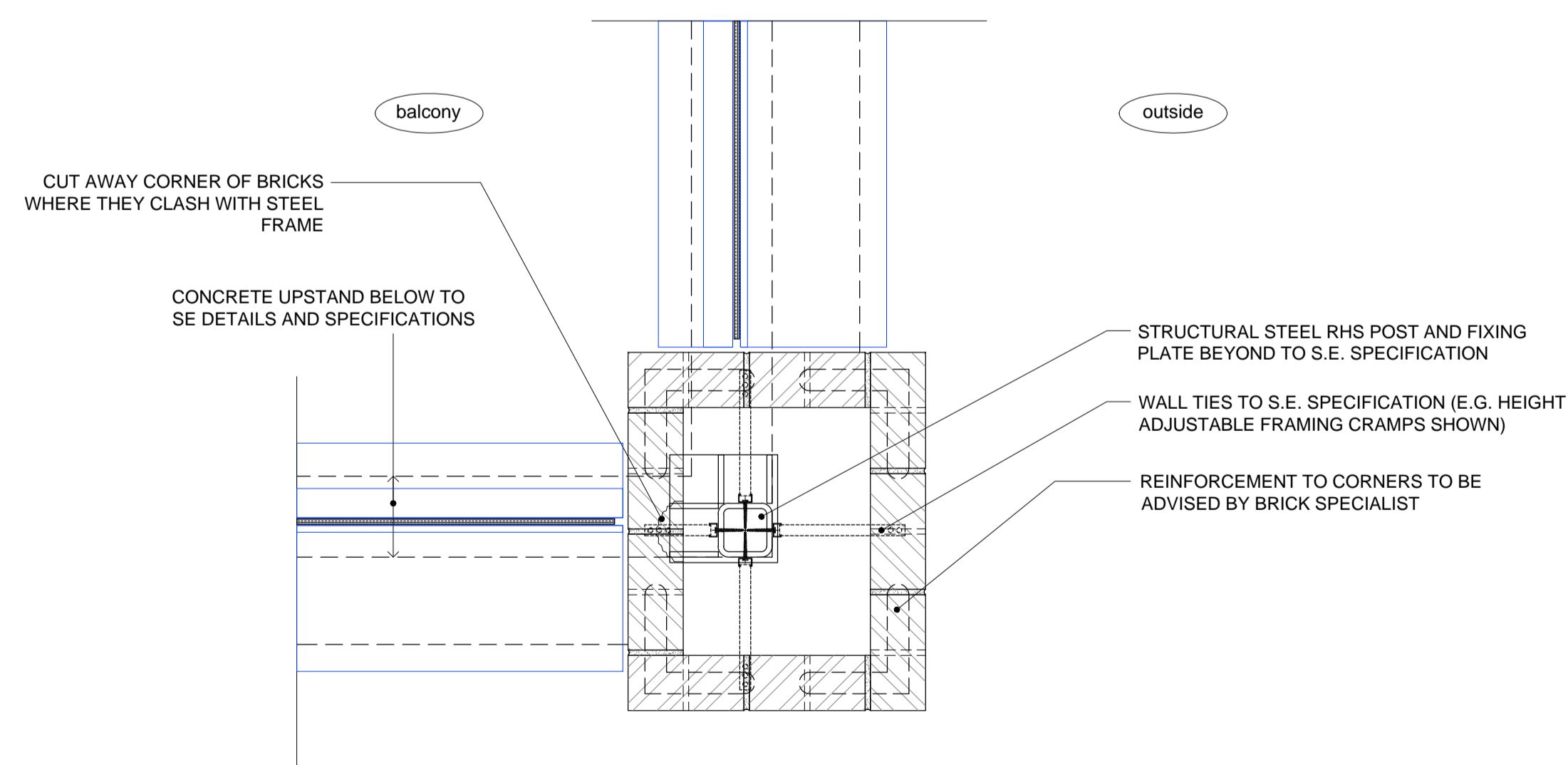

DETAIL - Block C - D-J-RC127 - Structural Post Encapsulation WT-RC1 (L02 GL J-09)

FOR NOTES ON BALCONY AND SOFFIT
CONSTRUCTION REFER TO DETAIL D-J-RC601

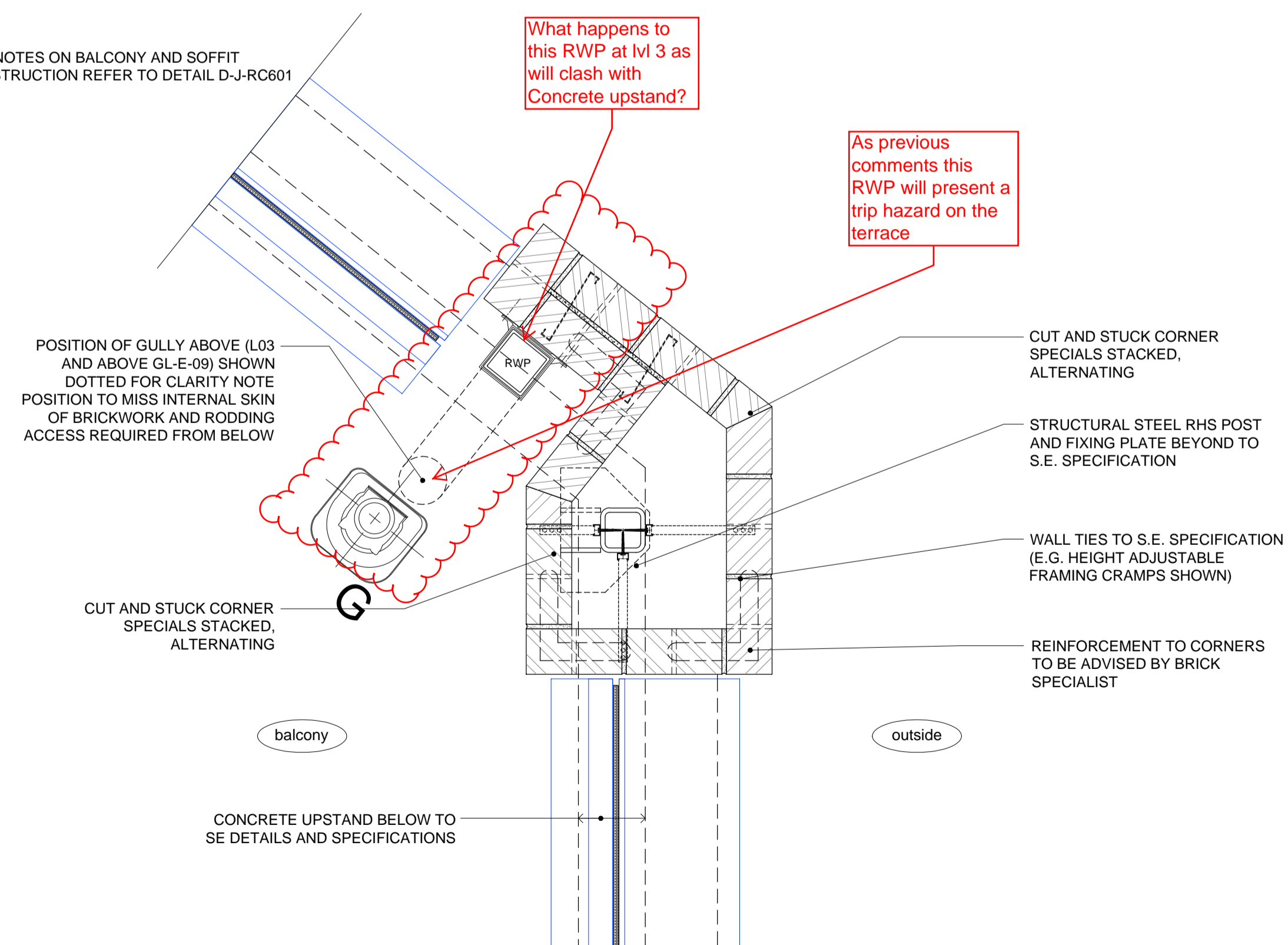

DETAIL - Block C - D-J-RC128 - Structural Post Encapsulation WT-RC1 (L02 GL E-09)