

job	BACTON LOW RISE LONDON NW5	drawn:	date:	
drawing	TYPICAL BLOCK C DETAILS ROOF TYPES SHEET 1	scale:	job no:	
revisions		1:10 @ A1 1:20 @ A3	1952	
rev.	date	description	issued by	checked by
C1	20.01.16	First Construction issue	RR	DWW

rev.	date	description	issued by	checked by
C1	20.01.16	First Construction issue	RR	DWW

Received		
	Initial	Date
RYDON	RA	25 Jan 16
Client		
Status A - No Comments		<input checked="" type="checkbox"/>
Status B - Comments, Revise & Resubmit		<input type="checkbox"/>
Status C - Rejected		<input type="checkbox"/>
For Information Only		<input type="checkbox"/>

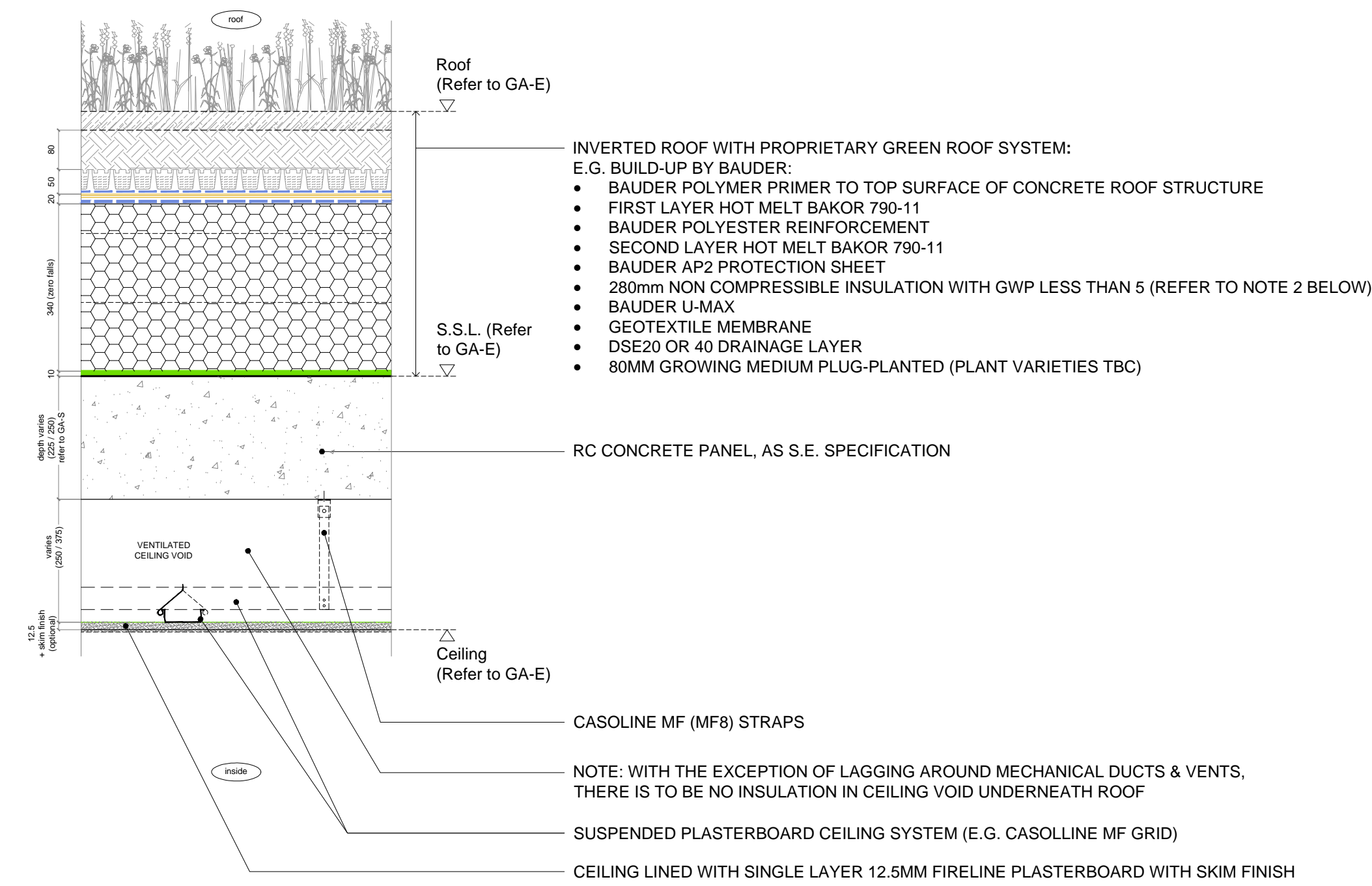

SECTION INVERTED ROOF

- NOTES:
- U-VALUE OF 0.10 W/m²K (Ref: 1U118Q3E55 Dated 27.08.14) ACHIEVED USING 340mm KINGSPAN "STYROZONE N300R" INSULATION ON 250mm RC SLAB.
 - ALL INSULATING MATERIAL TO HAVE A GLOBAL WARMING POTENTIAL OF LESS THAN 5
 - NO FALLS - NOTE: BBA CERTIFICATION FOR BAKOR 790-11 DEFINES 'COMPLETELY FLAT ROOFS' AS '..... THOSE ROOFS HAVING A FINISHED FALL OF LESS THAN 1:80.' AS CLIENT RECOMMENDATIONS DATED 29.09.15

DETAIL - D-TY-RT-RC1 - Green roof (INVERTED)

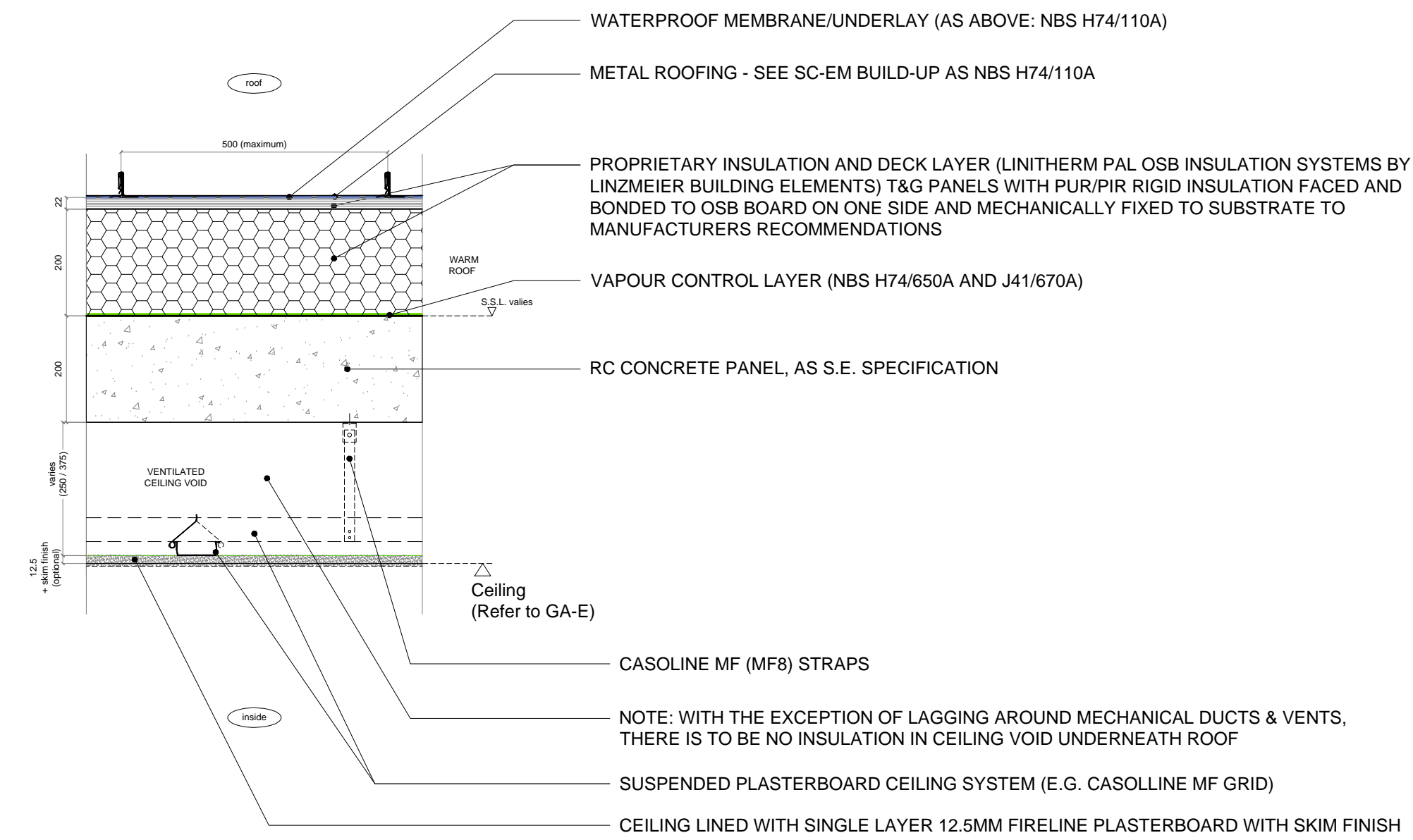

SECTION WARM ROOF (SET TO FALLS)

- NOTES:
- TARGET U-VALUE: 0.10 W/m²K
 - LINZMEIER BUILDING ELEMENTS CALCULATION DATED 28.09.15 200mm PUR/PIR (AS SHOWN) U-VALUE 0.11W/m²K
 - ALTERNATIVE U-VALUE OF 0.10W/m²K ACHIEVED USING LINZMEIER BUILDING ELEMENTS CALCULATION DATED 28.09.15 160mm PAL OSB PUR/PIR + 60mm PAL FD 60 PUR/PIR .
 - BASED ON 'GREEN GUIDE TO SPECIFICATION' REFERENCE ELEMENT NUMBER: 812540022
 - ALL INSULATING MATERIAL TO HAVE A GLOBAL WARMING POTENTIAL OF LESS THAN 5

DETAIL - D-TY-RT-RC2 - Metal roof (WARM)

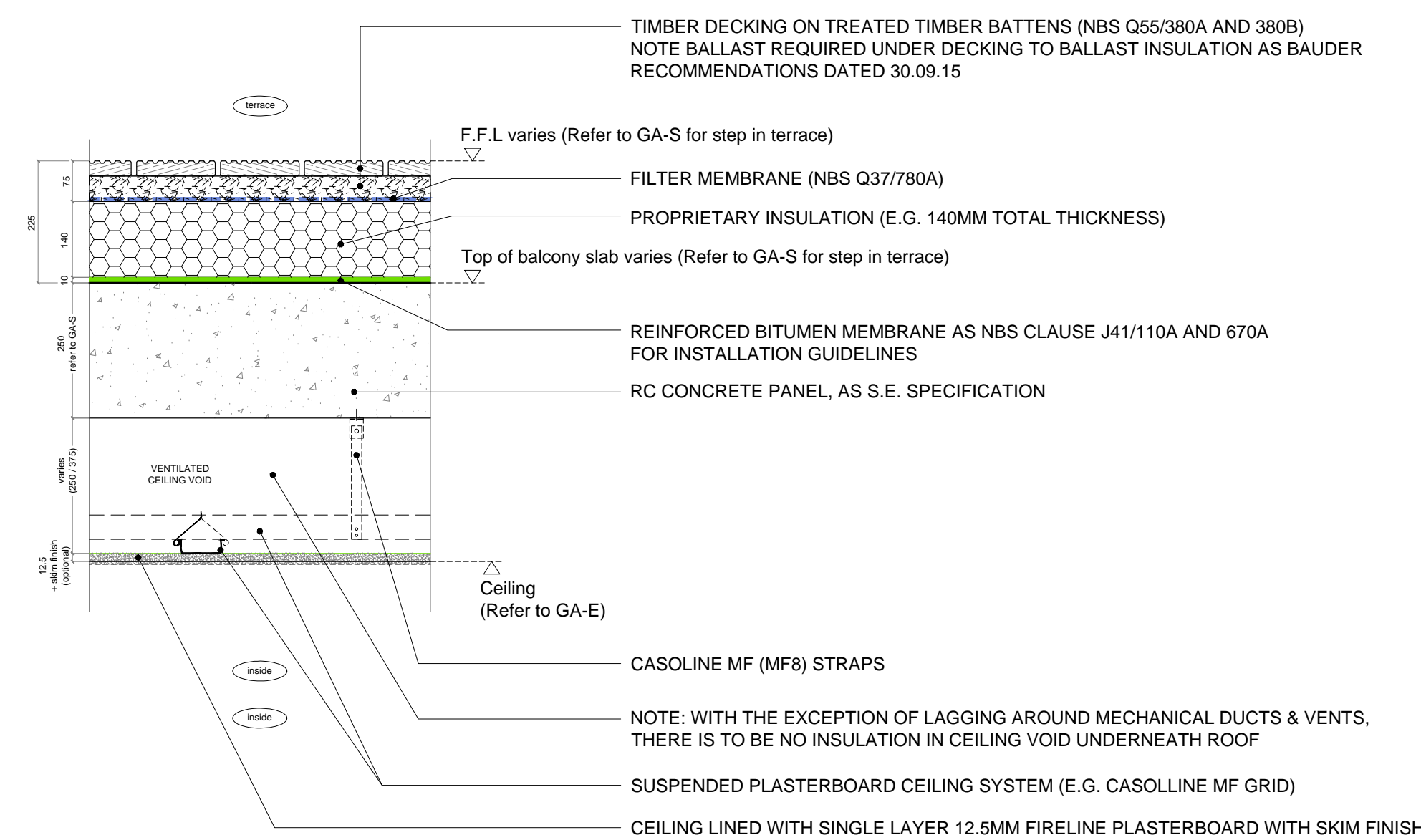

SECTION INVERTED ROOF

- NOTES:
- U-VALUE OF 0.25 W/m²K (Ref: 1Y118S4F50 Dated 28.08.14) ACHIEVED USING 140mm KINGSPAN "STYROZONE N300R" INSULATION ON 225mm RC SLAB.
 - ALL INSULATING MATERIAL TO HAVE A GLOBAL WARMING POTENTIAL OF LESS THAN 5.
 - NO FALLS - NOTE: BBA CERTIFICATION FOR BAKOR 790-11 DEFINES 'COMPLETELY FLAT ROOFS' AS '..... THOSE ROOFS HAVING A FINISHED FALL OF LESS THAN 1:80.' AS CLIENT RECOMMENDATIONS DATED 29.09.15

DETAIL - D-TY-RT-RC3 - Roof Terrace (INVERTED)

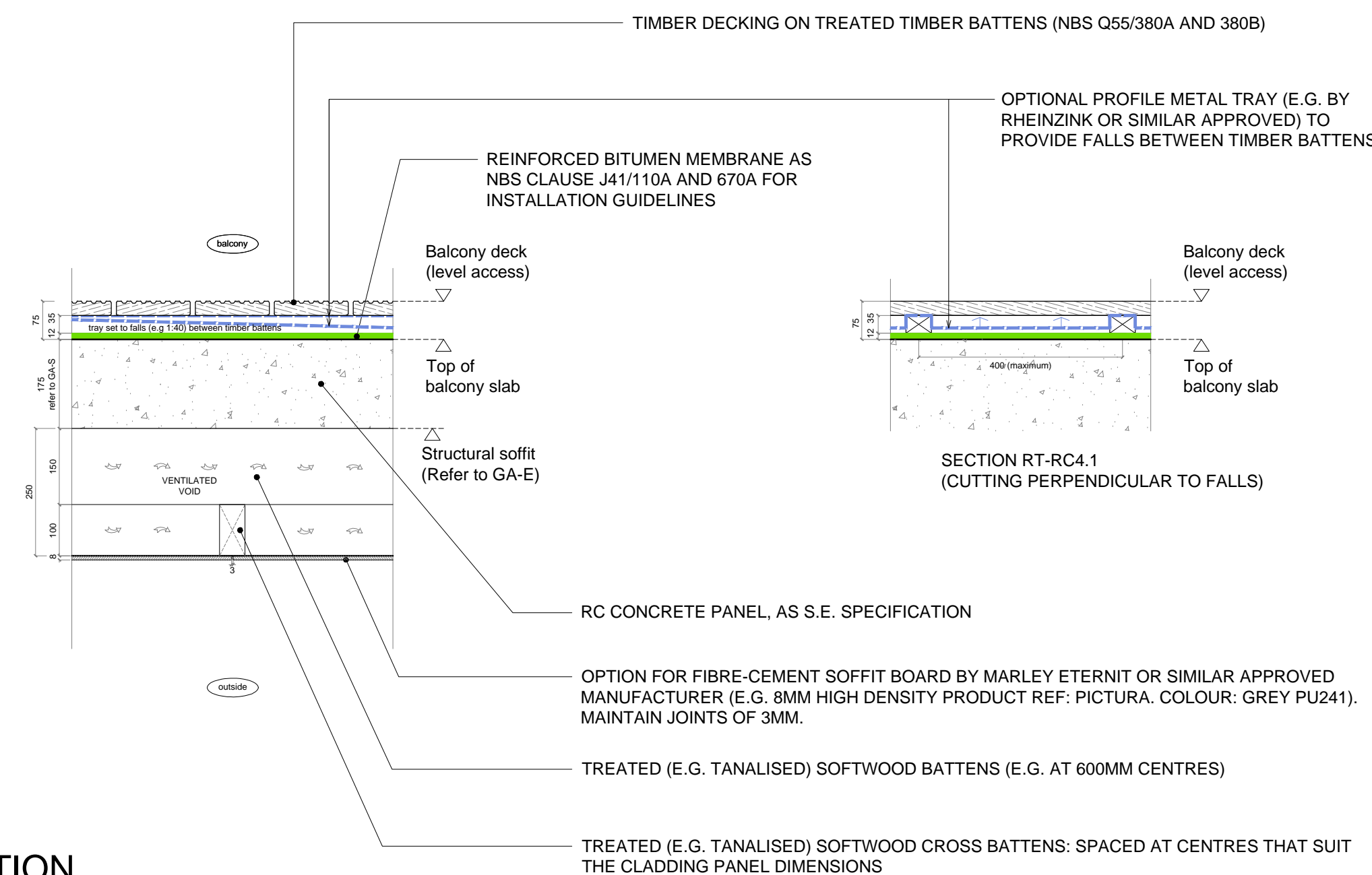

SECTION INVERTED BALCONY

- NOTES:
- NO FALLS - NOTE: BBA CERTIFICATION FOR BAKOR 790-11 DEFINES 'COMPLETELY FLAT ROOFS' AS '..... THOSE ROOFS HAVING A FINISHED FALL OF LESS THAN 1:80.' AS CLIENT RECOMMENDATIONS DATED 29.09.15

DETAIL - D-TY-RT-RC4 - Balcony (INVERTED)